

D2 TRASH/RECYCLING ENCLOSURE AND BATTERY STORAGE
A101 1/4" = 1'-0"

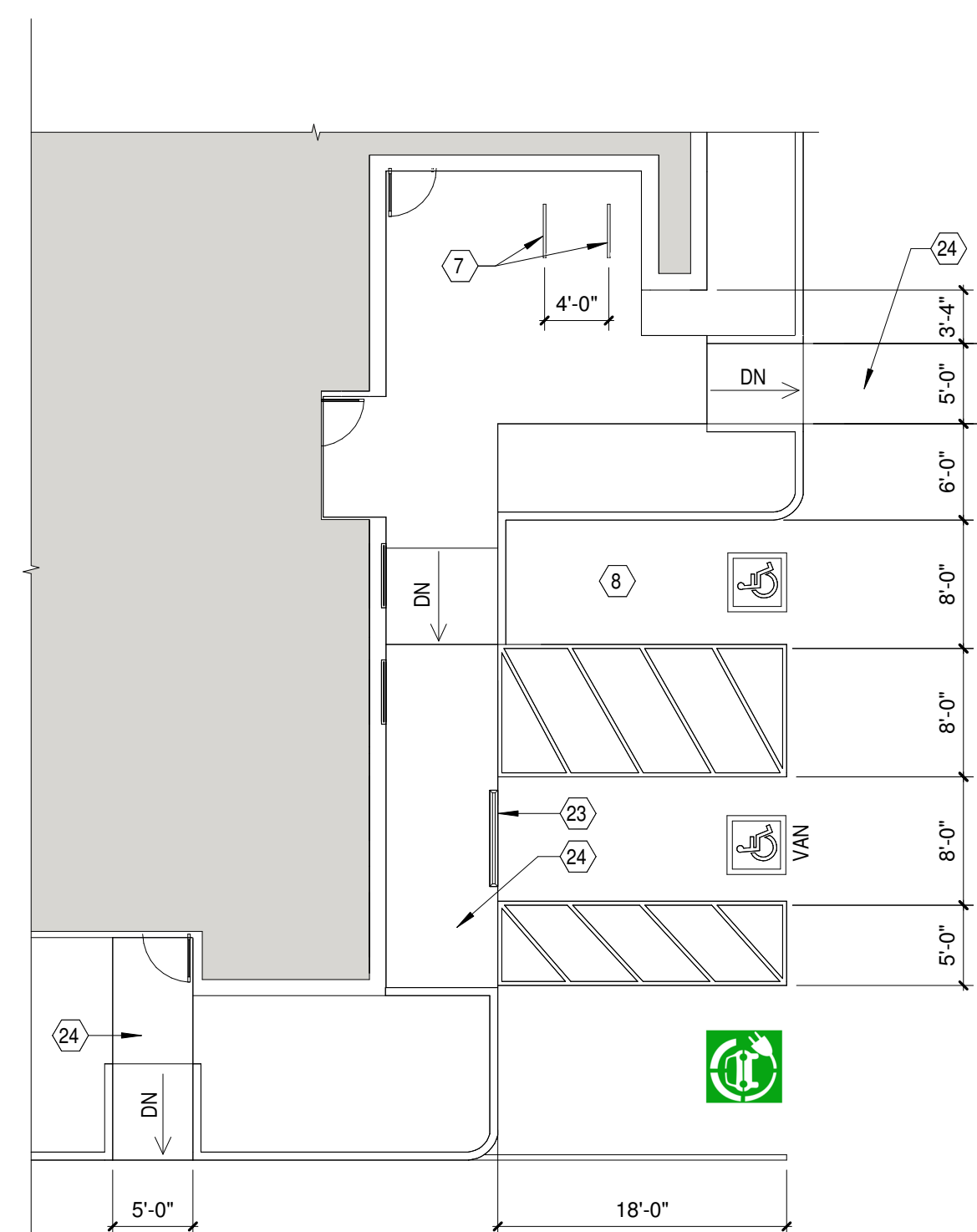

D4 PARKING AREA
A101 1" = 10'-0"

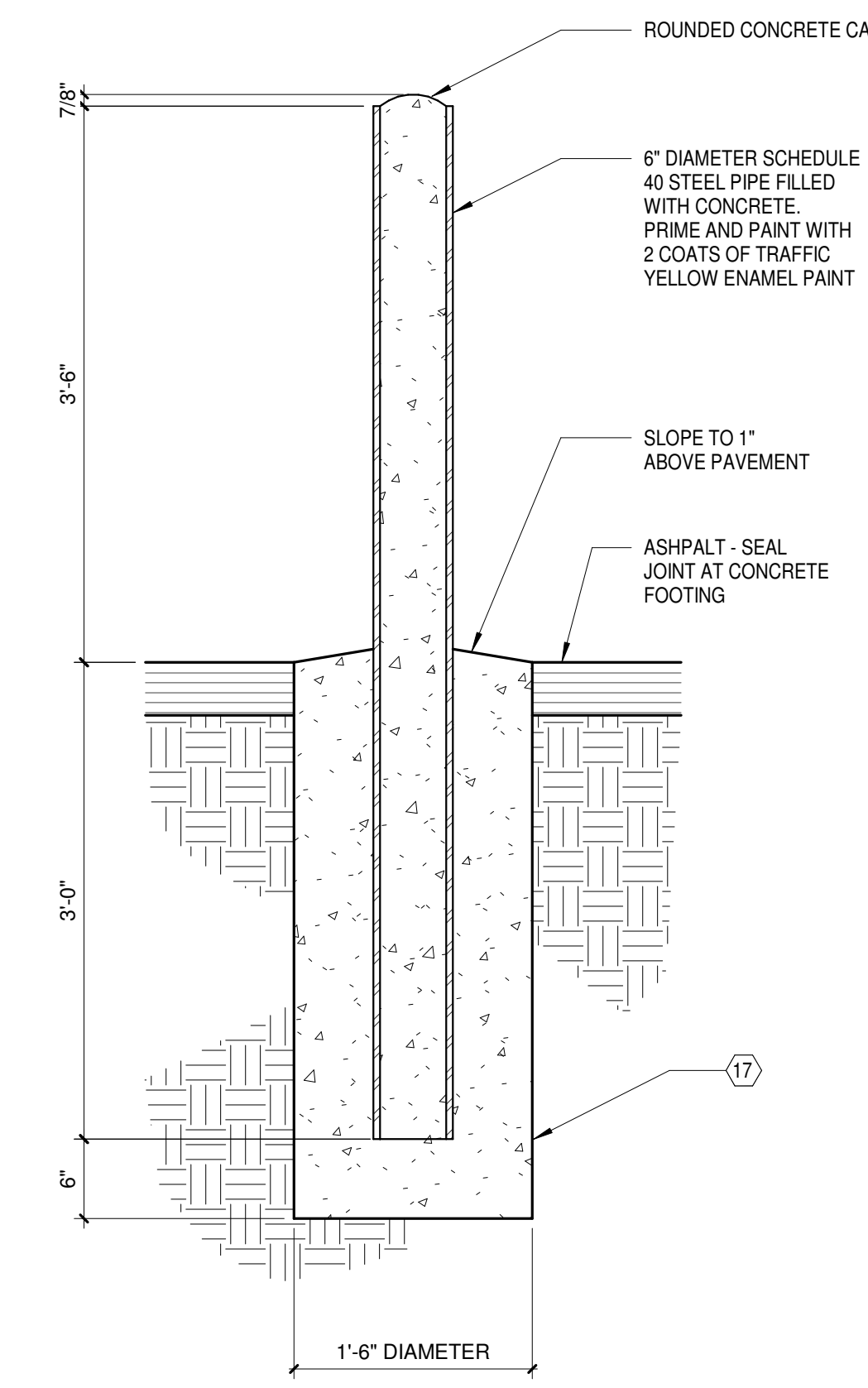

D5 STEEL PIPE BOLLARD DETAIL
A101 1" = 1'-0"

SITE AND BUILDING DATA

SITE SIZE	188,360 S.F. (4.32 ACRES)
BUILDING SIZE	52,933 S.F.
MAXIMUM IMPERVIOUS SURFACE AREA (85%)	160,106 S.F.
TOTAL IMPERVIOUS SURFACE AREA	160,094 S.F.
IMPERVIOUS SURFACE AREA PERCENTAGE	85%
PARKING:	
MINIMUM REQUIRED	(56) SPACES
CUSTOMER PARKING	(13) SPACES
EMPLOYEE PARKING	(48) SPACES
SERVICE HOLDING	(49) SPACES
RV HOLDING	(2) SPACES
SERVICE HOLDING, EV CHARGING	(7) SPACES

KEYNOTES

- 1 LANDSCAPE SETBACK
- 2 PYLON SIGN
- 3 CONCRETE SLAB ON GRADE
- 4 8x8x16 CMU WALL
- 5 CHAIN-LINK GATES TO PROVIDE 20' CLEAR OPENING WITH SLATS AND CANE BOLTS WITH SLEEVES INTO PAVEMENT TO SECURE GATES IN CLOSED POSITION AND WHEN OPEN 130-DEGREES. NO CENTER POSTS ALLOWED.
- 6 ANGLE 4x4x3/8 WITH 3/8" EXPANSION ANCHORS AT 48" OC WITH VERTICAL LEG TO INTERIOR OF ENCLOSURE
- 7 BIKE RACK
- 8 CUSTOMER PARKING
- 9 TRASH/RECYCLE ENCLOSURE
- 10 ELECTRIC VEHICLE BATTERY STORAGE AREA
- 11 CHAIN-LINK FENCE
- 12 CHAIN-LINK GATES WITH CANE BOLTS WITH SLEEVES INTO PAVEMENT TO SECURE GATES IN CLOSED POSITION AND WHEN OPEN. NO CENTER POSTS ALLOWED.
- 13 ROOF ABOVE
- 14 STEEL PIPE COLUMN
- 15 BOLLARD, TYPICAL-SEE DETAIL D5/A101
- 16 CONCRETE CURB
- 17 CONCRETE FOOTING AND FOUNDATION SYSTEM. SEE STRUCTURAL FOR SIZE AND REINFORCING
- 18 EXISTING FIRE HYDRANT - PROTECT IN PLACE
- 19 FIRE HYDRANT
- 20 FIRE DEPARTMENT CONNECTION (FDC)
- 21 DECORATIVE FENCE AND SWING GATES PROVIDING 20' CLEAR OPENING
- 22 DECORATIVE FENCE AND 20' CLEAR WIDTH SLIDING GATE
- 23 PRECAST CONCRETE WHEEL STOP
- 24 CONCRETE PEDESTRIAN WALKWAY
- 25 ASPHALT PAVEMENT (TYP)
- 26 4" WIDE STRIPING (TYP)
- 27 CARPOOL PARKING STALLS WITH SIGNAGE
- 28 POLE-MOUNTED LIGHT FIXTURES

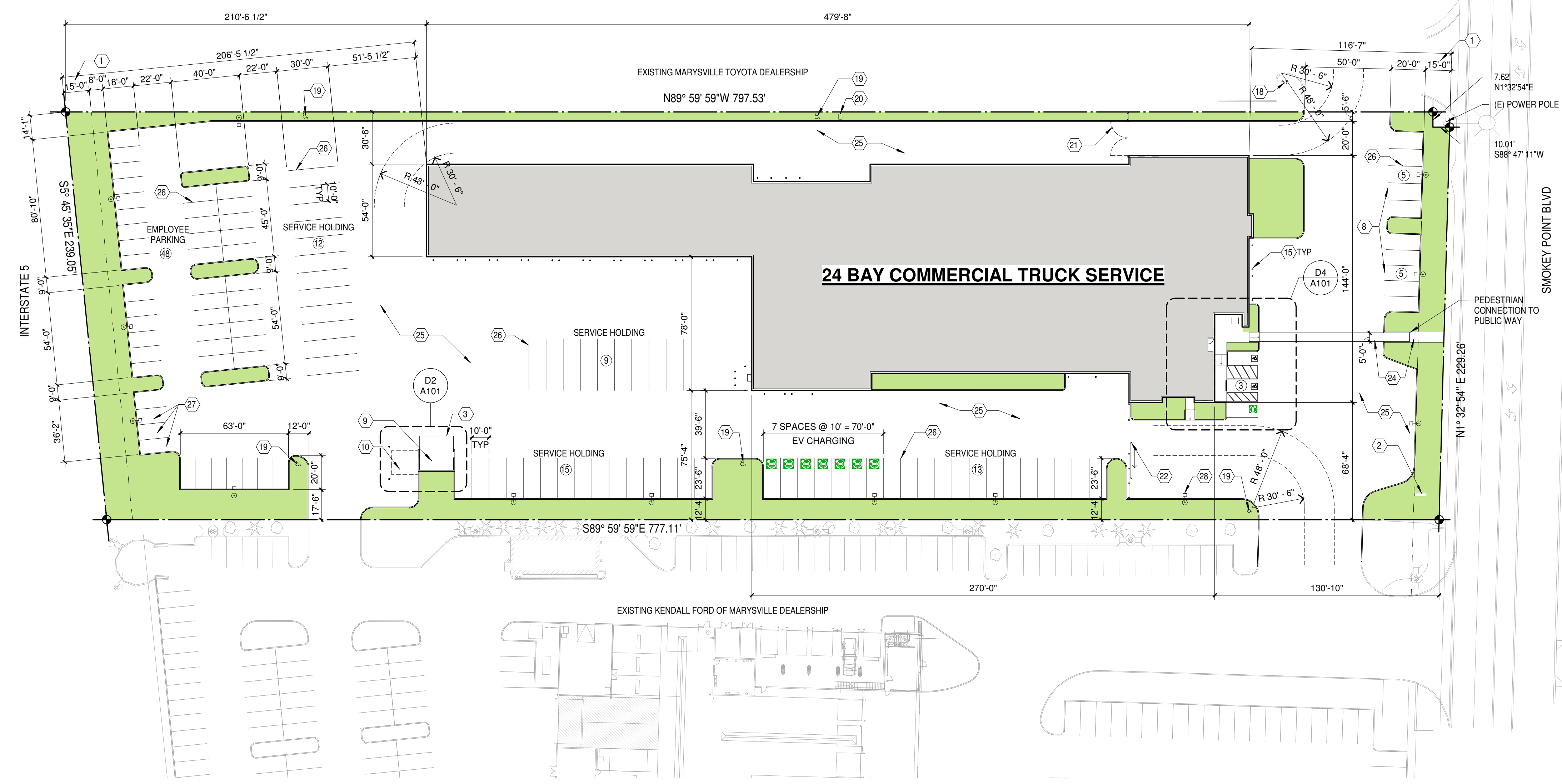

A3 SITE PLAN
A101 1" = 40'-0"

NORTH

REVISIONS

NOT FOR CONSTRUCTION

KENDALL AUTO GROUP
FORD PRO ELITE
COMMERCIAL VEHICLE SERVICE CENTER
16100 SMOKEY POINT BLVD
MARYSVILLE, WA 98271

PA.
Architects and Planners, Chartered
300 E. Mallard Drive, Suite 325, Boise Idaho 83706

DATE: OCT 17, 2023
PROJECT NO: 2310.00
SHEET:
A101
SITE PLAN