

66TH AVE TYPICAL SECTION

PRIVATE ROAD TYPICAL SECTION

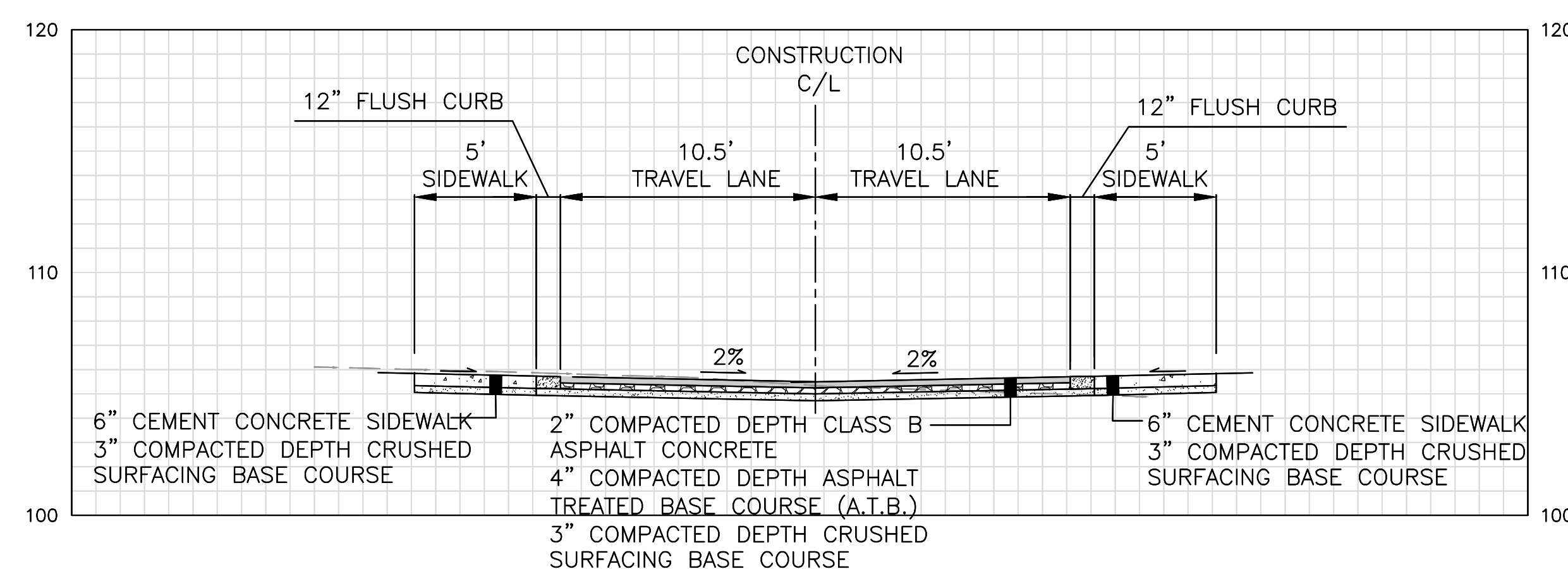

66th Ave NE

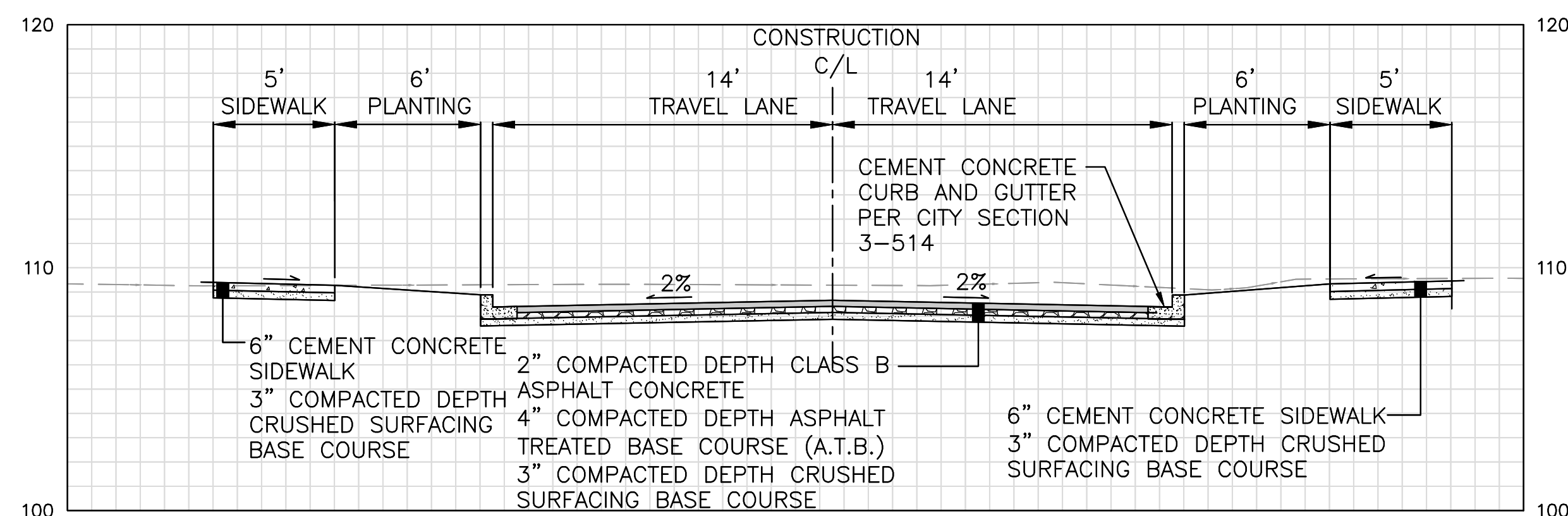
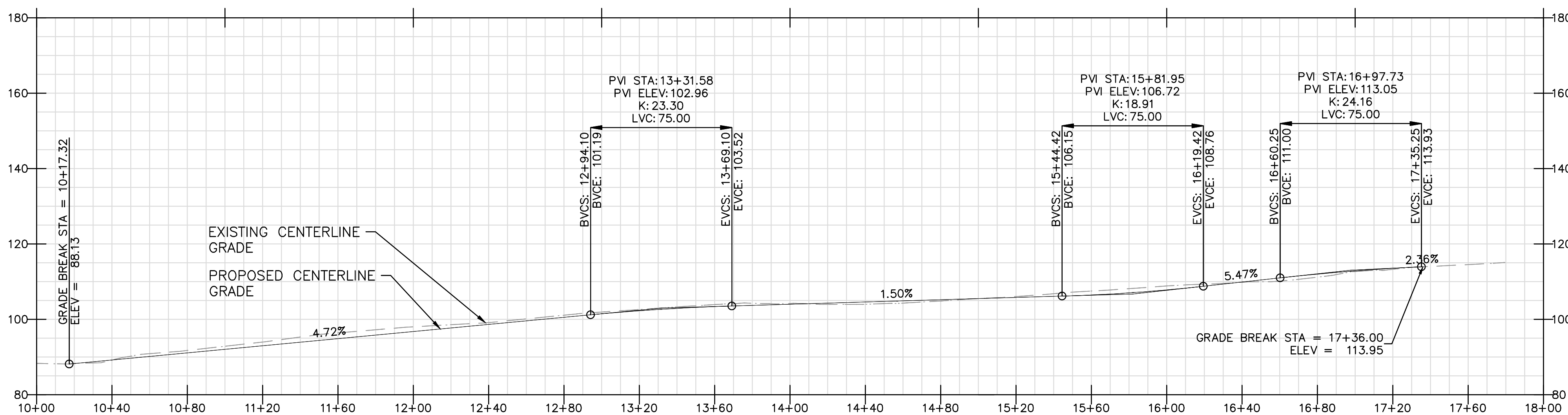

PRIVATE ROAD

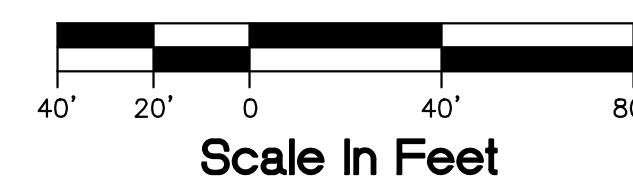
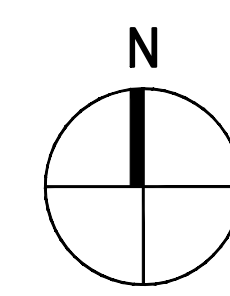
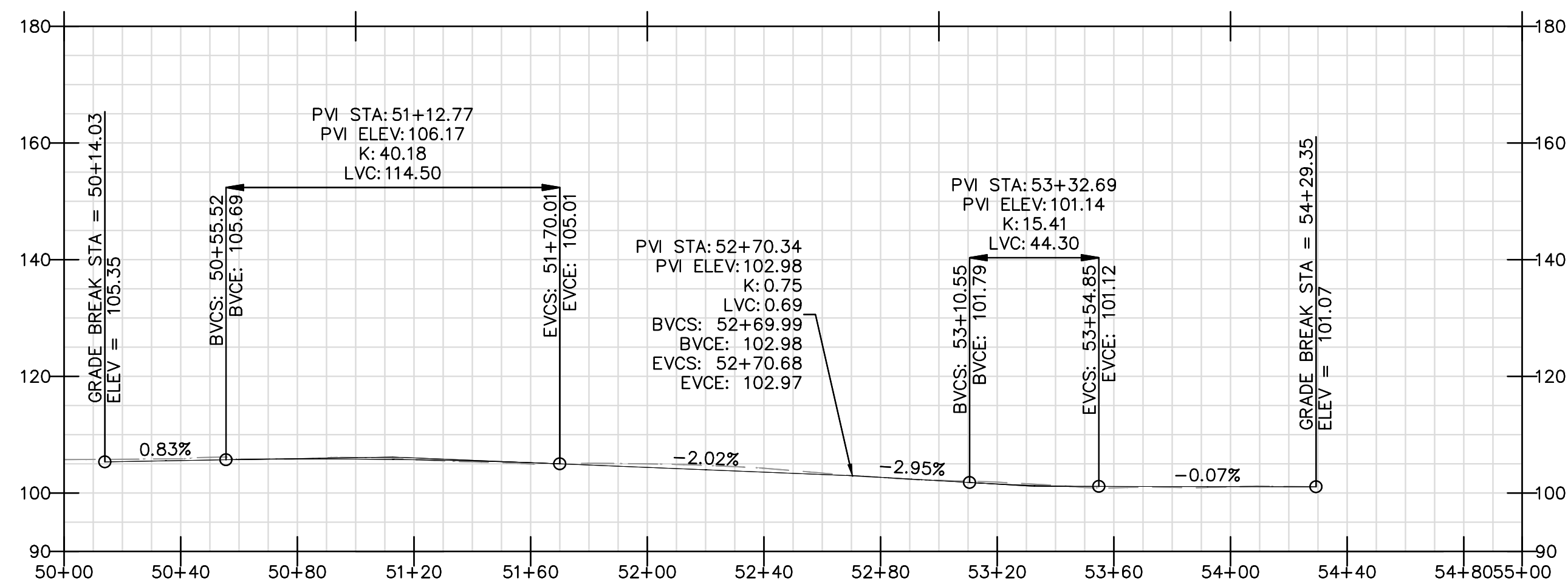

**PLEASE CALL 811  
3 Working Days  
BEFORE YOU DIG**



119 PINE ST. SUITE 400  
SEATTLE, WA 98101  
T 206.223.0326  
www.migcom.com

architect  
Schemata Workshop, Inc.  
1720 12th Avenue  
Seattle, WA 98122

CONTACT: Grace Kim, AIA  
v (206) 285.1589  
e grace@schemataworkshop.com

owner  
King Creek LLC  
2720 Hoyt Ave, Apt 119  
Everett, WA 98201

CONTACT: Sherie Rzczkowski  
e sherierenee@gmail.com  
v (360) 510.3959

SUNNYSIDE  
VILLAGE

3121 66th Ave NE  
Marysville, WA 98270

LUA Submittal  
August 19, 2022

NO.	DATE	DESCRIPTION
-----	------	-------------

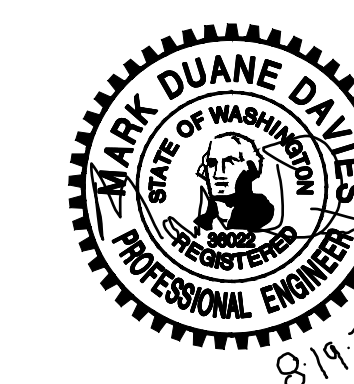

NOT FOR CONSTRUCTION

Architect Project No: 1819  
Author:  
Checker:

TYPICAL SECTIONS AND  
ROADWAY PROFILES

C-2