

HORT: NAD 83  
VERT: NAVD 88  
UNITS: US SURVEY FT

**LEGEND**

- SET 5/8" X 24" REBAR WITH CAP STAMPED "METRON LS 28067" (MARCH 2018)
- WATER VALVE
- IRRIGATION VALVE
- WATER METER
- FIRE HYDRANT
- WATER BLOW OFF
- SEWER MANHOLE
- CATCH BASIN
- DRAIN MANHOLE
- UTILITY POLE WITH GUY ANCHOR
- UTILITY POLE WITH LIGHT
- ELECTRIC BOX
- POWER TRANSFORMER
- W — WATER LINE
- SS — SEWER LINE
- OH PWR — OVERHEAD POWER LINE
- SHRUB
- DECIDUOUS TREE W/ DIA.
- CONIFER TREE W/ DIA.



Scale 1" = 30'

CONTOUR INTERVAL = 1'

PLAT OF SUNSET BOULEVARD  
AFN 20021135005

TRACT 997

PARCEL "B"  
AFN 201805305001  
TAX NO. 29050300405000

PARCEL "A"  
AFN 201805305001  
AREA=206,964 SQ FT  
=4.75 ACRES

TAX NO. 29050300402300

TAX NO. 29050300402500

TAX NO. 29050300403700

TAX NO. 29050200301600

TAX NO. 29050200302400

**UNDERGROUND UTILITY NOTE:**  
UNDERGROUND UTILITIES ARE BASED ON SURFACE INDICATORS AND CITY OF MARYSVILLE GIS RECORDS. 811 UTILITY LOCATE "CALL BEFORE YOU DIG" WAS NOT EMPLOYED FOR UTILITY LOCATE.  
THE USE OF THIS MAP FOR THE PRECISE LOCATION OF THE UTILITY LINES IS NOT WARRANTED OR GUARANTEED.  
RCW 19.122 REQUIRES 48 HOUR NOTIFICATION PRIOR TO UNDERGROUND CONSTRUCTION ACTIVITY. CONTACT "CALL BEFORE YOU DIG" UTILITY LOCATE SERVICE AT 811 OR 1-800-424-5555.

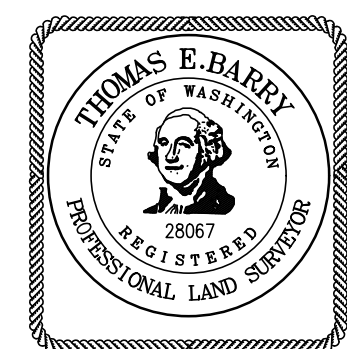

**METRON**  
and ASSOCIATES INC.  
LAND SURVEYS, MAPS, AND LAND USE PLANNING

307 N. OLYMPIC AVENUE, SUITE 205  
ARLINGTON, WASHINGTON 98223  
(360) 435-3777 FAX (360) 435-4822  
Copyright reserved 2019 © Metron and Associates, Inc.

PROJECT: SUNNYSIDE VILLAGE  
CO-HOUSING COMMUNITY  
3121 66TH AVE NE  
MARYSVILLE, WA 98270  
TAX NO. 29050300402100

A PORTION OF THE NE1/4 & THE SE1/4, OF THE SE1/4  
SECTION 3, TOWNSHIP 29 NORTH, RANGE 5 EAST, W.M.  
CITY OF MARYSVILLE  
SNOHOMISH COUNTY, WASHINGTON

SHEET NAME: <b>ENGINEERING SURVEY</b>		PROJECT NO. 19098
DRAWN BY: V.S.W.	APPROVED BY: T.E.B. DATE:	PROJECT NO.
DATE: NOVEMBER 2019	SCALE: 1" = 30'	19098
FIELD BOOK: 5-29-	DWG FILE: 19098.DWG	SHEET:
		1 OF 1

REV 01 VSW 8-12-2022