

SUNNYSIDE VILLAGE

3121 66TH Ave NE
 Marysville, WA 98270

LAND USE PERMIT

08/22/22

NO.	DATE	DESCRIPTION



NOT FOR CONSTRUCTION

Architect Project No: 1819
 Author: BS/PG
 Checker: IO

PLANTING PLAN

L1.0

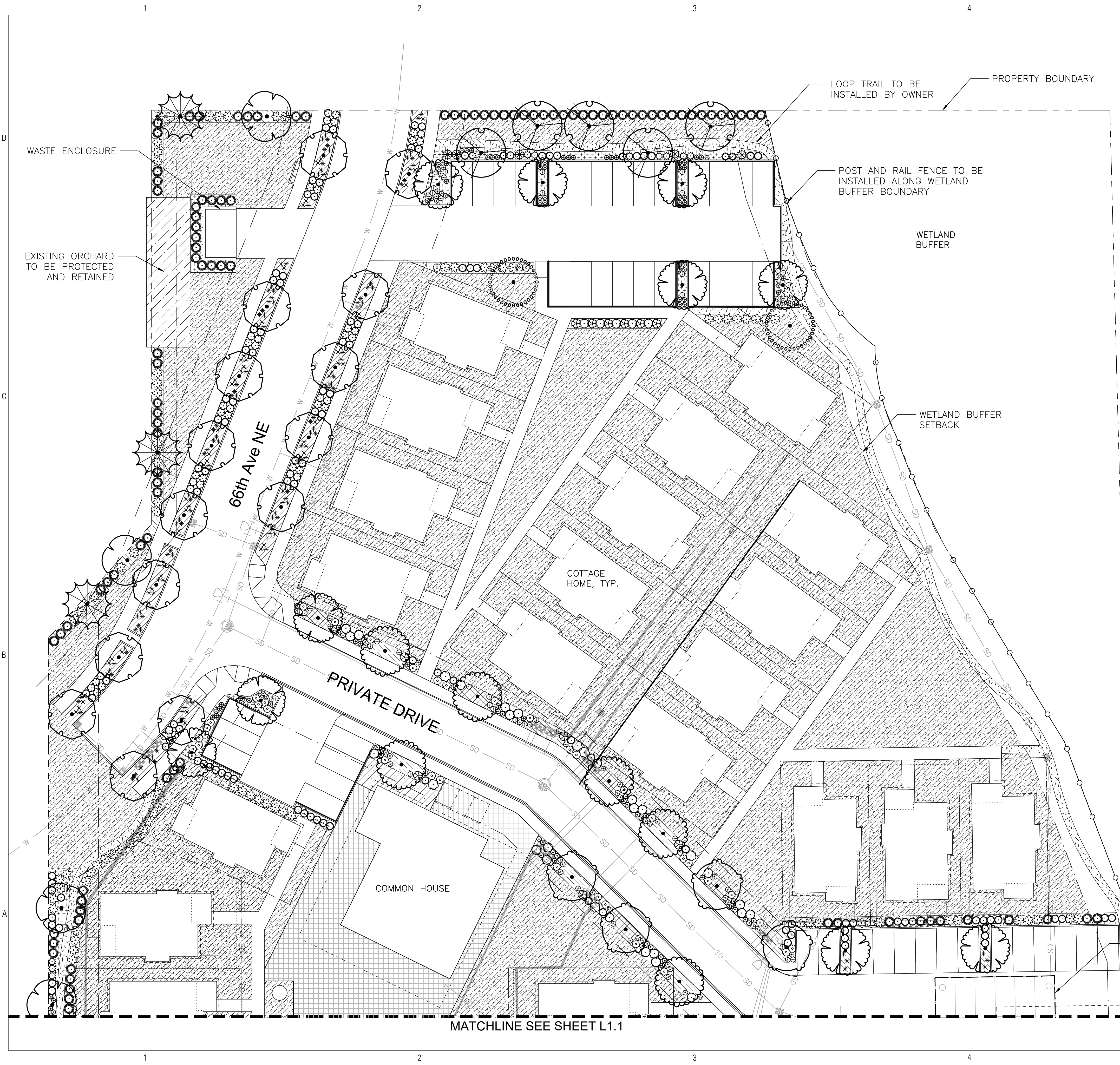

LEGEND

- POST AND RAIL FENCE WITH WEDLAND SIGNAGE, POST 5 FT ON CENTER
- PAVERS, SEE ARCHITECTURAL PLANS FOR DETAIL
- LOOP TRAIL TO BE INSTALLED BY OWNER POST OCCUPANCY
- ROOT BARRIER PER CITY STANDARDS

NOTES

1. REFER TO L1.2 FOR PLANT SCHEDULE

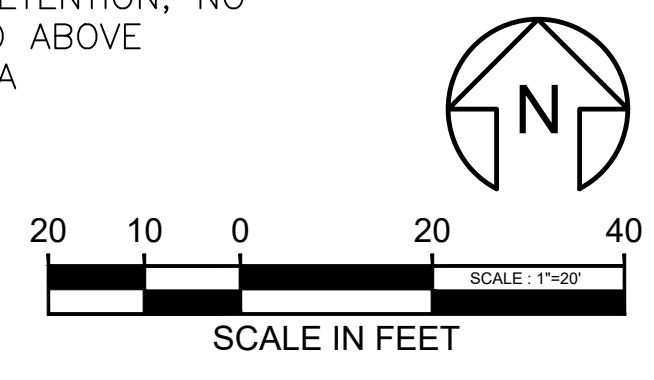

5/20/2022 1:34:22 PM

MATCHLINE SEE SHEET L1.1

1 2 3 4 5

MATCHLINE SEE SHEET L1.0

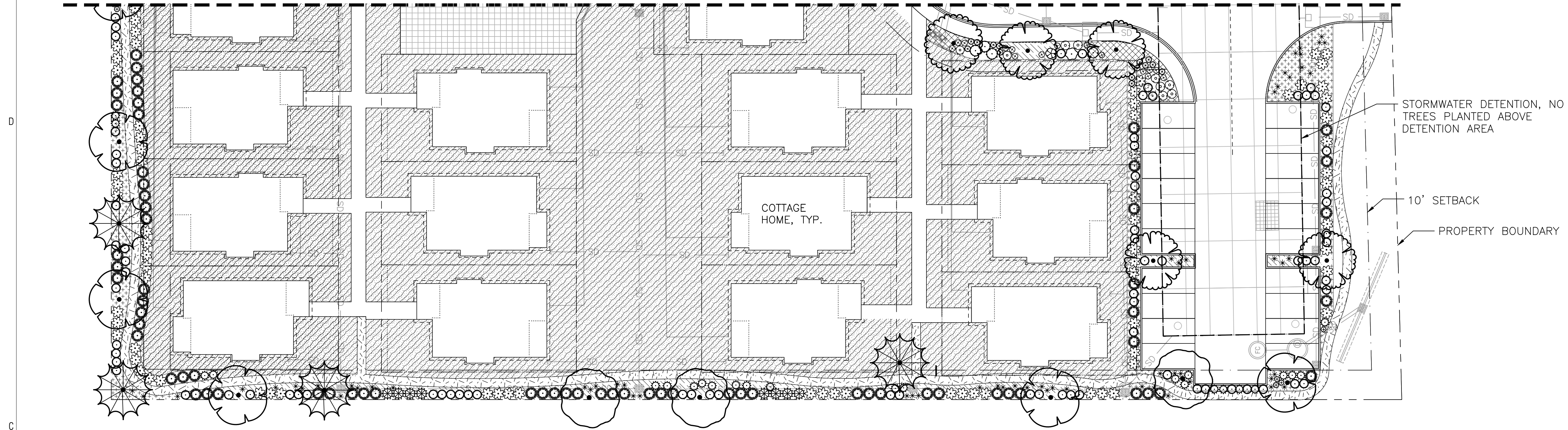

LEGEND

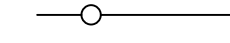
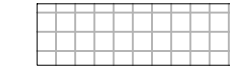
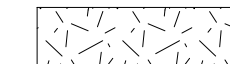
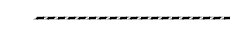
-  POST AND RAIL FENCE WITH WEDLAND SIGNAGE, POST 5 FT ON CENTER
-  PAVERS, SEE ARCHITECTURAL PLANS FOR DETAIL
-  LOOP TRAIL TO BE INSTALLED BY OWNER POST OCCUPANCY
-  ROOT BARRIER PER CITY STANDARDS

NOTES

1. REFER TO L1.2 FOR PLANT SCHEDULE

NAKANO ASSOCIATES
 LANDSCAPE ARCHITECTS
 3902 S. Ferdinand St.
 Seattle, WA 98118
 Tel: 206.292.9392
 www.nakanoassociates.com

architect
Schemata Workshop, Inc.
 1720 12th Avenue
 Seattle, WA 98122

CONTACT: Grace Kim, AIA
 v (206) 285.1589
 e grace@schemataworkshop.com

owner
King Creek LLC

2720 Hoyt Ave, Apt 119
 Everatt, WA 98201

CONTACT: Sherie Rzczkowski
 v (360) 510.3959
 e sherierenee@gmail.com

SUNNYSIDE VILLAGE

3121 66TH Ave NE
 Marysville, WA 98270

LAND USE PERMIT

08/22/22

NO.	DATE	DESCRIPTION

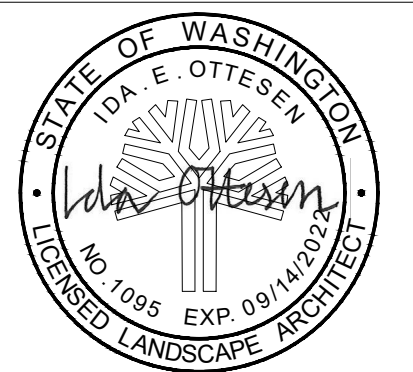

NOT FOR CONSTRUCTION

Architect Project No: 1819
 Author: BS/PG
 Checker: IO

PLANTING PLAN

L1.1

Copyright Schemata Workshop, Inc.

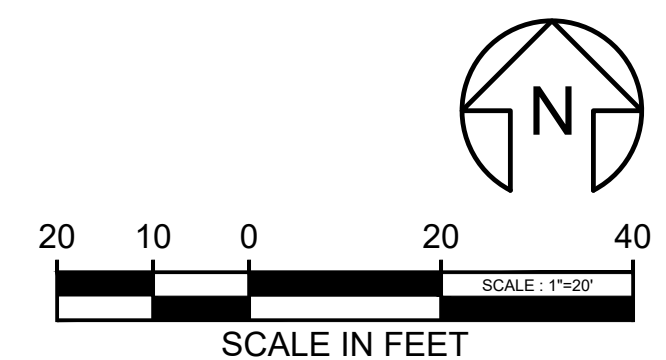

1 2 3 4 5

PLANT SCHEDULE

TREES	QTY	BOTANICAL / COMMON NAME	SIZE
	3	ACER CIRCINATUM VINE MAPLE	1.5" CAL, 6'-8' HT
	9	FRANGULA PURSHIANA CASCARA BUCKTHORN	1.5" CAL, 6'-8' HT
	14	MALUS X ZUMI 'CALOCARPA' REDBUD ZUMI CRABAPPLE	1.5" CAL, 6'-8' HT
	2	MORUS ALBA WHITE MULBERRY	1.5" CAL, 6'-8' HT
		NEIGHBORHOOD STREET FRUIT TREES	
	7	(1) MALUS DOMESTICA 'CENTENNIAL', CRABAPPLE (1) MALUS 'DOLGO', CRABAPPLE (1) PRUNUS ARMENIACA 'PUGET GOLD', APRICOT (1) PRUNUS ARMENIACA 'HARGLOW', APRICOT (1) DIOSPYRUS KAKI 'JIRO', PERSIMMON (1) DIOSPYRUS KAKI 'IZU', PERSIMMON	1.5" CAL, 6'-8' HT
		NUT TREES	
	4	(1) JUGLANS REGIA 'CASCADE', CASCADE ENGLISH WALNUT (1) JUGLANS REGIA 'CARPATHIAN', CARPATHIAN ENGLISH WALNUT (2) CASTANEA MOLLISSIMA, CHINESE CHESTNUT	1.5" CAL, 6'-8' HT
	15	NYSSA SYLVATICA TUPELO	1.5" CAL, 6'-8' HT
		ORCHARD FRUIT TREES	
	5	(2) MALUS X DOMESTICA 'YELLOW TRANSPARENT', YELLOW TRANSPARENT APPLE (1) MALUS X DOMESTICA 'LIBERTY', LIBERTY APPLE (1) PRUNUS DOMESTICA X INSITITIA 'REINE CLAUDE DOREE', GREENGAGE PLUM (1) PRUNUS DOMESTICA 'STANLEY', STANLEY PLUM	1.5" CAL, 6'-8' HT
	7	THUJA PPLICATA WESTERN RED CEDAR	6'-7' HT
SHRUBS	QTY	BOTANICAL / COMMON NAME	SIZE
	42	ARONIA MELANOCARPA BLACK CHOKEBERRY	2 GAL
	171	CORNUS SERICEA RED TWIG DOGWOOD	2 GAL
	11	RIBES NIGRUM 'BEN LOMOND' BEN LOMOND BLACK CURRANT	2 GAL
	12	RIBES NIGRUM 'MINAJ SMYRIOU' MINAJ SMYRIOU BLACK CURRANT	2 GAL
	13	RIBES SANGUINEUM RED FLOWERING CURRANT	2 GAL
	155	ROSA NUTKANA NOOTKA ROSE	2 GAL
	40	RUBUS PARVIFLORUS THIMBLEBERRY	2 GAL
	7	VACCINIUM CORYMBOSUM 'BLUECROP' BLUECROP Highbush BLUEBERRY	2 GAL
	35	VACCINIUM FORMOSUM 'SUNSHINE BLUE' COMPACT BLUEBERRY	2 GAL
	190	VACCINIUM OVATUM 'SCARLET OVATION' EVERGREEN HUCKLEBERRY	2 GAL
PERENNIALS/FERNS	QTY	BOTANICAL / COMMON NAME	SIZE
	22	CYNARA SCOLYMUS 'IMPROVED GREEN GLOBE' IMPROVED GREEN GLOBE ARTICHOKE	2 GAL
	80	IRIS TENAX OREGON IRIS	1 GAL

PLANT SCHEDULE

TREES	QTY	BOTANICAL / COMMON NAME	SIZE	
*	241	JUNCUS EFFUSUS PACIFICUS PACIFIC RUSH	1 GAL	
⊙	54	LAVANDULA ANGUSTIFOLIA 'HIDCOTE SUPERIOR' HIDCOTE SUPERIOR ENGLISH LAVENDER	2 GAL	
⊕	54	PHLOMIS RUSSELLIANA JERUSALEM SAGE	1 GAL	
⊗	15	RHEUM RHABBARBARUM 'CRIMSON RED' CRIMSON RED RHUBARB	1 GAL	
⊖	45	SALVIA OFFICINALIS 'BERGGARTEN' BERGGARTEN GARDEN SAGE	1 GAL	
GROUND COVERS	QTY	BOTANICAL / COMMON NAME	SIZE	SPACING
	1,205	ARCTOSTAPHYLOS UVA-URSI KINNIKINNICK	1 GAL	18" o.c.
	901	FRAGARIA VESCA WOODLAND STRAWBERRY	1 GAL	18" o.c.
	298	FRAGARIA X ANANASSA 'PUGET SUMMER' PUGET SUMMER STRAWBERRY	1 GAL	18" o.c.
	696	RUBUS HAYATA-KOIDZUMII CREEPING RASPBERRY	1 GAL	18" o.c.
	48,204 SF	TRIFOLIUM REPENS NEW ZEALAND WHITE CLOVER HYDROSEED	SEED	

LANDSCAPE NOTES

- ALL PLANTINGS REQUIRED BY FOR PERMIT SHALL BE MANUALLY IRRIGATED BY OWNER. REQUIRED PLANTINGS SHALL BE NO MORE THAN 75 FT FROM A QUICK COUPLING VALVE, YARD HYDRANT OR OTHER WATER SOURCE.
- ALL PLANTING BEDS TO RECEIVE 2 INCH DEPTH MULCH.
- SOILS IN LANDSCAPE BEDS SHALL HAVE A MINIMUM 10% ORGANIC MATTER CONTENT BY DRY WEIGHT AND BE DECOMPACTED TO MINIMUM 12" DEPTH PER POST-CONSTRUCTION SOIL STANDARDS, TO COMPLY WITH STORMWATER REQUIREMENTS FOR WESTERN WASHINGTON.
- ALL LANDSCAPE PLANTING AREAS SHALL BE GRADED TO DRAIN SURFACE WATER AWAY FROM BUILDINGS.
- CONTRACTOR SHALL BE FAMILIAR WITH LOCATIONS OF ALL ON-SITE UTILITIES PRIOR TO COMMENCING ANY LANDSCAPE WORK.
- ALL TREES SHALL HAVE STRAIGHT CENTRAL LEADER, SINGLE TRUNK, AND SYMMETRICAL BRANCHING UNLESS OTHERWISE NOTED.
- USE TRIANGULAR SPACING WHEN PLANTING GROUNDCOVER. TREES AND SHRUBS SHALL BE UNDER PLANTED WITH GROUNDCOVER WHERE GROUNDCOVER IS USED.
- VINE MAPLES SHALL BE MULT-STEM WITH 3 TO 4 STEMS.
- CONTRACTOR SHALL PROVIDE QUANTITY OF PLANTS THAT ARE REPRESENTED ON PLANTING PLAN. IF A DISCREPANCY BETWEEN PLAN AND PLANT SCHEDULE IS ENCOUNTERED, NOTIFY THE OWNER'S REPRESENTATIVE FOR CLARIFICATION IMMEDIATELY.

NAKANO ASSOCIATES
LANDSCAPE ARCHITECTS
3902 S. Ferdinand St.
Seattle, WA 98118
Tel: 206.292.9392
www.nakanoassociates.com

architect
Schemata Workshop, Inc.
1720 12th Avenue
Seattle, WA 98122

CONTACT: Grace Kim, AIA
v (206) 285.1589
e grace@schemataworkshop.com

owner
King Creek LLC

2720 Hoyt Ave, Apt 119
Everett, WA 98201

CONTACT: Sherie Rzeczkowski
v (360) 510.3959
e sherierenee@gmail.com

SUNNYSIDE VILLAGE

3121 66TH Ave NE
Marysville, WA 98270

LAND USE PERMIT

08/22/22

NO.	DATE	DESCRIPTION



Architect Project No: 1819
Author: BS/PG
Checker: IO

PLANTING SCHEDULE AND NOTES

L1.2

Copyright Schemata Workshop, Inc.



NOT FOR CONSTRUCTION