

GENERAL NOTES

THE GENERAL CONTRACTOR IS TO PROVIDE SUBGRADES 4" BELOW HARD SURFACES PLUS/MINUS .1 FOOT.
 ALL ROUGH GRADING SHALL BE POSITIVE, DRAINING AWAY FROM ALL STRUCTURES.
 ALL STONES LARGER THAN 1.5" DIAMETER SHALL BE REMOVED FROM THE GROWING MEDIUM.
 TOPSOIL SHALL BE PLACED AT A MINIMUM DEPTH OF 4" IN ALL LAWN AND BED AREAS.
 TOPSOIL SHALL BE TILLED INTO THE EXISTING SUBGRADE TO ELIMINATE SOIL INTERFACE PROBLEMS.
 TOPSOIL SHALL BE RED-E'S WINTER MIX OR APPROVED EQUAL.

ALL BED AREAS TO RECEIVE 2" OF FINE GROUND FIR OR HEMLOCK BARK, COMPOSITION MULCHES ARE NOT AN ACCEPTABLE ALTERNATIVE.

TREES AND SHRUBS ARE TO BE PLANTED AT A DEPTH 3/4" HIGHER THAN THE LEVEL THAT THEY WERE GROWN IN THE NURSERY.
 BARK MULCH IS NOT TO BE PLACED ABOVE THE ROOT CROWN.

ALL PLANTS SHALL AT LEAST CONFORM TO THE MINIMUM STANDARD ESTABLISHED BY THE AMERICAN ASSOCIATION OF NURSERYMEN.

LAWN AREAS ARE TO BE HYDROSEEDED WITH VAN DEN AKKER'S EMERALD VELVET MIX PER MANUFACTURER'S SPECIFICATIONS, OR APPROVED EQUAL. REMOVE ALL STONES LARGER THAN 1" FROM LAWN AREAS.

SUBSTITUTIONS ARE STRONGLY DISCOURAGED. IF PLANT AVAILABILITY IS A PROBLEM, CONTACT THE LANDSCAPE ARCHITECT FOR SOURCES OR ACCEPTABLE ALTERNATIVES.

IF THE SITE WORK IS DIFFERENT THAN SHOWN ON THE LANDSCAPE PLAN, OR POOR SOILS AND DEBRIS ARE DISCOVERED, REQUIRING CHANGES TO THE LANDSCAPE PLAN, CONTACT THE LANDSCAPE ARCHITECT FOR INSTRUCTION.

THE LANDSCAPE CONTRACTOR IS RESPONSIBLE FOR MAINTAINING THE LANDSCAPE DURING INSTALLATION, UNTIL FINAL ACCEPTANCE BY THE OWNER'S REPRESENTATIVE.

THE LANDSCAPE CONTRACTOR SHALL WARRANTY ALL MATERIALS AND WORKMANSHIP FOR A PERIOD OF ONE YEAR, FROM THE TIME OF FINAL ACCEPTANCE.

DURING THE WARRANTY PERIOD, THE LANDSCAPE CONTRACTOR WILL NOT BE RESPONSIBLE FOR PLANT DEATH CAUSED BY UNUSUAL CLIMATIC CONDITIONS, VANDALISM, THEFT, FIRE, OR POOR MAINTENANCE PRACTICES. THE LANDSCAPE ARCHITECT SHALL HAVE SOLE AUTHORITY TO DETERMINE THE CAUSE OF DEATH.

PLANT COUNTS PROVIDED ARE ESTIMATES ONLY. CONTRACTOR IS RESPONSIBLE FOR CALCULATING ALL FINAL AREA AND COUNTS.

IRRIGATION ASSESSMENT

SUPPLEMENTAL HAND WATERING MAY BE NECESSARY FOR THE FIRST GROWING SEASON TO ESTABLISH PLANTINGS, BUT MAY NOT BE NECESSARY IN SUBSEQUENT YEARS.

LANDSCAPE PLANTING SCHEDULE

TREES

SYMBOL	QTY	BOTANICAL / COMMON NAME	SIZE	CONDITION
	5	Acer rubrum 'Bowhall' / Bowhall Maple	2" CAL.	B&B
	6	Chamaecyparis nootkatensis 'Pendula' / Alaska Cedar	8' MIN. HT.	B&B
	12	Liquidambar styraciflua 'Worplesdon' / Sweetgum	2" CAL.	B&B
	23	Thuja plicata 'Excelsa' / Excelsa Cedar	6' MIN. HT.	B&B
	6	Acer palmatum / Japanese Maple	2" CAL.	B&B
	3	Lireodendron tulipifera 'Arnold' / Tulip Poplar	2" CAL.	B&B
	155	Thuja occidentalis 'Emerald Green' / Emerald Green Arborvitae	6' MIN. HT.	B&B

SHRUBS

SYMBOL	QTY	BOTANICAL / COMMON NAME	SIZE	CONDITION
	55	Prunus lusitanica / Portugal Laurel	21" MIN. HT.	Container Grown
	28	Rhododendron 'Ken Janek' / N.C.N.	21" MIN. HT.	Container Grown
	38	Spiraea 'Doubleplay Doozie' / Doozie Spirea	21" MIN. HT.	Container Grown
	53	Ilex crenata 'Convexa' / Japanese Holly	21" MIN. HT.	Container Grown
	40	Hemerocallis 'Happy Returns' / Day Lily	2 gallon	Container Grown
	24	Nepeta 'Prussian Blue' / Catmint	1 gallon	Container Grown
	36	Geranium 'Bevan's Variety' / Cranesbill	1 gallon	Container Grown

GROUND COVER

SYMBOL	QTY	BOTANICAL / COMMON NAME	SIZE	CONDITION
		Lonicera pileata / Box Leaf Honeysuckle	1 gallon	CON. GRWN, 30" O.C.
		Vinca minor / Common Periwinkle	4" POTS	CON. GRWN, 24" O.C.
		Microclover Hydroseed		

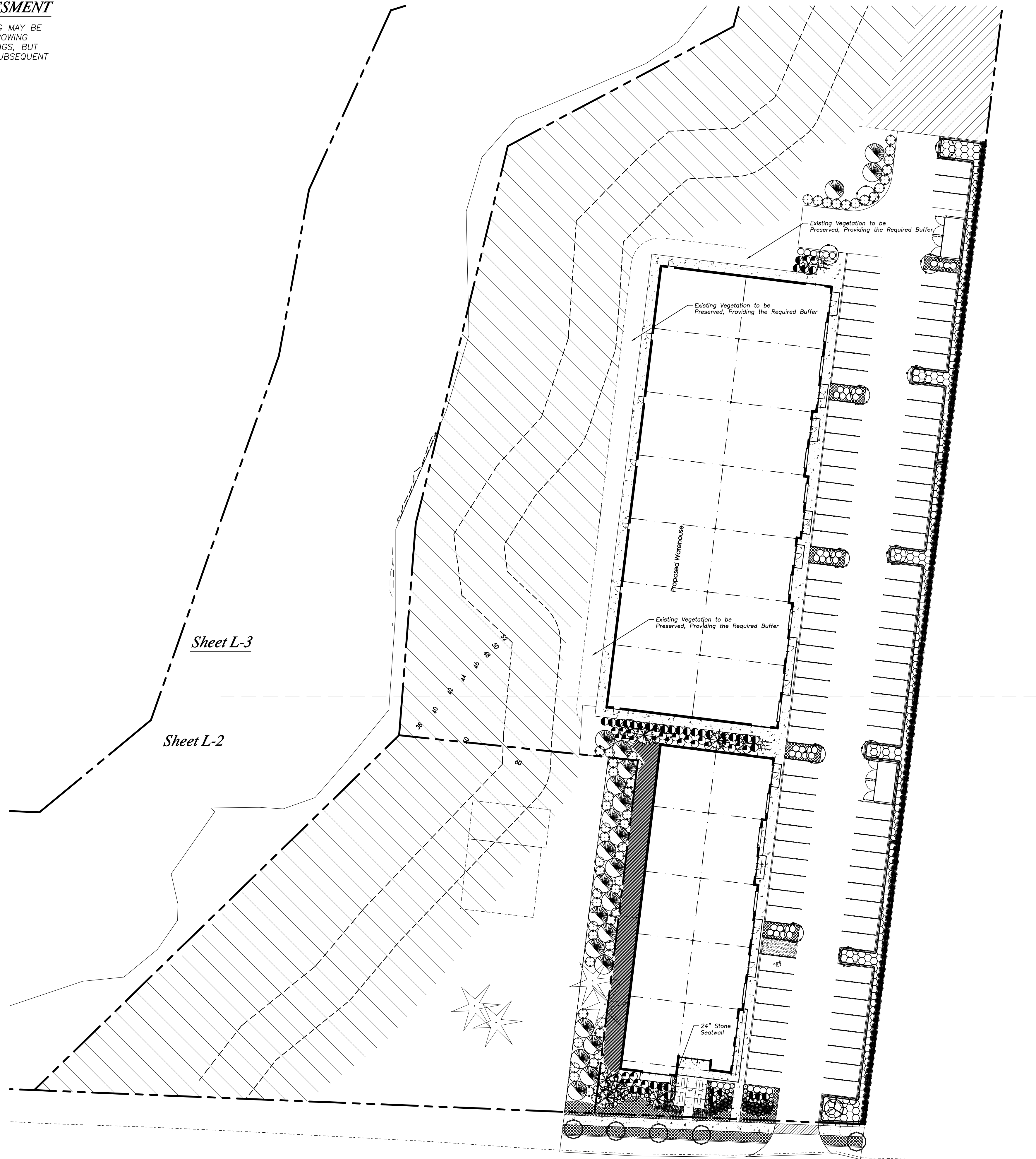

Sheet L-3

Sheet L-2

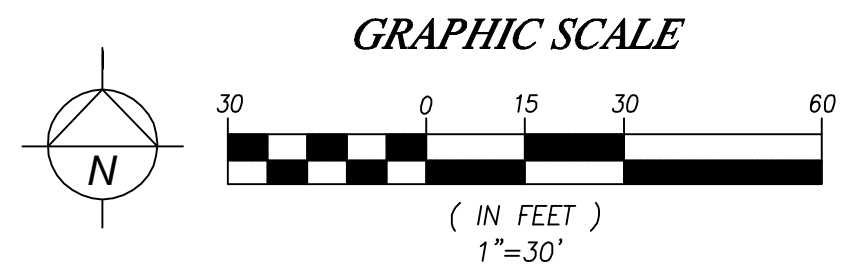

DATE	REVISION	BY

Paul Jay
 Landscape Architect
 1115 Bridge Road
 Eastham, MA 02642
 p. 360.659.8159
 c. 425.210.1986
 e. pauljay@aol.com



104th. Street Rezone
 Marysville WA
 LANDSCAPE PLAN

APPLICANT:
 Landtechnologies

DATE:
 5.24.22

PJLA JOB NO.:

DRAWN BY: PJ

CHECKED BY: PJ

LANDSCAPE PLAN

SHEET
L-1
 OF 3

GENERAL NOTES

THE GENERAL CONTRACTOR IS TO PROVIDE SUBGRADES 4" BELOW HARD SURFACES PLUS/MINUS .1 FOOT.
 ALL ROUGH GRADING SHALL BE POSITIVE, DRAINING AWAY FROM ALL STRUCTURES.
 ALL STONES LARGER THAN 1.5" DIAMETER SHALL BE REMOVED FROM THE GROWING MEDIUM.
 TOPSOIL SHALL BE PLACED AT A MINIMUM DEPTH OF 4" IN ALL LAWN AND BED AREAS.
 TOPSOIL SHALL BE TILLED INTO THE EXISTING SUBGRADE TO ELIMINATE SOIL INTERFACE PROBLEMS.
 TOPSOIL SHALL BE RED-E'S WINTER MIX OR APPROVED EQUAL.

ALL BED AREAS TO RECEIVE 2" OF FINE GROUND FIR OR HEMLOCK BARK, COMPOSITION MULCHES ARE NOT AN ACCEPTABLE ALTERNATIVE.

TREES AND SHRUBS ARE TO BE PLANTED AT A DEPTH 3/4" HIGHER THAN THE LEVEL THAT THEY WERE GROWN IN THE NURSERY.
 BARK MULCH IS NOT TO BE PLACED ABOVE THE ROOT CROWN.

ALL PLANTS SHALL AT LEAST CONFORM TO THE MINIMUM STANDARD ESTABLISHED BY THE AMERICAN ASSOCIATION OF NURSERYMEN.

LAWN AREAS ARE TO BE HYDROSEEDED WITH VAN DEN AKKER'S EMERALD VELVET MIX PER MANUFACTURER'S SPECIFICATIONS, OR APPROVED EQUAL. REMOVE ALL STONES LARGER THAN 1" FROM LAWN AREAS.

SUBSTITUTIONS ARE STRONGLY DISCOURAGED. IF PLANT AVAILABILITY IS A PROBLEM, CONTACT THE LANDSCAPE ARCHITECT FOR SOURCES OR ACCEPTABLE ALTERNATIVES.

IF THE SITE WORK IS DIFFERENT THAN SHOWN ON THE LANDSCAPE PLAN, OR POOR SOILS AND DEBRIS ARE DISCOVERED, REQUIRING CHANGES TO THE LANDSCAPE PLAN, CONTACT THE LANDSCAPE ARCHITECT FOR INSTRUCTION.

THE LANDSCAPE CONTRACTOR IS RESPONSIBLE FOR MAINTAINING THE LANDSCAPE DURING INSTALLATION, UNTIL FINAL ACCEPTANCE BY THE OWNER'S REPRESENTATIVE.

THE LANDSCAPE CONTRACTOR SHALL WARRANTY ALL MATERIALS AND WORKMANSHIP FOR A PERIOD OF ONE YEAR, FROM THE TIME OF FINAL ACCEPTANCE.

DURING THE WARRANTY PERIOD, THE LANDSCAPE CONTRACTOR WILL NOT BE RESPONSIBLE FOR PLANT DEATH CAUSED BY UNUSUAL CLIMATIC CONDITIONS, VANDALISM, THEFT, FIRE, OR POOR MAINTENANCE PRACTICES. THE LANDSCAPE ARCHITECT SHALL HAVE SOLE AUTHORITY TO DETERMINE THE CAUSE OF DEATH.

PLANT COUNTS PROVIDED ARE ESTIMATES ONLY. CONTRACTOR IS RESPONSIBLE FOR CALCULATING ALL FINAL AREA AND COUNTS.

IRRIGATION ASSESSMENT

SUPPLEMENTAL HAND WATERING MAY BE NECESSARY FOR THE FIRST GROWING SEASON TO ESTABLISH PLANTINGS, BUT MAY NOT BE NECESSARY IN SUBSEQUENT YEARS.

LANDSCAPE PLANTING SCHEDULE

TREES

SYMBOL	QTY	BOTANICAL / COMMON NAME	SIZE	CONDITION
	5	Acer rubrum 'Bowhall' / Bowhall Maple	2" CAL.	B&B
	6	Chamaecyparis nootkatensis 'Pendula' / Alaska Cedar	8' MIN. HT.	B&B
	12	Liquidambar styraciflua 'Worplesdon' / Sweetgum	2" CAL.	B&B
	23	Thuja plicata 'Excelsa' / Excelsa Cedar	6' MIN. HT.	B&B
	6	Acer palmatum / Japanese Maple	2" CAL.	B&B
	3	Liriodendron tulipifera 'Arnold' / Tulip Poplar	2" CAL.	B&B
	155	Thuja occidentalis 'Emerald Green' / Emerald Green Arborvitae	6' MIN. HT.	B&B

SHRUBS

SYMBOL	QTY	BOTANICAL / COMMON NAME	SIZE	CONDITION
	55	Prunus lusitanica / Portugal Laurel	21" MIN. HT.	Container Grown
	28	Rhododendron 'Ken Janek' / N.C.N.	21" MIN. HT.	Container Grown
	38	Spiraea 'Doubleplay Doozie' / Doozie Spirea	21" MIN. HT.	Container Grown
	53	Ilex crenata 'Convexa' / Japanese Holly	21" MIN. HT.	Container Grown
	40	Hemerocallis 'Happy Returns' / Day Lily	2 gallon	Container Grown
	24	Nepeta 'Prussian Blue' / Catmint	1 gallon	Container Grown
	36	Geranium 'Bevan's Variety' / Cranesbill	1 gallon	Container Grown

GROUND COVER

SYMBOL	QTY	BOTANICAL / COMMON NAME	SIZE	CONDITION
		Lonicera pileata / Box Leaf Honeysuckle	1 gallon	CON. GRWN, 30" O.C.
		Vinca minor / Common Periwinkle	4" POTS	CON. GRWN, 24" O.C.
		Microclover Hydroseed		

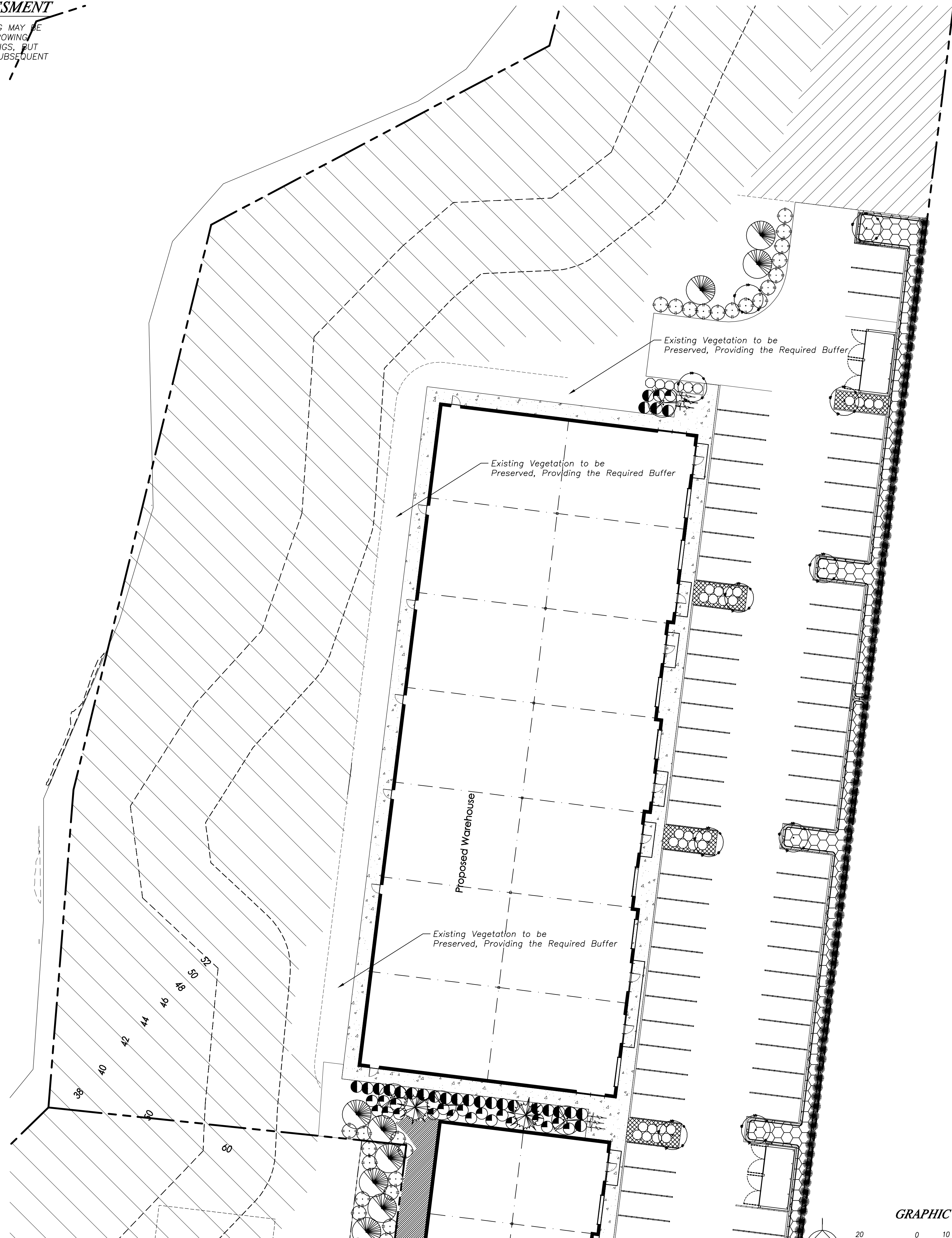

DATE	REVISION	BY

Paul Jay
 Landscape Architect
 1115 Bridge Road
 Eastham, MA 02642
 p. 360.659.8159
 c. 425.210.1986
 e. pauljay@gmail.com



104th. Street Rezone
 Marysville WA
 LANDSCAPE PLAN

APPLICANT:
 Landtechnologies

DATE:
 5.18.22

PJLA JOB NO.:
 DRAWN BY: PJ

CHECKED BY: PJ

LANDSCAPE PLAN

SHEET
L-3
 OF 3