

SW 1/4 SECTION 35, TOWNSHIP 30 N, RANGE 5 E, W.M.
MARYSVILLE - 44TH PRD

HORIZONTAL DATUM: (PER CORE DESIGN)

NAD83(2011) EPOCH 2010

VERTICAL DATUM: (PER CORE DESIGN)

NAVD88 PER GNSS OBSERVATIONS

BENCHMARKS: (PER CORE DESIGN)

FOUND 2" BRASS DISK IN CONCRETE MONUMENT STAMPED "LS#30427" DOWN 0.30 IN CASE. INTERSECTION OF 46TH PLACE NE AND 75TH AVENUE NE.
 ELEVATION=313.42

BASIS OF BEARINGS: (PER CORE DESIGN)

N01°03'22"E ALONG THE EAST LINE OF THE SOUTHWEST QUARTER OF SECTION 35, TOWNSHIP 30, RANGE 5 E, W.M. PER REF. 2.

REFERENCES: (PER CORE DESIGN)

1. CITY OF MARYSVILLE BLA NO. BLA 19-004, RECORDED UNDER SNOHOMISH COUNTY AUDITOR'S FILE NO. 201910295002.
 2. RECORD OF SURVEY RECORDED IN BOOK 4 OF SURVEYS, PAGE 166, UNDER SNOHOMISH COUNTY AUDITOR'S FILE NO. 7609290248.

LEGAL DESCRIPTION: (PER CORE DESIGN)

TPN: 30053500303600
 LOT 7 OF THAT SURVEY RECORDED IN BOOK 4 OF SURVEYS, PAGE 166, UNDER AUDITOR'S FILE NO. 7609290248, BEING A PORTION OF THE SOUTHEAST QUARTER OF THE SOUTHWEST QUARTER OF SECTION 35, TOWNSHIP 30 NORTH, RANGE 5 EAST, W.M.
 SITUATE IN THE COUNTY OF SNOHOMISH, STATE OF WASHINGTON.

TPN: 30053500303700
 LOT 8 OF THAT SURVEY RECORDED IN BOOK 4 OF SURVEYS, PAGE 166, UNDER AUDITOR'S FILE NO. 7609290248, BEING A PORTION OF THE SOUTHEAST QUARTER OF THE SOUTHWEST QUARTER OF SECTION 35, TOWNSHIP 30 NORTH, RANGE 5 EAST, W.M.
 SITUATE IN THE COUNTY OF SNOHOMISH, STATE OF WASHINGTON.

EXCEPTIONS CONTAINED IN TITLE: (PER CORE DESIGN)

TPN: 30053500303600, COMMITMENT NO. 500126919

- THIS SITE IS SUBJECT TO A WATER LINE EASEMENT AND THE RIGHTS INCIDENTAL THERETO AS DISCLOSED BY INSTRUMENT RECORDED UNDER SNOHOMISH COUNTY AUDITOR'S FILE NO. 1226499. (SHOWN HEREON)
- THIS SITE IS SUBJECT TO A RELEASE OF DAMAGES AND THE TERMS AND CONDITIONS THEREOF AS DISCLOSED BY INSTRUMENT RECORDED UNDER SNOHOMISH COUNTY AUDITOR'S FILE NO. 2093460. (NOTHING TO PLOT)
- THIS SITE IS SUBJECT TO COVENANTS, CONDITIONS, RESTRICTIONS, RECITALS, RESERVATIONS, EASEMENTS, EASEMENT PROVISIONS, DEDICATIONS, BUILDING SETBACK LINES, NOTES, STATEMENTS, AND OTHER MATTERS AS SET FORTH BY SURVEY RECORDED UNDER SNOHOMISH COUNTY AUDITOR'S FILE NUMBER 7609290248.
- THIS SITE IS SUBJECT TO A WATER LINE EASEMENT AND THE RIGHTS INCIDENTAL THERETO AS DISCLOSED BY INSTRUMENT RECORDED UNDER SNOHOMISH COUNTY AUDITOR'S FILE NO. 7911210154.
- THIS SITE IS SUBJECT TO COVENANTS, CONDITIONS, RESTRICTIONS, RECITALS, RESERVATIONS, EASEMENTS, EASEMENT PROVISIONS, DEDICATIONS, BUILDING SETBACK LINES, NOTES, STATEMENTS, AND OTHER MATTERS AS SET FORTH ON PURPORTED CITY OF MARYSVILLE BOUNDARY LINE ADJUSTMENT NO. 19-004 RECORDED UNDER SNOHOMISH COUNTY AUDITOR'S FILE NUMBER 201910295002. (PROPOSED LOT LINE SHOWN HEREON)

TPN: 30053500303700, COMMITMENT NO. 500126920

- THIS SITE IS SUBJECT TO A RELEASE OF DAMAGES AND THE TERMS AND CONDITIONS THEREOF AS DISCLOSED BY INSTRUMENT RECORDED UNDER SNOHOMISH COUNTY AUDITOR'S FILE NO. 2093460. (NOTHING TO PLOT)
- THIS SITE IS SUBJECT TO COVENANTS, CONDITIONS, RESTRICTIONS, RECITALS, RESERVATIONS, EASEMENTS, EASEMENT PROVISIONS, DEDICATIONS, BUILDING SETBACK LINES, NOTES, STATEMENTS, AND OTHER MATTERS AS SET FORTH BY SURVEY RECORDED UNDER SNOHOMISH COUNTY AUDITOR'S FILE NUMBER 7609290248.
- THIS SITE IS SUBJECT TO AN UNDERGROUND ELECTRIC TRANSMISSION AND DISTRIBUTION LINE EASEMENT AND THE RIGHTS INCIDENTAL THERETO AS DISCLOSED BY INSTRUMENT RECORDED UNDER SNOHOMISH COUNTY AUDITOR'S FILE NO. 7809200175. (SHOWN HEREON)
- THIS SITE IS SUBJECT TO A TIGHT LINE AND DRAINFIELD EASEMENT AND THE RIGHTS INCIDENTAL THERETO AS DISCLOSED BY INSTRUMENT RECORDED UNDER SNOHOMISH COUNTY AUDITOR'S FILE NO. 8002190104. SAID EASEMENT IS A RE-RECORDING OF EASEMENT RECORDED UNDER AUDITOR'S FILE NO. 7911210153. (APPROXIMATE LOCATION SHOWN HEREON)
- THIS SITE IS SUBJECT TO COVENANTS, CONDITIONS, RESTRICTIONS, RECITALS, RESERVATIONS, EASEMENTS, EASEMENT PROVISIONS, DEDICATIONS, BUILDING SETBACK LINES, NOTES, STATEMENTS, AND OTHER MATTERS AS SET FORTH ON PURPORTED CITY OF MARYSVILLE BOUNDARY LINE ADJUSTMENT NO. 19-004 RECORDED UNDER SNOHOMISH COUNTY AUDITOR'S FILE NUMBER 201910295002. (PROPOSED LOT LINE SHOWN HEREON)
- THIS SITE IS SUBJECT TO AN INGRESS, EGRESS AND UTILITIES EASEMENT AND THE RIGHTS INCIDENTAL THERETO AS DISCLOSED BY INSTRUMENT RECORDED UNDER SNOHOMISH COUNTY AUDITOR'S FILE NO. 20191029273. (SHOWN HEREON)

NOTES: (PER CORE DESIGN)

- ALL TITLE INFORMATION SHOWN ON THIS MAP HAS BEEN EXTRACTED FROM CHICAGO TITLE COMPANY OF WASHINGTON COMMITMENT NO. 500126920 AND 500126919 BOTH DATED SEPTEMBER 6, 2021. IN PREPARING THIS MAP, CORE DESIGN, INC. HAS CONDUCTED NO INDEPENDENT TITLE SEARCH NOR IS CORE DESIGN, INC. AWARE OF ANY TITLE ISSUES AFFECTING THE SURVEYED PROPERTY OTHER THAN THOSE SHOWN ON THE MAP AND DISCLOSED BY THE REFERENCED CHICAGO TITLE COMPANY OF WASHINGTON COMMITMENTS. CORE DESIGN, INC. HAS RELIED WHOLLY ON CHICAGO TITLE COMPANY OF WASHINGTON'S REPRESENTATIONS OF THE TITLE'S CONDITION TO PREPARE THIS SURVEY AND THEREFORE CORE DESIGN, INC. QUALIFIES THE MAP'S ACCURACY AND COMPLETENESS TO THAT EXTENT.
- THIS SURVEY REPRESENTS VISIBLE PHYSICAL IMPROVEMENT CONDITIONS EXISTING ON OCTOBER 13, 2021. ALL SURVEY CONTROL INDICATED AS "FOUND" WAS RECOVERED FOR THIS PROJECT IN OCTOBER, 2021.
- PROPERTY AREA = 407,865± SQUARE FEET (9.3633± ACRES).
- ALL DISTANCES ARE IN US FEET AT GROUND LEVEL.
- CONTOUR INTERVAL = 2 FEET.
- ELEVATION AND/OR CONTOUR INFORMATION SHOWN HEREON IS GENERATED FROM DIRECT FIELD OBSERVATION. SAID INFORMATION MEETS US NATIONAL MAPPING STANDARDS AND IS ACCURATE TO WITHIN ONE-HALF THE CONTOUR INTERVAL.
- BOUNDARY INFORMATION SHOWN HEREON IS DERIVED FROM OBSERVATION OF CONTROLLING MONUMENTATION AND INTERPRETATION OF RECORD DESCRIPTIONS AND OTHER EVIDENCE. TOPOGRAPHIC INFORMATION SHOWN HEREON IS RELATED TO THE BOUNDARY BY DIRECT FIELD OBSERVATION FROM CONTROLLING MONUMENTATION.
- THIS IS A COMBINED FIELD TRAVERSE AND GPS/GNSS SURVEY. A THREE SECOND COMBINED ELECTRONIC TOTAL STATION AND GPS/GNSS UNIT WITH OPUS/WSRN CORRECTIONS WERE USED TO MEASURE THE ANGULAR AND DISTANCE RELATIONSHIPS BETWEEN THE CONTROLLING MONUMENTATION AS SHOWN. CLOSURE RATIOS OF THE TRAVERSE MET OR EXCEEDED THOSE SPECIFIED IN WAC 332-130-090. ALL MEASURING INSTRUMENTS AND EQUIPMENT ARE MAINTAINED IN ADJUSTMENT ACCORDING TO MANUFACTURER'S SPECIFICATIONS.
- UTILITIES OTHER THAN THOSE SHOWN MAY EXIST ON THIS SITE. ONLY THOSE UTILITIES WITH EVIDENCE OF THEIR INSTALLATION VISIBLE AT GROUND SURFACE OR AS MARKED BY 811 OR OTHER UTILITY LOCATING PROVIDERS ARE SHOWN HEREON. UNDERGROUND UTILITY LOCATIONS SHOWN ARE APPROXIMATE ONLY. UNDERGROUND CONNECTIONS ARE SHOWN AS STRAIGHT LINES BETWEEN SURFACE EVIDENCE OF UTILITY LOCATIONS BUT MAY CONTAIN BENDS OR CURVES NOT SHOWN. SOME UNDERGROUND LOCATIONS SHOWN HEREON MAY HAVE BEEN TAKEN FROM PUBLIC RECORDS. CLIENT UNDERSTANDS THAT CORE DESIGN ASSUMES NO LIABILITY FOR THE ACCURACY OF PUBLIC RECORDS OR PAINTED UTILITY LOCATIONS.

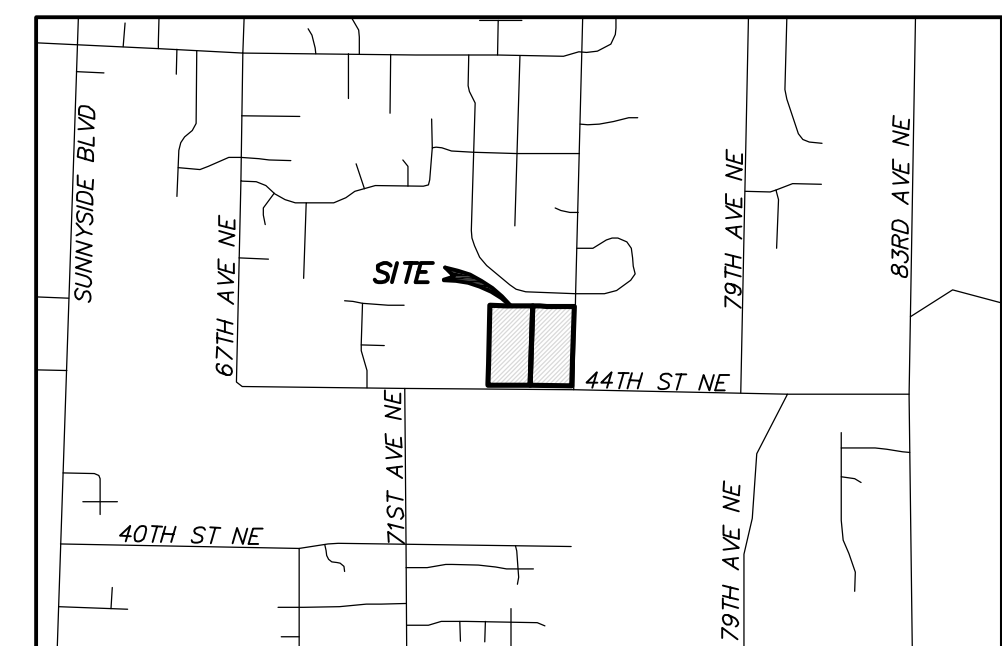

VICINITY MAP
 1"=1,500'

PROJECT CONTACTS:

- APPLICANT/OWNER..... TOLL BROS., INC.
 8815 - 122ND AVE NE, STE 200
 KIRKLAND, WA 98133
 (425) 825-1955
 CONTACT: AARON HOLLINGBERY
- CIVIL ENGINEER..... D.R. STRONG CONSULTING ENGINEERS, INC.
 620 7TH AVE
 KIRKLAND, WASHINGTON 98033
 (425) 827-3063
 CONTACT: LUAY R. JOUDEH, P.E.
 LUAY.JOUEH@DRSTRONG.COM
- SURVEYOR..... CORE DESIGN
 12100 NE 195TH ST, STE 300
 BOTHELL, WASHINGTON 98011
 (425) 888-7877
 CONTACT: GLENN R. SPAGUE, P.L.S.
- GEOTECHNICAL ENGINEER..... ROBINSON NOBLE
 17625 - 130TH AVE NE, STE 102
 WOODINVILLE, WASHINGTON 98072
 (425) 488-0599
 CONTACT: RYAN MINKEL, GIT
- LANDSCAPE ARCHITECT..... VARLEY VARLEY VARLEY
 12743 NE 170TH LANE
 WOODINVILLE, WASHINGTON 98072
 (425) 466-9430
 CONTACT: JEFF VARLEY
 VARLEY_JEFF@HOTMAIL.COM
- WETLAND BIOLOGIST..... RAEDEKE
 2111 N. NORTHGATE WAY STE
 SEATTLE, WASHINGTON 98133
 (425) 466-9430
 CONTACT: (206) 525-8122
 ACLARK@RAEDEKE.COM

PROJECT DESCRIPTION:

- ADDRESS OF THE PROPERTY..... 7315 & 7417 - 44TH ST NE
 PARCEL NUMBERS..... 3005350030-3600-3700
 SITE ACREAGE..... 407,865 SF
 ROW, AUTOCOURTS..... 73,928 SF
 UTILITY EASEMENTS 30' WIDE OR GREATER..... 18,632 SF
 NET PROJECT ACREAGE (MMC 22A.020.150)..... 315,305 SF (7.28 AC)
 EXISTING ZONING..... R-6.5
 PROPOSED DENSITY..... 4.81 DU/ACRE
 ALLOWABLE DWELLING UNITS..... 47
 PROPOSED DWELLING UNITS..... 35
 MAXIMUM IMPERVIOUS SURFACE..... 70%
 MINIMUM LOT AREA..... 3,500 SF
 DRIVEWAY LENGTH..... 20 FEET
 PARKING REQUIRED..... 3 STALLS PER DWELLING
 PARKING PROVIDED..... 4 STALLS PER DWELLING
 PROPOSED USE..... BSP/PRD
 SEWER AND WATER DISTRICT..... CITY OF MARYSVILLE
 SCHOOL DISTRICT..... MARYSVILLE SCHOOL DISTRICT 25
 FIRE DISTRICT..... MARYSVILLE FIRE DISTRICT RFA
 TELEPHONE SERVICE..... FRONTIER
 POWER SOURCE..... SNOHOMISH COUNTY PUD

SHEET INDEX:

C1 OF 8	PRELIMINARY PLAT
C2 OF 8	CONCEPTUAL ROAD, GRADING AND STORM DRAINAGE PLAN
C3 OF 8	ROAD CROSS SECTIONS
C4 OF 8	CONCEPTUAL ROAD PROFILE
C5 OF 8	CONCEPTUAL ROAD PROFILES
C6 OF 8	CONCEPTUAL STORM DRAINAGE PLAN
C7 OF 8	CONCEPTUAL WATER PLAN
C8 OF 8	CONCEPTUAL SEWER PLAN

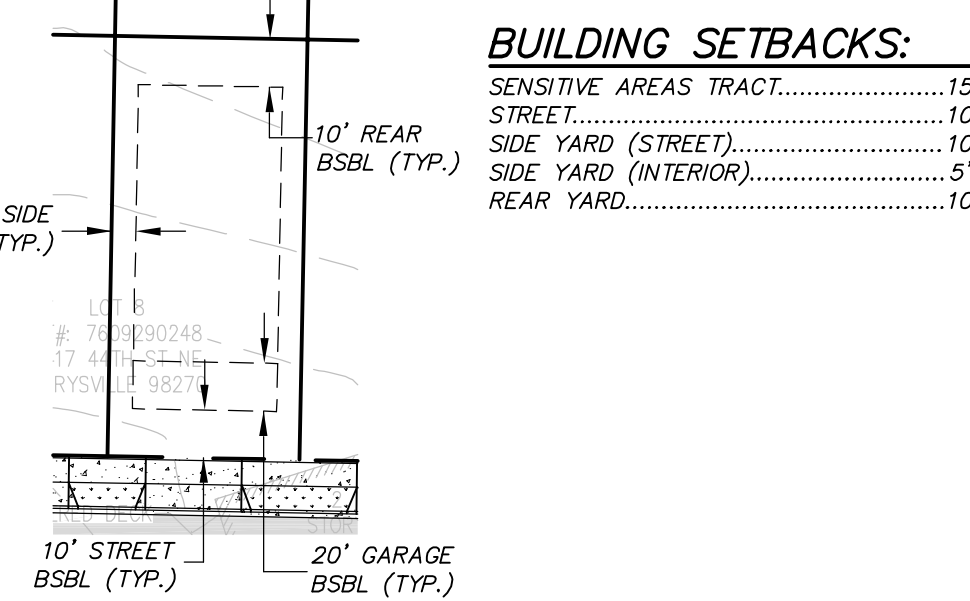

OPEN SPACE CALCULATIONS:

PRD OPEN SPACE REQUIREMENTS PER MMC 22C.080.100

NET PROJECT AREA (MMC 22A.020.150)	317,954 SF
TRACT 998 (STORM DRAINAGE & RECREATION)	25,059 SF
TRACT 997 (WETLAND & BUFFERS)	182,021 SF
TRACT 996 (OPEN SPACE)	4,787 SF
TOTAL OPEN SPACE	211,867 SF
REQUIRED OPEN SPACE (15% OF NET PROJECT AREA)	47,693 SF
MAX. OPEN SPACE IN CRITICAL AREA (65% REQUIRED OPEN SPACE)	31,000 SF
ACTIVE OPEN SPACE (35% OF REQUIRED)	16,693 SF

TRACTS

NAME	DESIGNATION	AREA
TRACT 999	AUTOCOURT	3,900 S.F.
TRACT 998	STORM DRAINAGE/OPEN SPACE	25,059 S.F.
TRACT 997	WETLANDS & BUFFERS	182,021 S.F.
TRACT 996	OPEN SPACE	4,787 S.F.
TRACT 995	AUTOCOURT	2,163 S.F.

SOIL TYPE AND VEGETATIVE COVER:

SOILS: TOKUL GRAVELLY MEDIAL LOAM, 0-8% SLOPES
 TOKUL GRAVELLY MEDIAL LOAM, 8-15% SLOPES
 VEGETATIVE COVER: PRIMARILY FORESTED

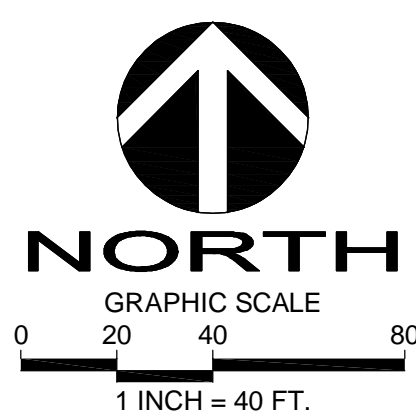

DRS
 D.R. STRONG
 CONSULTING ENGINEERS
 ENGINEERS PLANNERS SURVEYORS
 620 - 7th AVENUE KIRKLAND, WA 98033
 © 425.827.3063 F 425.827.3423

MARYSVILLE - 44TH PRD
 PRELIMINARY PLAT
 7315 & 7417 - 44TH ST NE
 MARYSVILLE, WA
 PARCELS 3005350030-3600-3700

TOLL BROS., INC
 8815 - 122ND AVE NE, STE 200
 KIRKLAND, WA 98033
 (425) 825-1955

LUAY R. JOUDEH
 STATE REGISTERED PROFESSIONAL ENGINEER
 10.5.22

APR LRU LRU
 REVISION PER CITY COMMENTS PER CITY COMMENTS
 DATE 06.29.22 09.15.22

DRAFTED BY: ZLJ
 DESIGNED BY: LRU
 PROJECT ENGINEER: LRU
 DATE: 05-12-22
 PROJECT NO.: 21101

DRAWING: C1
 SHEET: 1 OF 8

SW 1/4 SECTION 35, TOWNSHIP 30 N, RANGE 5 E, W.M.
MARYSVILLE - 44TH PRD

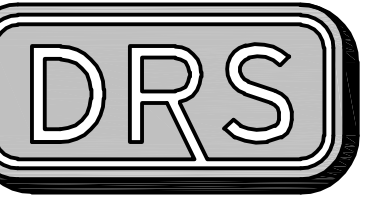

D.R. STRONG
 CONSULTING ENGINEERS
 ENGINEERS PLANNERS SURVEYORS
 620 - 7th AVENUE KIRKLAND, WA 98033
 O 425.827.3065 F 425.827.2423

MARYSVILLE - 44TH PRD

CONCEPTUAL ROAD AND GRADING PLAN
 7315 & 7417 - 44TH ST NE
 MARYSVILLE, WA
 PARCELS 3005350030-3600-3700

TOLL BROS., INC

8815 - 122ND AVE NE, STE 200
 KIRKLAND, WA 98033
 (425) 825-1955



DATE	06-29-22	REVISION	PER CITY COMMENTS
DATE	09-15-22	REVISION	PER CITY COMMENTS
DATE	APR	REVISION	LRJ
DATE	APR	REVISION	LRJ

DRAFTED BY: ZLJ
 DESIGNED BY: LRJ
 PROJECT ENGINEER: LRJ
 DATE: 05-12-22
 PROJECT NO.: 21101

DRAWING: **C2**
 SHEET: **2** OF **8**

SITE VOLUME CALCULATIONS		
CUT VOLUME (CU. YDS.)	FILL VOLUME (CU. YDS.)	NET VOLUME (CU. YDS.)
19,348	22,417	3,069 FILL

ALL VOLUMES ARE APPROXIMATE AND ARE PROVIDED FOR PERMITTING PURPOSES AND REPRESENT FINISH GRADE TO EXISTING GRADE AS SHOWN. CONTRACTOR SHALL RELY ON HIS/HER OWN ESTIMATES FOR DETERMINING ACTUAL EARTHWORK QUANTITIES. THE VOLUMES DO NOT INCLUDE STRIPPING, STRUCTURAL EXCAVATION, EXPANSION/COMPACTION FACTOR OR ANY SOIL TYPE RESTRICTIONS.

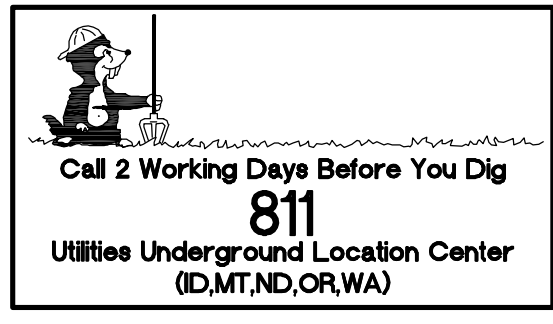
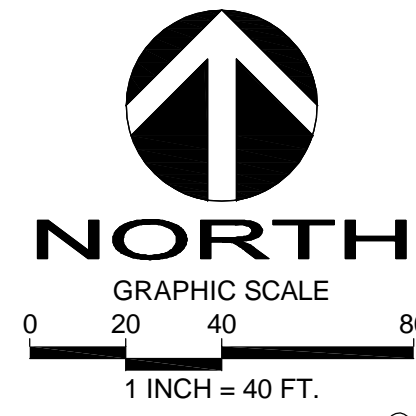
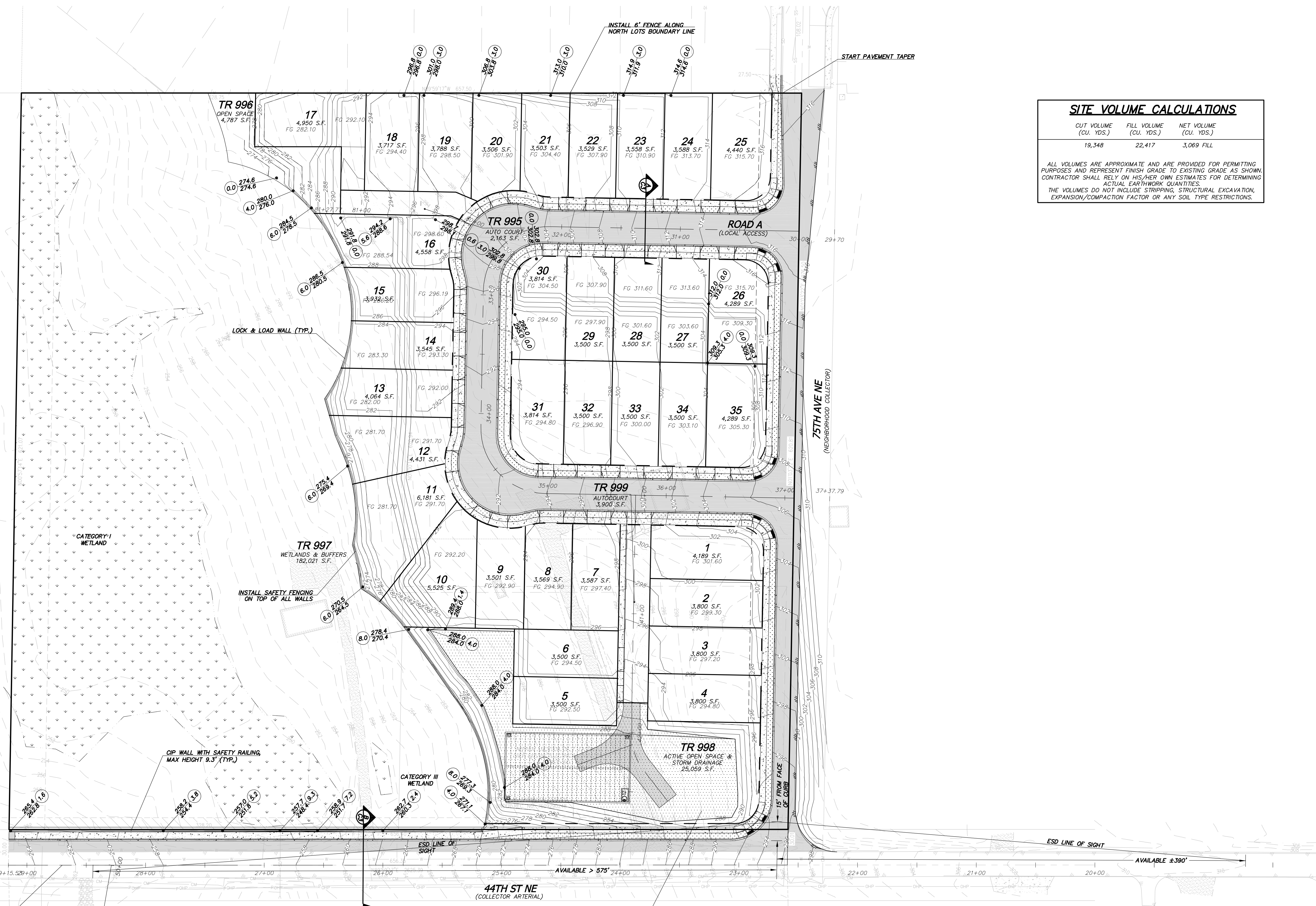

P:\2022\11\21\001_U3\Drawings\002\101_02_3005350030-3600-3700.dwg 10/17/2022 3:15:02 PM

SW 1/4 SECTION 35, TOWNSHIP 30 N, RANGE 5 E, W.M.
MARYSVILLE - 44TH PRD

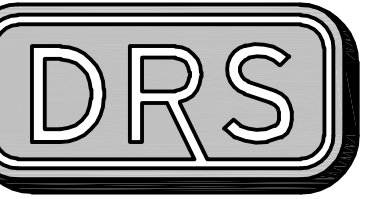

D.R. STRONG
 CONSULTING ENGINEERS
 ENGINEERS PLANNERS SURVEYORS
 620 - 7th AVENUE KIRKLAND, WA 98033
 O 425.827.3063 F 425.827.3423

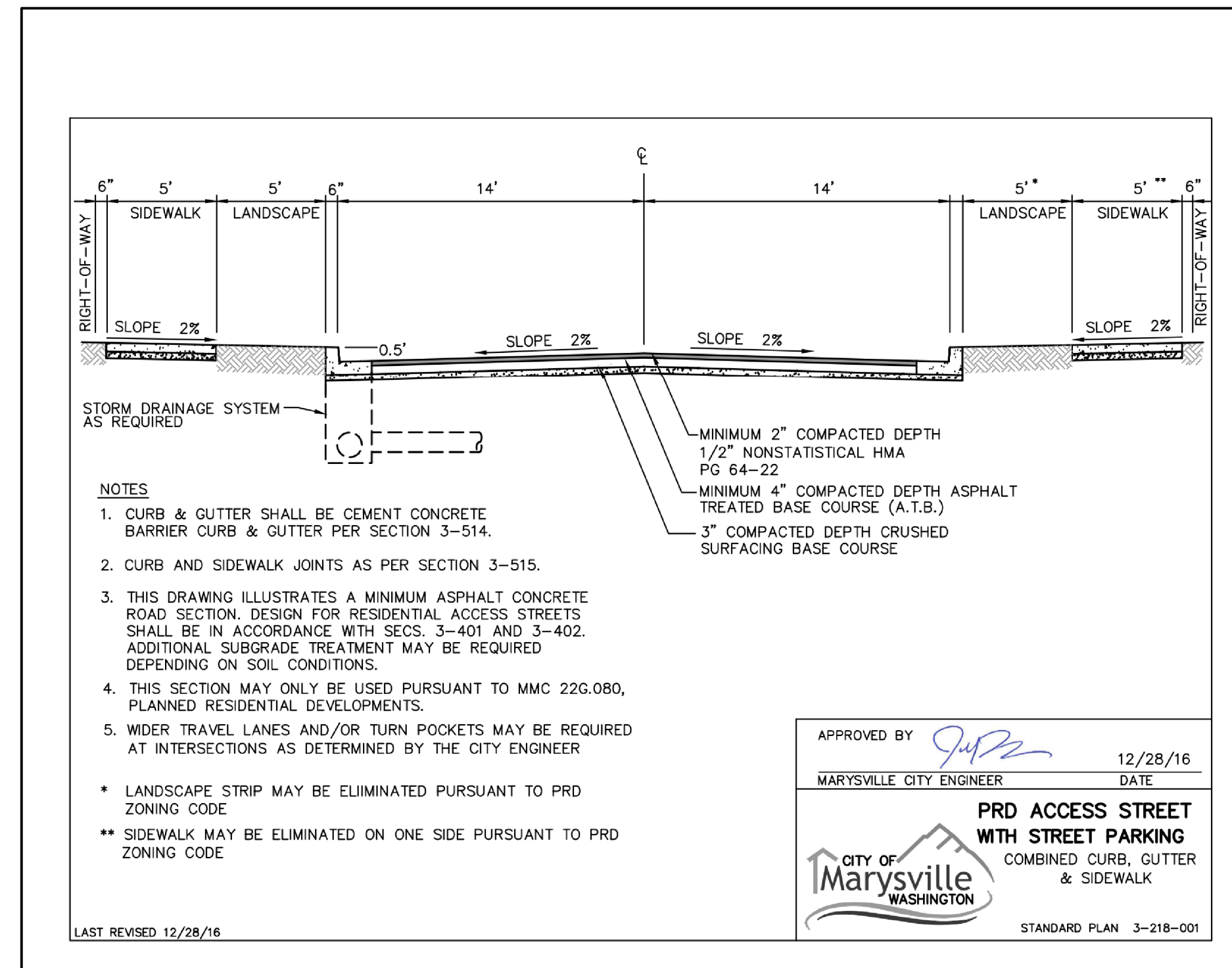

ROAD A

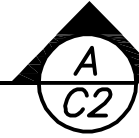

MARYSVILLE - 44TH PRD

ROAD CROSS SECTIONS
 7315 & 7417 - 44TH ST NE
 MARYSVILLE, WA
 PARCELS 3005350030-3600,-3700

TOLL BROS., INC

8815 - 122ND AVE NE, STE 200
 KIRKLAND, WA 98033
 (425) 825-1955



10.5.22

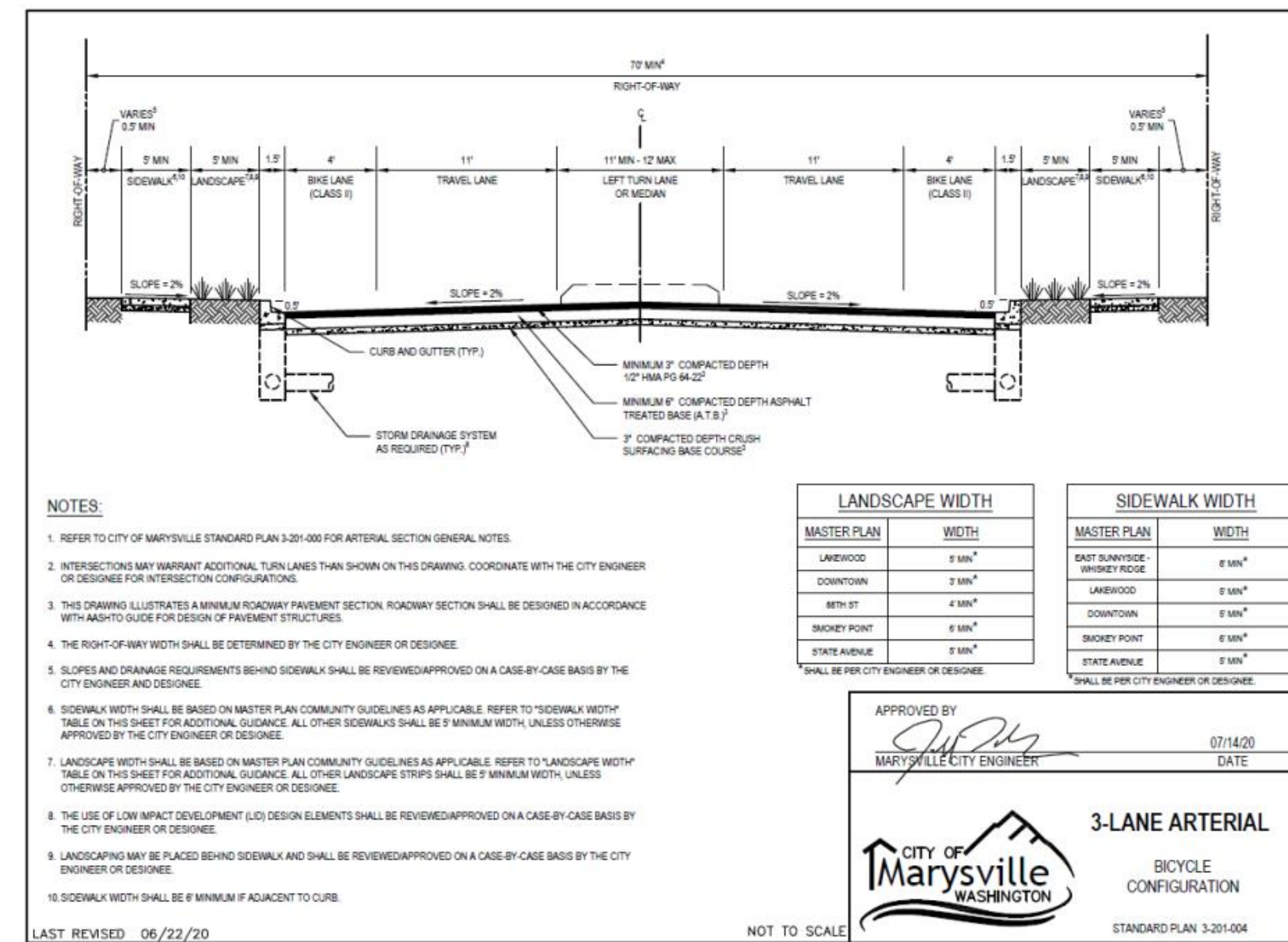

44TH AVE NE

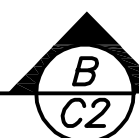

A: \\0221\1\21101_1\Drawings\Plans\03-3005350030-3600-3700-4-28-21.dwg 10/26/2022 4:26:51 PM

DRAFTED BY: ZLJ
 DESIGNED BY: LRJ
 PROJECT ENGINEER: LRU
 DATE: 05-12-22
 PROJECT NO.: 21101

DRAWING: **C3**
 SHEET: **3** OF **8**

SW 1/4 SECTION 35, TOWNSHIP 30 N, RANGE 5 E, W.M.
MARYSVILLE - 44TH PRD

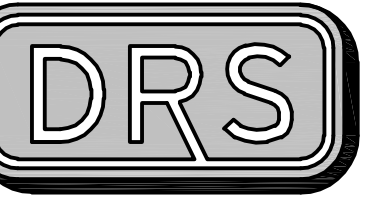

D.R. STRONG
 CONSULTING ENGINEERS
 ENGINEERS PLANNERS SURVEYORS
 620 - 7th AVENUE KIRKLAND, WA 98033
 O 425.827.3065 F 425.827.2423

MARYSVILLE - 44TH PRD

CONCEPTUAL ROAD PROFILES
 7315 & 7417 - 44TH ST NE
 MARYSVILLE, WA
 PARCELS 3005350030-3600,-3700

TOLL BROS., INC

8815 - 122ND AVE NE, STE 200
 KIRKLAND, WA 98033
 (425) 825-1855



10.5.22

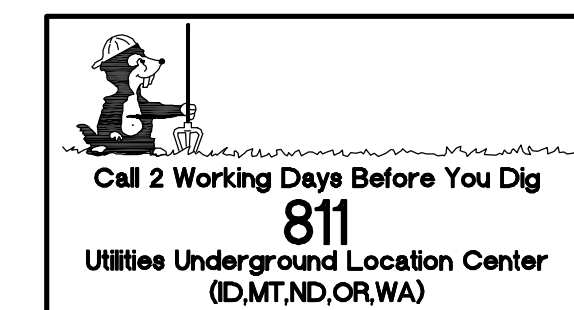
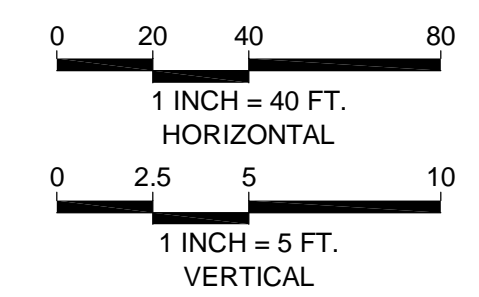
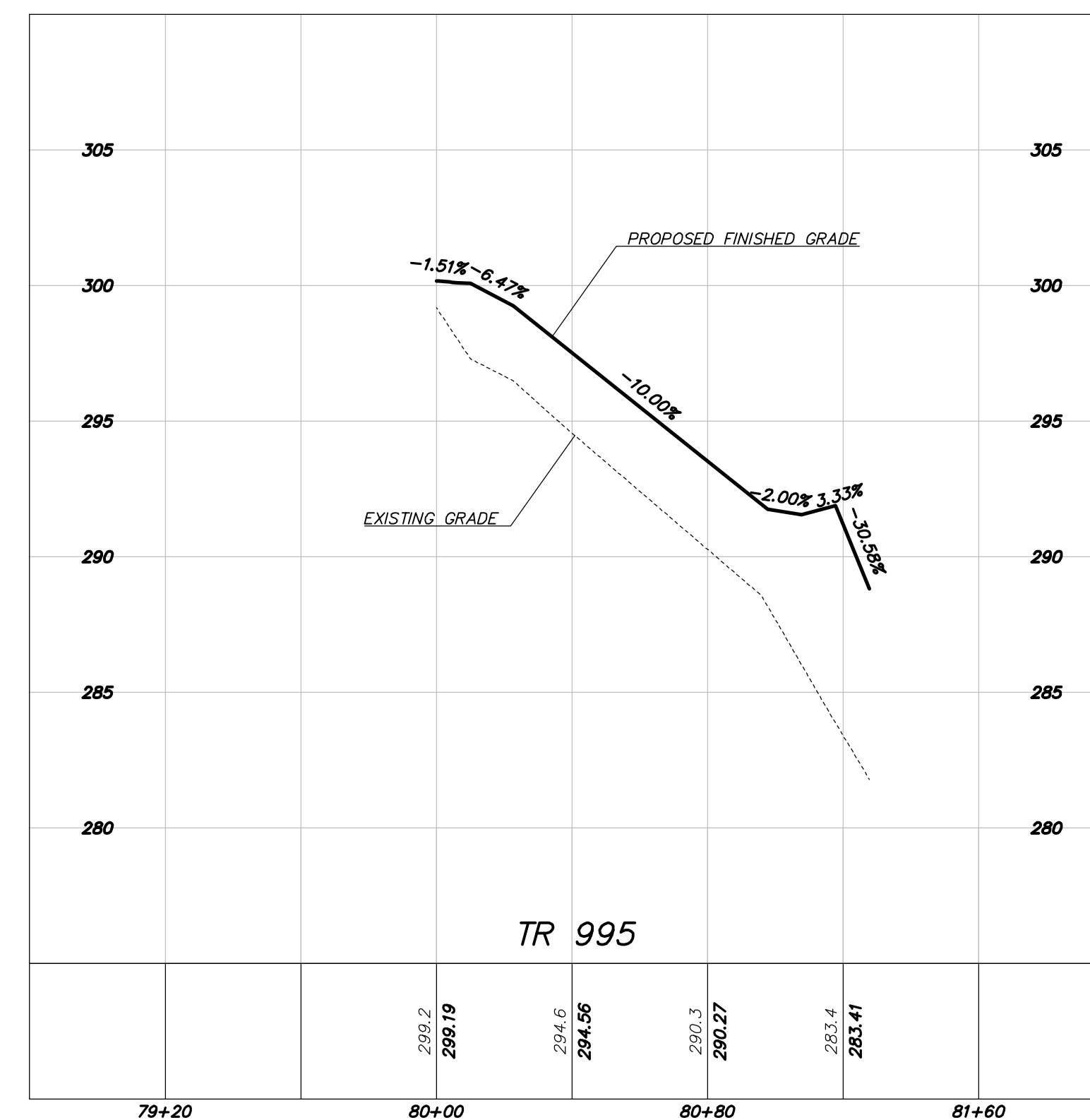
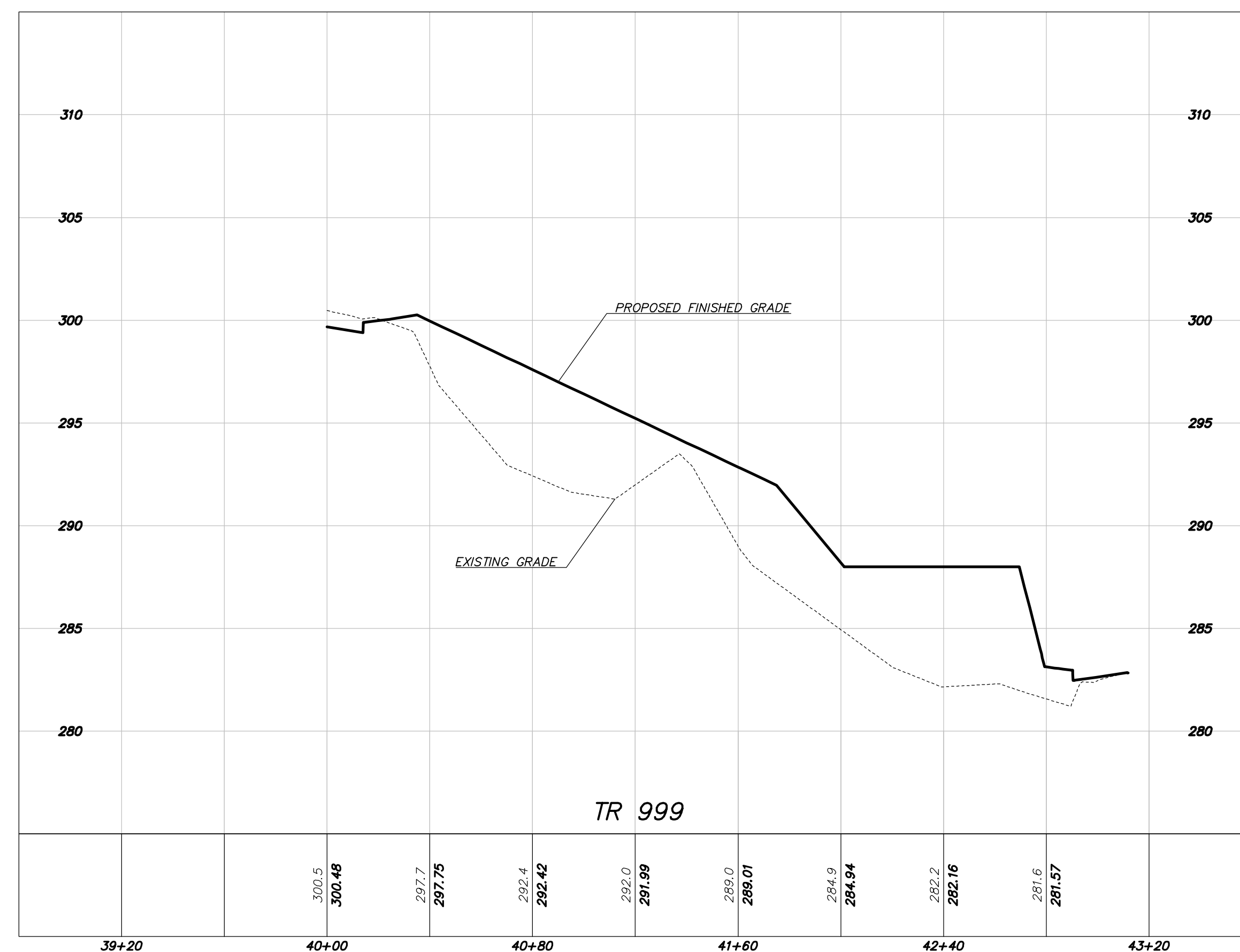
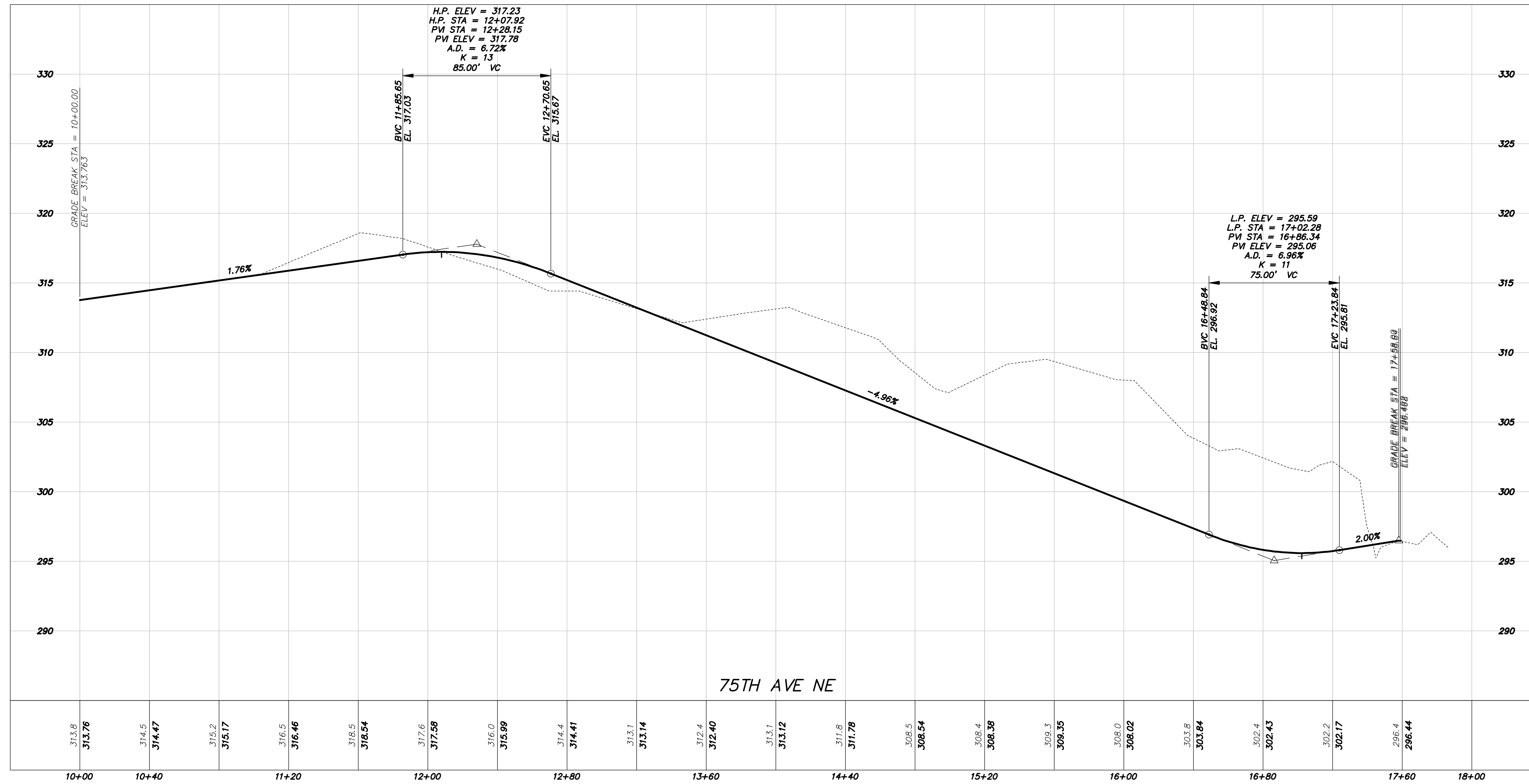

APR
LRJ
LRJ

REVISION
PER CITY COMMENTS
DATE
06.29.22
09.15.22

DRAFTED BY: ZLJ
 DESIGNED BY: LRJ
 PROJECT ENGINEER: LRJ
 DATE: 05-12-22
 PROJECT NO.: 21101

DRAWING: **C4**
 SHEET: **4** OF **8**

SW 1/4 SECTION 35, TOWNSHIP 30 N, RANGE 5 E, W.M.
MARYSVILLE - 44TH PRD

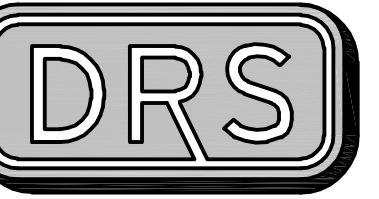

D.R. STRONG
 CONSULTING ENGINEERS
 ENGINEERS PLANNERS SURVEYORS
 620 - 7th AVENUE KIRKLAND, WA 98033
 O 425.827.3063 F 425.827.3423

MARYSVILLE - 44TH PRD

CONCEPTUAL ROAD PROFILES
 7315 & 7417 - 44TH ST NE
 MARYSVILLE, WA
 PARCELS 3005350030-3600,-3700

TOLL BROS., INC

8815 - 122ND AVE NE, STE 200
 KIRKLAND, WA 98033
 (425) 825-1955



10.5.22

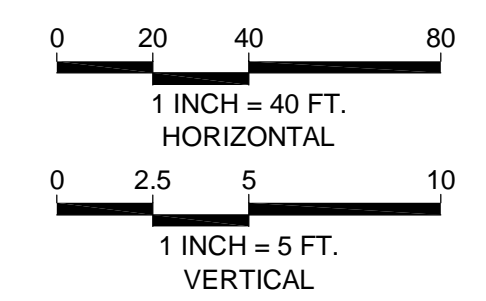
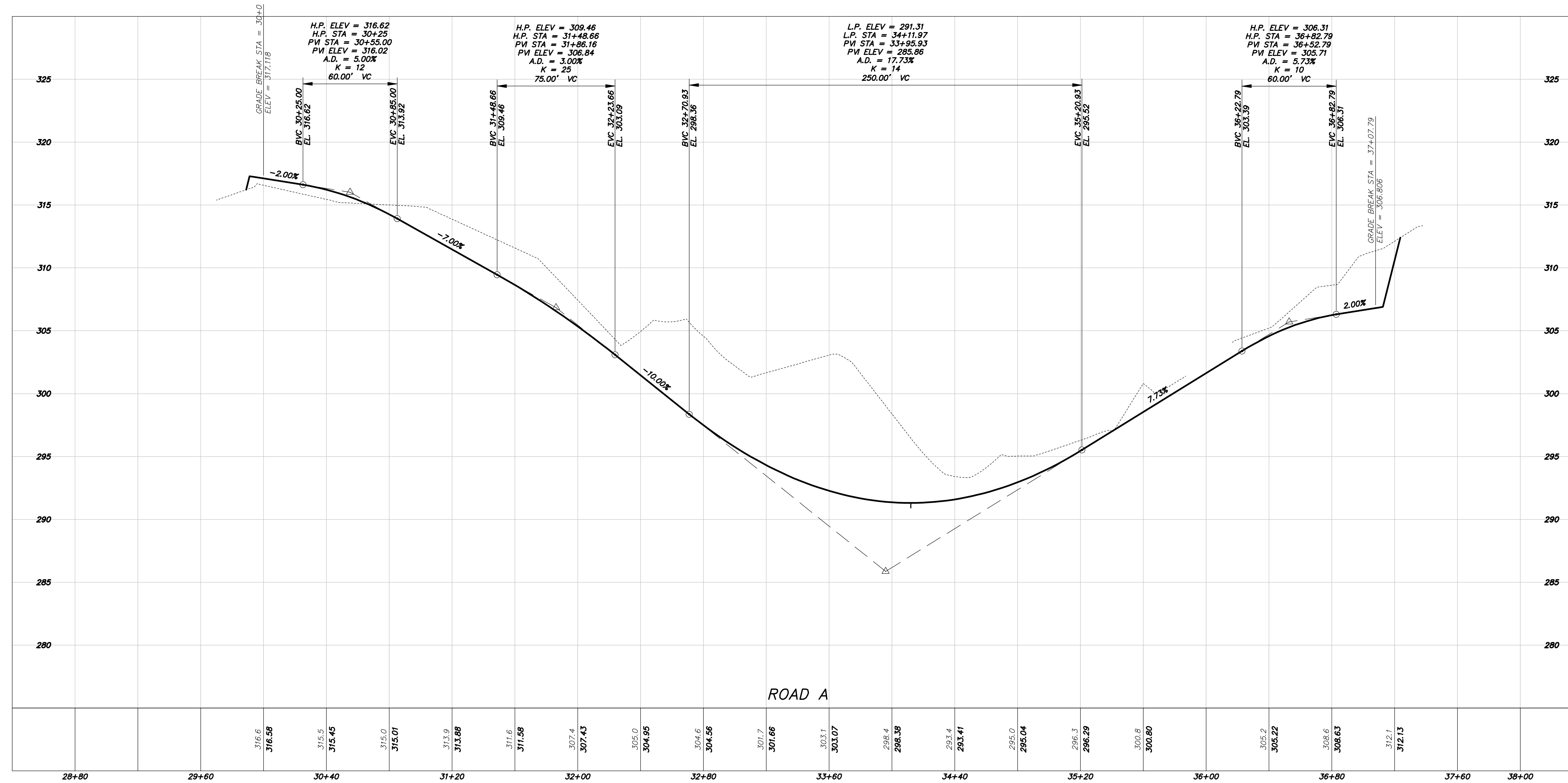

A:\2021\112101\1\Drawings\Road\105-3005350030-3600-3700.dwg 10/29/2022 4:27:34 PM

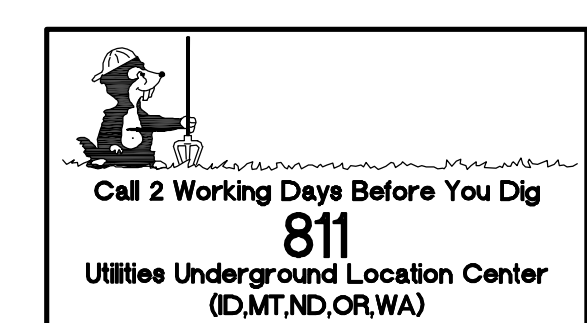

COPYRIGHT © 2018, D.R. STRONG CONSULTING ENGINEERS INC.

DATE	REVISION	PER CITY COMMENTS
06-29-22		PER CITY COMMENTS
09-15-22		PER CITY COMMENTS

DRAFTED BY: ZLJ
 DESIGNED BY: LRJ
 PROJECT ENGINEER: LRJ
 DATE: 05-12-22
 PROJECT NO.: 21101

DRAWING: C5
 SHEET: 5 OF 8

SW 1/4 SECTION 35, TOWNSHIP 30 N, RANGE 5 E, W.M.
MARYSVILLE - 44TH PRD

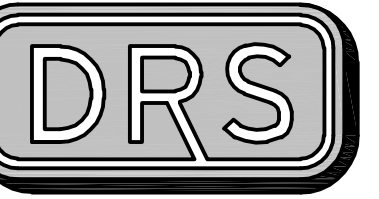

D.R. STRONG
 CONSULTING ENGINEERS
 ENGINEERS PLANNERS SURVEYORS
 620 - 7th AVENUE KIRKLAND, WA 98033
 O 425.827.3065 F 425.827.2423

MARYSVILLE - 44TH PRD

CONCEPTUAL STORM DRAINAGE PLAN
 7315 & 7417 - 44TH ST NE
 MARYSVILLE, WA
 PARCELS 3005350030-3600, -3700

TOLL BROS., INC

8815 - 122ND AVE NE, STE 200
 KIRKLAND, WA 98033
 (425) 825-1955

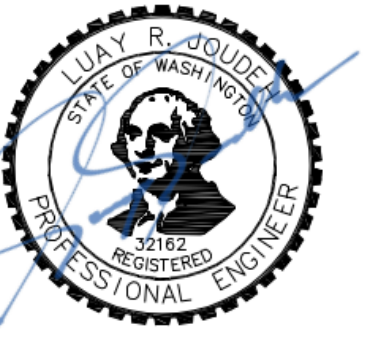

10.5.22

APR LRJ LRJ

REVISION PER CITY COMMENTS
 DATE 06-29-22 PER CITY COMMENTS
 09-15-22

DRAFTED BY: ZLJ
 DESIGNED BY: LRJ
 PROJECT ENGINEER: LRJ
 DATE: 05-12-22
 PROJECT NO.: 21101

DRAWING: **C6**
 SHEET: **6** OF **8**

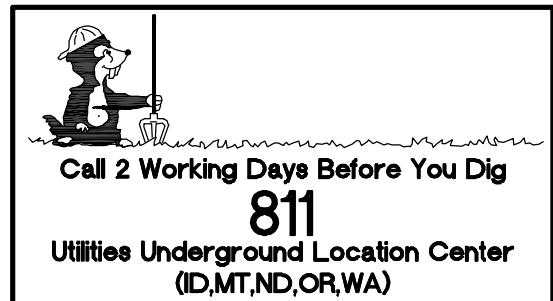
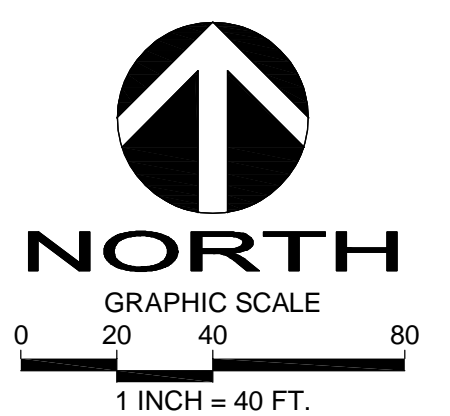

I:\work\2022\11-27\101_11_27\101_11_27\101_11_27\101_11_27.dwg 10/26/2022 11:40:16 AM

SW 1/4 SECTION 35, TOWNSHIP 30 N, RANGE 5 E, W.M.
MARYSVILLE - 44TH PRD

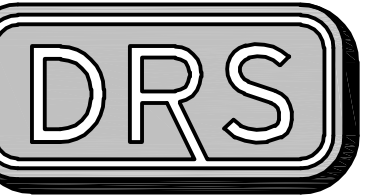

D.R. STRONG
 CONSULTING ENGINEERS
 ENGINEERS PLANNERS SURVEYORS
 620 - 7th AVENUE KIRKLAND, WA 98033
 O 425.827.3065 F 425.827.2423



MARYSVILLE - 44TH PRD

CONCEPTUAL WATER PLAN
 7315 & 7417 - 44TH ST NE
 MARYSVILLE, WA
 PARCELS 3005350030-3600-3700

TOLL BROS., INC

8815 - 122ND AVE NE, STE 200
 KIRKLAND, WA 98033
 (425) 825-1955



10.5.22

APR

LRJ

LRJ

REVISION

PER CITY COMMENTS

PER CITY COMMENTS

DATE

06.29.22

09.15.22



NORTH
 GRAPHIC SCALE
 0 20 40 80
 1 INCH = 40 FT.

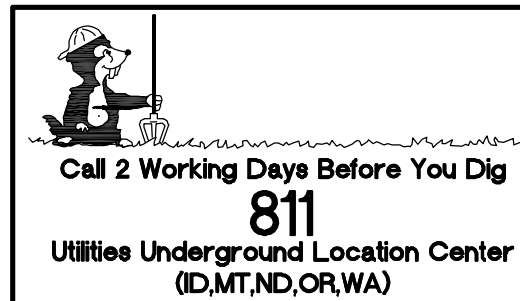

Call 2 Working Days Before You Dig
811
 Utilities Underground Location Center
 (D, M, T, D, OR, WA)

DRAFTED BY: ZLJ
 DESIGNED BY: LRJ
 PROJECT ENGINEER: LRJ
 DATE: 05-12-22
 PROJECT NO.: 21101

DRAWING: C7
 SHEET: 7 OF 8

SW 1/4 SECTION 35, TOWNSHIP 30 N, RANGE 5 E, W.M.
MARYSVILLE - 44TH PRD

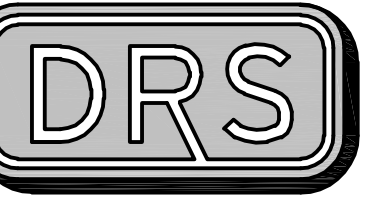

D.R. STRONG
 CONSULTING ENGINEERS
 ENGINEERS PLANNERS SURVEYORS
 620 - 7th AVENUE KIRKLAND, WA 98033
 O 425.827.3063 F 425.827.2423

MARYSVILLE - 44TH PRD

CONCEPTUAL SEWER PLAN
 7315 & 7417 - 44TH ST NE
 MARYSVILLE, WA
 PARCELS 3005350030-3600-3700

TOLL BROS., INC

8815 - 122ND AVE NE, STE 200
 KIRKLAND, WA 98033
 (425) 825-1955



APR LRU LRU

DATE	REVISION	PER CITY COMMENTS	PER CITY COMMENTS
06-29-22			
09-15-22			

DRAFTED BY: ZLJ
 DESIGNED BY: LRU
 PROJECT ENGINEER: LRU
 DATE: 05-12-22
 PROJECT NO.: 21101

DRAWING: **C8**
 SHEET: **8** OF **8**

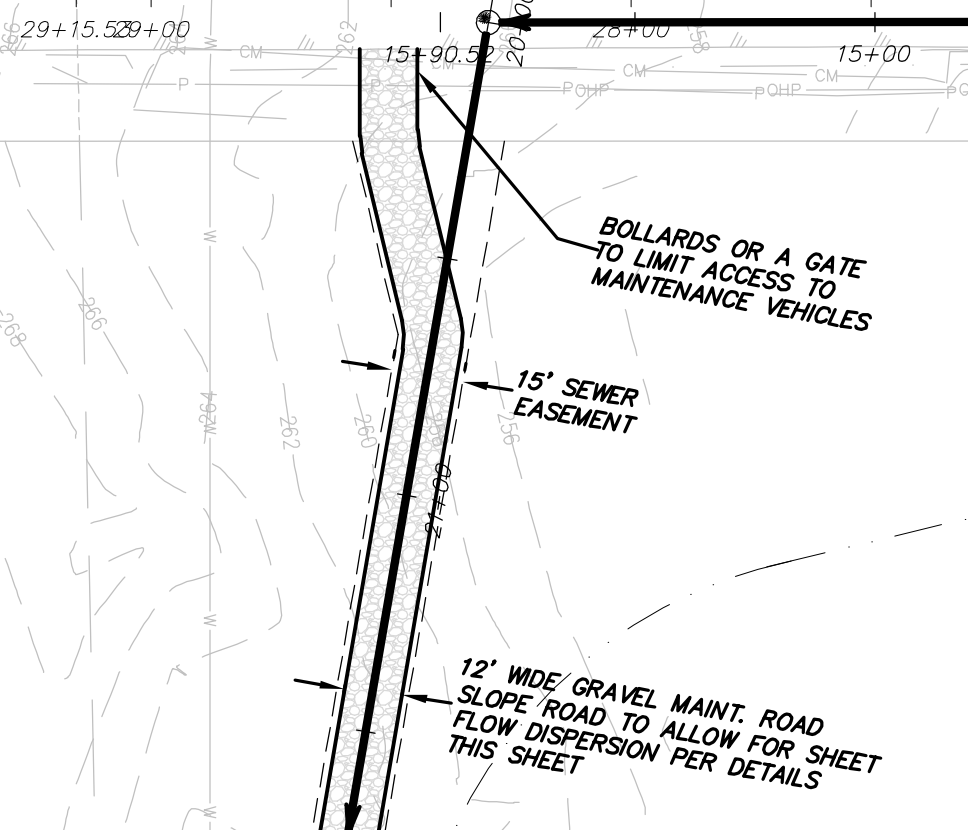

SEE RIGHT

SEE LEFT

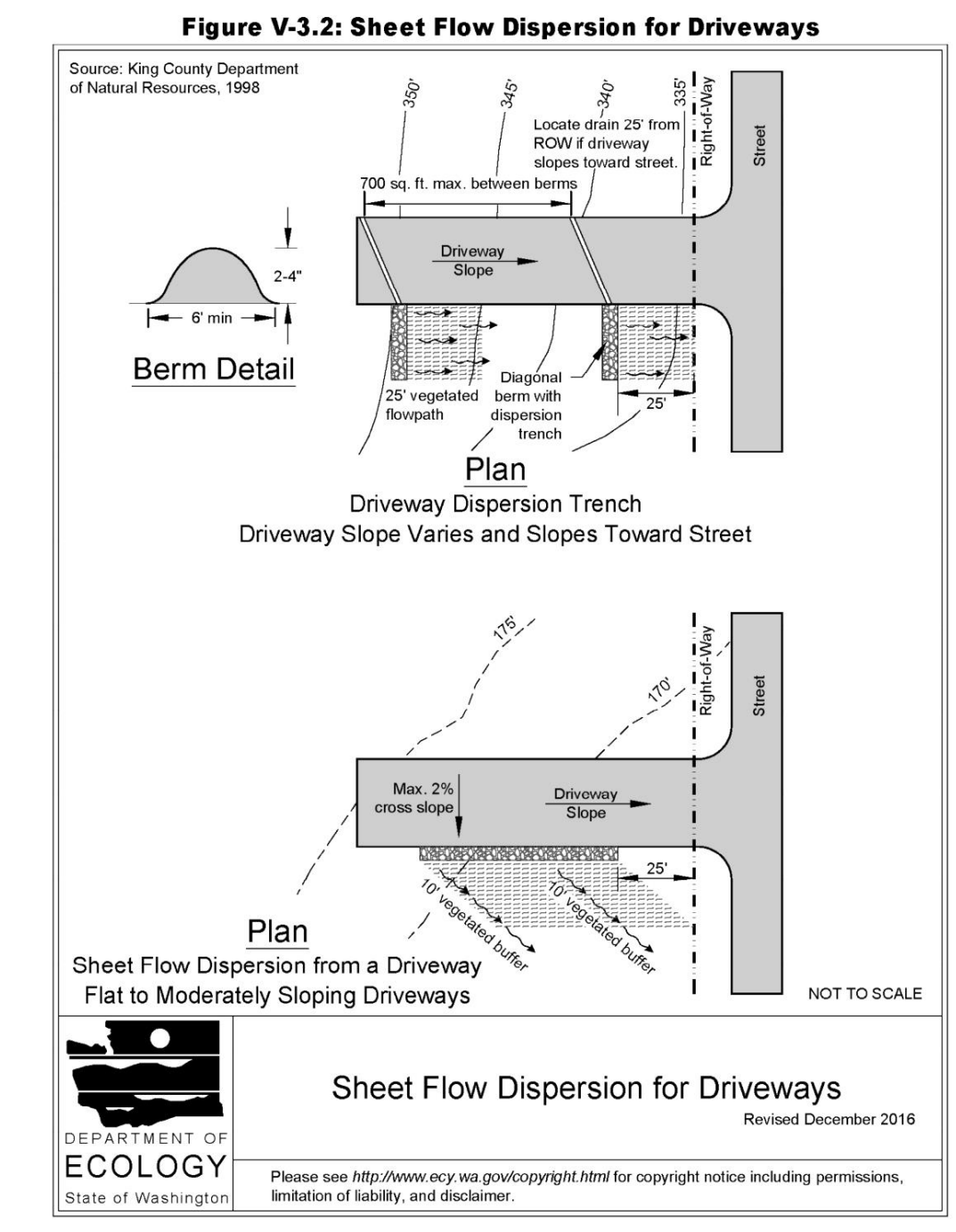
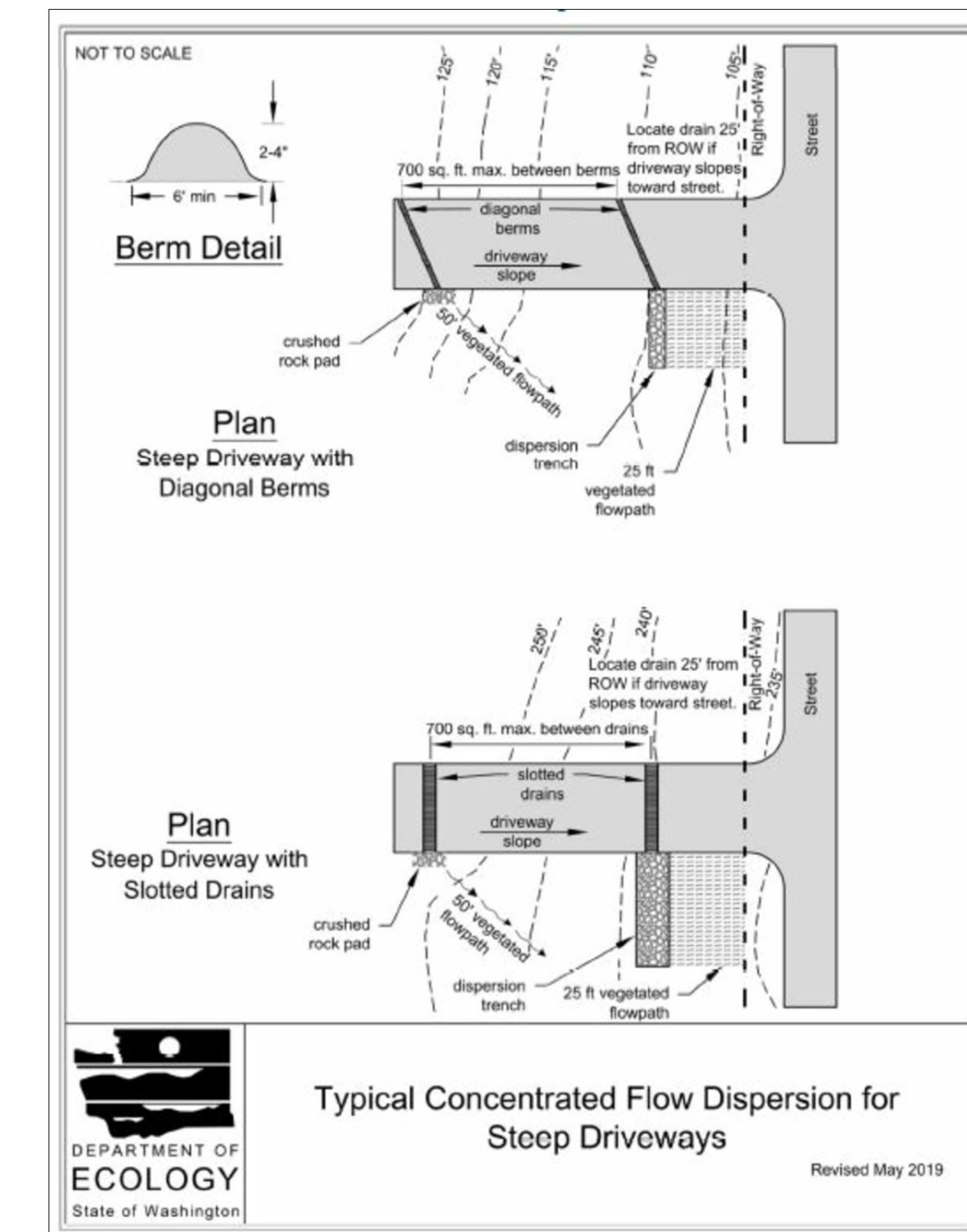
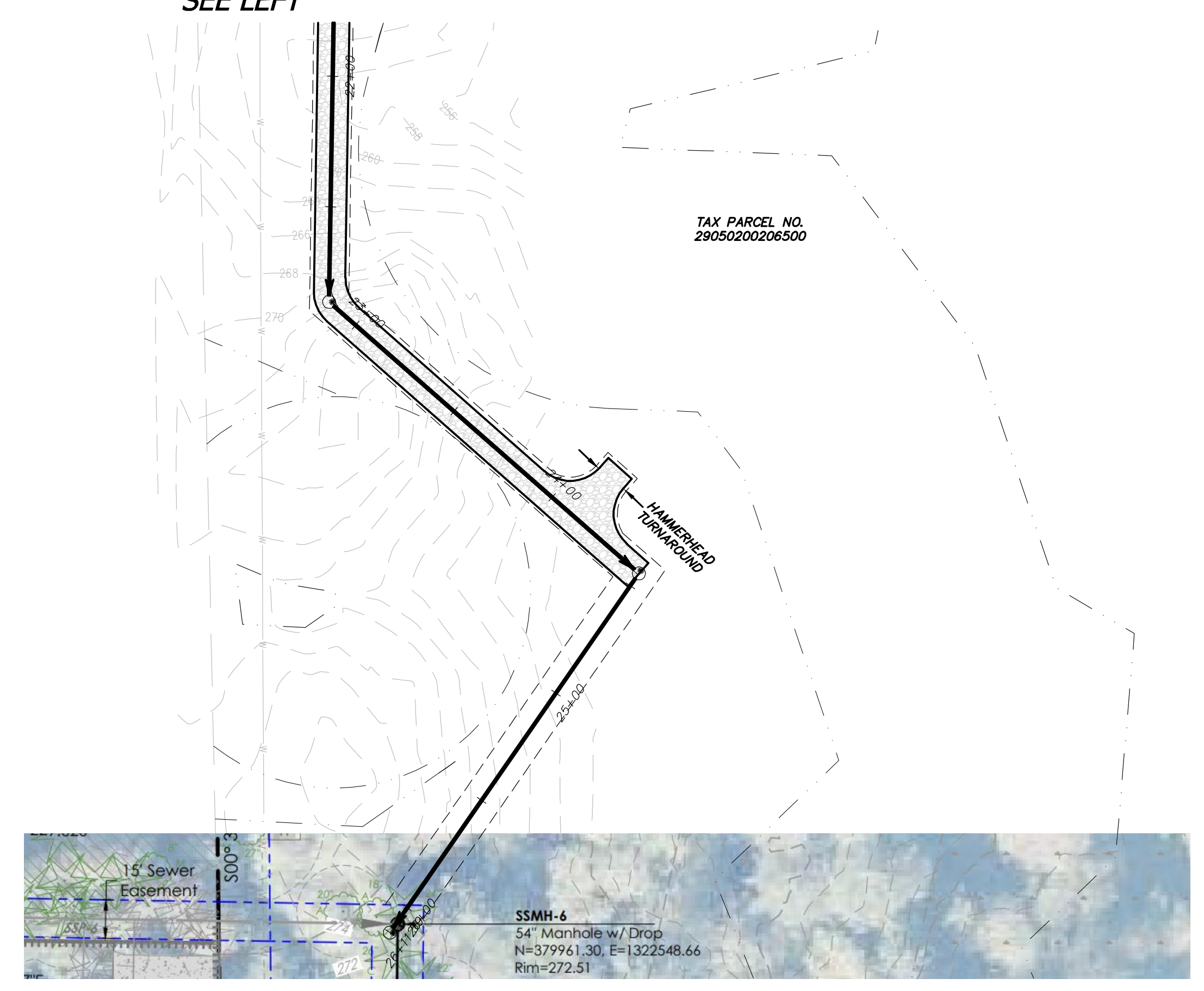

2019 Stormwater Management Manual for Western Washington
 Volume V - Chapter 3 - Page 694

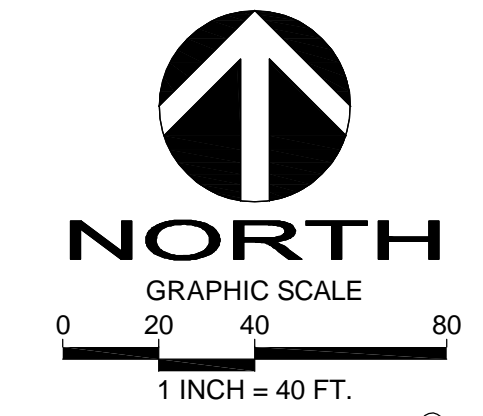

Call 2 Working Days Before You Dig
811
 Utilities Underground Location Center
 (D.M.T.D. OR WA)