

SW 1/4 SEC 20, NW 1/4 SEC 29, T 31 N, R 5 E, WM

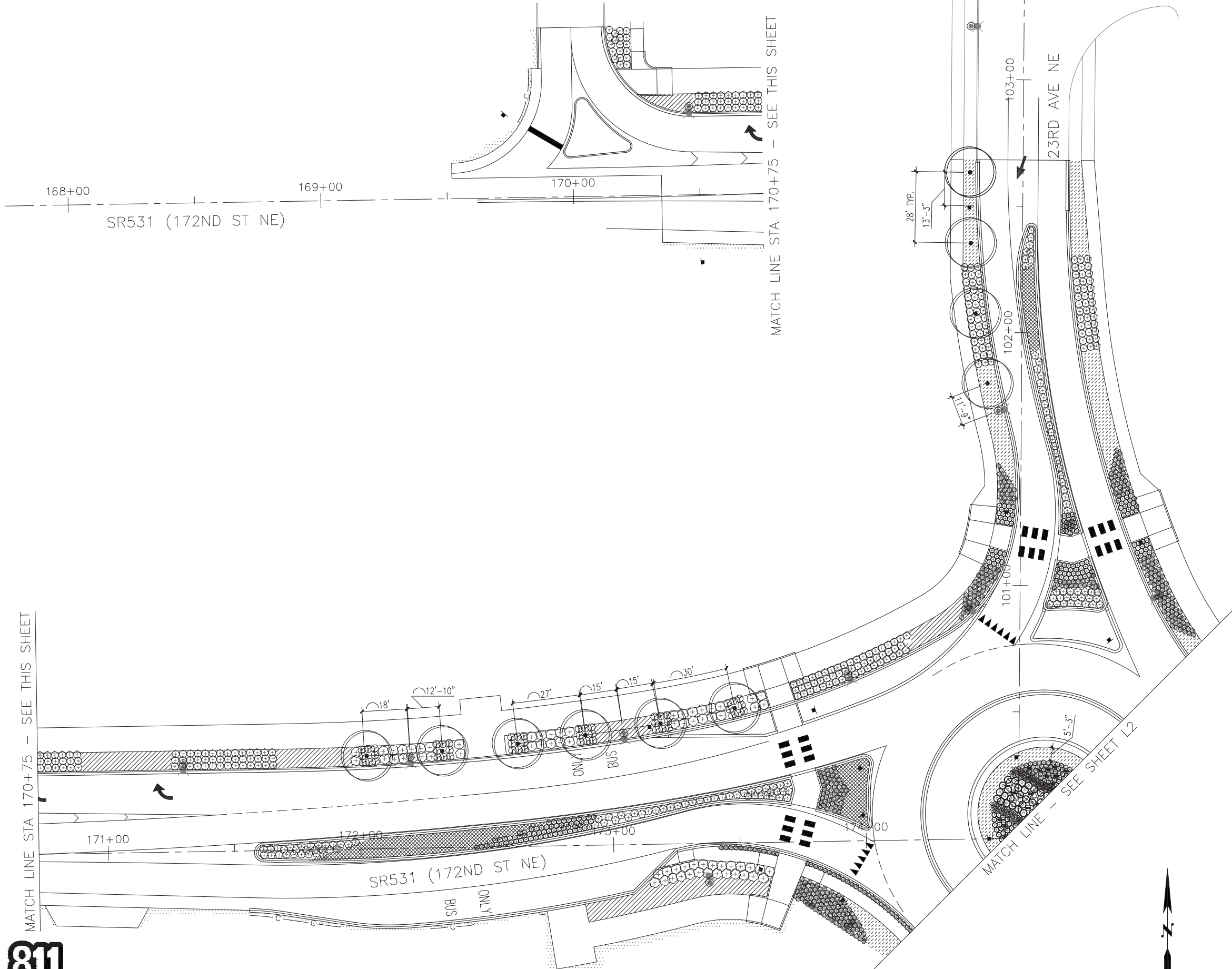

MATCH LINE STA 170+75 - SEE THIS SHEET

MATCH LINE STA 170+75 - SEE THIS SHEET

MATCH LINE - SEE SHEET L2

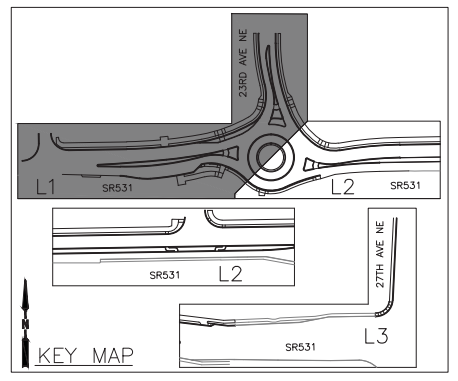
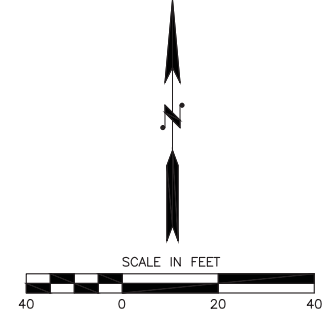

NO.	DATE	BY	Checked	REVISIONS

ENGINEER:
 DESIGNED BY: BS/MS/MH
 DRAWN BY: BS/MS/MH
 CHECKED BY: TR
 DATE: 5/15/2015

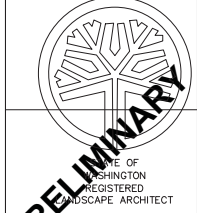

THOMAS V. RENGSTORF
 CERTIFICATE NO. 298

PRELIMINARY

**LAKewood STATION/
 SR531 ROUNDABOUT**

LANDSCAPE PLAN



25.2015.002
 Project No.
 L1
 Sheet No.
52 OF 55

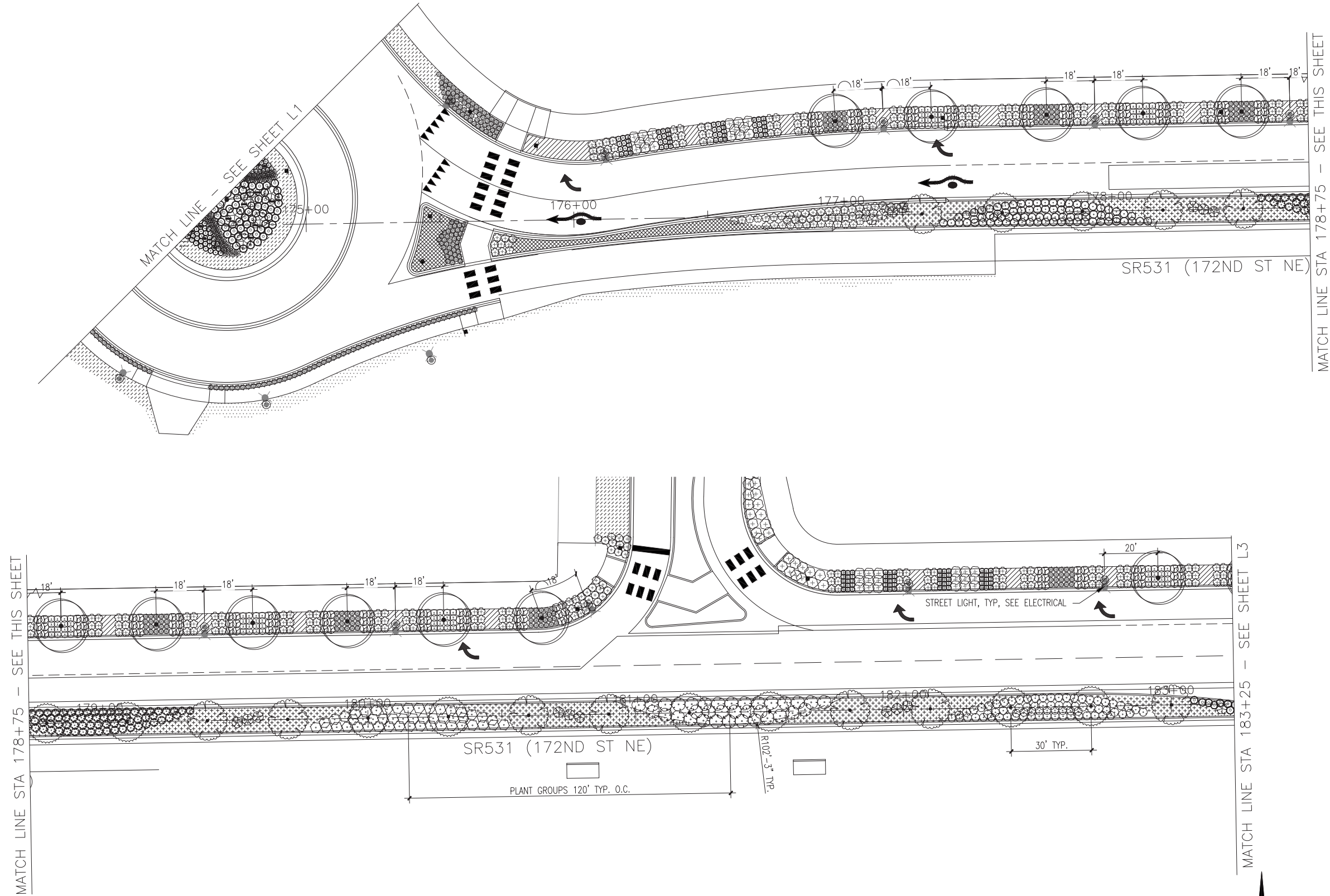

MATCH LINE STA 178+75 - SEE THIS SHEET

MATCH LINE STA 183+25 - SEE SHEET L3

MATCH LINE STA 178+75 - SEE THIS SHEET

NO.	DATE	BY	Checked	REVISIONS

ENGINEER:
 DESIGNED BY: BS/MS/MH
 DRAWN BY: BS/MS/MH
 CHECKED BY: TR
 DATE: 5/15/2015

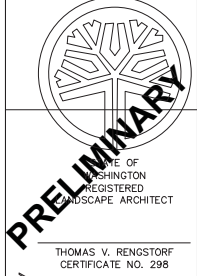

PRELIMINARY

STATE OF WASHINGTON
 REGISTERED
 LANDSCAPE ARCHITECT

THOMAS V. RENGSTORF
 CERTIFICATE NO. 298

**LAKewood STATION/
 SR531 ROUNDABOUT**

LANDSCAPE PLAN

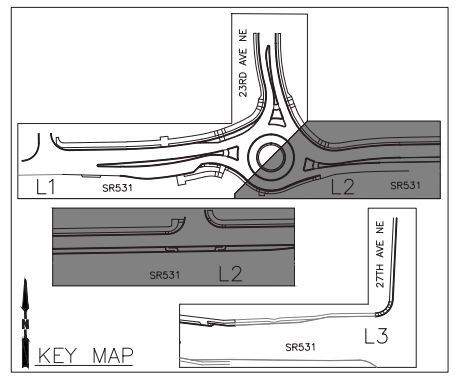
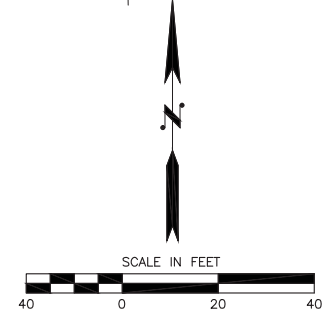

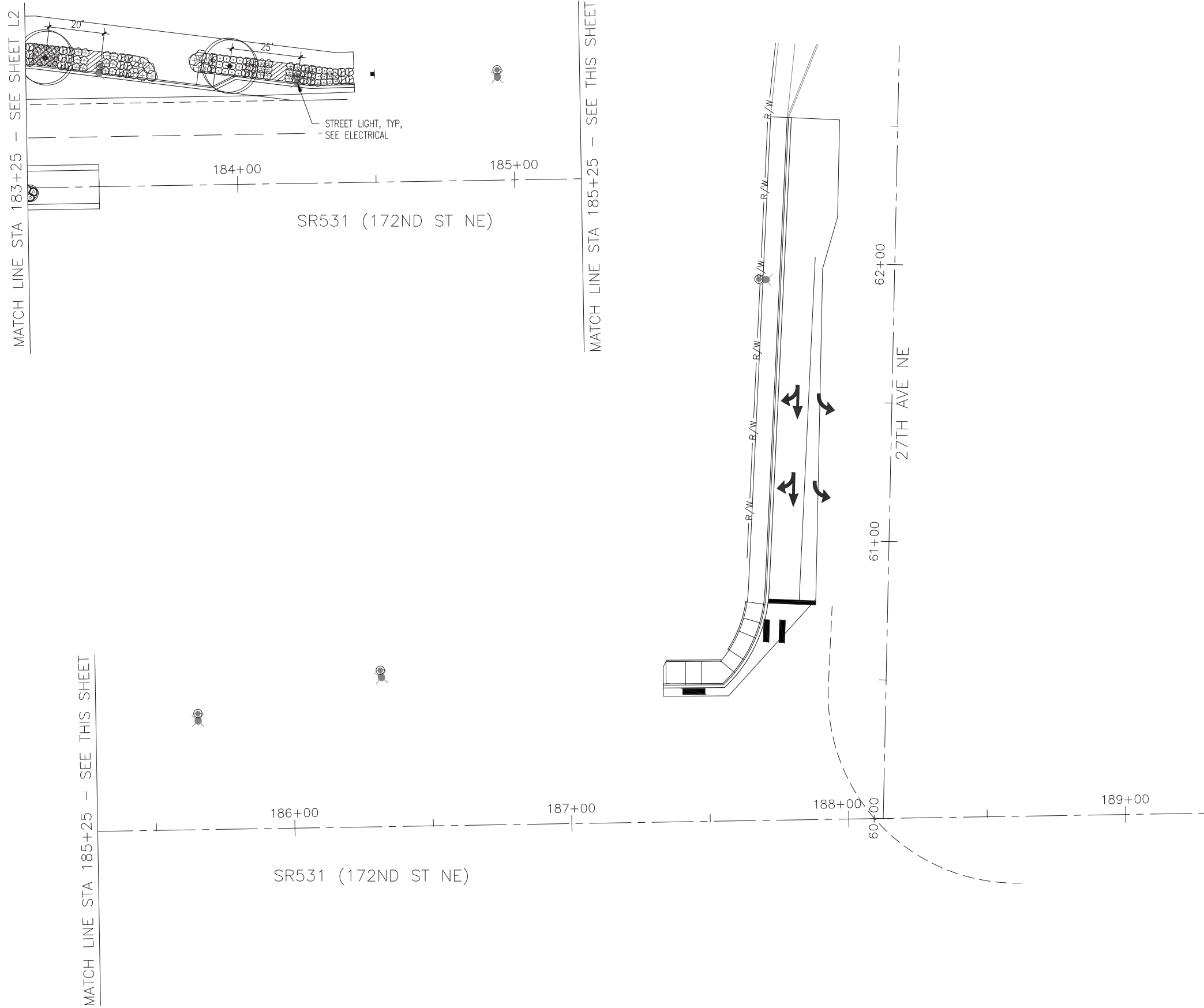

MATCH LINE STA 183+25 - SEE SHEET L2

MATCH LINE STA 185+25 - SEE THIS SHEET

MATCH LINE STA 185+25 - SEE THIS SHEET

SR531 (172ND ST NE)

SR531 (172ND ST NE)

27TH AVE NE

STREET LIGHT, TYP.
- SEE ELECTRICAL

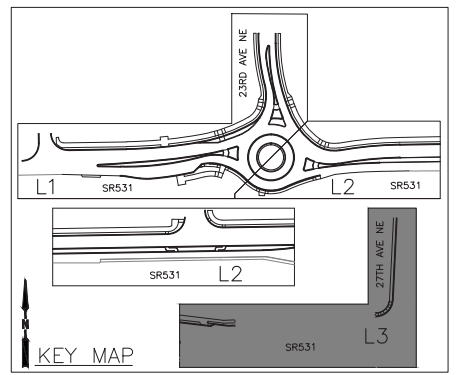
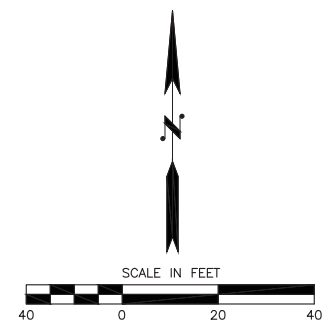

NO.	DATE	BY	Checked	REVISIONS

ENGINEER:
DESIGNED BY: BS/MS/MH
DRAWN BY: BS/MS/MH
CHECKED BY: TR
DATE: 5/15/2015

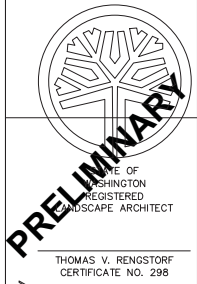

LAKEWOOD STATION/
SR531 ROUNDABOUT
LANDSCAPE PLAN



25.2015.002
Project No.
L3
Sheet No.
54 OF 55

SW 1/4 SEC 20, NW 1/4 SEC 29, T 31 N, R 5 E, WM

PLANT SCHEDULE

TREES	BOTANICAL NAME	COMMON NAME	CONT	CAL	SIZE	QTY	
	ACER FREEMANII 'JEFFERSRED' TM	AUTUMN BLAZE MAPLE	B & B	2.5" CAL		25	
	CORNUS FLORIDA 'EDDIES WHITE WONDER'	FLOWERING DOGWOOD	B & B	2.5" CAL		10	
	LIRIODENDRON TULIPIFERA	TULIP TREE	B & B	3.5" CAL	10'-12' HT	1	
	THUJA PLICATA 'HOGAN'	HOGAN CEDAR	B & B		6'-8' HT. NOT SHEARED	10	
SHRUBS	BOTANICAL NAME	COMMON NAME	CONT	MIN HT/SPREAD	O.C. SPCG	QTY	
	CORNUS SERICEA 'ISANTI'	ISANTI RED TWIG DOGWOOD	2 GAL	24" - 36"		48	
	GAULTHERIA SHALLON	SALAL	1 GAL	12" - 18"		120	
	PHILADELPHUS LEWISII 'BLIZZARD'	BLIZZARD MOCKORANGE	5 GAL	24" - 30"		34	
	POTENTILLA FRUTICOSA	BUSH CINQUEFOIL	2 GAL	12"-18" HT		241	
	RHUS GLABRA	SMOOTH SUMAC	5 GAL	42" - 48" HT		8	
	RIBES SANGUINEUM 'KING EDWARD VII'	RED FLOWERING CURRANT	5 GAL	36"		17	
	ROSA NUTKANA	NOOTKA ROSE	5 GAL	24" - 30"		82	
	SPIRAEA DOUGLASII	WESTERN SPIREA	5 GAL	24" MIN. HT.		81	
	SYMPHORICARPOS ALBUS	COMMON WHITE SNOWBERRY	2 GAL	18" - 24"		74	
	YUCCA FILAMENTOSA 'BRIGHT EDGE'	ADAM'S NEEDLE	2 GAL			74	
ANNUALS/PERENNIALS	BOTANICAL NAME	COMMON NAME	CONT	MIN HT/SPREAD	O.C. SPCG	QTY	
	ASTER SUBSPICATUS SYN. SYMPHYOTRICHUM SUBSPICATUM	DOUGLAS ASTER	1 GAL			10	
	ECHINACEA PURPUREA	PURPLE CONEFLOWER	1 GAL			19	
GRASSES	BOTANICAL NAME	COMMON NAME	CONT	MIN HT/SPREAD	O.C. SPCG	QTY	
	DESCHAMPSIA CESPITOSA 'SCHOTTLAND'	SCHOTTLAND HAIR GRASS	5 GAL			97	
	HELIOTRICHON SEMPERVIRENS	BLUE OAT GRASS	1 GAL			64	
	MUHLENBERGIA CAPILLARIS 'PINK CLOUD'	PINK MUHLY	2 GAL			53	
LOW SHRUBS (<18" HT)	BOTANICAL NAME	COMMON NAME	CONT	MIN HT/SPREAD	O.C. SPCG	QTY	
	ERICA X DARLEYENSIS 'DARLEY DALE'	DARLEY HEATH	2 GAL	12"		296	
	LAVANDULA ANGUSTIFOLIA 'HIDCOTE BLUE'	HIDCOTE BLUE LAVENDER	2 GAL	12"		427	
	LONICERA PILEATA	PRIVET HONEYSUCKLE	5 GAL	12"-18" HT		140	
	MAHONIA REPENS	CREeping OREGON GRAPE	2 GAL	12"		746	
	PROSTANTHERA CUNEATA	APLINE MINT BUSH	5 GAL	12"-18" HT		264	
GROUND COVERS	BOTANICAL NAME	COMMON NAME	CONT	SPCG	AP_RT	SPACING	QTY
	50% ARCTOSTAPHYLOS UVA-URSI 'EMERALD CARPET' 50% FRAGARIA CHILOENSIS	EMERALD CARPET MANZANITA & BEACH STRAWBERRY	1 GAL			24" o.c.	752
	50% ARMERIA MARITIMA 50% FESTUCA GLAUCA 'ELIJAH BLUE'	SEA THRIFT & BLUE FESCUE	1 GAL			18" o.c.	1,141
	50% IRIS TENAX 50% CAREX ALBULA	OREGON IRIS & FROSTY CURLS SEDGE	1 GAL			18" o.c.	685
	EROSION CONTROL SEED	GRASS SEED PER SPECIFICATIONS	-				1,775 SF
TALL GROUND COVERS	BOTANICAL NAME	COMMON NAME	CONT	SPCG	AP_RT	SPACING	QTY
	CEANOTHUS GRISEUS 'LOUIS EDMUNDS'	CEANOTHUS LOUIS EDMUNDS	1 GAL			36" o.c.	338

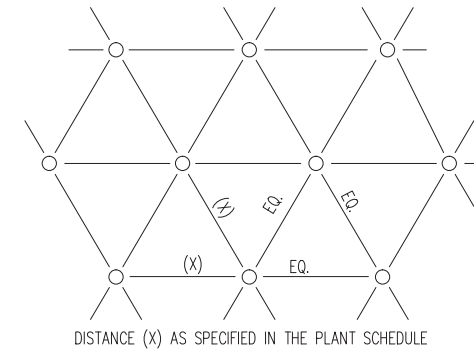

42 PLAN: PLANT SPACING
NTS

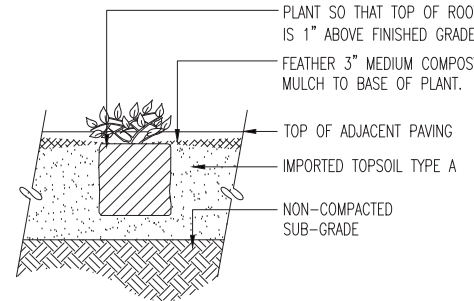

32 SECTION: GROUNDCOVER - PERENNIAL
NOT TO SCALE

- NOTES:
- TREE PIT SHALL NOT BE LESS THAT (2) TIMES ROOT BALL DIA.
 - CUT ALL TIES & FOLD BACK BURLAP FROM UPPER 1/3 OF ROOT BALL.
 - WATER DAILY UNTIL ESTABLISHED, FERTILIZE & USE GROWTH HORMONE.
 - WHERE A CONTINUOUS PLANTING STRIP IS ALLOWED, WIDEN TREE PIT TO SIDEWALK.
 - IMPORTED TOPSOIL TO BE WSDOT TYPE A
 - MULCH TO BE WSDOT MEDIUM COMPOST

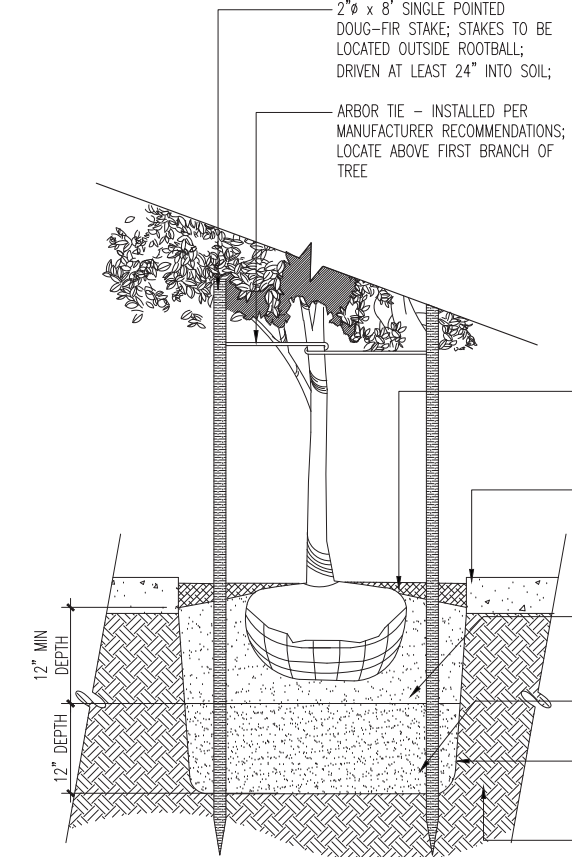

21 SECTION: CONIFER TREE
NOT TO SCALE

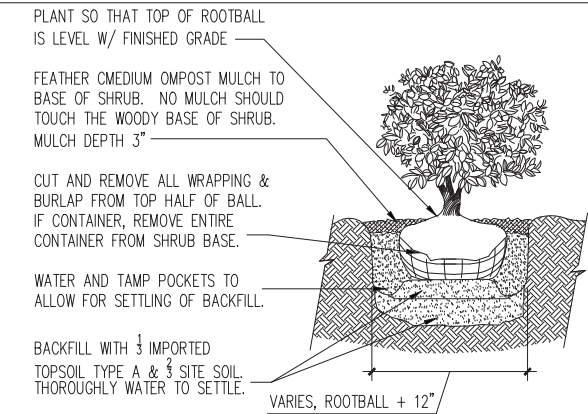

41 SECT: SMALL B & B SHRUB
NOT TO SCALE

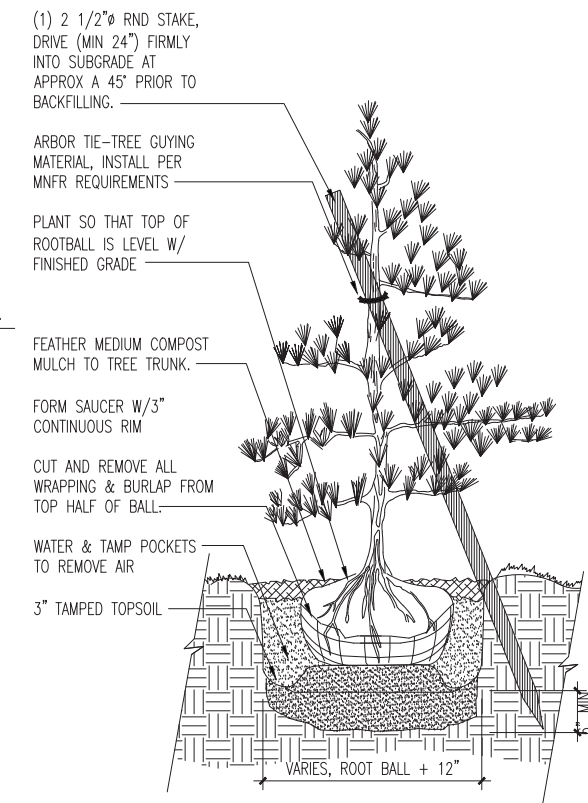

32 SECTION: GROUNDCOVER - PERENNIAL
NOT TO SCALE

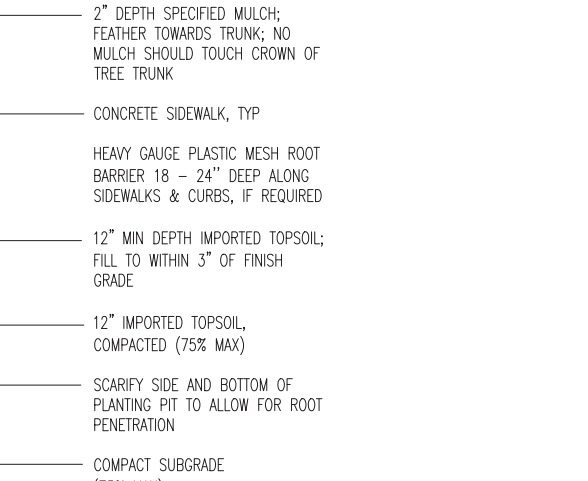

21 SECTION: CONIFER TREE
NOT TO SCALE

NO.	DATE	BY	REVISIONS

ENGINEER:
DESIGNED BY: BS/MS/MH
DRAWN BY: BS/MS/MH
CHECKED BY: TR
DATE: 5/15/2015

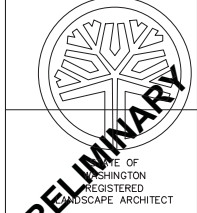

THOMAS V. RENGSTORF
CERTIFICATE NO. 298

LAKELAND STATION / SR531 ROUNDABOUT
LANDSCAPE SCHEDULE & DETAILS



25.2015.002
Project No. L4
Sheet No. 55 OF 55

