

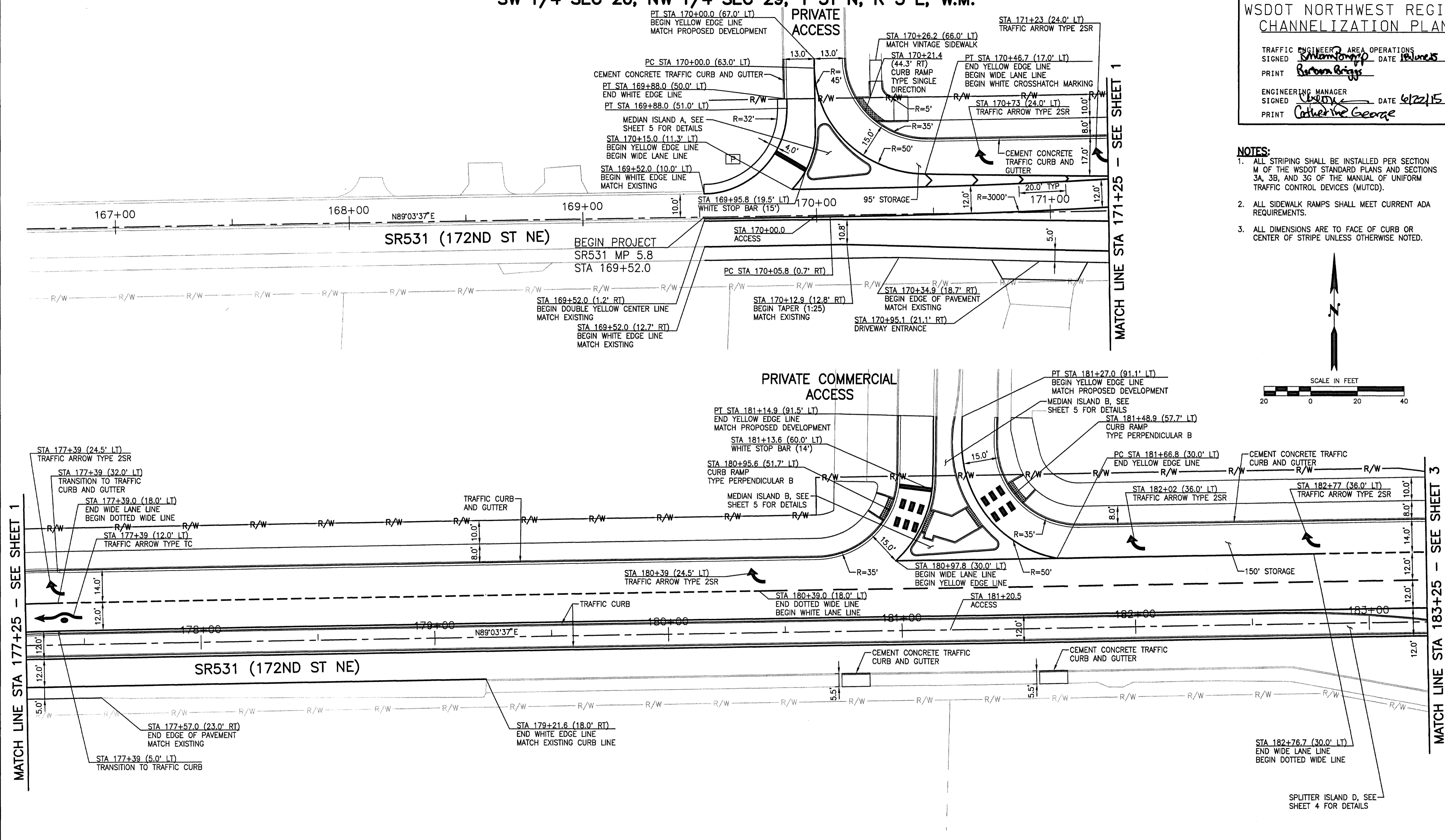

SW 1/4 SEC 20, NW 1/4 SEC 29, T 31 N, R 5 E, W.M.

WSDOT NORTHWEST REGION  
CHANNELIZATION PLAN

TRAFFIC ENGINEER AREA OPERATIONS  
SIGNED *[Signature]* DATE 6/22/15  
PRINT *[Signature]*  
ENGINEERING MANAGER  
SIGNED *[Signature]* DATE 6/22/15  
PRINT *[Signature]*



- NOTES:**
1. ALL STRIPING SHALL BE INSTALLED PER SECTION M OF THE WSDOT STANDARD PLANS AND SECTIONS 3A, 3B, AND 3G OF THE MANUAL OF UNIFORM TRAFFIC CONTROL DEVICES (MUTCD).
  2. ALL SIDEWALK RAMPS SHALL MEET CURRENT ADA REQUIREMENTS.
  3. ALL DIMENSIONS ARE TO FACE OF CURB OR CENTER OF STRIPE UNLESS OTHERWISE NOTED.

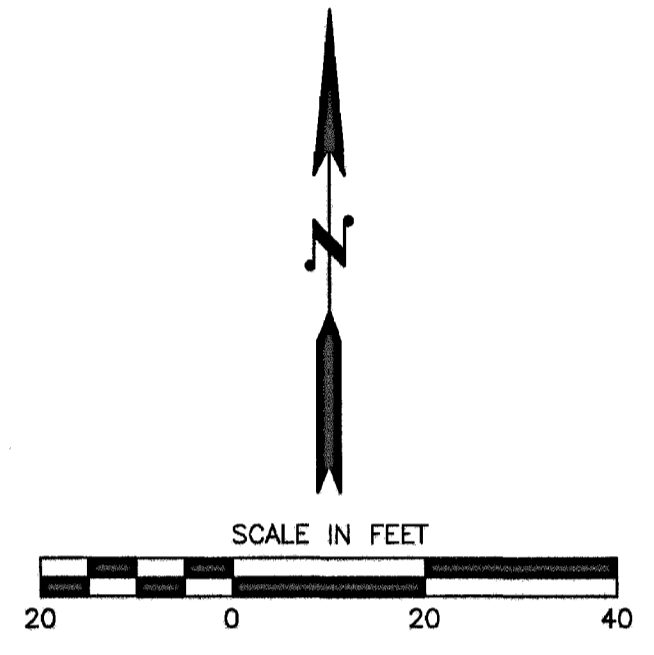

FILE NAME		REGION NO.		STATE		FED. AID PROJ. NO.		SR 531		MP 5.8 TO MP 6.1		PLOT 1	
DATE 06/2015		NW		WASH				LAKESIDE A. KIRKLANDS		LAKESIDE A. KIRKLANDS		2	
DESIGNED BY RP		JOB NUMBER		CONTRACT NO.		LOCATION NO.		CITY OF Marysville WASHINGTON		CITY OF MARYSVILLE, SNOHOMISH COUNTY		SHEET 2 OF 5 SHEETS	
ENTERED BY KGH								ReidMiddleton		JUNE 2015			
CHECKED BY RAK								728 134th Street SW · Suite 200		CHANNELIZATION PLAN			
PROJ. ENGR.								Everett, Washington 98204					
REGIONAL ADM.		REVISION		DATE		BY		Ph: 425 741-3800					

SW 1/4 SEC 20, NW 1/4 SEC 29, T 31 N, R 5 E, W.M.

WSDOT NORTHWEST REGION  
CHANNELIZATION PLAN

TRAFFIC ENGINEER AREA OPERATIONS  
SIGNED *[Signature]* DATE *6/22/15*  
PRINT *[Name]*  
ENGINEERING MANAGER  
SIGNED *[Signature]* DATE *6/22/15*  
PRINT *[Name]*

- NOTES:**
1. ALL STRIPING SHALL BE INSTALLED PER SECTION M OF THE WSDOT STANDARD PLANS AND SECTIONS 3A, 3B, AND 3G OF THE MANUAL OF UNIFORM TRAFFIC CONTROL DEVICES (MUTCD).
  2. ALL SIDEWALK RAMPS SHALL MEET CURRENT ADA REQUIREMENTS.
  3. ALL DIMENSIONS ARE TO FACE OF CURB OR CENTER OF STRIPE UNLESS OTHERWISE NOTED.

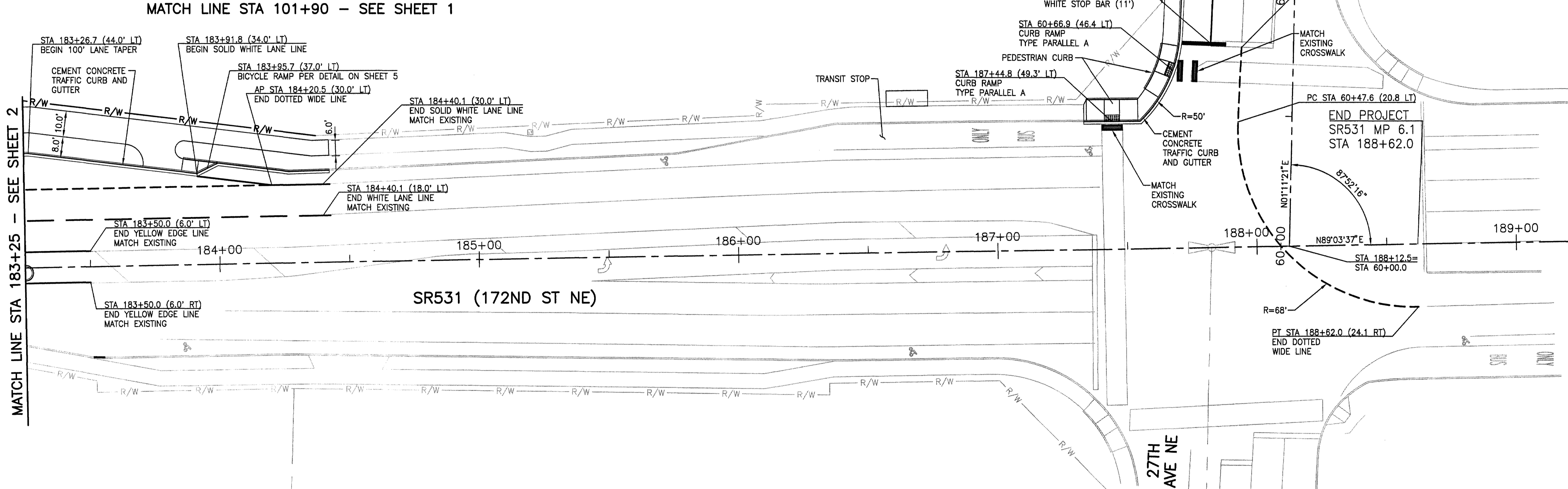
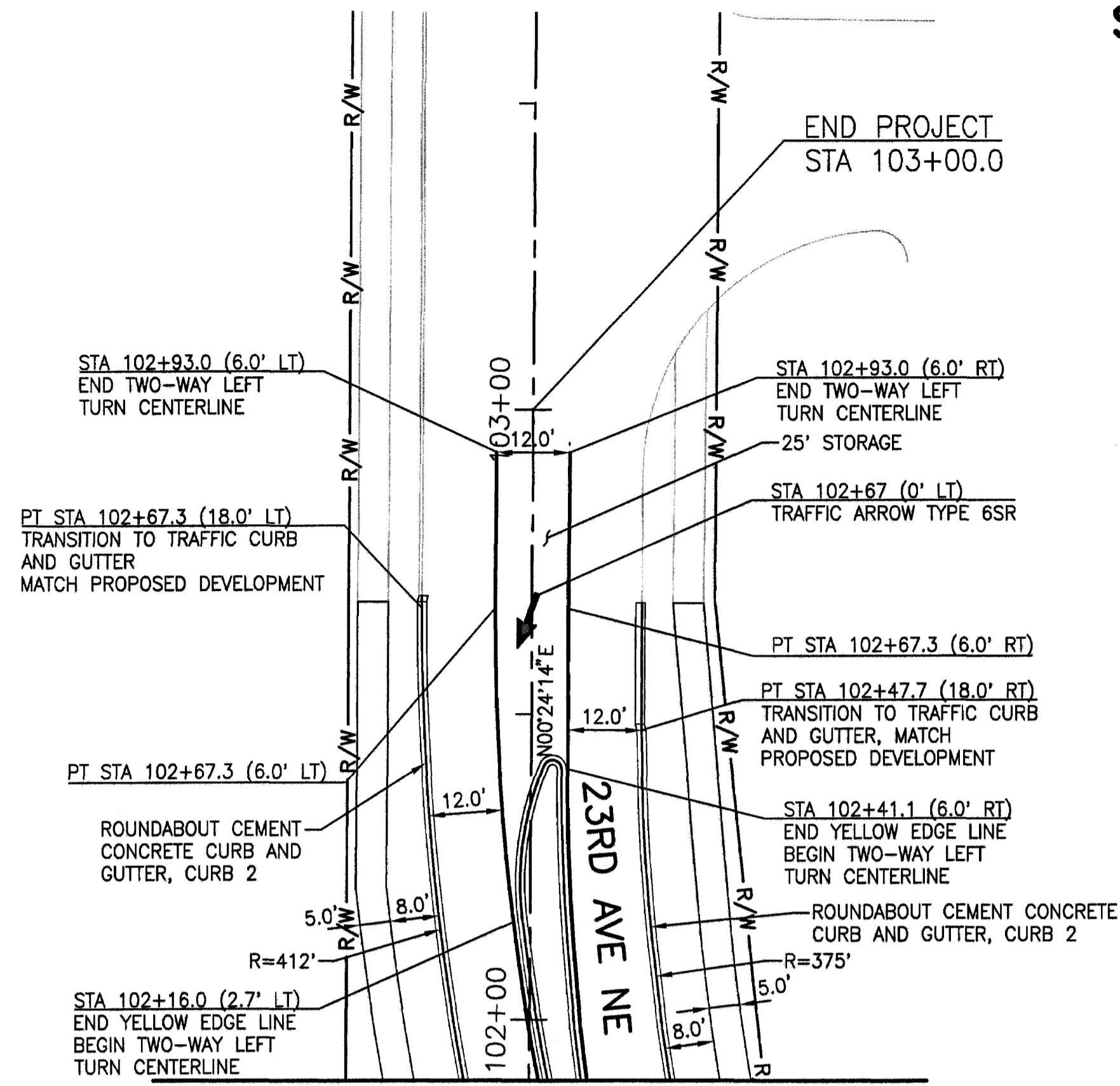
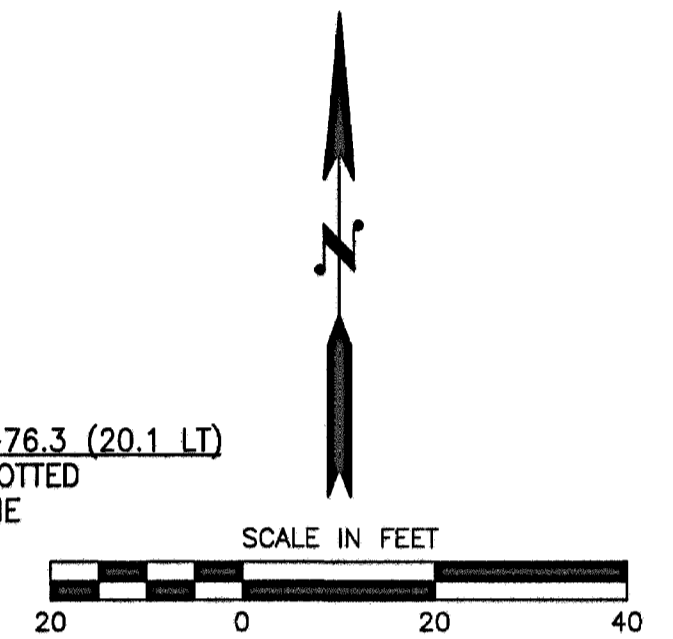

FILE NAME		REGION NO.		STATE	FED.AID PROJ.NO.				SR 531	MP 5.8 TO MP 6.1	PLOT 1
TIME	DATE	NW	WASH						LAKWOOD STATION/SR531 ROUNDBOUT	3	
DESIGNED BY RP	ENTERED BY KGH	JOB NUMBER		CONTRACT NO.	LOCATION NO.				CITY OF MARYSVILLE, SNOHOMISH COUNTY	JUNE 2015	SHEET 3 OF 5 SHEETS
CHECKED BY RAK	PROJ. ENGR.								CHANNELIZATION PLAN		
REGIONAL ADM.	REVISION	DATE	BY								

WSDOT NORTHWEST REGION  
CHANNELIZATION PLAN

TRAFFIC ENGINEER AREA OPERATIONS  
SIGNED *Barbara Briggs* DATE 6/29/15  
PRINT *Barbara Briggs*  
ENGINEERING MANAGER  
SIGNED *Andrew George* DATE 6/29/15  
PRINT *Andrew George*

- NOTES:**
1. ALL STRIPING SHALL BE INSTALL PER SECTION M OF THE WSDOT STANDARD PLANS AND SECTIONS 3A, 3B, AND 3G OF THE MANUAL OF UNIFORM TRAFFIC CONTROL DEVICES (MUTCD).
  2. ALL DIMENSIONS ARE TO FACE OF CURB OR CENTER OF STRIPE UNLESS OTHERWISE NOTED.

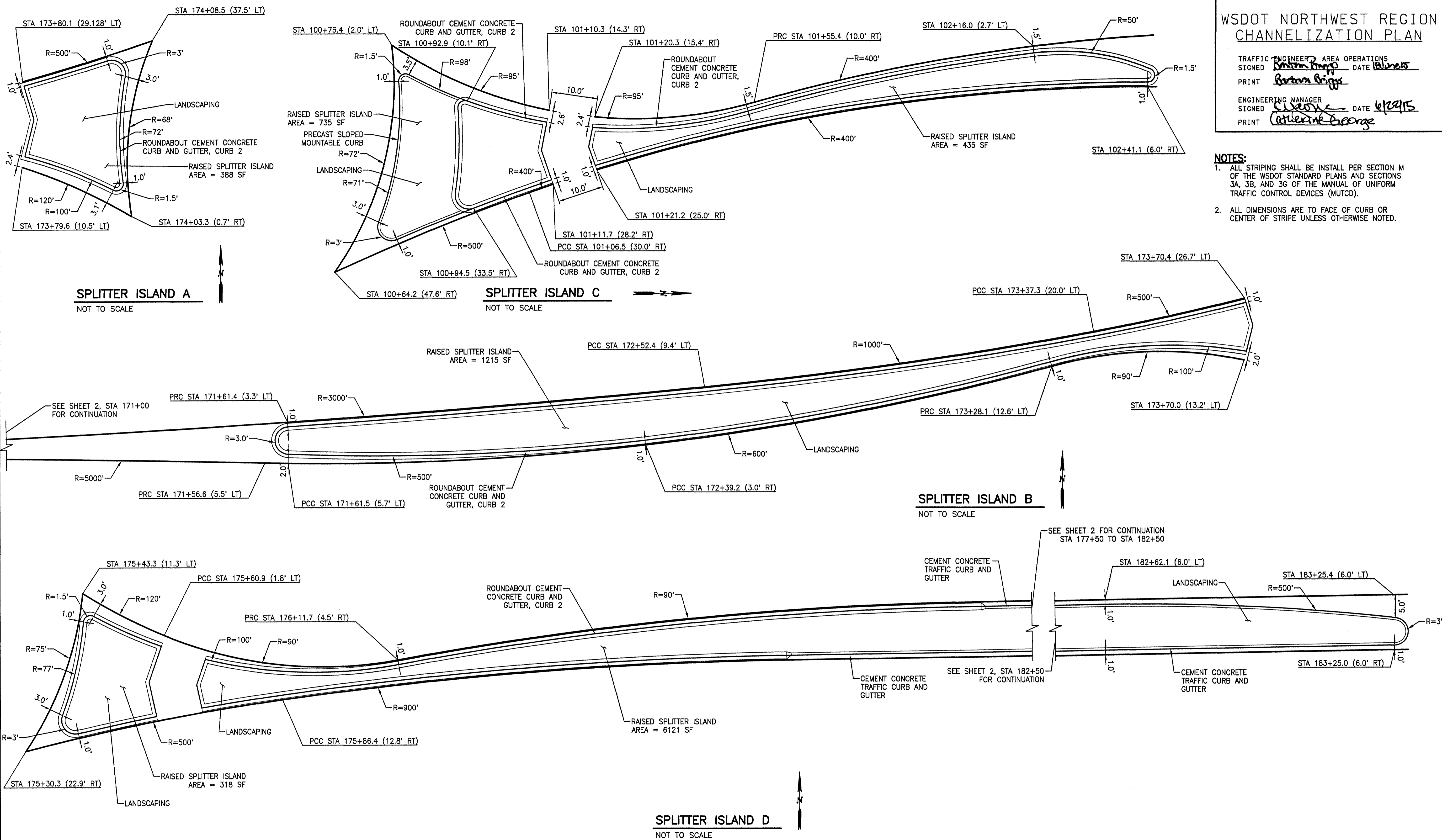

FILE NAME	REGION NO.	STATE	FED.AID PROJ.NO.				SR 531	MP 5.8 TO MP 6.1	PLOT 1
DATE 06/2015	NW	WASH					LAKESIDE	4	
DESIGNED BY RP	JOB NUMBER	CONTRACT NO.	LOCATION NO.	Public Works Department 80 Columbia Avenue Marysville, Washington 98204 Ph: 360 363-8100	CITY OF MARYSVILLE, SNOHOMISH COUNTY JUNE 2015	SHEET 4 OF 5 SHEETS			
ENTERED BY KGH	DATE	BY							
CHECKED BY RAK									
PROJ. ENGR.					CHANNELIZATION DETAILS				
REGIONAL ADM.									

WSDOT NORTHWEST REGION  
CHANNELIZATION PLAN

TRAFFIC ENGINEER AREA OPERATIONS  
SIGNED Barbara Longo DATE 6/2/15  
PRINT Barbara Briggs

ENGINEERING MANAGER  
SIGNED Catherine George DATE 6/2/15  
PRINT Catherine George

- NOTES:**
1. ALL STRIPING SHALL BE INSTALL PER SECTION M OF THE WSDOT STANDARD PLANS AND SECTIONS 3A, 3B, AND 3G OF THE MANUAL OF UNIFORM TRAFFIC CONTROL DEVICES (MUTCD).
  2. ALL DIMENSIONS ARE TO FACE OF CURB OR CENTER OF STRIPE UNLESS OTHERWISE NOTED.

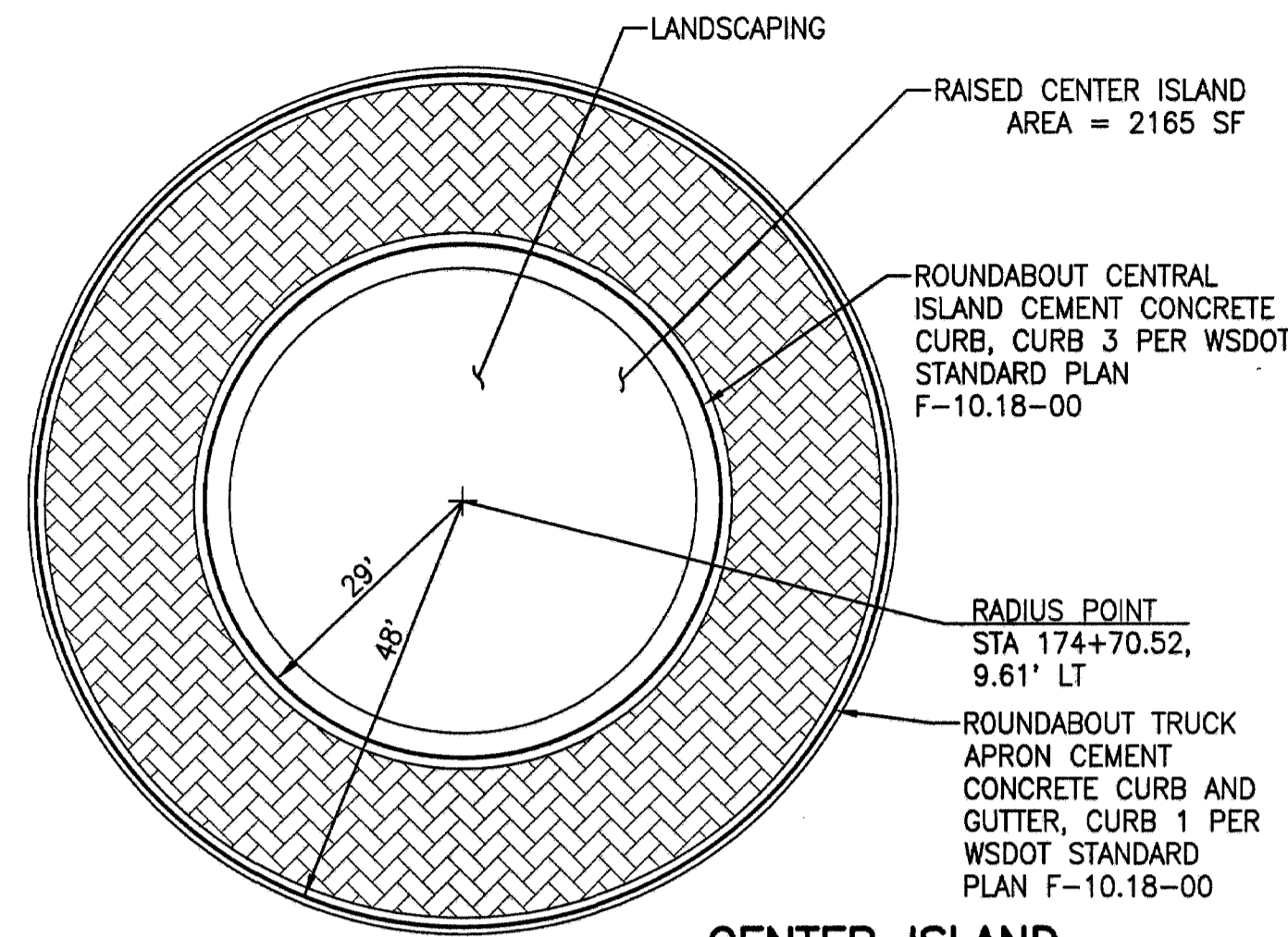

**CENTER ISLAND**  
NOT TO SCALE

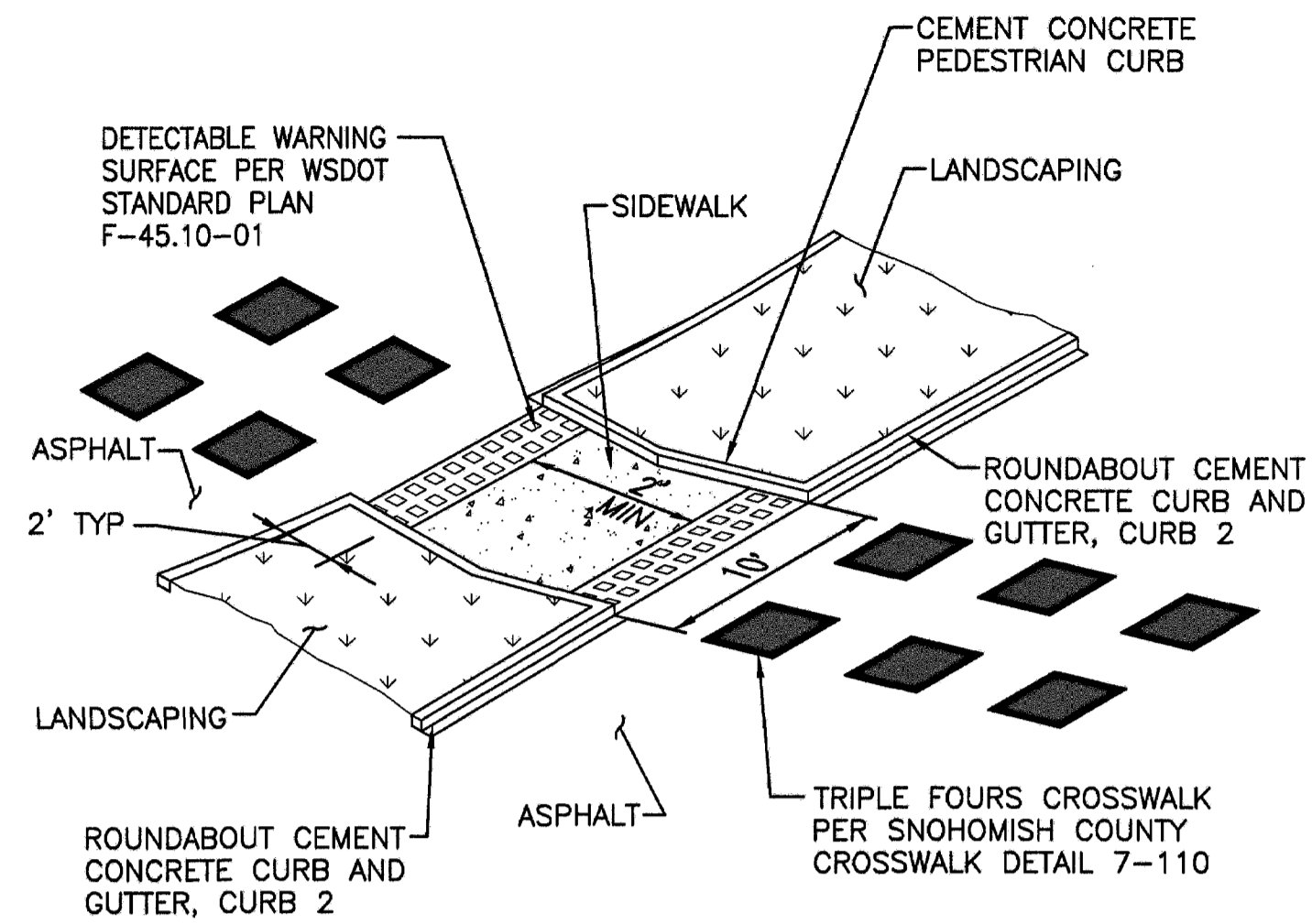

**SIDEWALK IN SPLITTER ISLAND**  
NOT TO SCALE

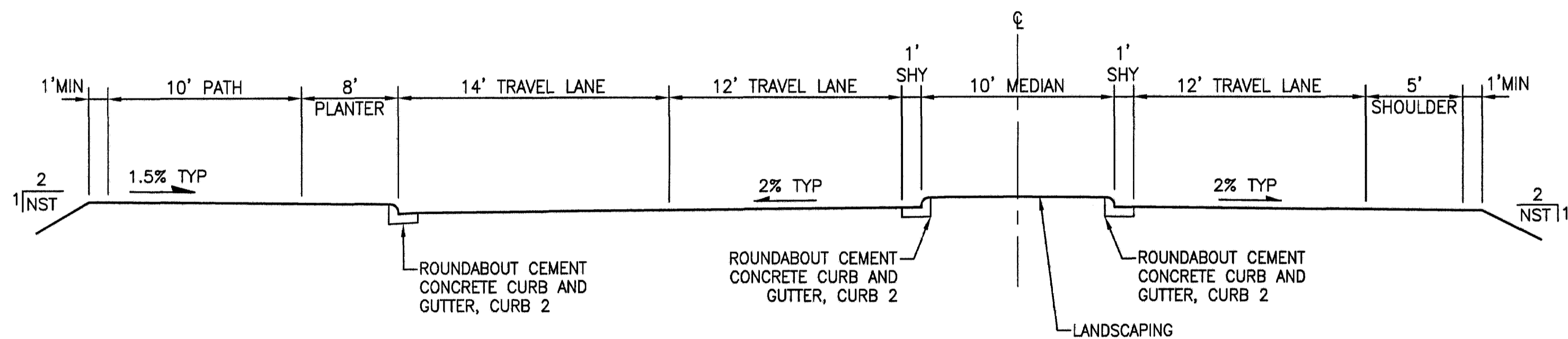

**TYPICAL ROADWAY SECTION**  
NOT TO SCALE

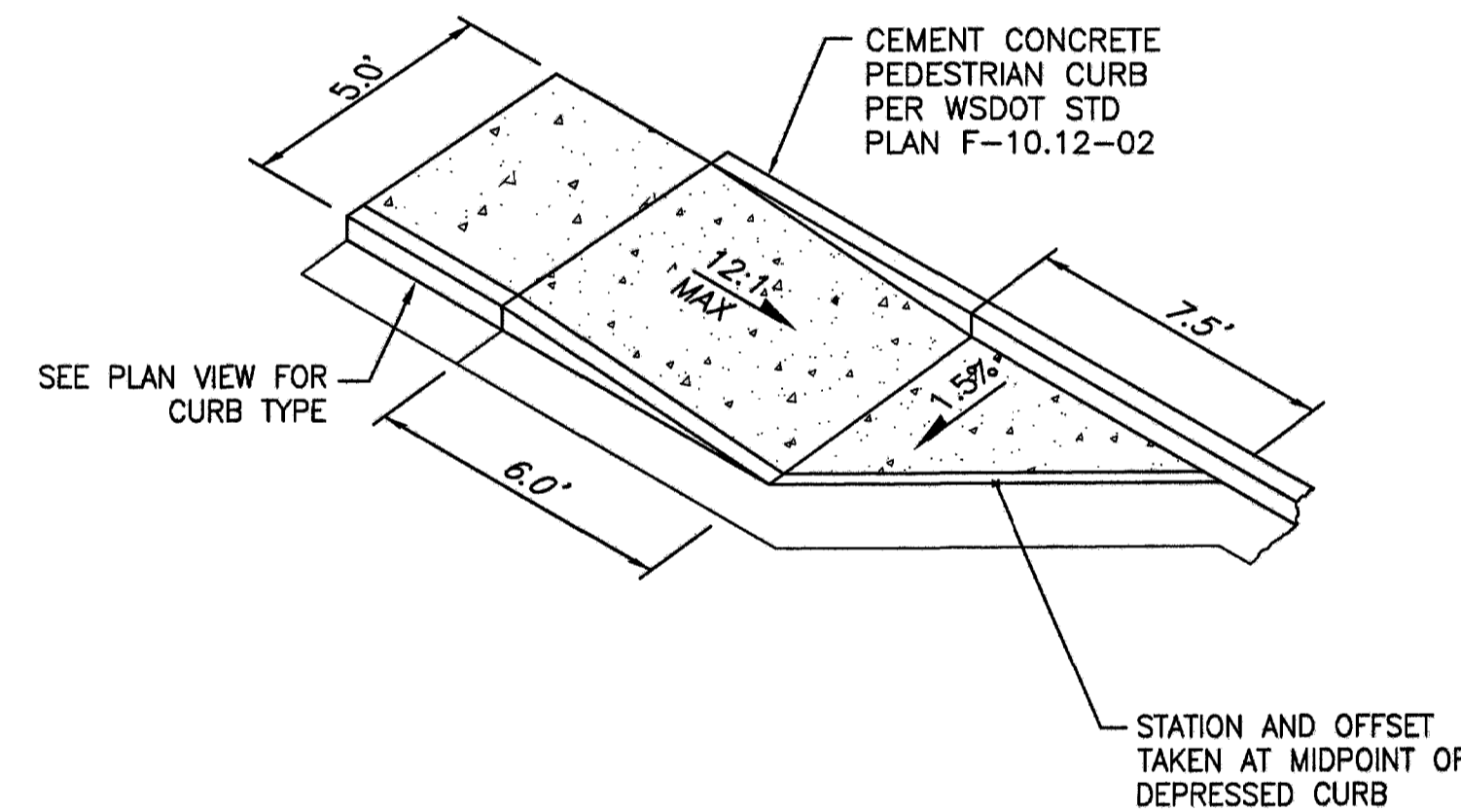

**BICYCLE RAMP**  
NOT TO SCALE

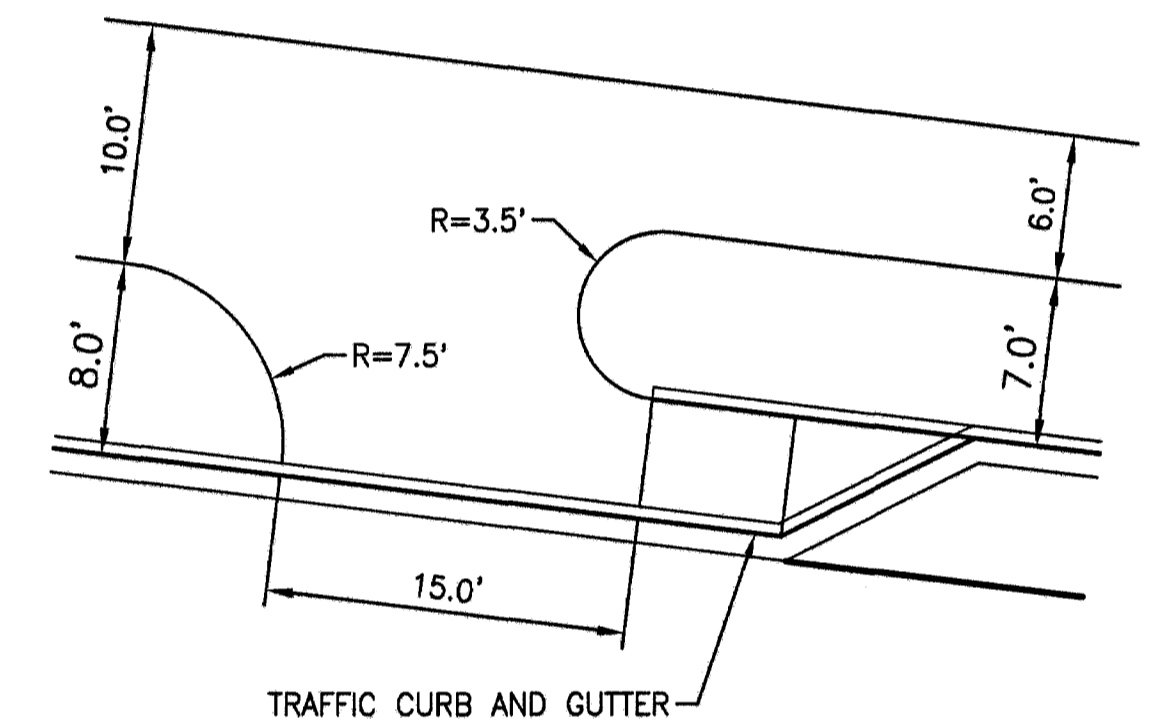

**PLAN VIEW - STA 183+95.7**

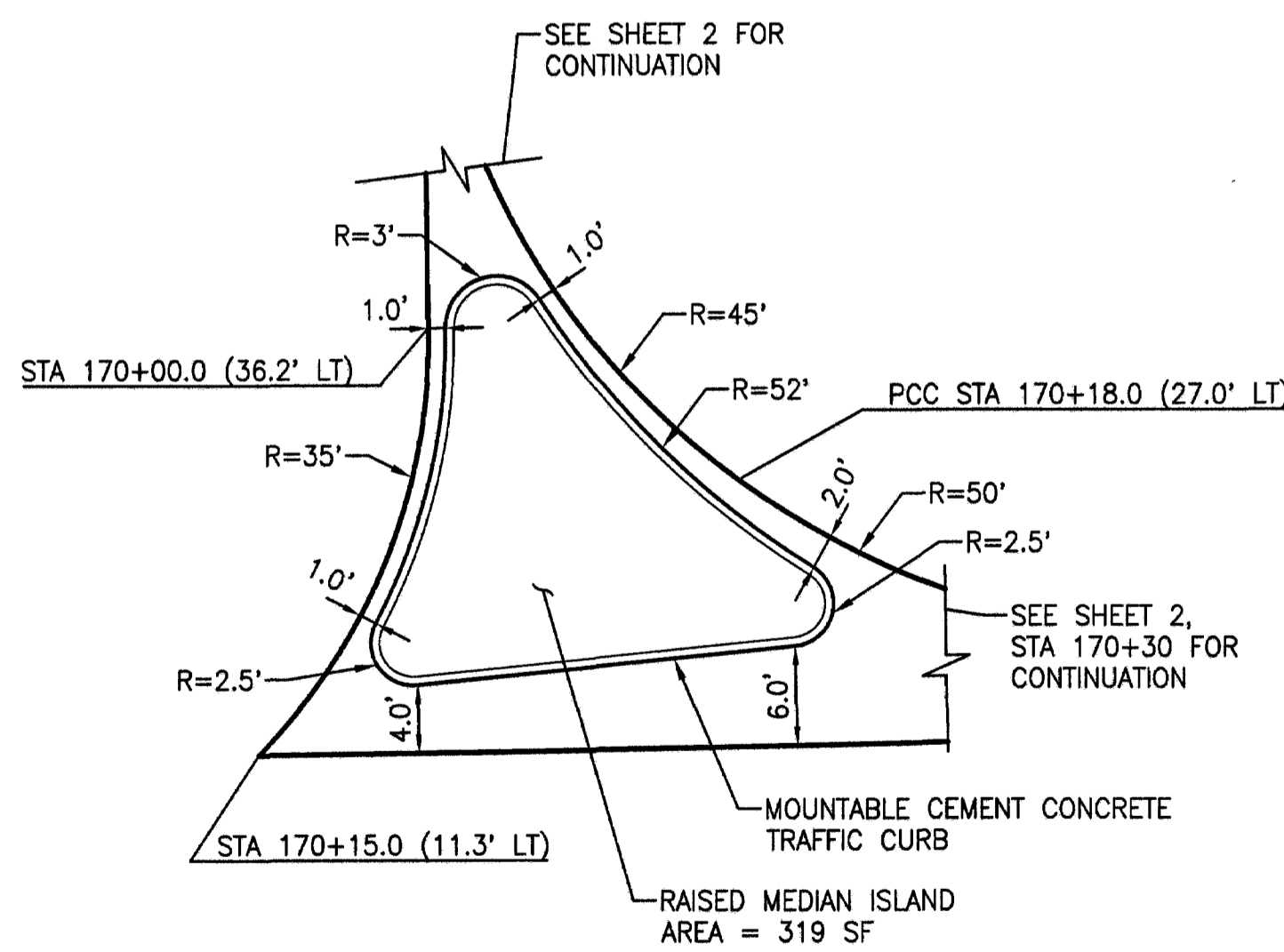

**MEDIAN ISLAND A**  
NOT TO SCALE

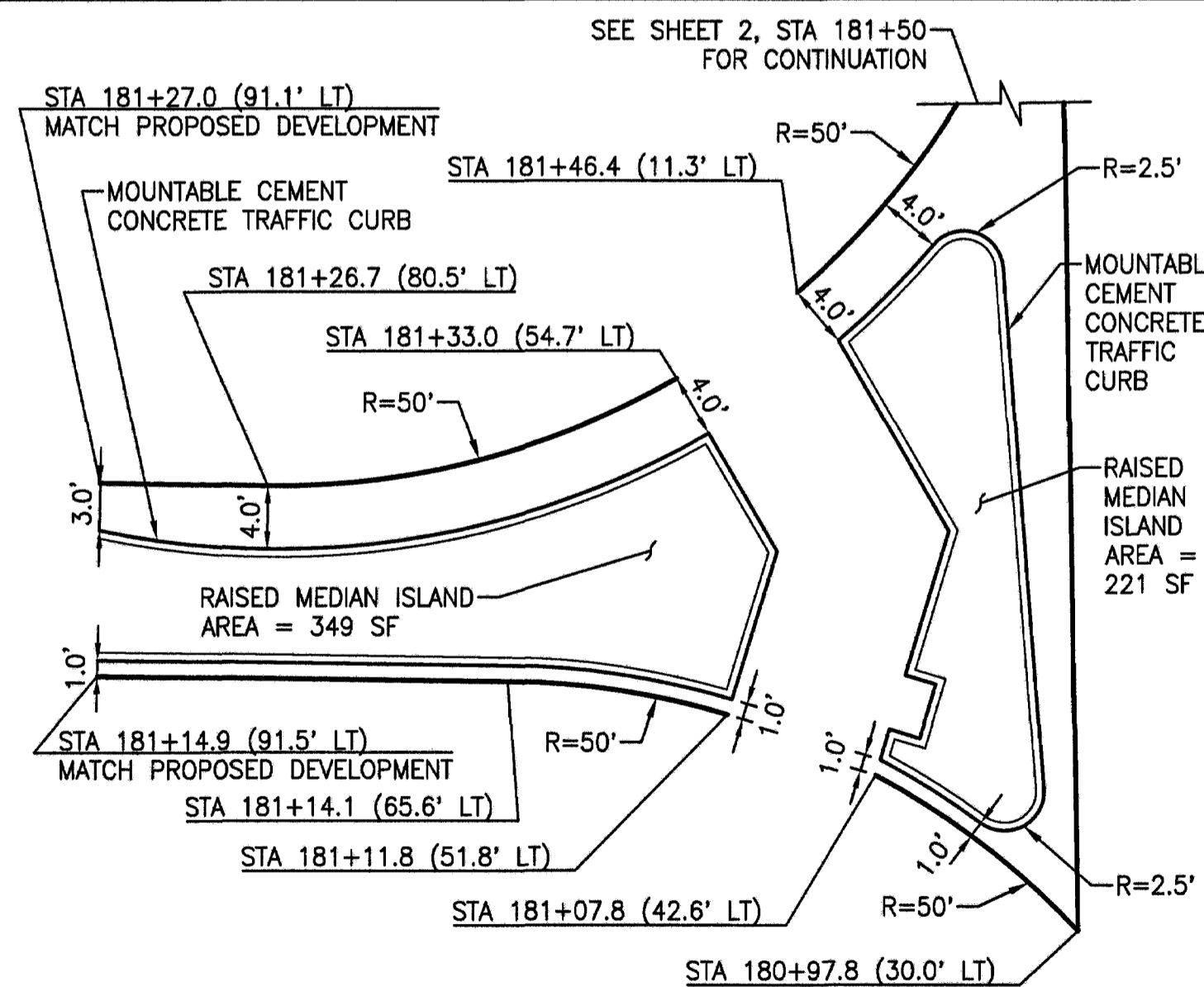

**MEDIAN ISLAND B**  
NOT TO SCALE

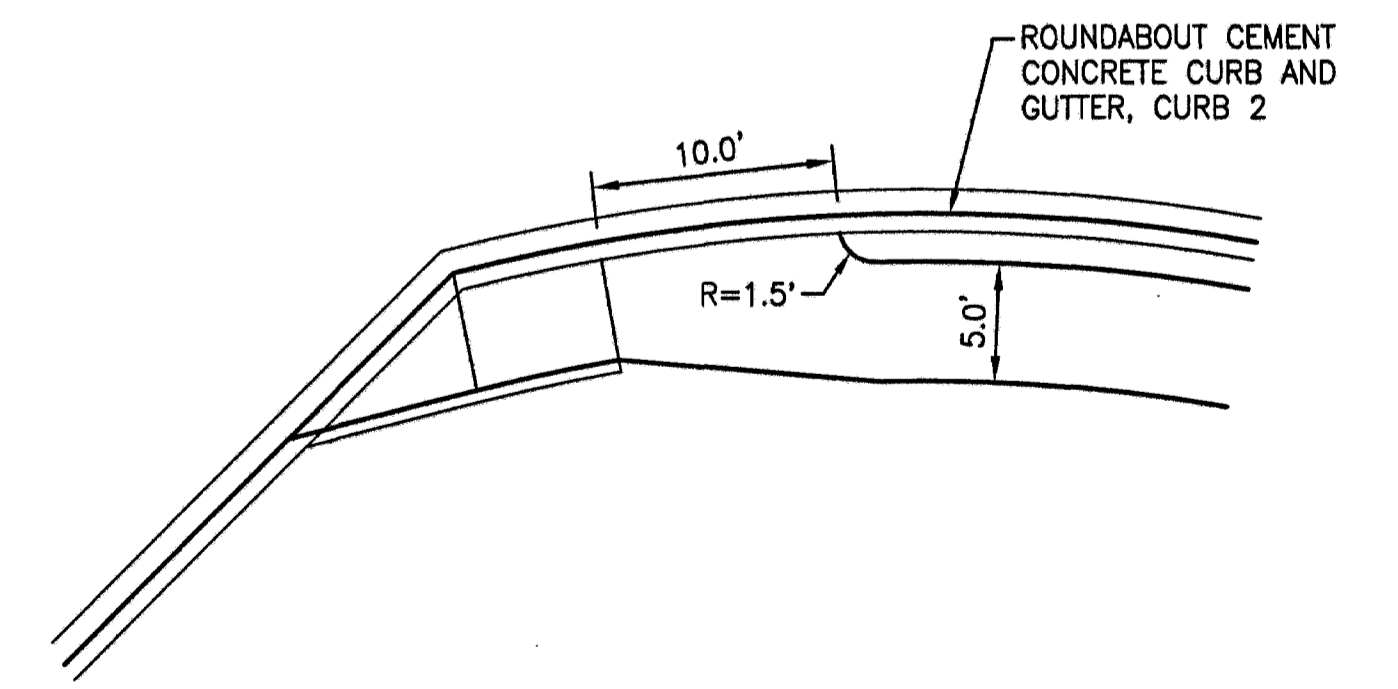

**PLAN VIEW - STA 173+21.4**

FILE NAME	REGION NO.	STATE	FED. AID PROJ. NO.			<b>ReidMiddleton</b> 728 134th Street SW · Suite 200 Everett, Washington 98204 Ph: 425 741-3800	SR 531	MP 5.8 TO MP 6.1	PLOT 1
TIME DATE 06/2015	NW	WASH					5		
DESIGNED BY RP	JOB NUMBER	CONTRACT NO.	LOCATION NO.				CITY OF MARYSVILLE, SNOHOMISH COUNTY	JUNE 2015	SHEET 5 OF 5 SHEETS
ENTERED BY KGH							LAKESIDE STATION/SR531 ROUNDABOUT		
CHECKED BY RAK							CHANNELIZATION DETAILS		
PROJ. ENGR.									
REGIONAL ADM.	REVISION	DATE	BY						