

GENERAL NOTES

THE GENERAL CONTRACTOR IS TO PROVIDE SUBGRADES 4" BELOW HARD SURFACES PLUS/MINUS .1 FOOT.

ALL ROUGH GRADING SHALL BE POSITIVE, DRAINING AWAY FROM ALL STRUCTURES.

ALL STONES LARGER THAN 1.5" DIAMETER SHALL BE REMOVED FROM THE GROWING MEDIUM.

TOPSOIL SHALL BE PLACED AT A MINIMUM DEPTH OF 4" IN ALL LAWN AND BED AREAS.

TOPSOIL SHALL BE TILLED INTO THE EXISTING SUBGRADE TO ELIMINATE SOIL INTERFACE PROBLEMS.

TOPSOIL SHALL BE TOPSOILS NW 3-WAY MIX OR APPROVED EQUAL.

ALL BED AREAS TO RECEIVE 2" OF FINE GROUND FIR OR HEMLOCK BARK, COMPOSITION MULCHES ARE NOT AN ACCEPTABLE ALTERNATIVE.

TREES AND SHRUBS ARE TO BE PLANTED AT A DEPTH 3/4" HIGHER THAN THE LEVEL THAT THEY WERE GROWN IN THE NURSERY.

BARK MULCH IS NOT TO BE PLACED ABOVE THE ROOT CROWN.

ALL PLANTS SHALL AT LEAST CONFORM TO THE MINIMUM STANDARD ESTABLISHED BY THE AMERICAN ASSOCIATION OF NURSERYMEN.

LAWN AREAS ARE TO BE HYDROSEEDED WITH A PACIFIC NORTHWEST LAWN MIX PER MANUFACTURER'S SPECIFICATIONS, OR APPROVED EQUAL. REMOVE ALL STONES LARGER THAN 1" FROM LAWN AREAS.

SUBSTITUTIONS ARE STRONGLY DISCOURAGED. IF PLANT AVAILABILITY IS A PROBLEM, CONTACT THE LANDSCAPE ARCHITECT FOR SOURCES OR ACCEPTABLE ALTERNATIVES.

IF THE SITE WORK IS DIFFERENT THAN SHOWN ON THE LANDSCAPE PLAN, OR POOR SOILS AND DEBRIS ARE DISCOVERED, REQUIRING CHANGES TO THE LANDSCAPE PLAN, CONTACT THE LANDSCAPE ARCHITECT FOR INSTRUCTION.

THE LANDSCAPE CONTRACTOR IS RESPONSIBLE FOR MAINTAINING THE LANDSCAPE DURING INSTALLATION, UNTIL FINAL ACCEPTANCE BY THE OWNER'S REPRESENTATIVE.

THE LANDSCAPE CONTRACTOR SHALL WARRANTY ALL MATERIALS AND WORKMANSHIP FOR A PERIOD OF ONE YEAR, FROM THE TIME OF FINAL ACCEPTANCE.

DURING THE WARRANTY PERIOD, THE LANDSCAPE CONTRACTOR WILL NOT BE RESPONSIBLE FOR PLANT DEATH CAUSED BY UNUSUAL CLIMATIC CONDITIONS, VANDALISM, THEFT, FIRE, OR POOR MAINTENANCE PRACTICES. THE LANDSCAPE ARCHITECT SHALL HAVE SOLE AUTHORITY TO DETERMINE THE CAUSE OF DEATH.

PLANT COUNTS PROVIDED ARE ESTIMATES ONLY. CONTRACTOR IS RESPONSIBLE FOR CALCULATING ALL FINAL AREA AND COUNTS.

IRRIGATION ASSESSMENT

A FULLY AUTOMATIC IRRIGATION SYSTEM WILL BE INSTALLED, DESIGN WILL BE PROVIDED IN CONSTRUCTION DRAWINGS

Street And Parking Lot Tree Selections:

Acer rubrum 'Bowhall' / Bowhall Maple	2" Caliper	B&B
Fraxinus pennsylvanica 'Patmore' / Patmore Ash	2" Caliper	B&B
Liquidambar styraciflua / Sweetgum	2" Caliper	B&B
Quercus ilicifolia 'Styline' / Honey Locust	2" Caliper	B&B
Acer platanoides 'Emerald Queen' / Norway Maple	2" Caliper	B&B
Tilia cordata / Linden Tree	2" Caliper	B&B
Malus 'Sugar Thyme' / Sugar Thyme Crabapple	2" Caliper	B&B
Liriodendron tulipifera 'Arnold' / Tulip Poplar	2" Caliper	B&B

Evergreen Screening Trees:

Thuja plicata 'Excelsa' / Western Red Cedar	6-8" Height	B&B
Pinus contorta / Shore Pine	6-8" Height	B&B
Chamaecyparis nootkatensis / Alaska Cedar	6-8" Height	B&B
Picea omorika / Serbian Spruce	6-8" Height	B&B
Pseudotsuga menziesii / Douglas Fir	6-8" Height	B&B

Accent Trees:

Cornus Kousa / Korean Dogwood	6-8" Height	B&B
Acer circinnatum / Vine Maple	6-8" Height	B&B
Amelancier alnifolia / Serviceberry	6-8" Height	B&B
Chamaecyparis nootkatensis / Alaska Cedar	6-8" Height	B&B

Evergreen Screening Shrubs:

Prunus laurocerasus 'Otto Luyken' / Otto Luyken Laurel	24" Height	Container Grown
Rhododendron 'Anah Kruschke' / Anna Kruschke Rhododendron	24" Height	Container Grown
Ilex x 'Blue Princess' / Blue Princess Holly	24" Height	Container Grown
Mahonia aquifolium / Oregon Grape	24" Height	Container Grown
Myrica californica / Wax Myrtle	24" Height	Container Grown

Biofiltration Shrubs:

Cornus Serica / Red Twig Dogwood	2 Gallon	Container Grown
Symphoricarpos albus / Snowberry	2 Gallon	Container Grown
Lonicera involucrata / Twinberry	2 Gallon	Container Grown
Physocarpus capitatus / Ninebark	2 Gallon	Container Grown

Parking Lot Shrubs:

Rhododendron 'Blue Diamond' / Blue Diamond Rhododendron	21" Height	Container Grown
Viburnum davidii / David's Viburnum	21" Height	Container Grown
Osmarthus delavayi / N.C.N.	21" Height	Container Grown
Spiraea 'Big Bang' / Big Bang Spiraea	21" Height	Container Grown

Foundation Shrubs:

Pieris japonica / Andromeda	21" Height	Container Grown
Rhododendron 'Uniques' / Unique Rhododendron	21" Height	Container Grown
Spiraea 'Limemound' / Limemound Spiraea	21" Height	Container Grown
Viburnum davidii / David's Viburnum	21" Height	Container Grown

Garbage Collection Screening:

Thuja occidentalis 'Emerald Green' / Emerald Green Arborvitae	5' Height	B&B
---	-----------	-----

Groundcovers:

Lonicera pileata / Box Leaf Honeysuckle	1 Gallon	30" On Center
Arctostaphylos uva ursi / Bearberry	4" Pots	24" On Center
Cotoneaster dammeri / Bearberry Cotoneaster	1 Gallon	30" On Center

- 22C.120.180 Landscaping - Maintenance.
- (1) All landscaped areas and plants required by this chapter must be permanently maintained in a healthy growing condition in order to accomplish the purpose for which they were required.
 - (2) Dead or diseased plants must be replaced within 30 days of notification, or as soon as practical in regard to freezing weather, or complex situations involving the removal and replacement of large trees.
 - (3) All landscaped areas must be kept free of debris and weeds.
 - (4) Plant material must not interfere with public utilities, restrict pedestrian or vehicular access, or constitute a traffic hazard.
 - (5) Planted areas next to pedestrian walkways and sidewalks shall be maintained or plant material chosen to maintain a clear zone between three and eight feet from ground level.
 - (6) The owners, their agents and assigns are responsible for providing, protecting, and maintaining all landscaping material in a healthy and growing condition, replacing it when necessary, and keeping it free of litter, debris, and weeds. (Ord. 2852 § 10 (Exh. A), 2011).
 - (7) All fencing, walls and other features used for screening purposes shall be kept free of litter, debris, and weeds. (Ord. 2852 § 10 (Exh. A), 2011).

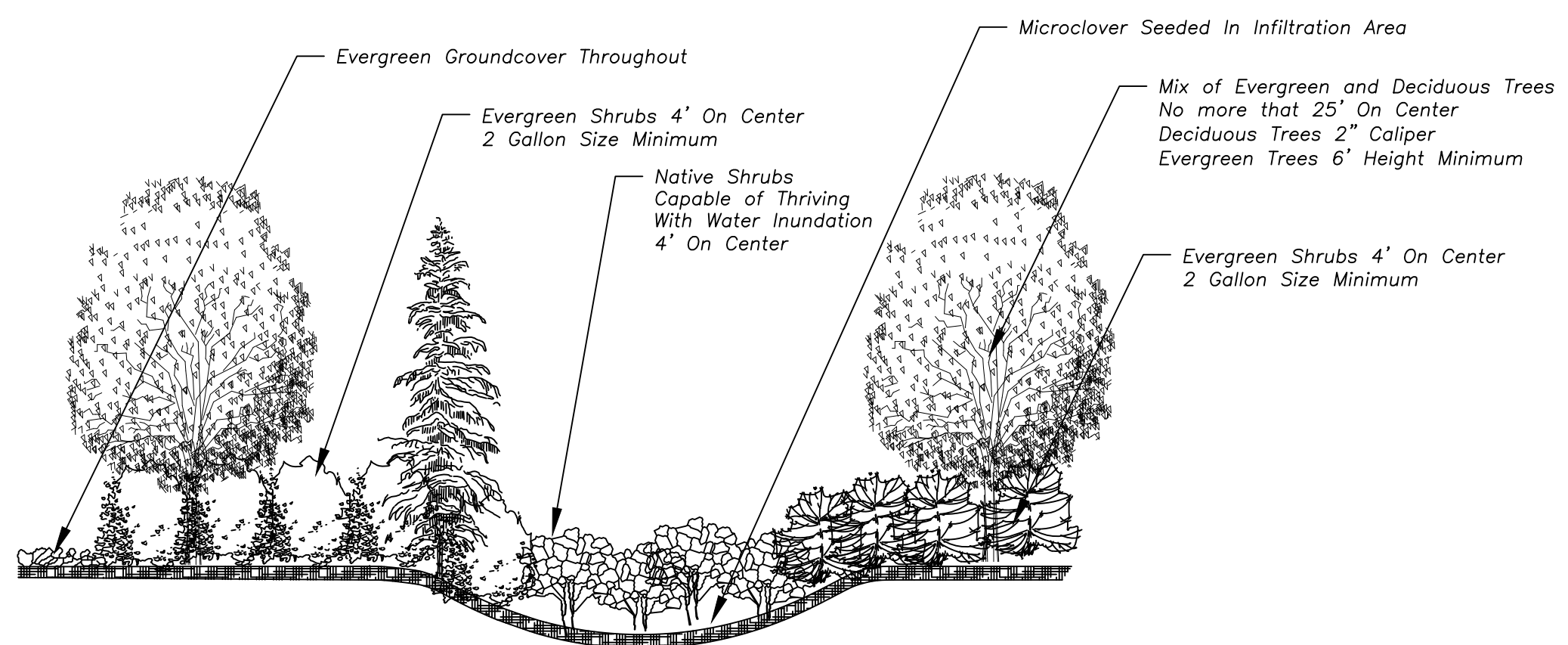
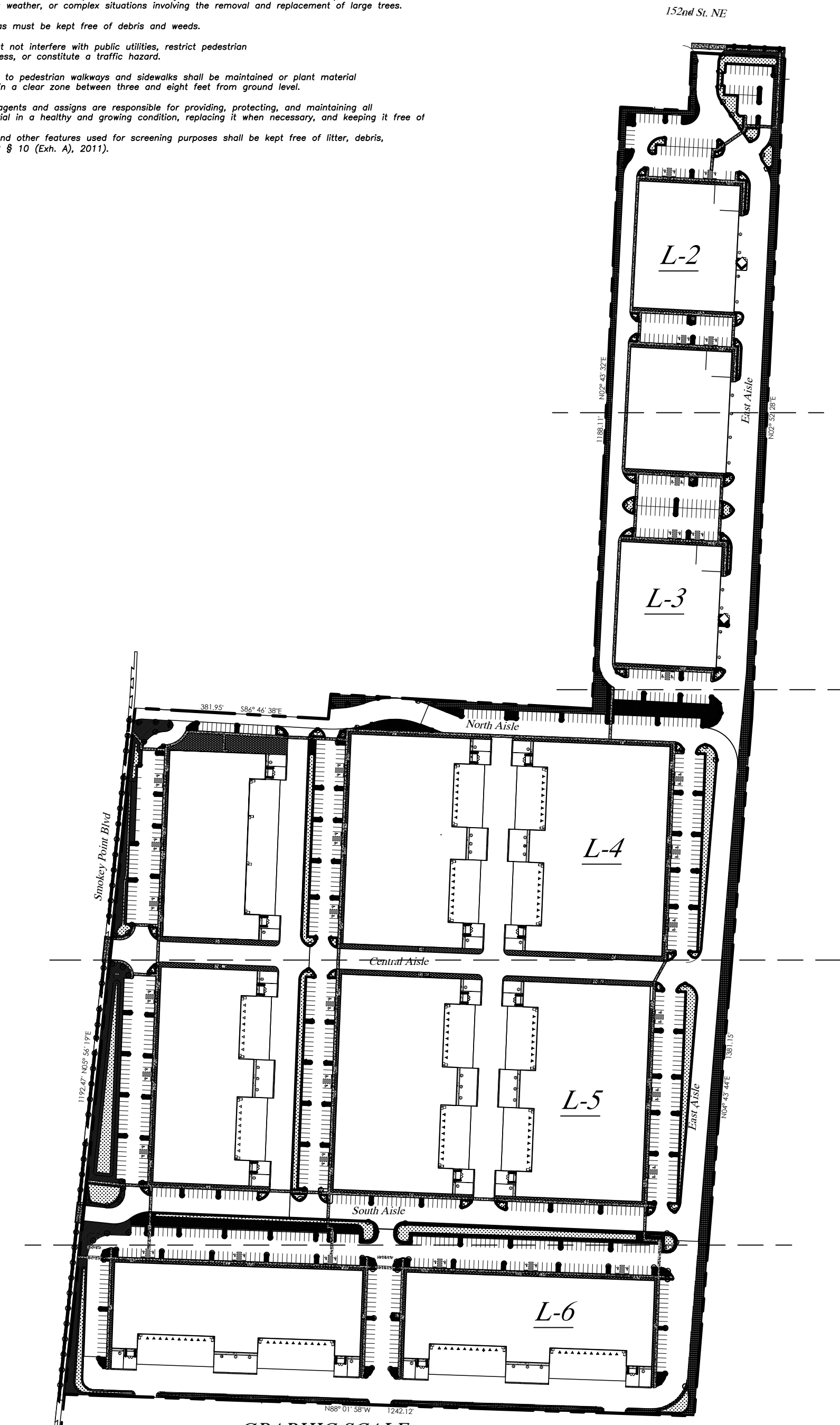

**L-3 Landscape (typ).
Not To Scale**

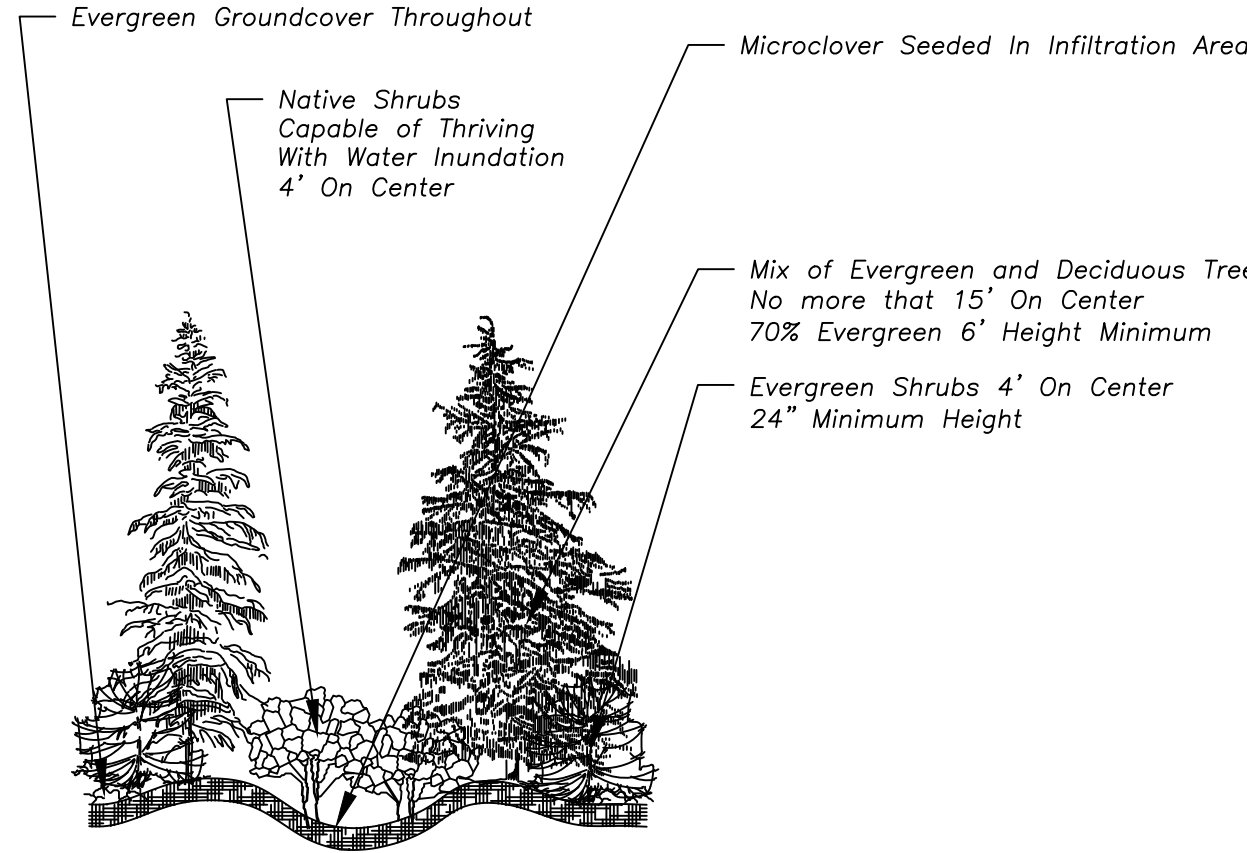

**L-1 Landscape with
Infiltration
Not To Scale**

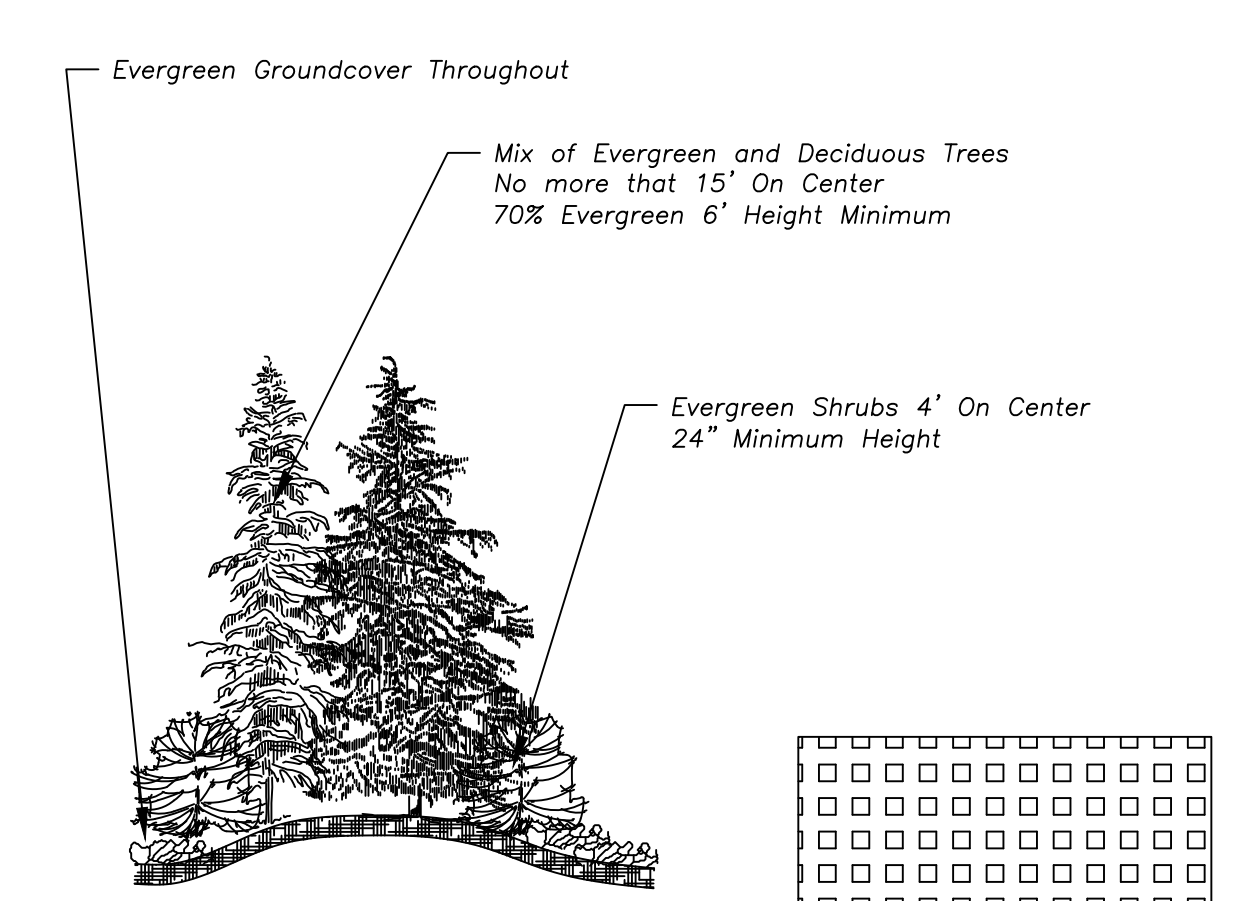

**L-1 Landscape (typ).
Not To Scale**

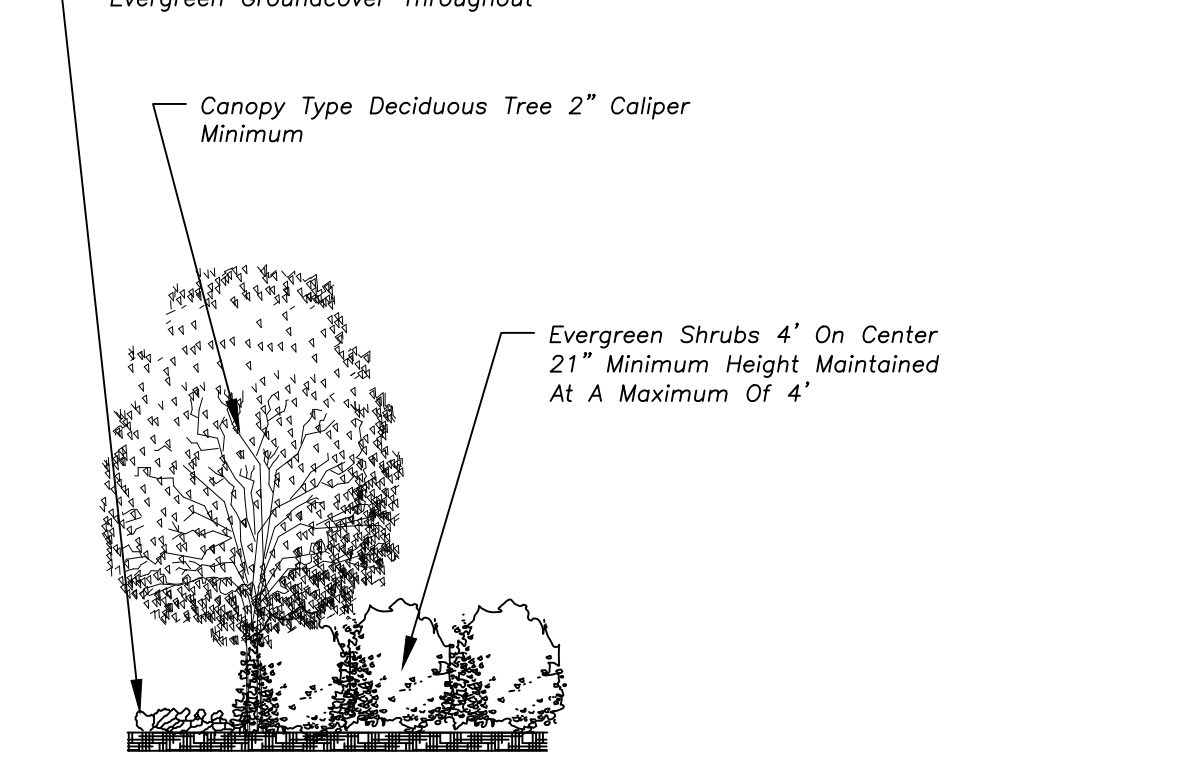

**L-4 Landscape (typ).
Not To Scale**

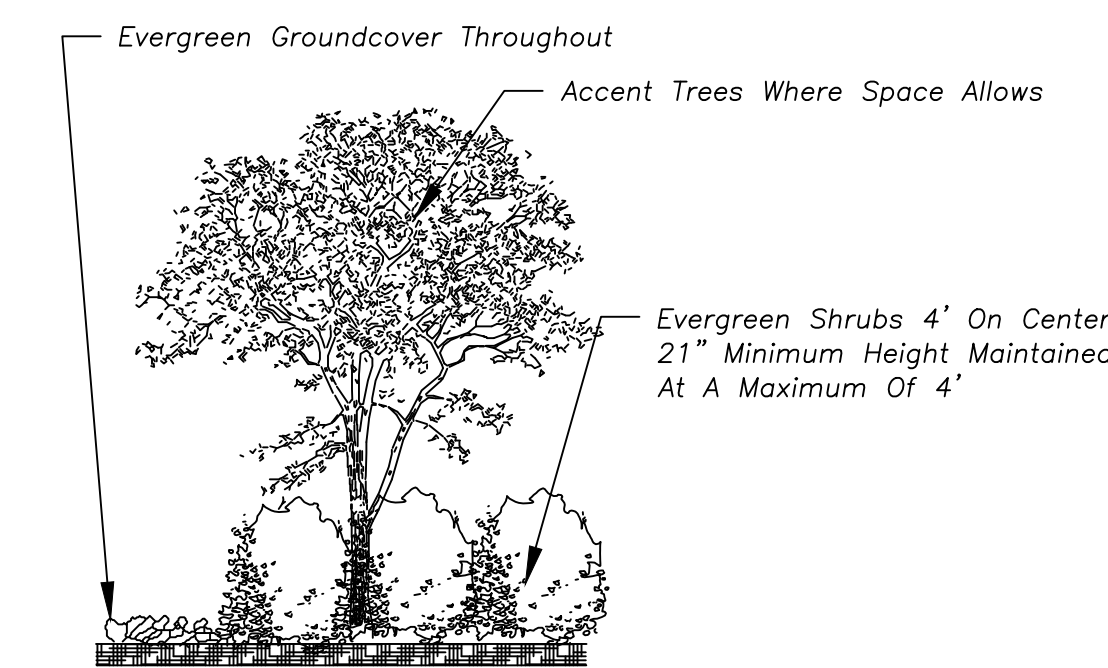

**Foundation Plantings (typ).
Not To Scale**

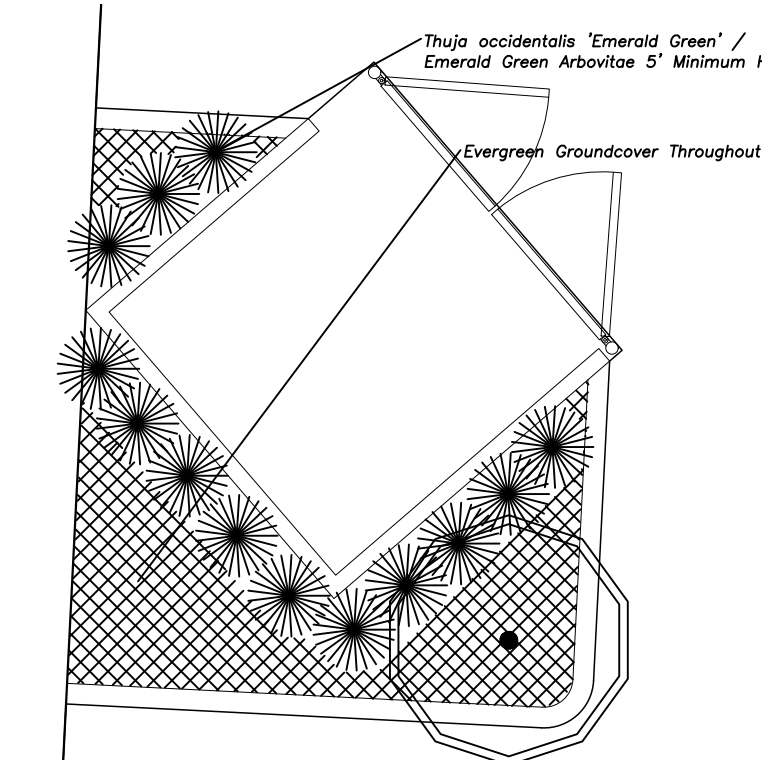

**Waste Area Screening (typ).
Not To Scale**

BY	
REVISION	
DATE	

**Paul Jay
Landscape Architect**
1115 Bridges Road
East 380 659 8159
c. 425.210.1986
e. pauljayla@gmail.com

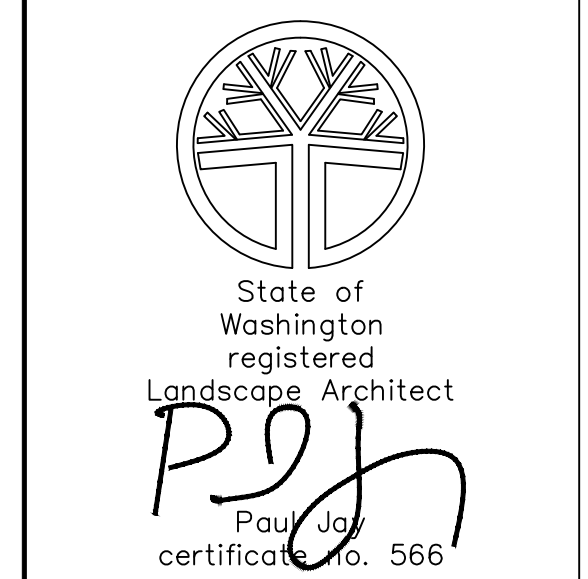

**Undi Commerce Park
Undi Development LLC
PRELIMINARY LANDSCAPE PLAN**

APPLICANT:
Landtechnologies

DATE:
1.5.23

PJLA JOB NO.:
DRAWN BY: PJ

CHECKED BY: PJ

LANDSCAPE PLAN

SHEET
L-1
OF 6

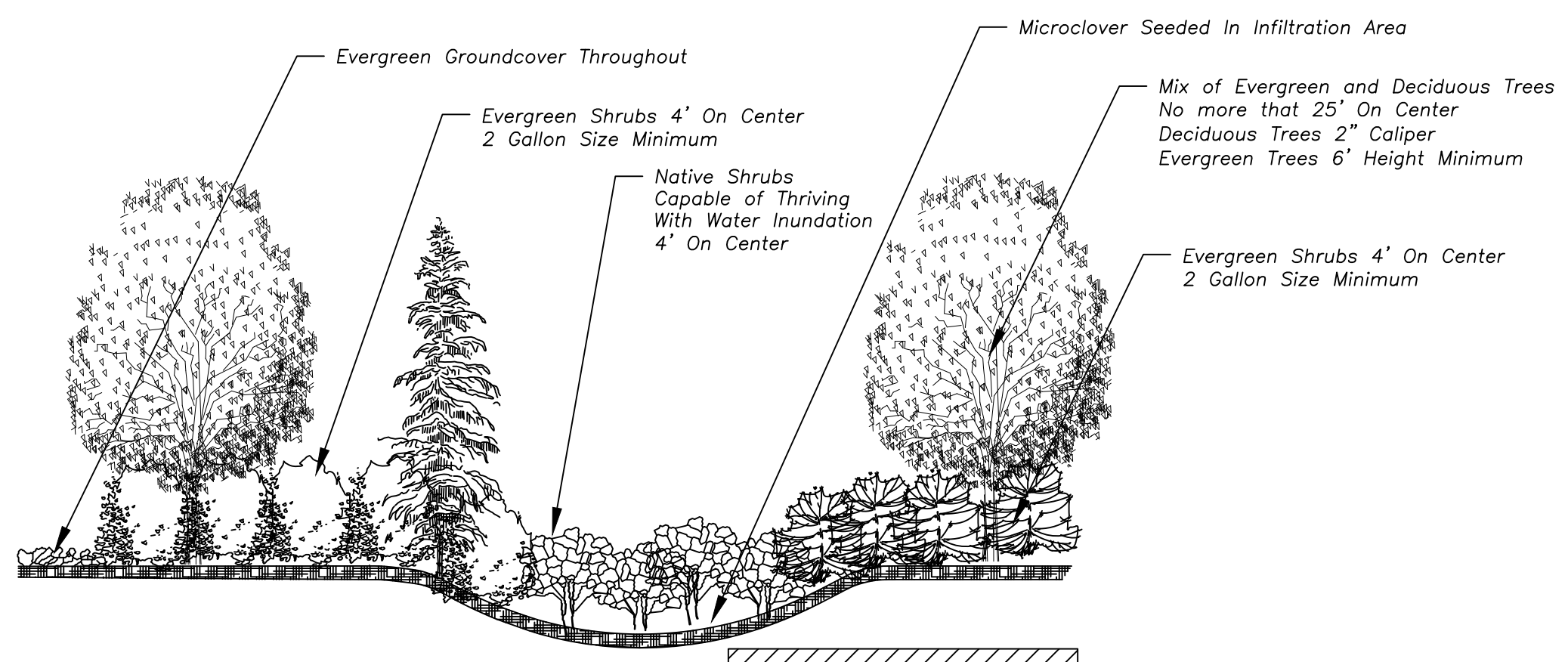
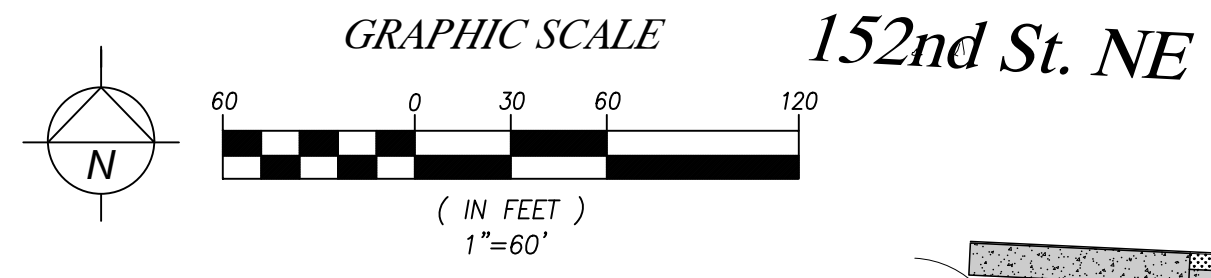

L-3 Landscape (typ).
Not To Scale

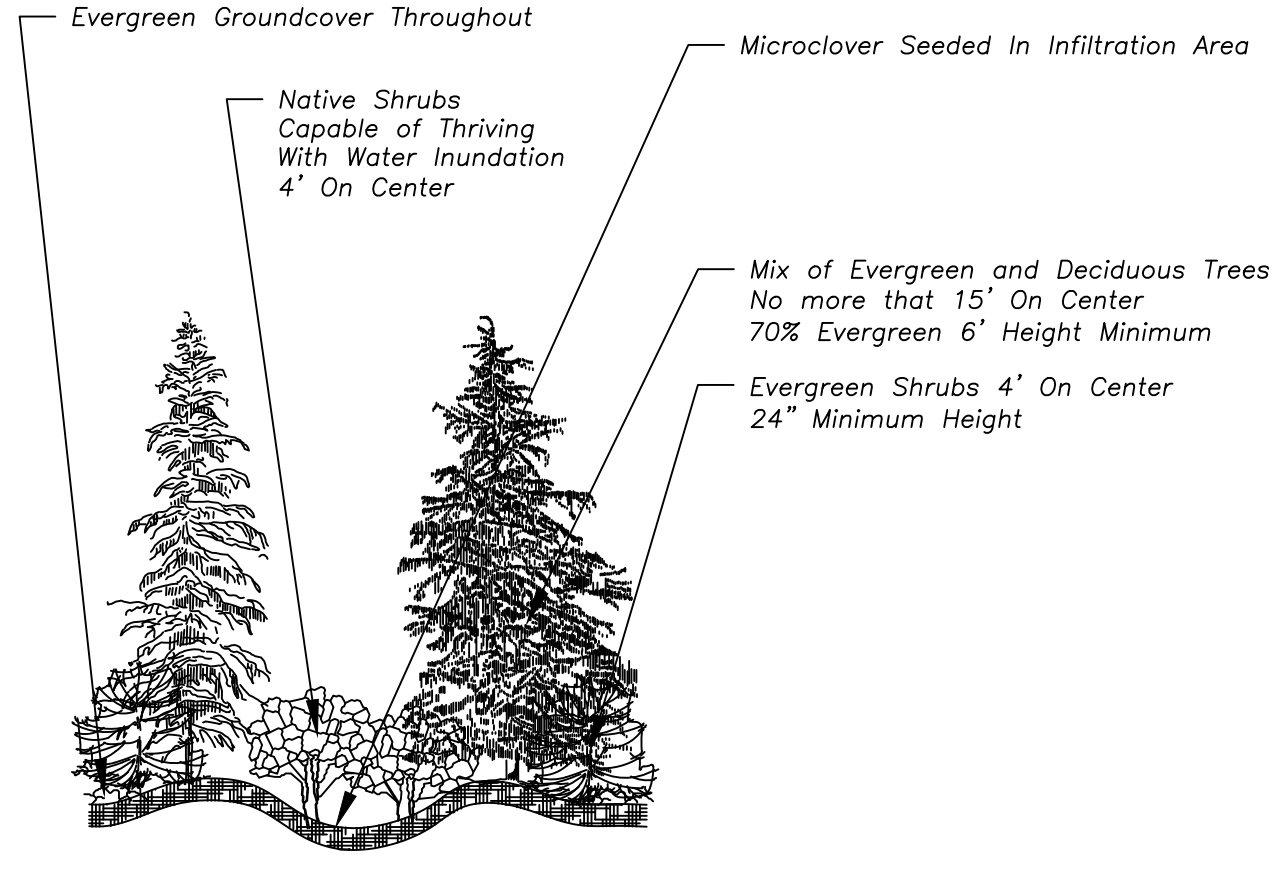

L-1 Landscape with Infiltration
Not To Scale

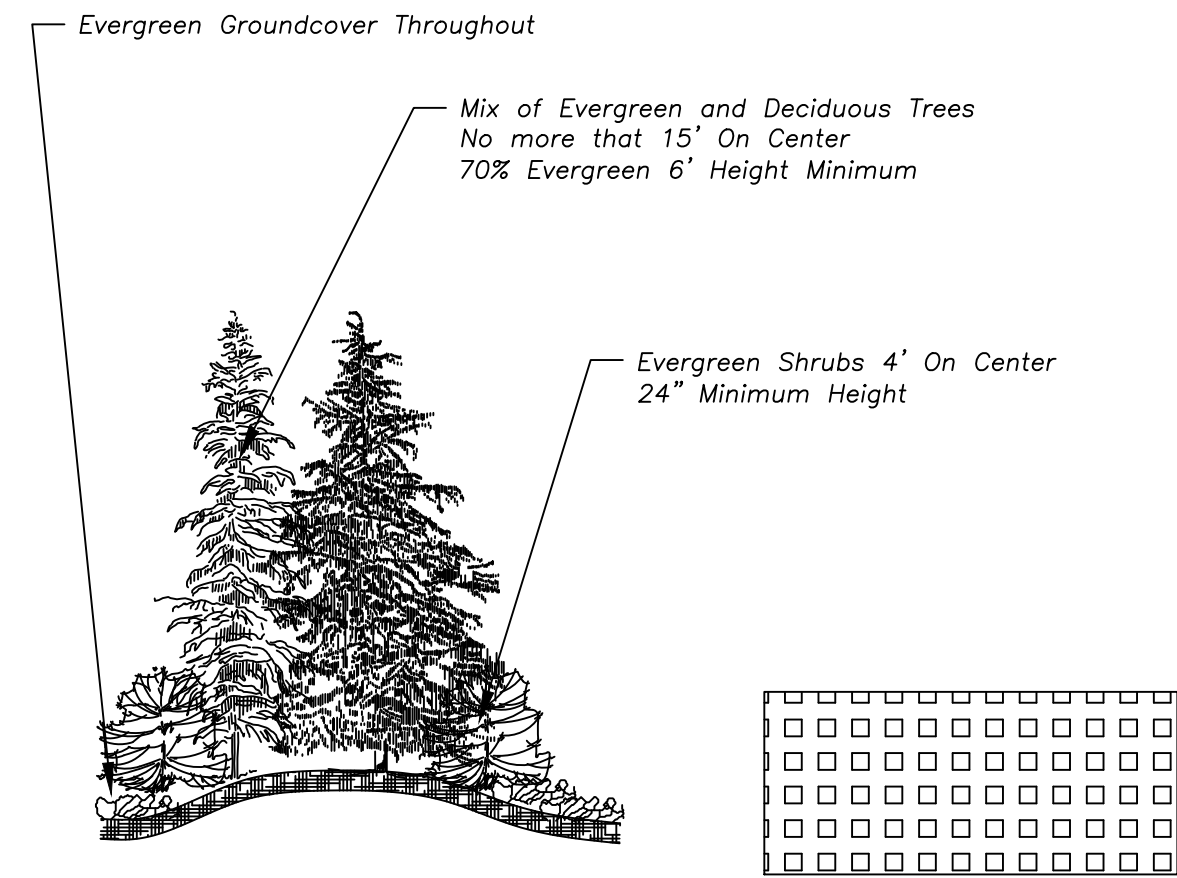

L-1 Landscape (typ).
Not To Scale

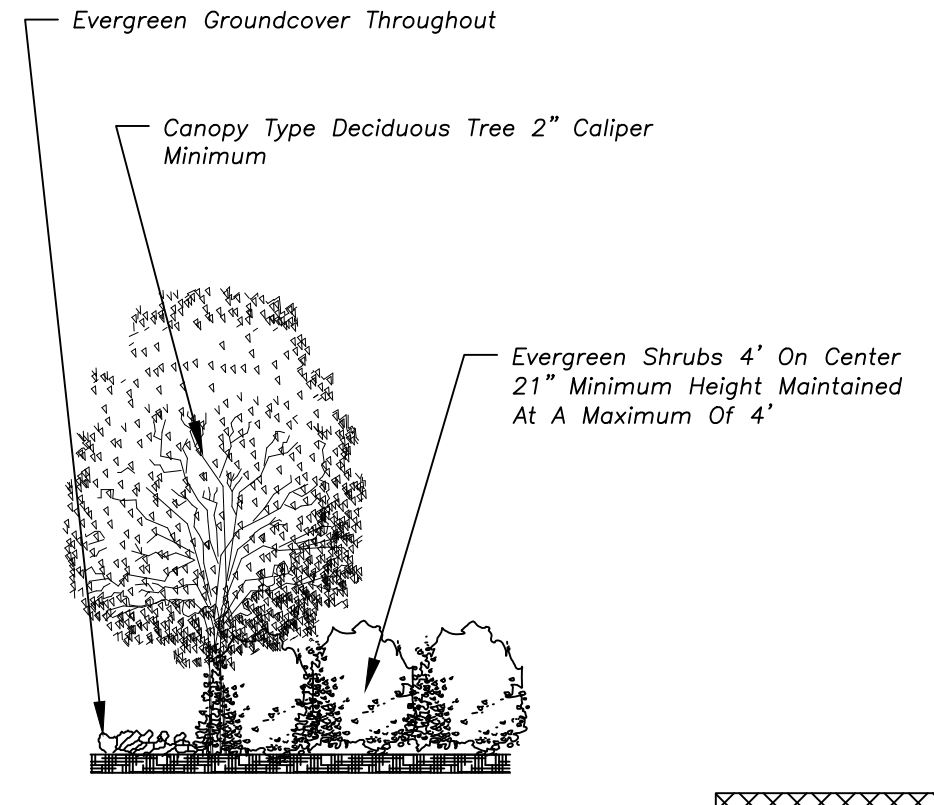

L-4 Landscape (typ).
Not To Scale

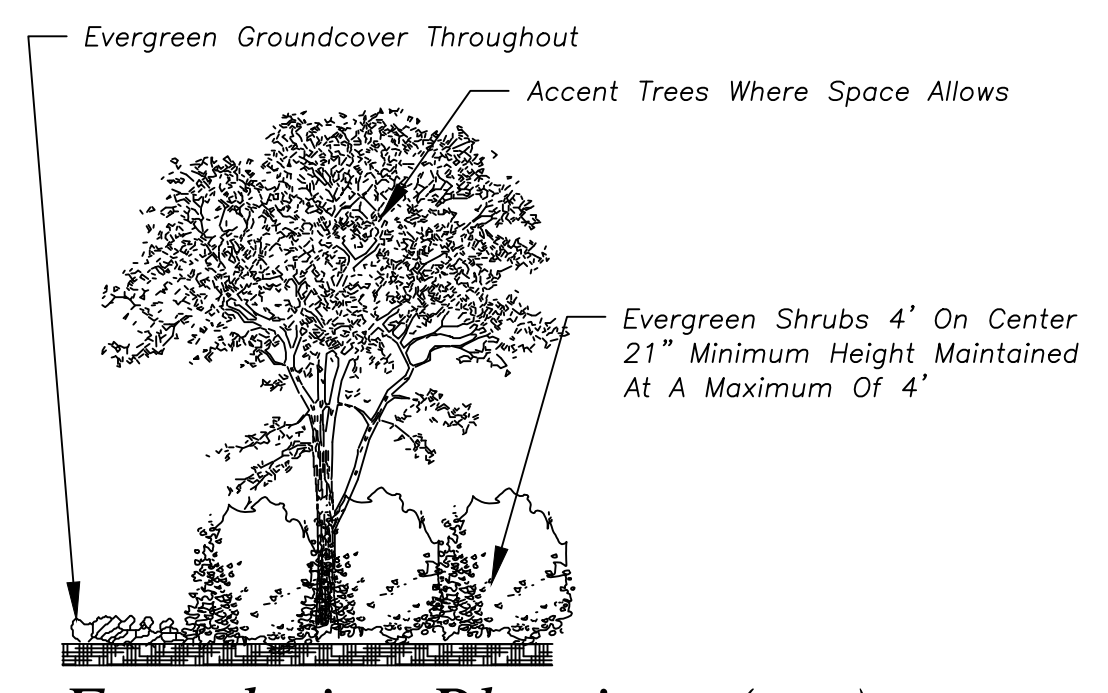

Foundation Plantings (typ).
Not To Scale

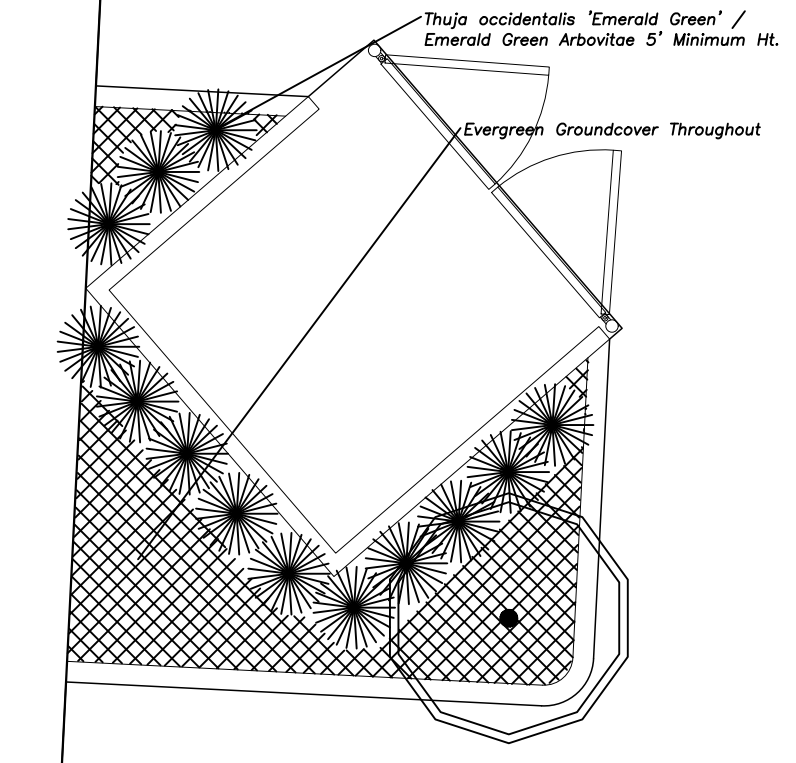

Waste Area Screening (typ).
Not To Scale

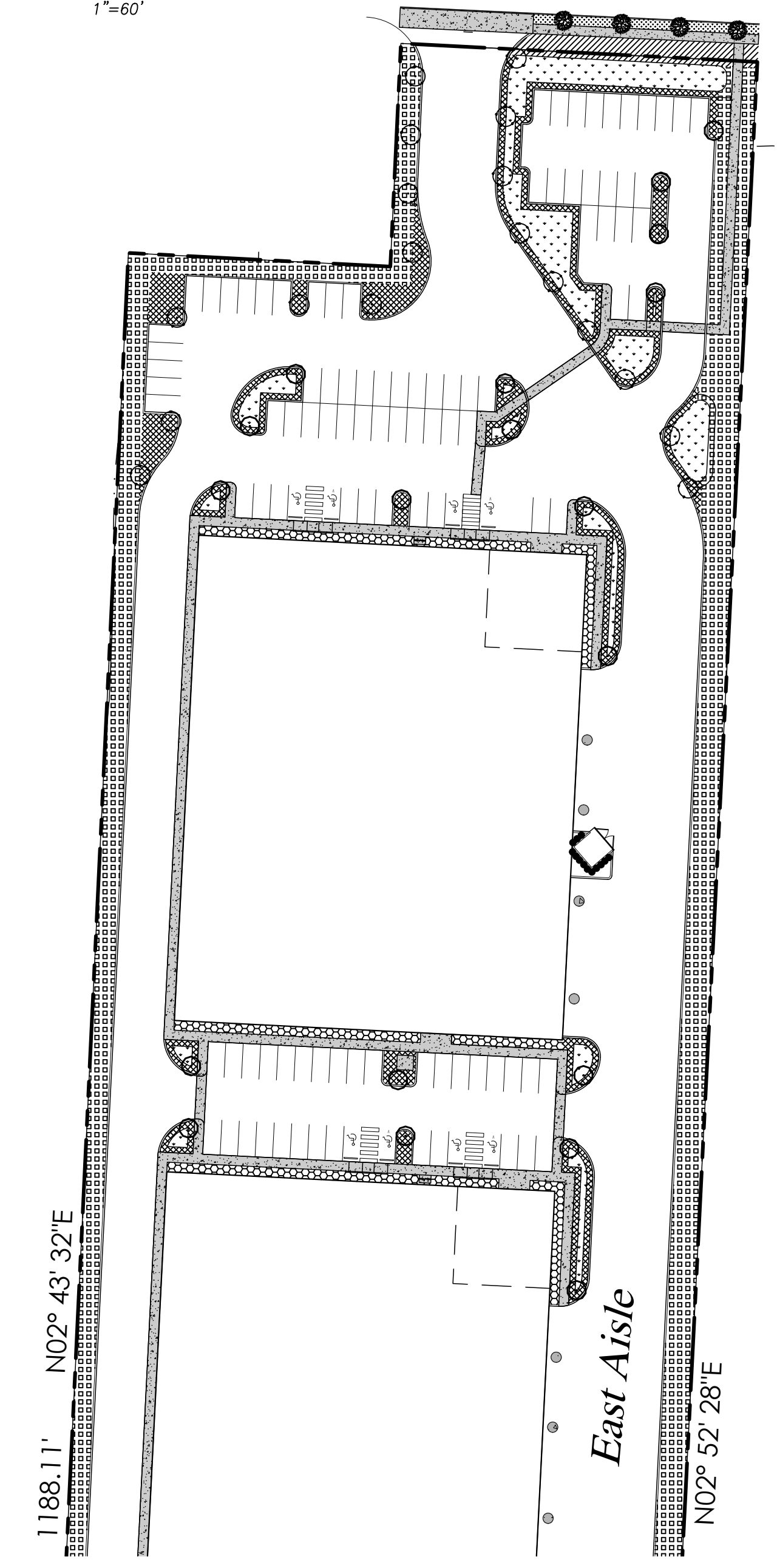

BY	REVISION	DATE

Paul Jay
Landscape Architect
1115 Bridges Road
East 380 659 8159
c. 425.210.1986
e. pauljay@aol.com



Undi Commerce Park
Undi Development LLC
PRELIMINARY LANDSCAPE PLAN

APPLICANT:
Landtechnologies

DATE:
1.5.23

PJLA JOB NO.:
DRAWN BY: PJ

CHECKED BY: PJ

LANDSCAPE PLAN

SHEET
L-2
OF 6

Jan 07, 2024 - 10:38am Paul E:\SvData\Company\Projects\2024\Cape Cod\Undi Commerce Park\Plans\L-2.dwg Layout Name: L-2

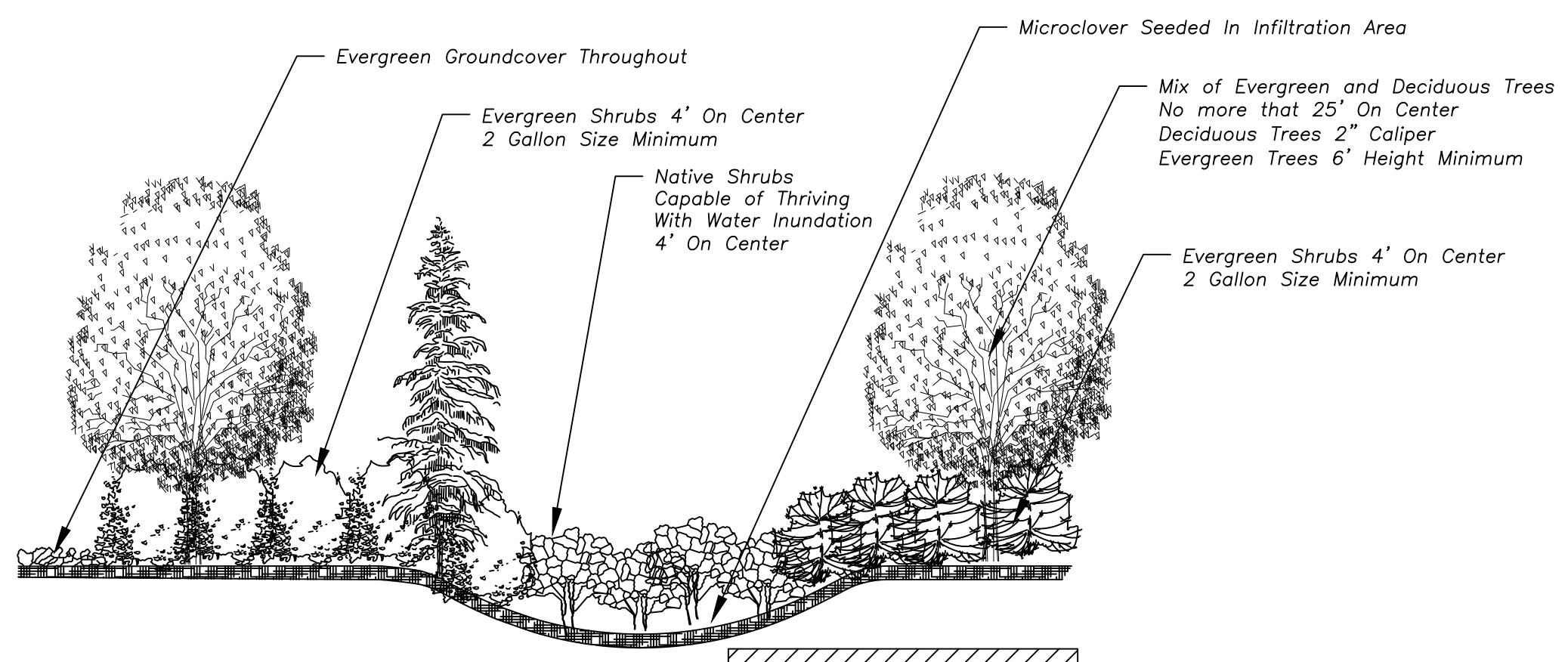
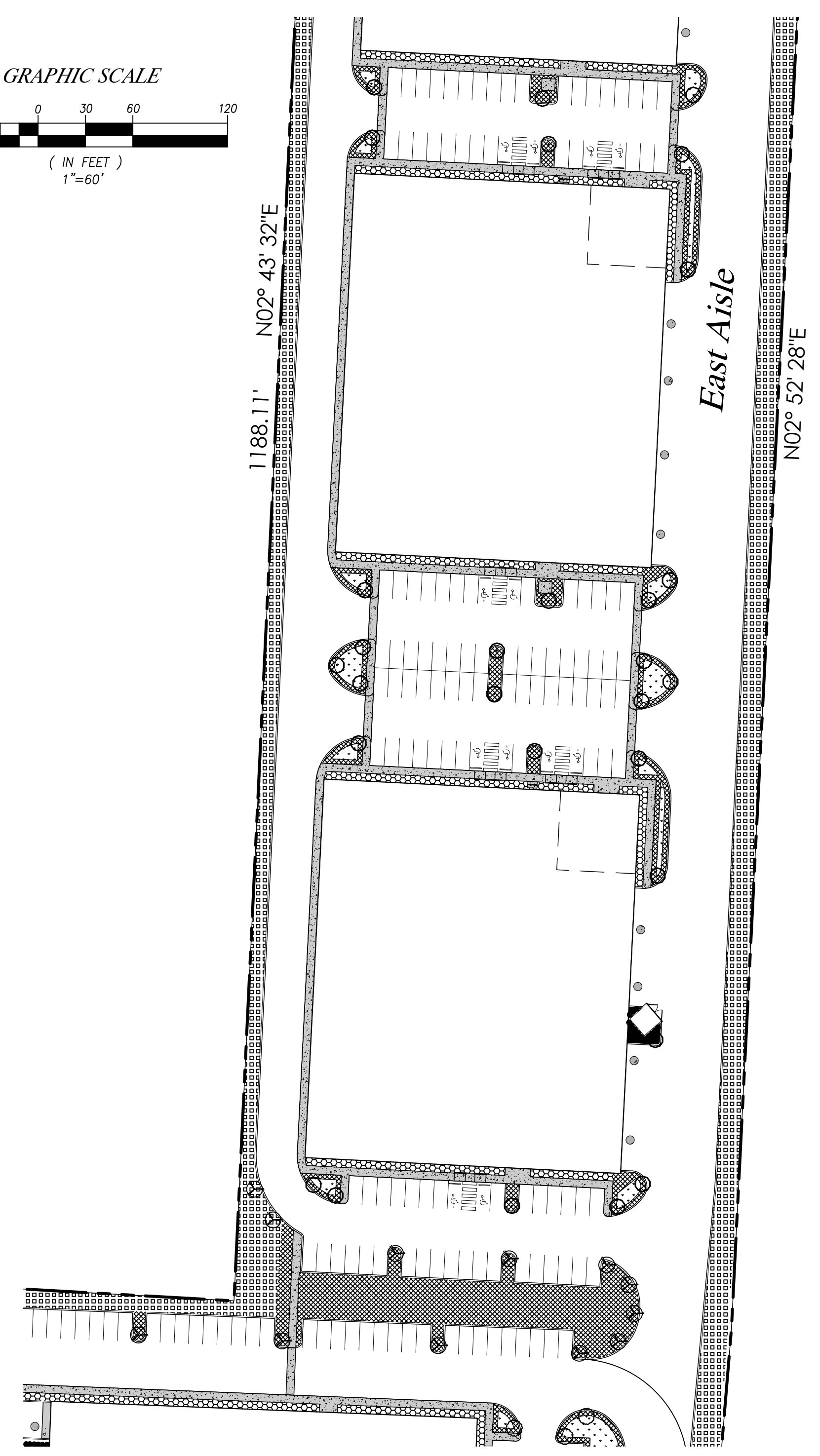
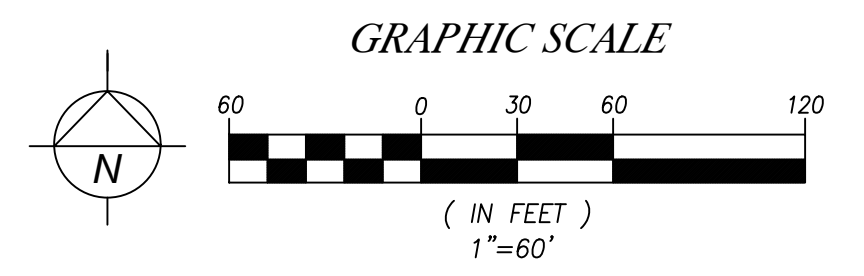

*L-3 Landscape (typ).
Not To Scale*

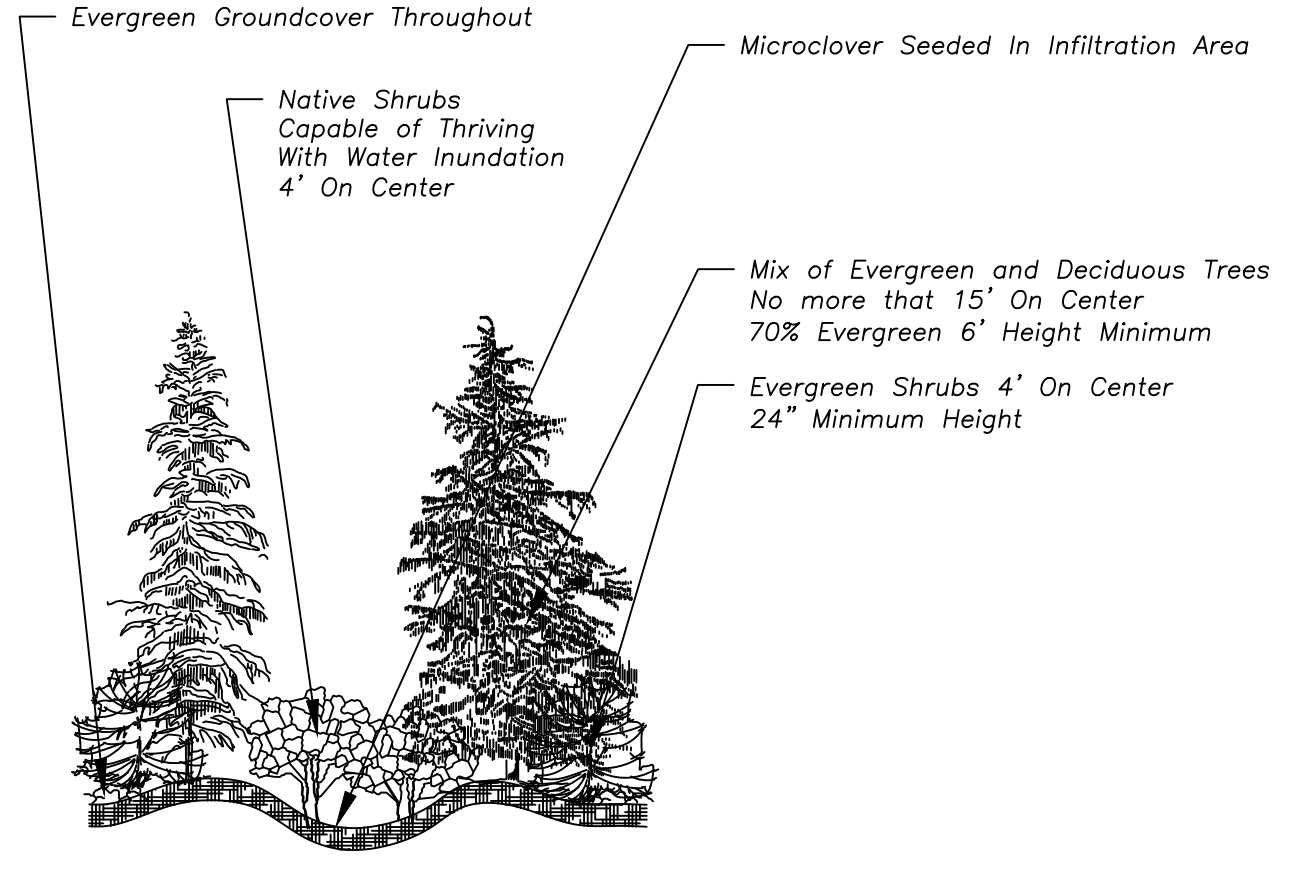

*L-1 Landscape with
Infiltration
Not To Scale*

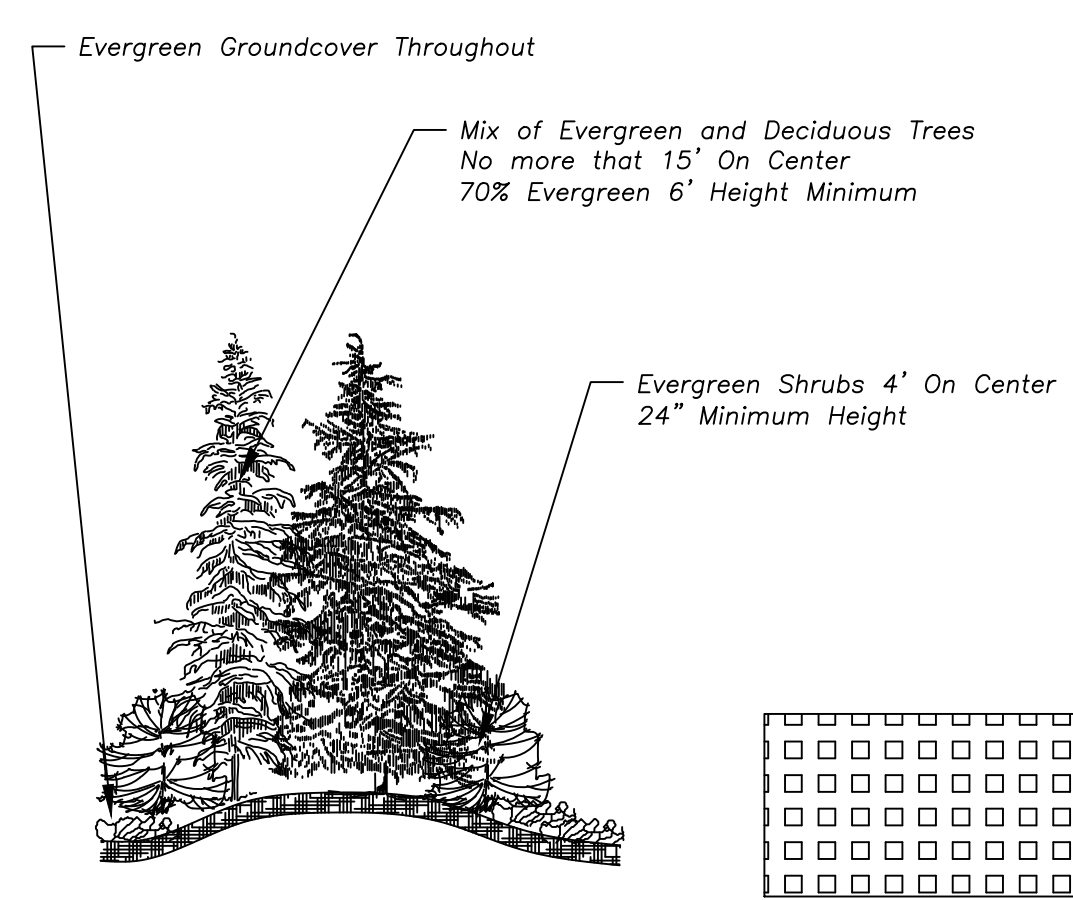

*L-1 Landscape (typ).
Not To Scale*

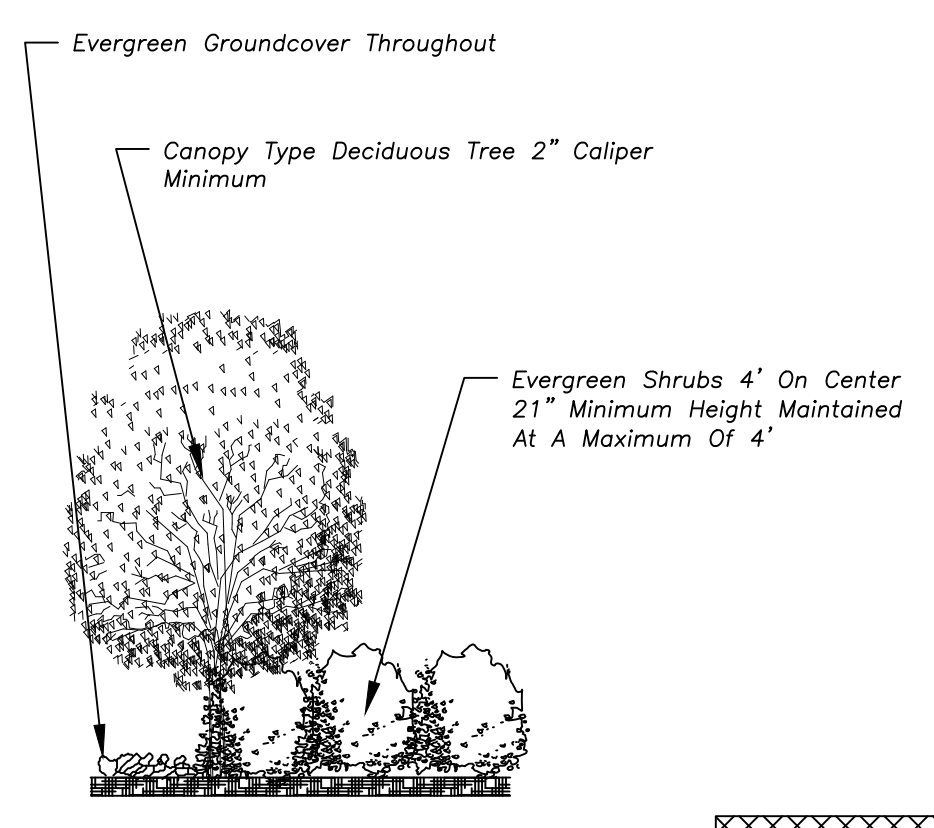

*L-4 Landscape (typ).
Not To Scale*

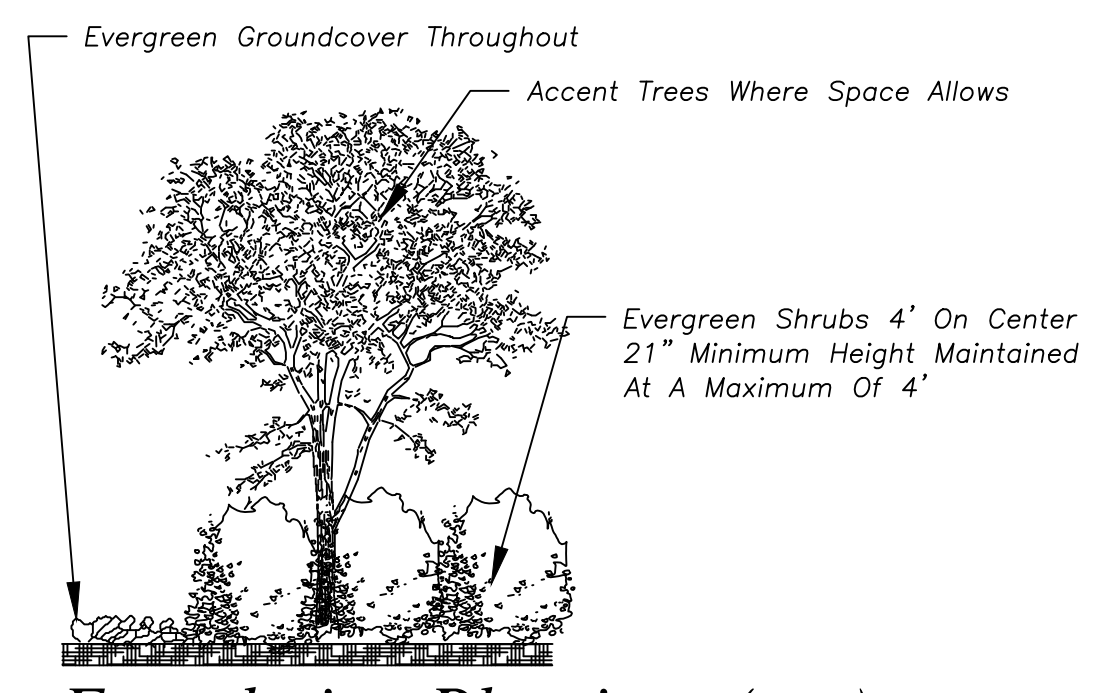

*Foundation Plantings (typ).
Not To Scale*

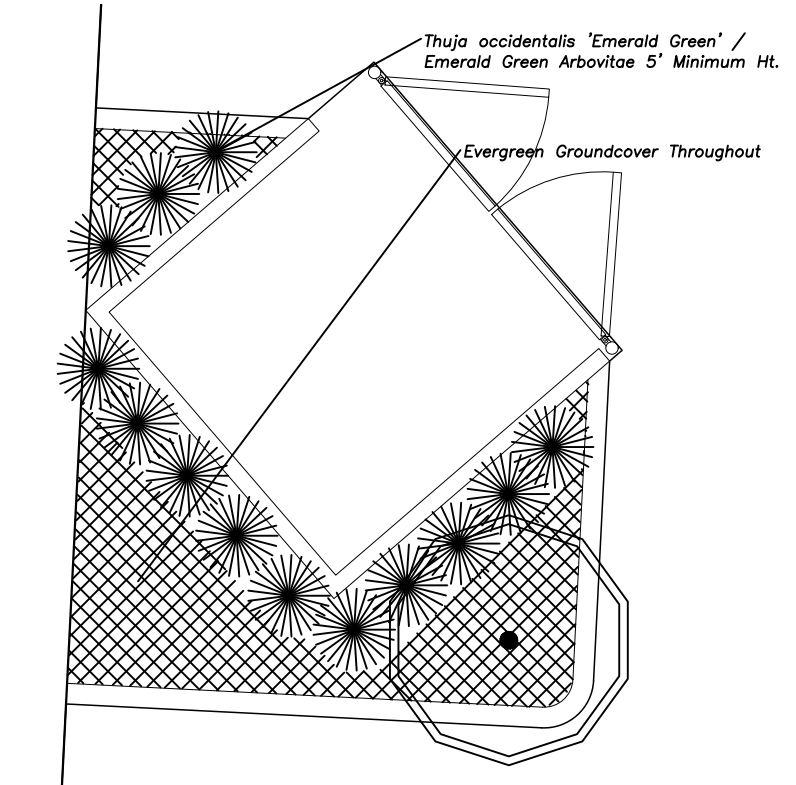

*Waste Area Screening (typ).
Not To Scale*

DATE	REVISION	BY

Paul Jay
Landscape Architect
1115 Bridges Road
Easton, MA 02842
t. 425.210.1986
e. pauljay@aol.com

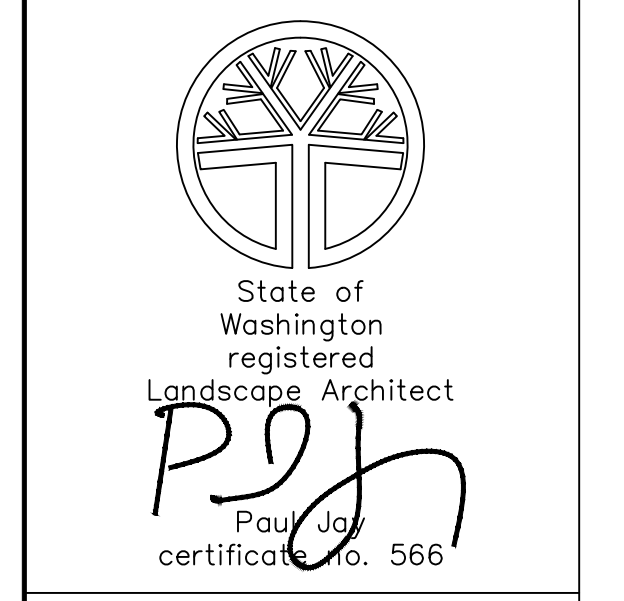

Undi Commerce Park
Undi Development LLC
PRELIMINARY LANDSCAPE PLAN

APPLICANT:	Landtechnologies
DATE:	1.5.23
PJLA JOB NO.:	
DRAWN BY:	PJ
CHECKED BY:	PJ
LANDSCAPE PLAN	
SHEET	L-3 OF 6

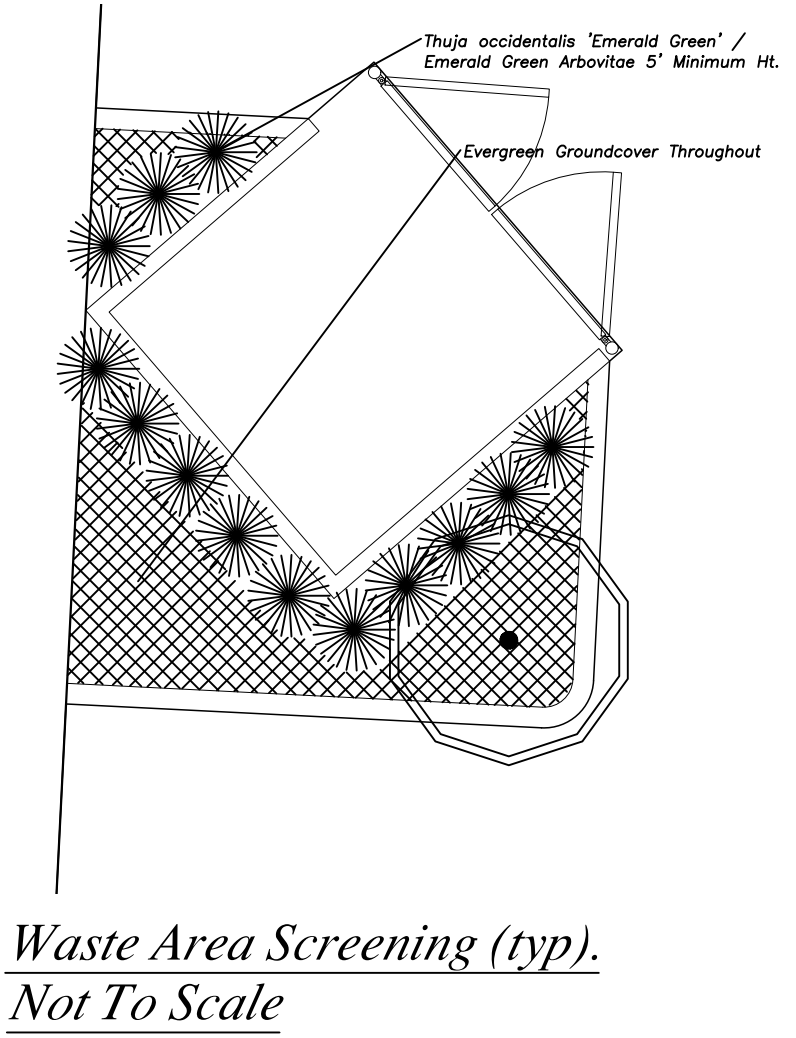
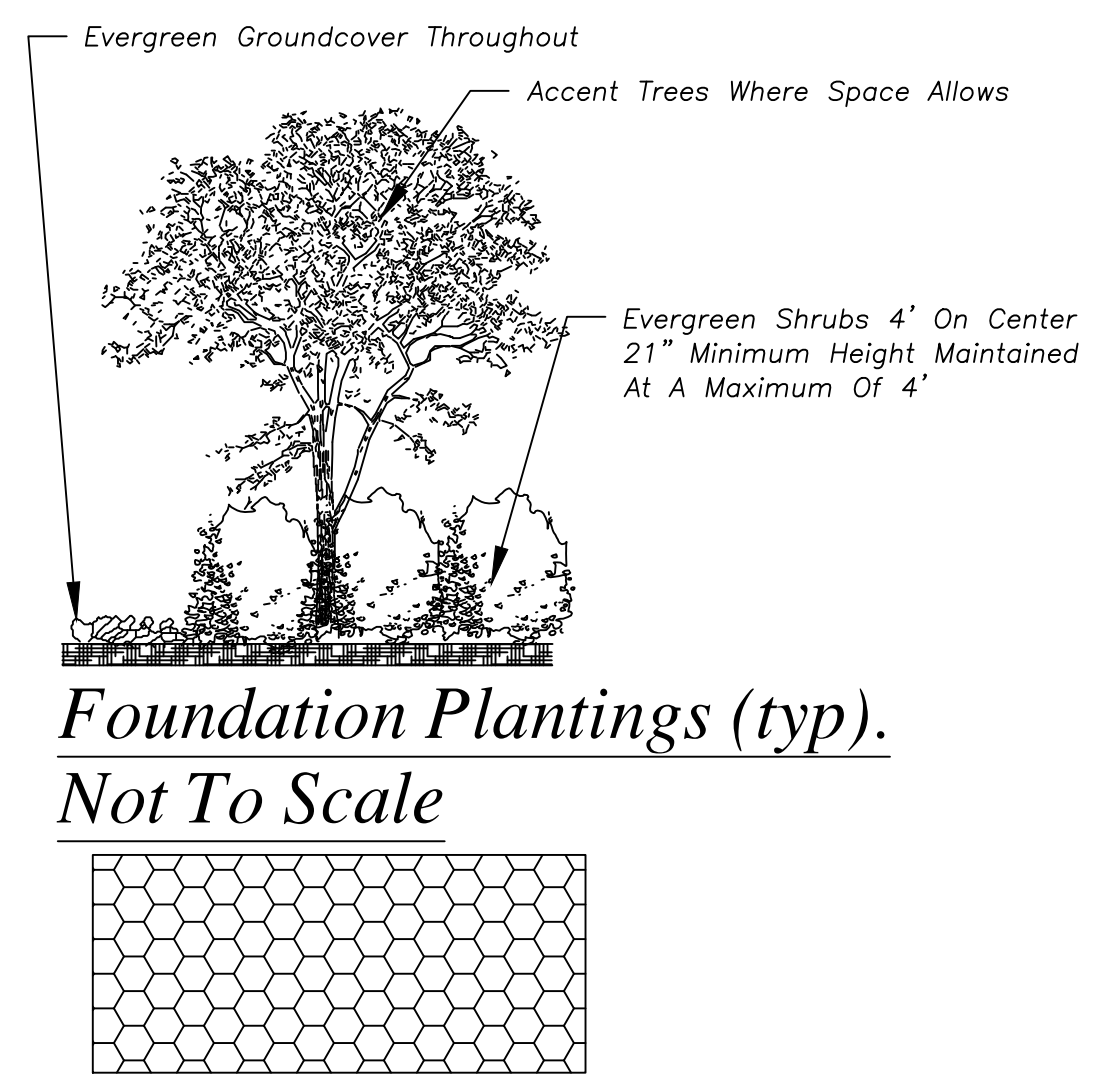
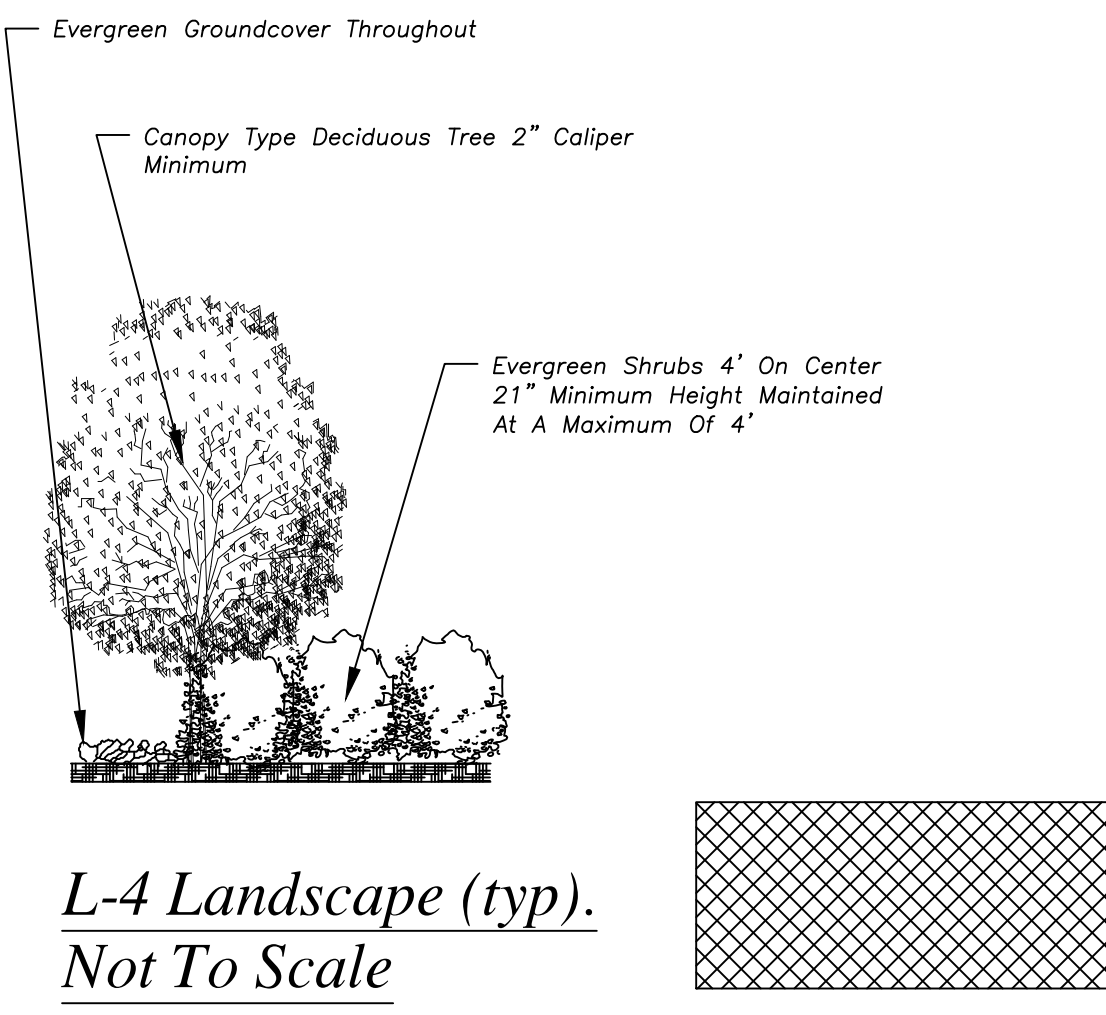
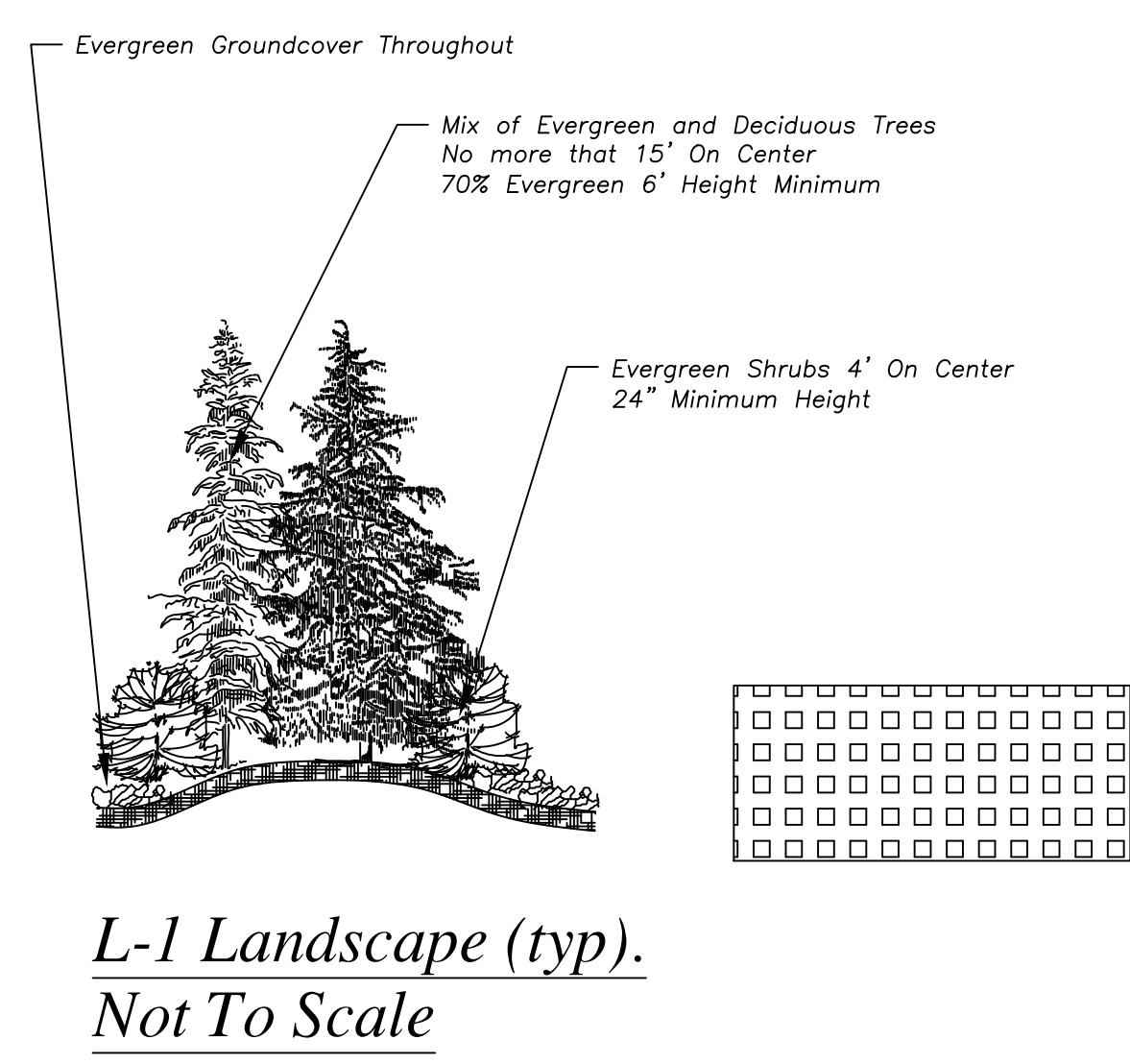
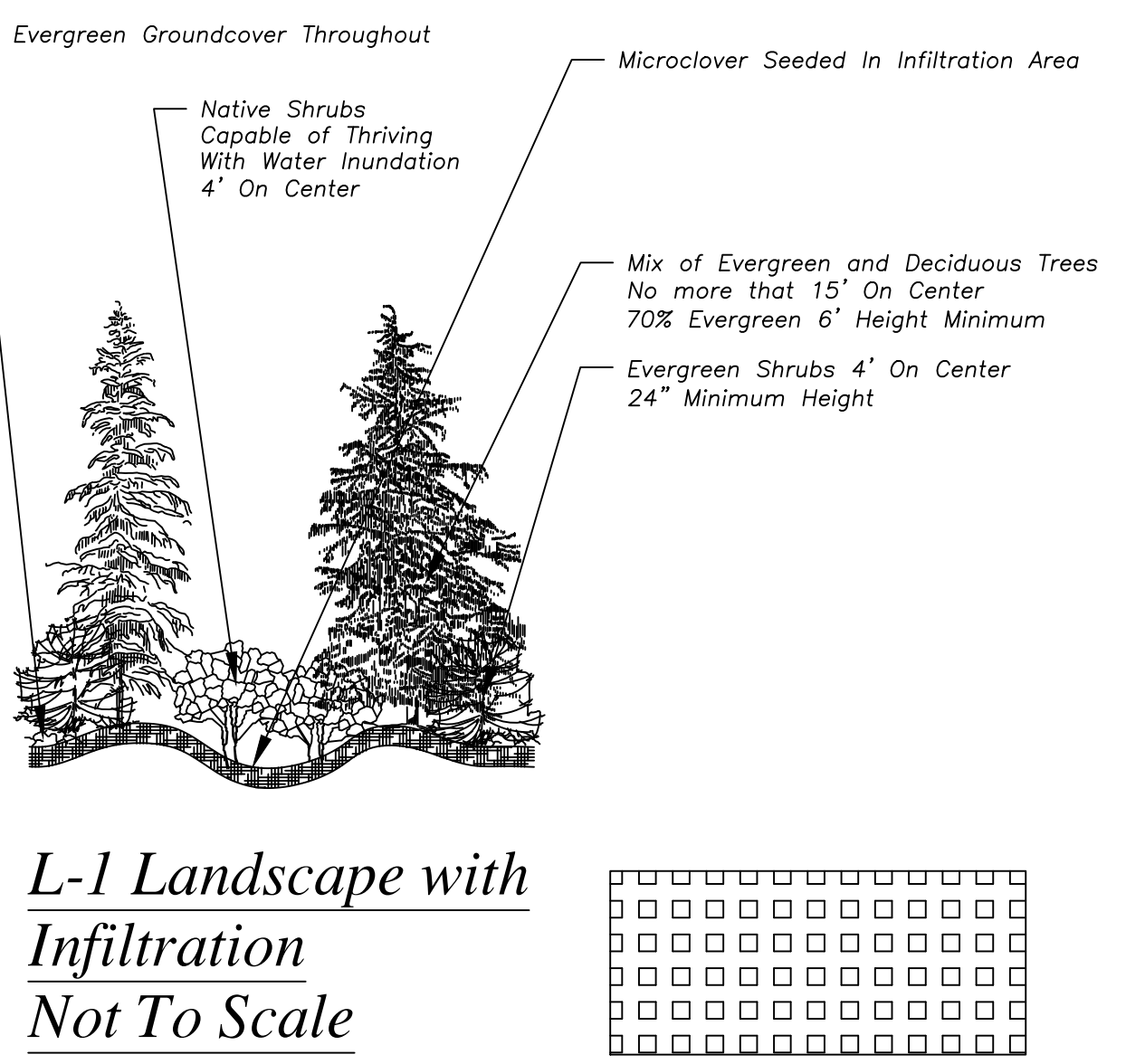
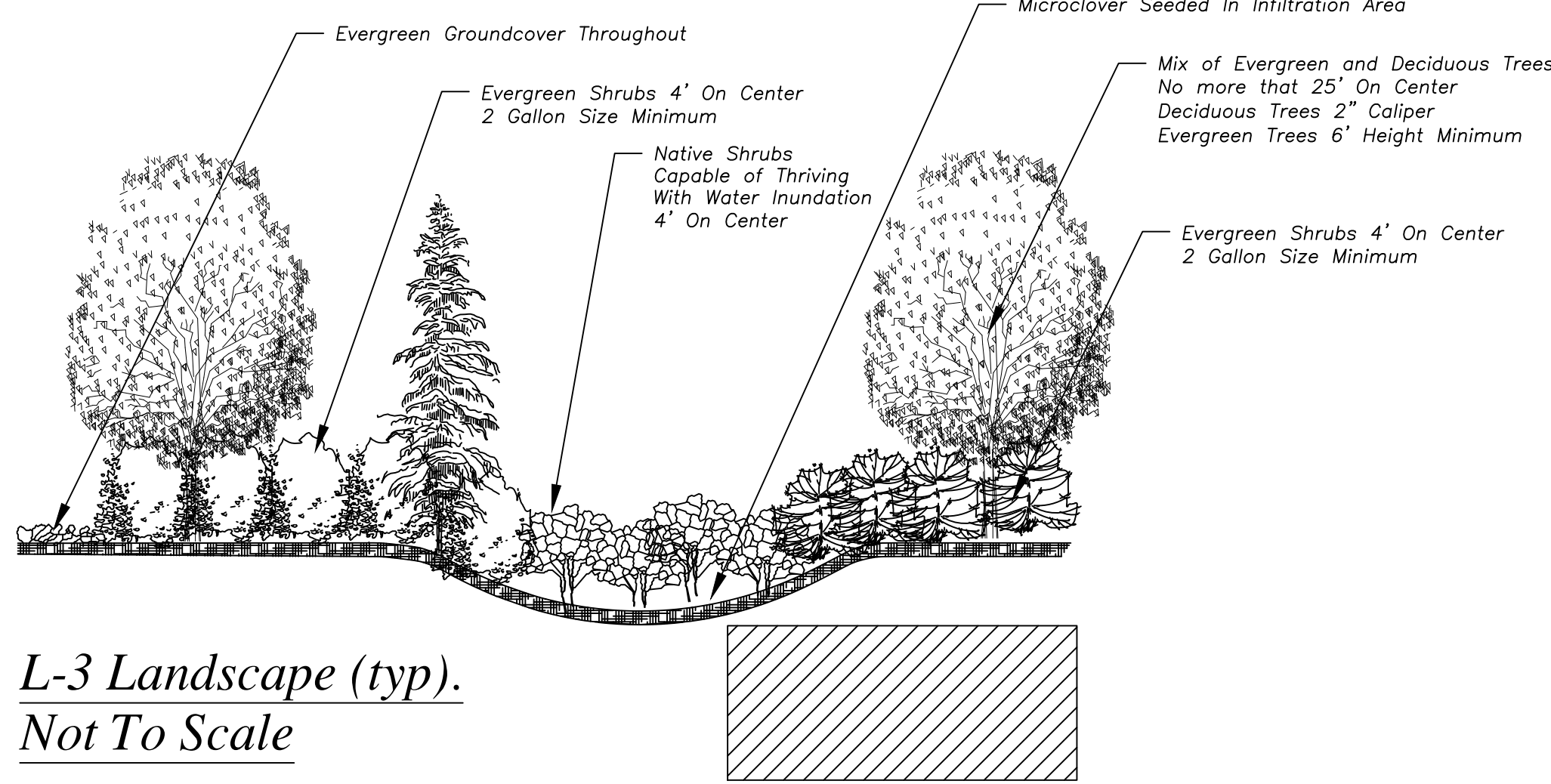
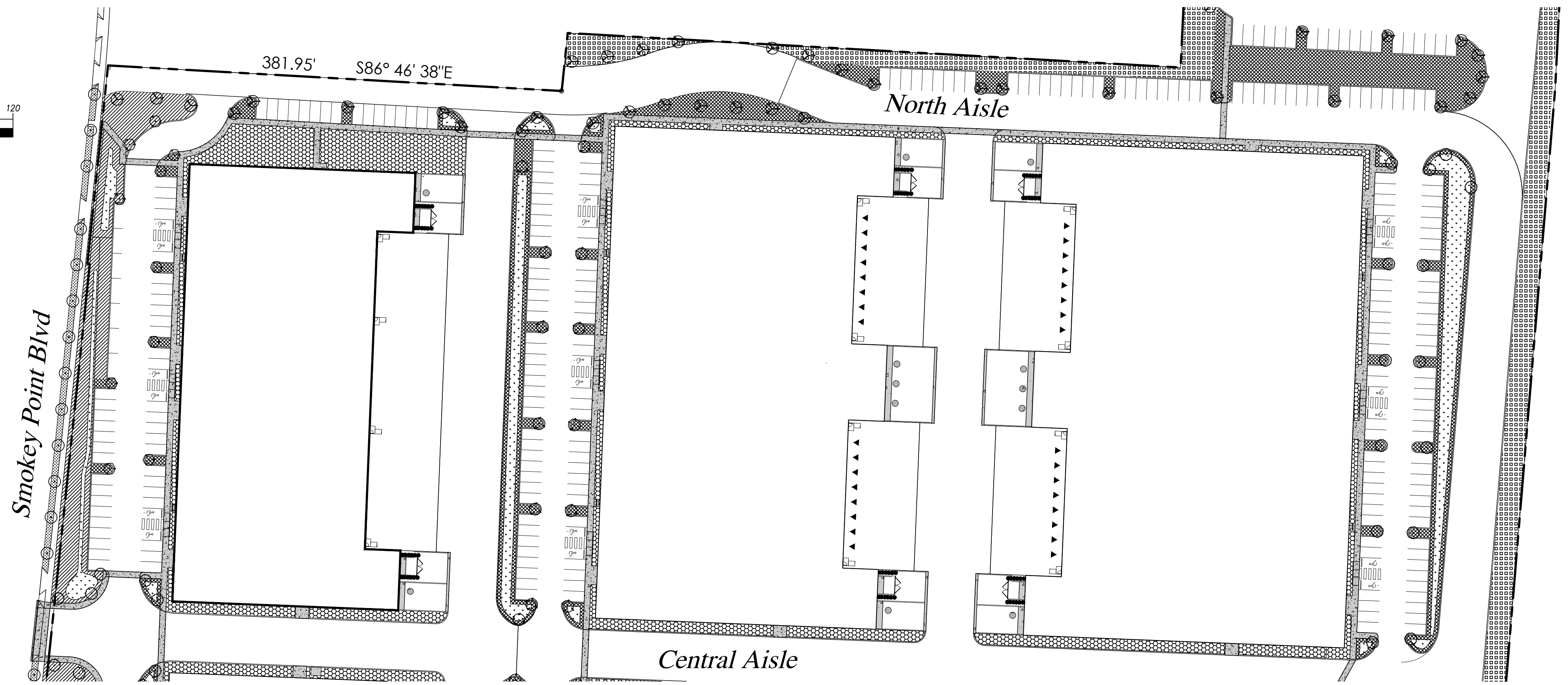
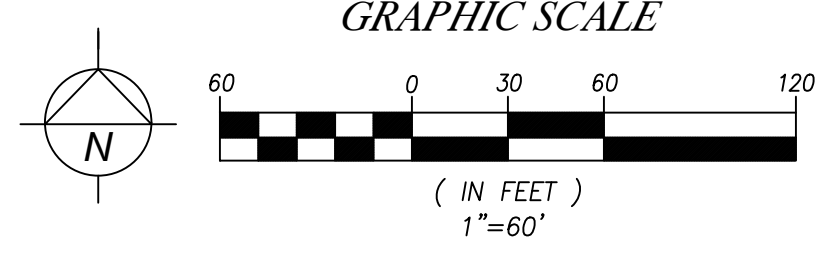

DATE	REVISION	BY

Paul Jay
Landscape Architect
1115 Bridges Road
Seattle, WA 98142
t. 206.360.659.8159
c. 425.210.1986
e. pauljayla@gmail.com



Undi Commerce Park
Undi Development LLC
PRELIMINARY LANDSCAPE PLAN

APPLICANT:
Landtechnologies

DATE:
1.5.23

PJLA JOB NO.:
DRAWN BY: PJ

CHECKED BY: PJ

LANDSCAPE PLAN

SHEET
L-4
OF 6

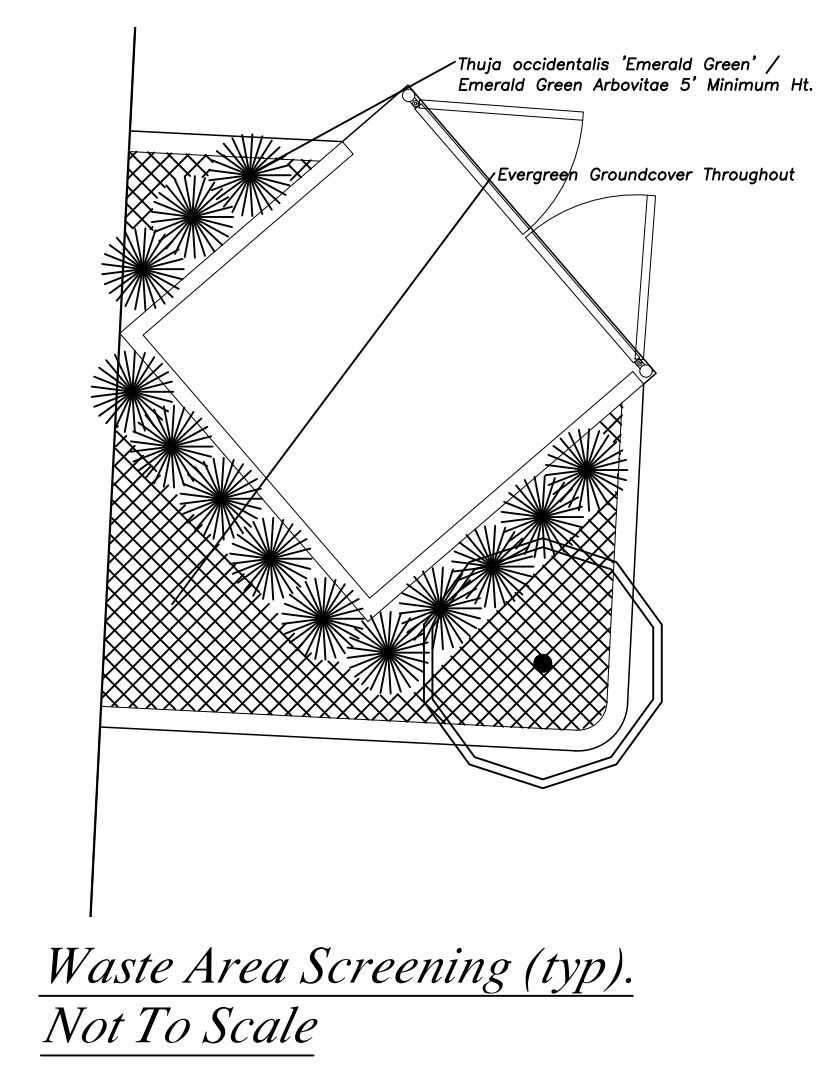
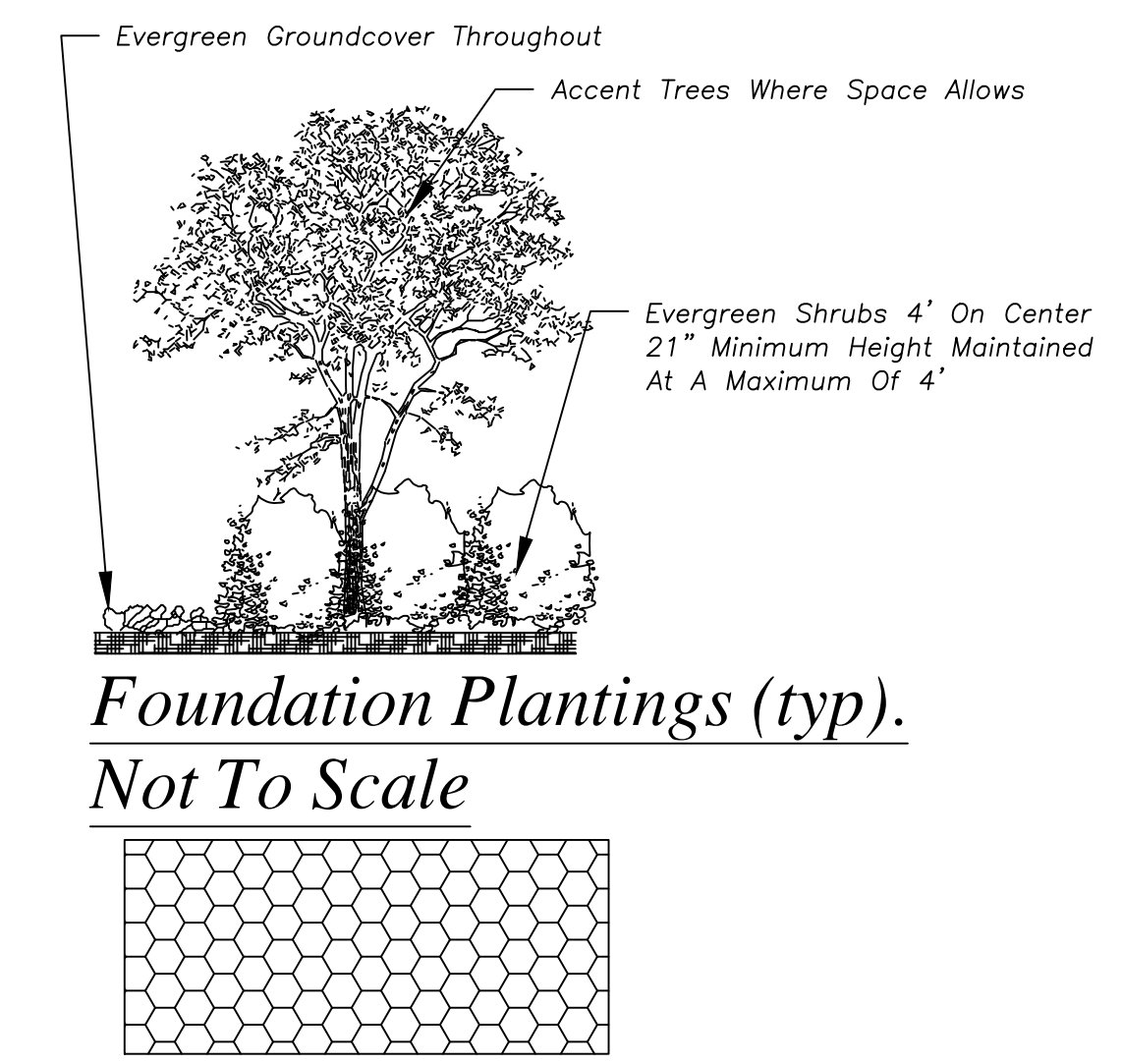
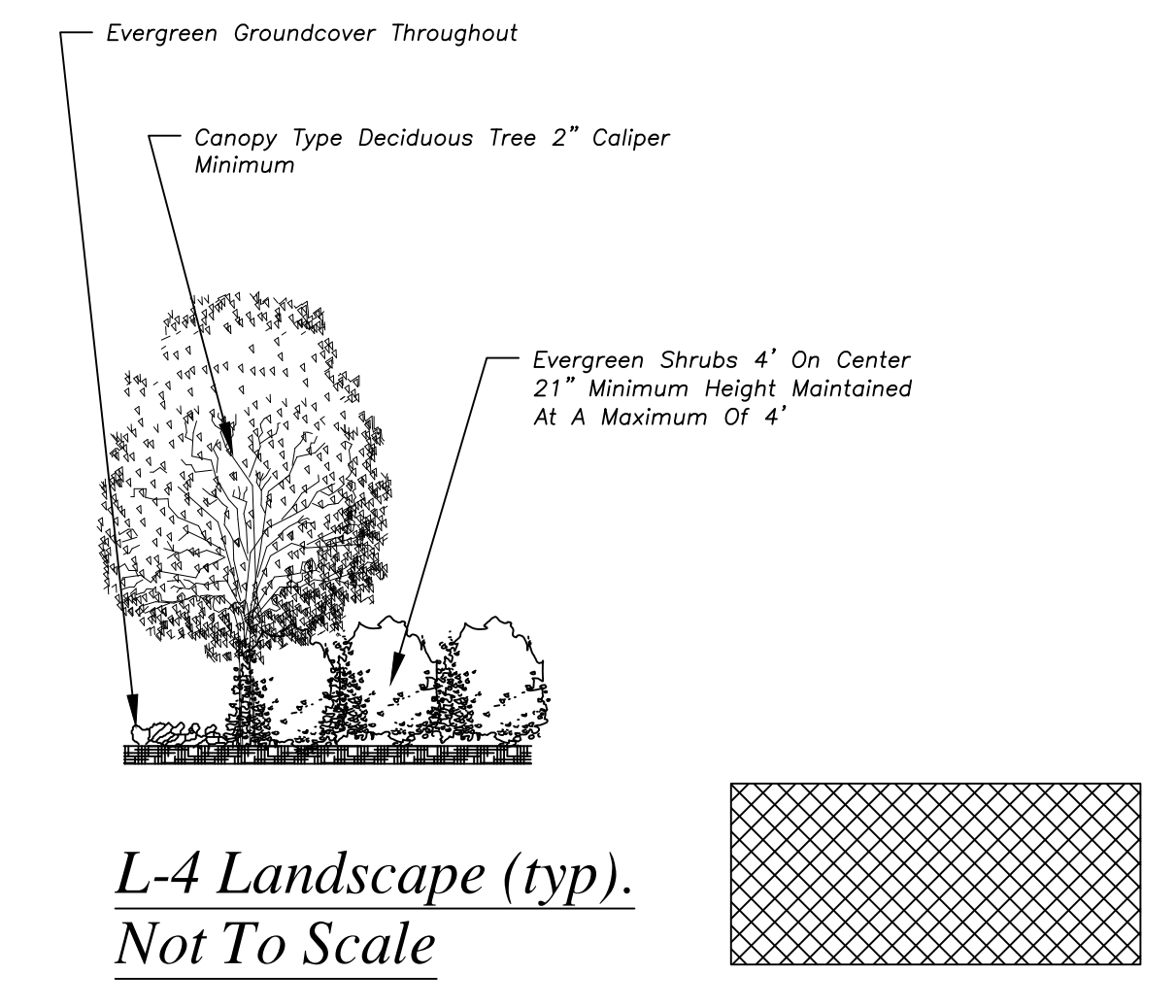
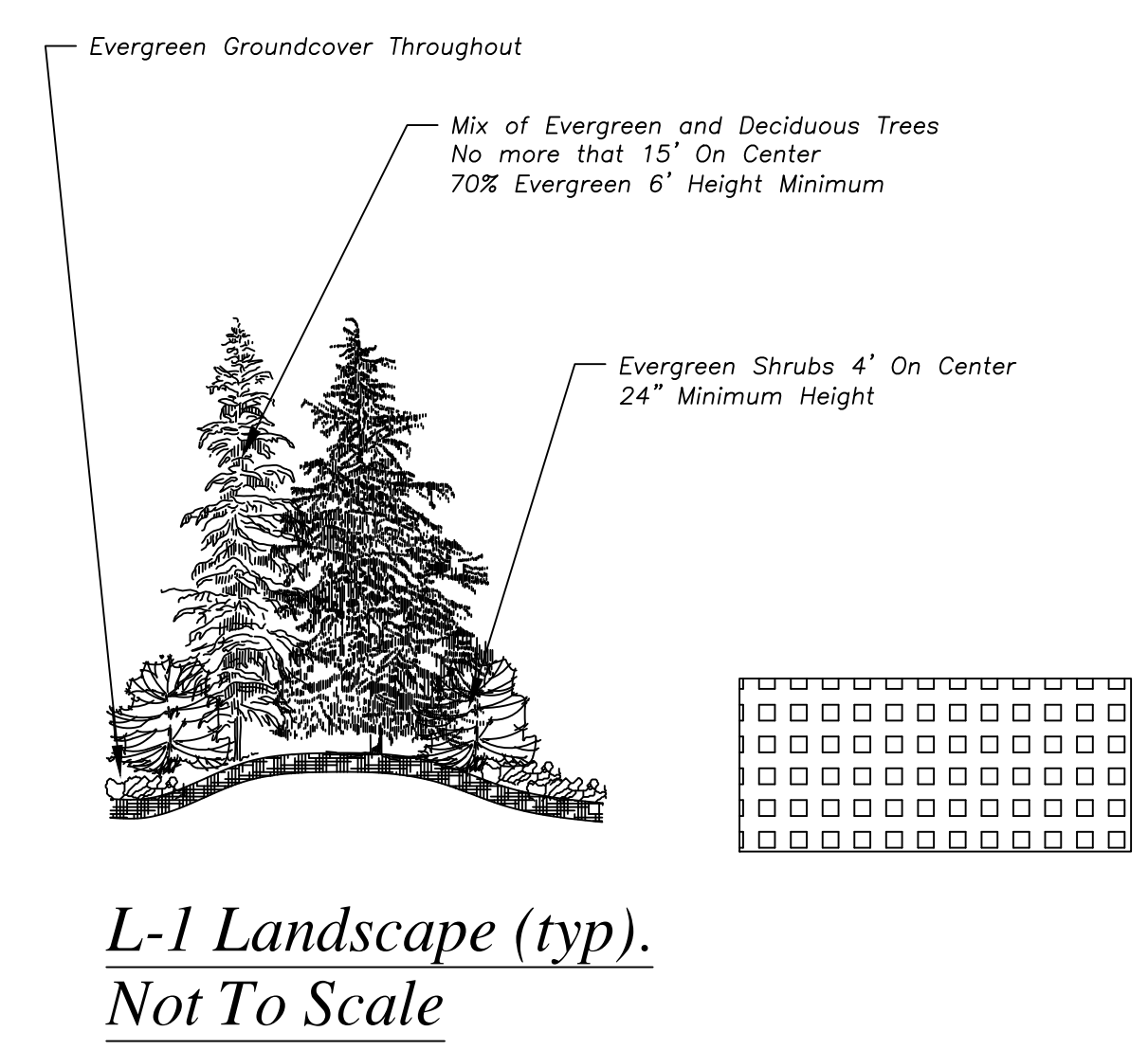
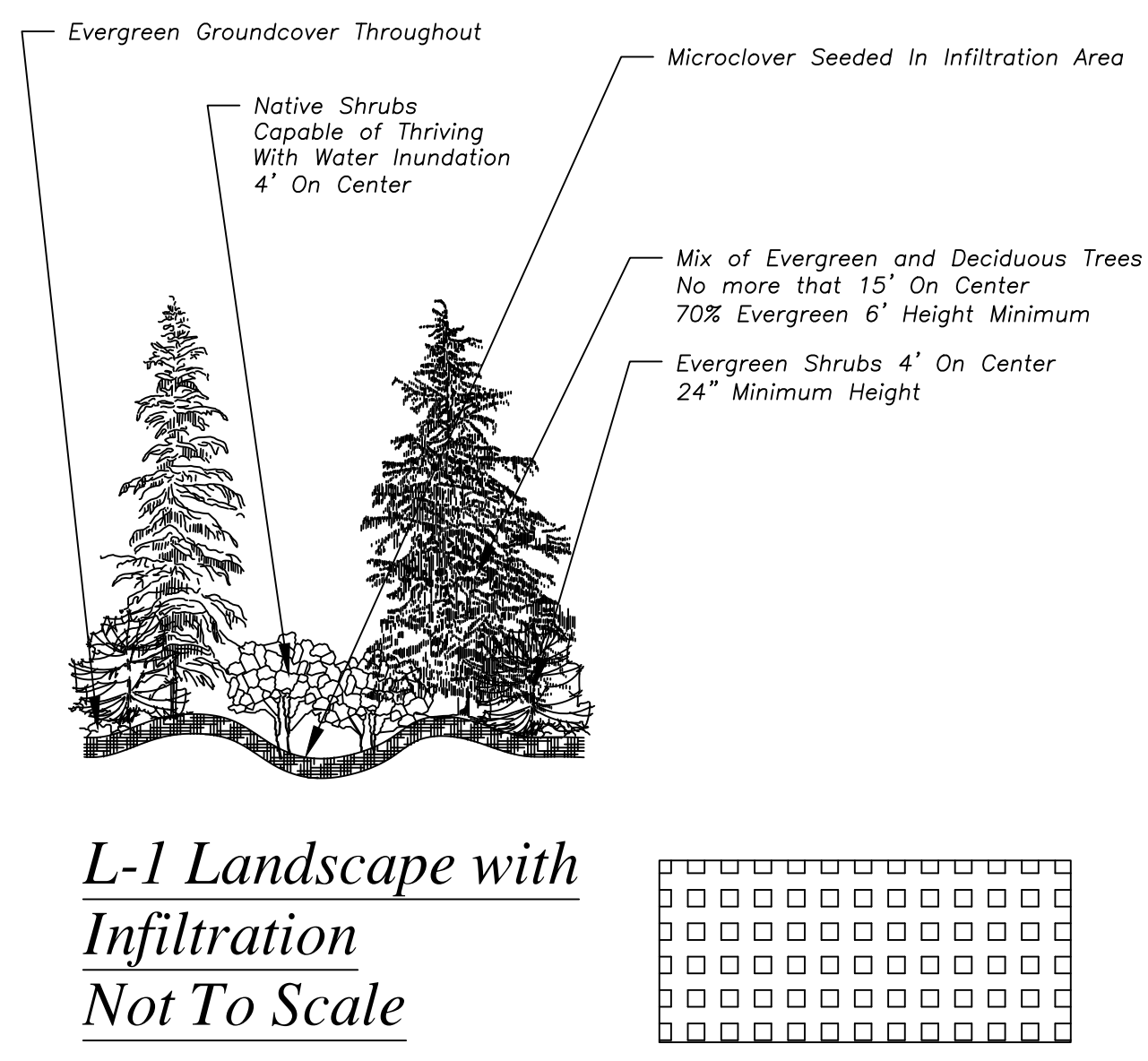
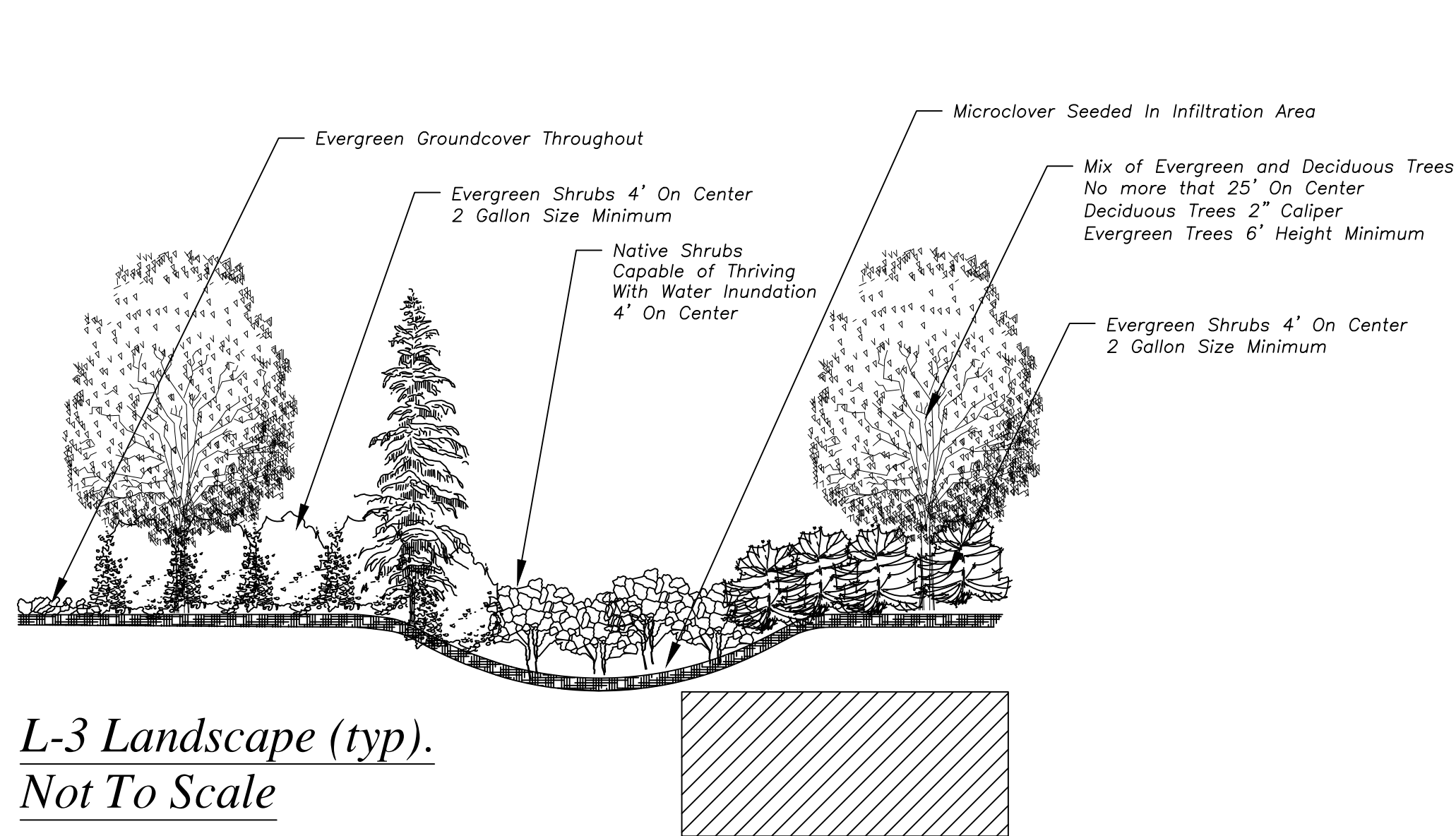
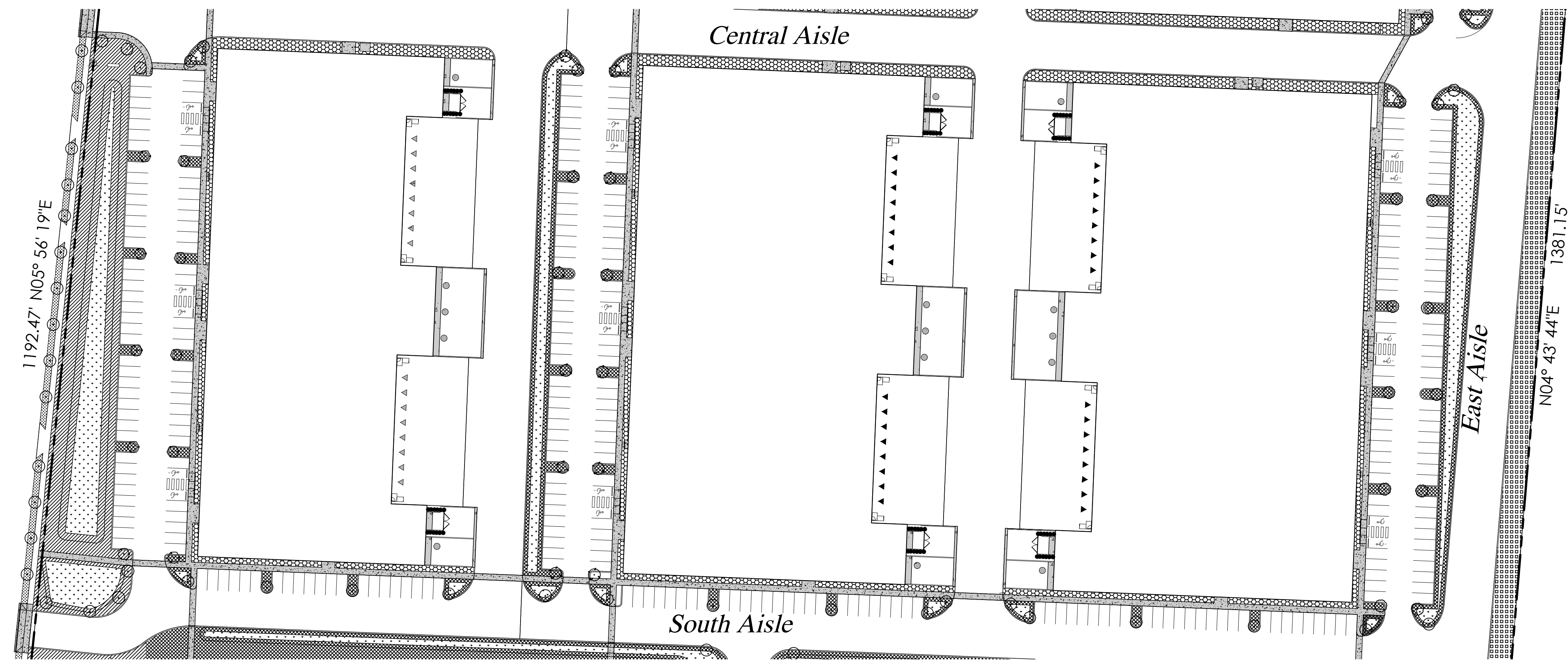
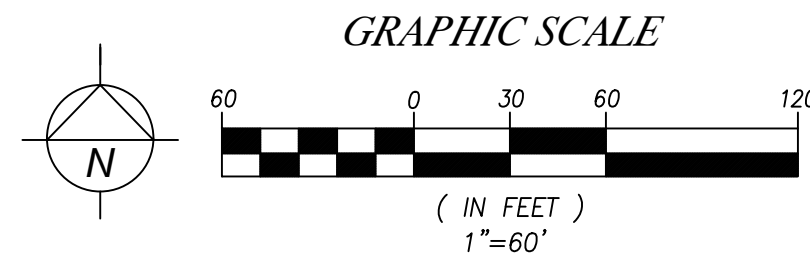

DATE	REVISION	BY

Paul Jay
Landscape Architect
1115 Bridges Road
Easton, MA 02842
t. 425.210.1986
e. pauljay@aol.com



Undi Commerce Park
Undi Development LLC
PRELIMINARY LANDSCAPE PLAN

APPLICANT:
Landtechnologies

DATE:
1.5.23

PJLA JOB NO.:
DRAWN BY: PJ

CHECKED BY: PJ

LANDSCAPE PLAN

SHEET
L-5
OF 6

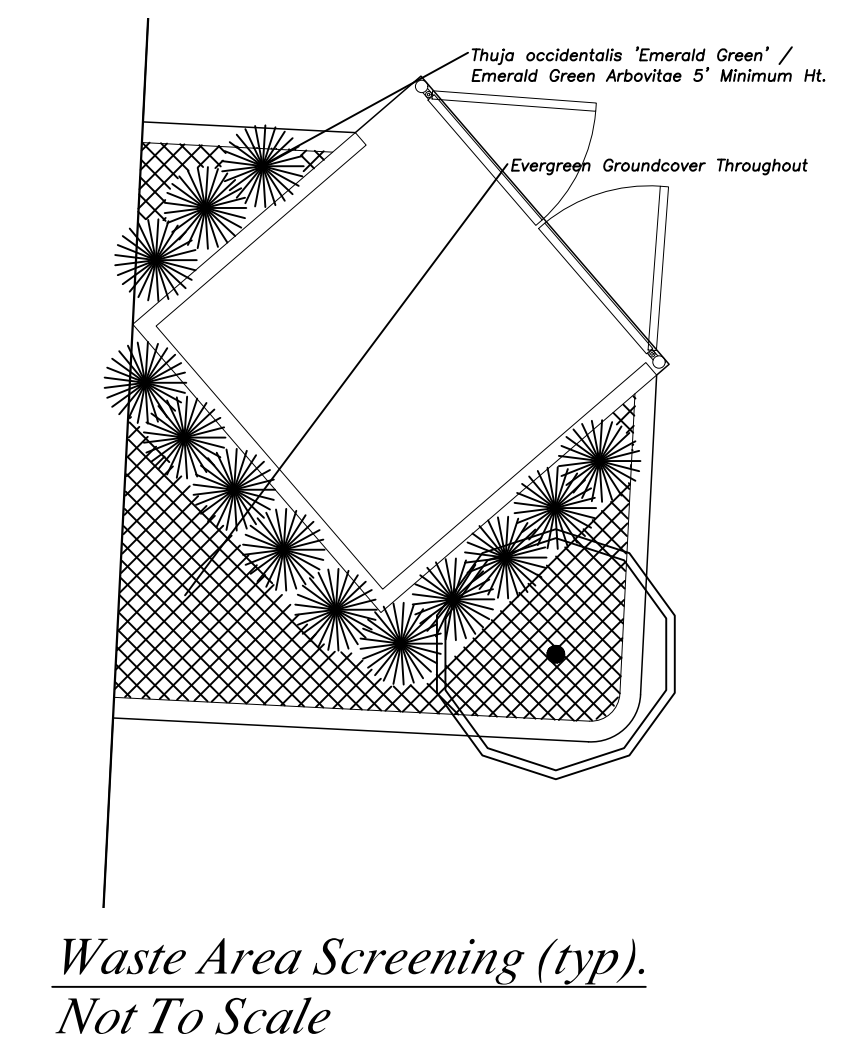
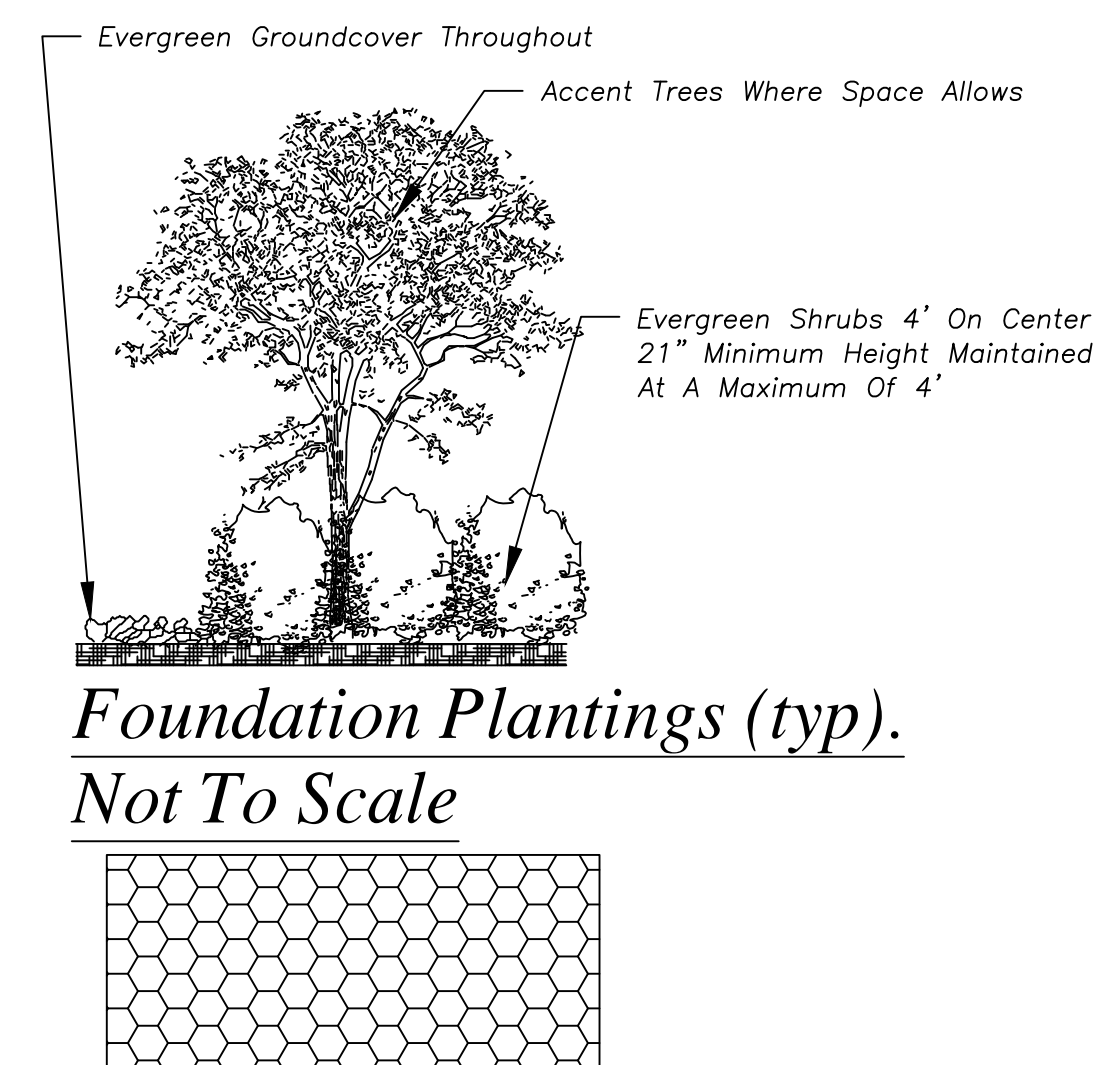
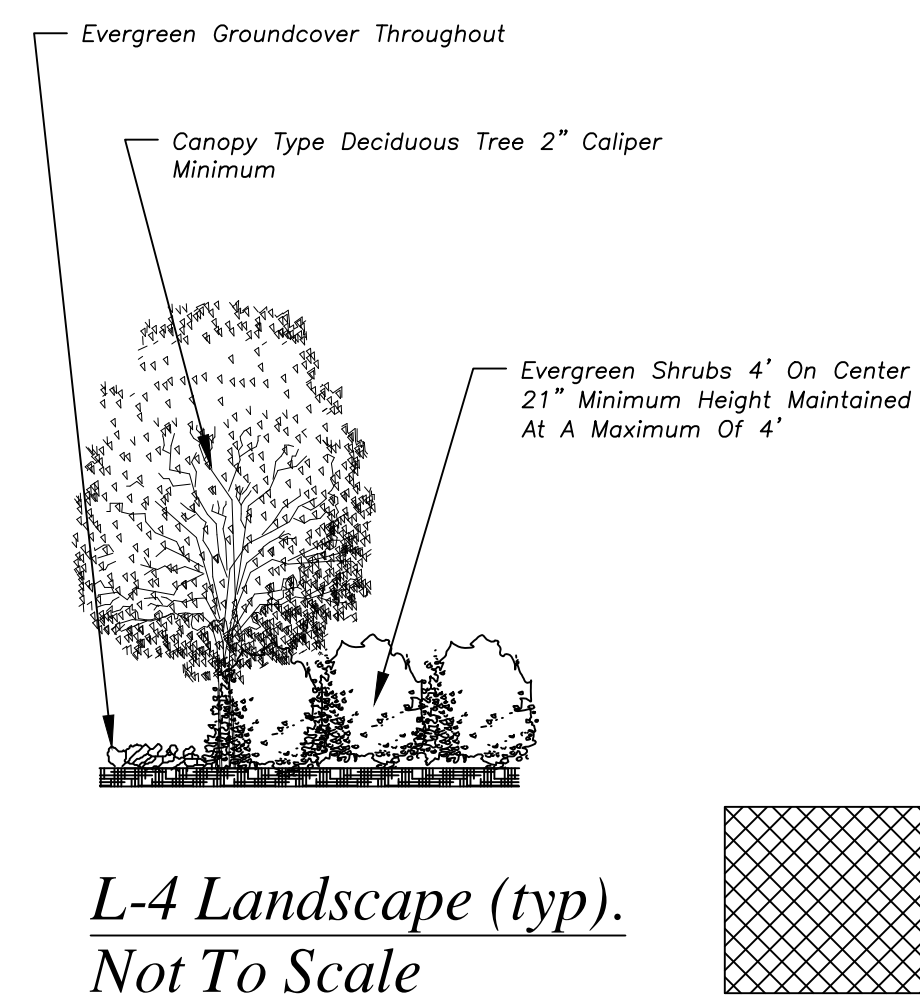
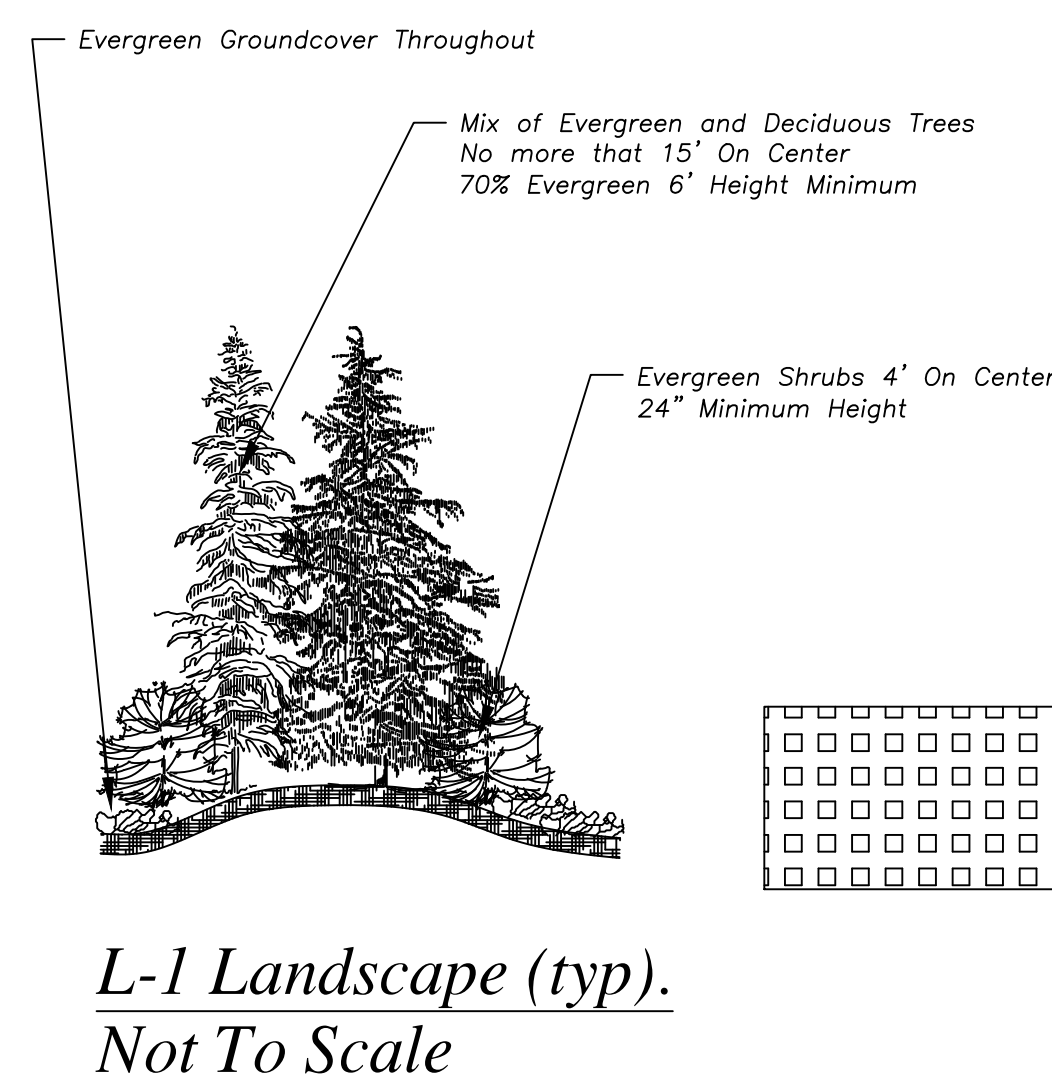
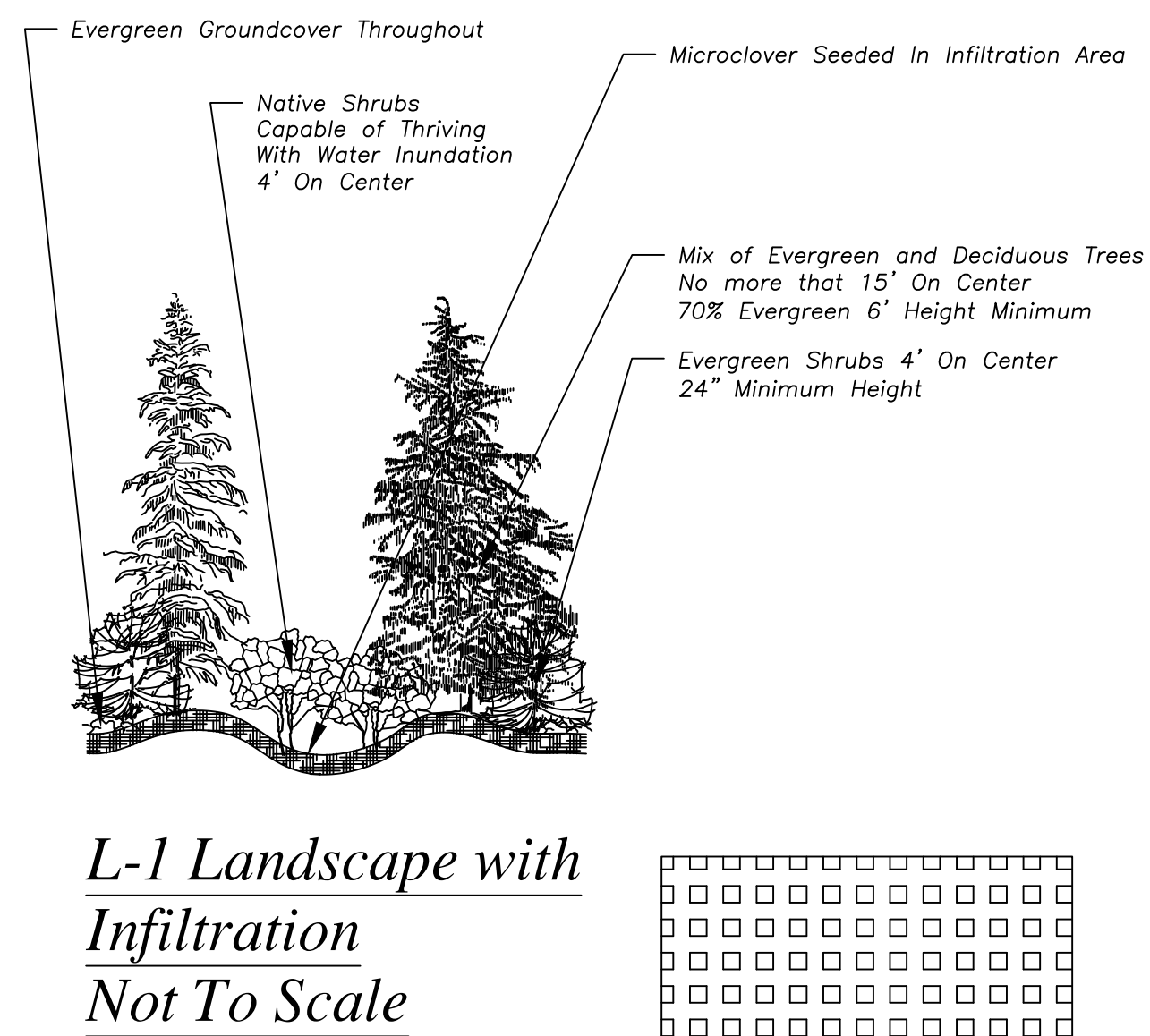
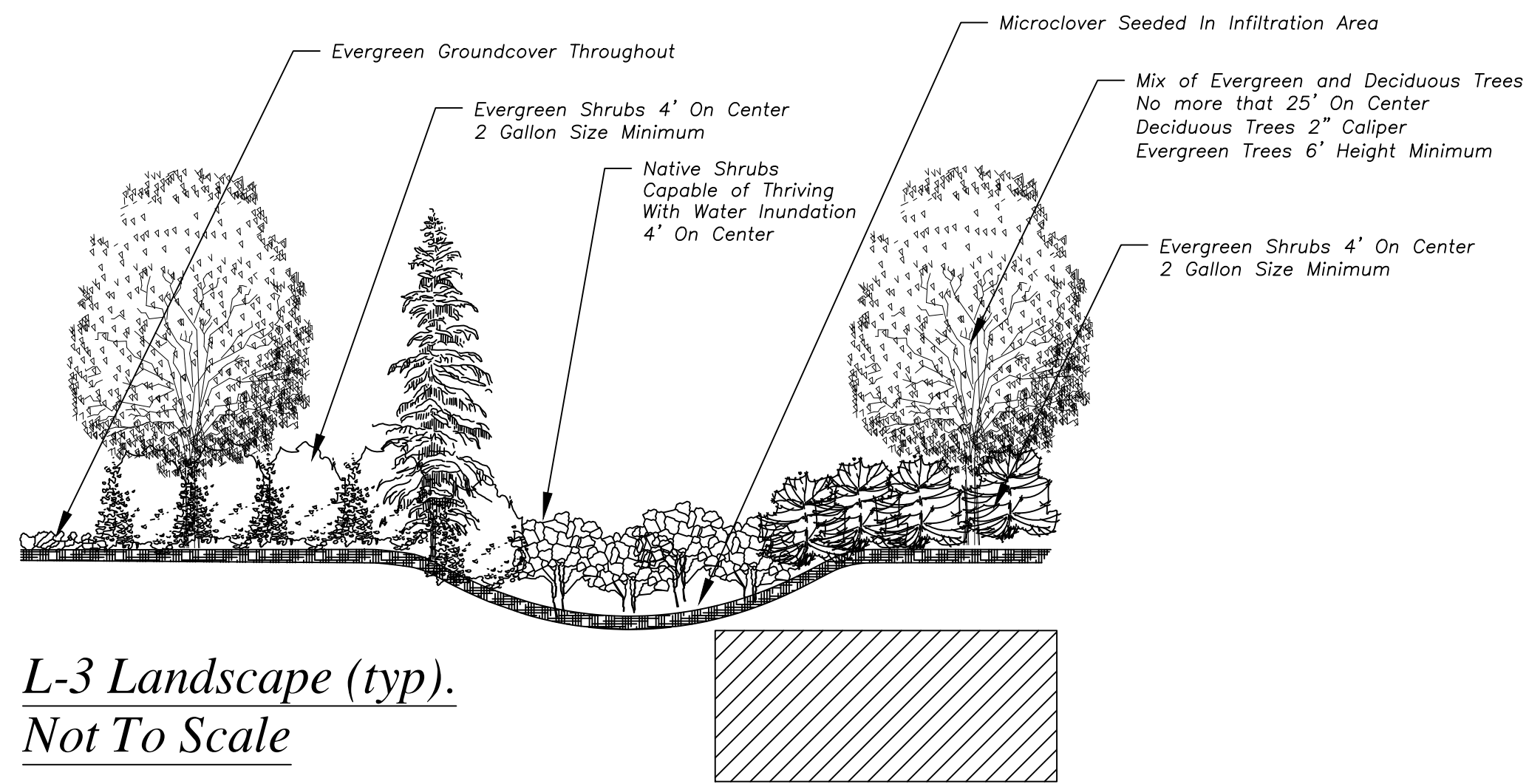
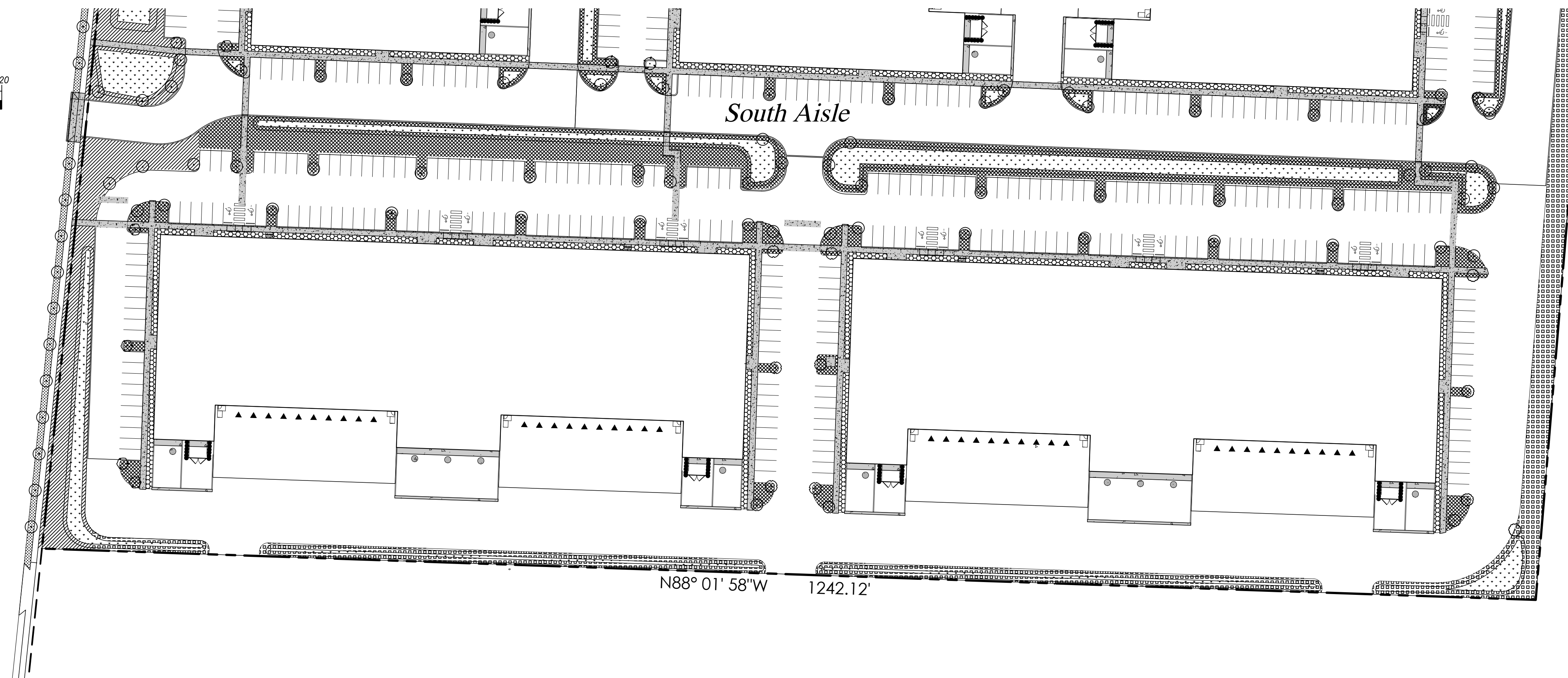
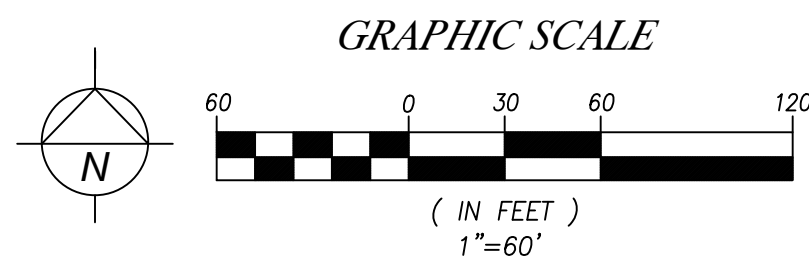

DATE	REVISION	BY

**Paul Jay
Landscape Architect**
1115 Bridges Road
East 380 659 8159
c. 425.210.1986
e. pauljayla@gmail.com

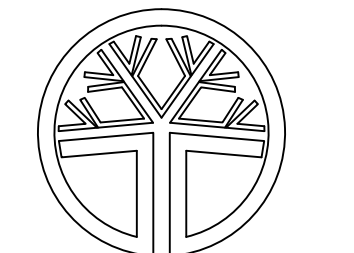

State of Washington
registered
Landscape Architect
PJ
Paul Jay
certificate No. 566

**Undi Commerce Park
Undi Development LLC
PRELIMINARY LANDSCAPE PLAN**

APPLICANT:
Landtechnologies
DATE:
1.5.23
PJLA JOB NO.:
DRAWN BY: PJ
CHECKED BY: PJ

LANDSCAPE PLAN

SHEET
L-6
OF 6