

**SITE PLAN REQUEST TO AUTHORIZE A SECURITY SYSTEM FOR:  
UNIFIRST - MARYSVILLE  
13059 41ST AVE NE  
MARYSVILLE, WA 98271**

**PROJECT DATA**  
APN:30050400304400  
ZONING:L1  
ACRES:3.20

**PROPERTY OWNER**  
LEIFER DEVELOPMENT NO 1 LLC  
13001 STATE AVE  
MARYSVILLE, WA 98271

#	DATE / DESCRIPTION



**AMAROK**  
ULTIMATE PERIMETER SECURITY  
550 Assembly Street, 5th Floor Columbia, SC 29201 PH: 803-786-6333

PROJECT: UNIFIRST - MARYSVILLE  
13059 41ST AVE NE  
MARYSVILLE, WA 98271

SHEET TITLE: SITE PLAN

DATE: 2/11/2022  
SCALE: SEE PLAN

SHEET: **C-1**  
of 3

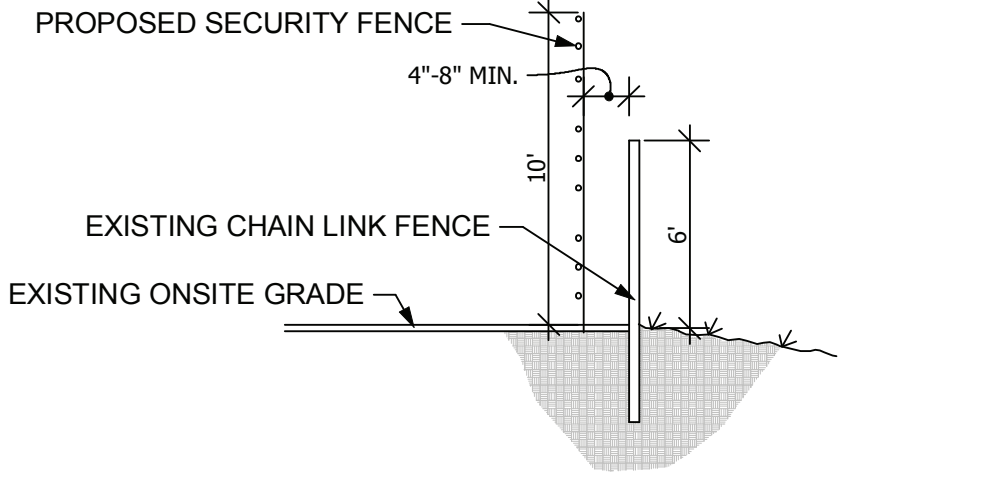
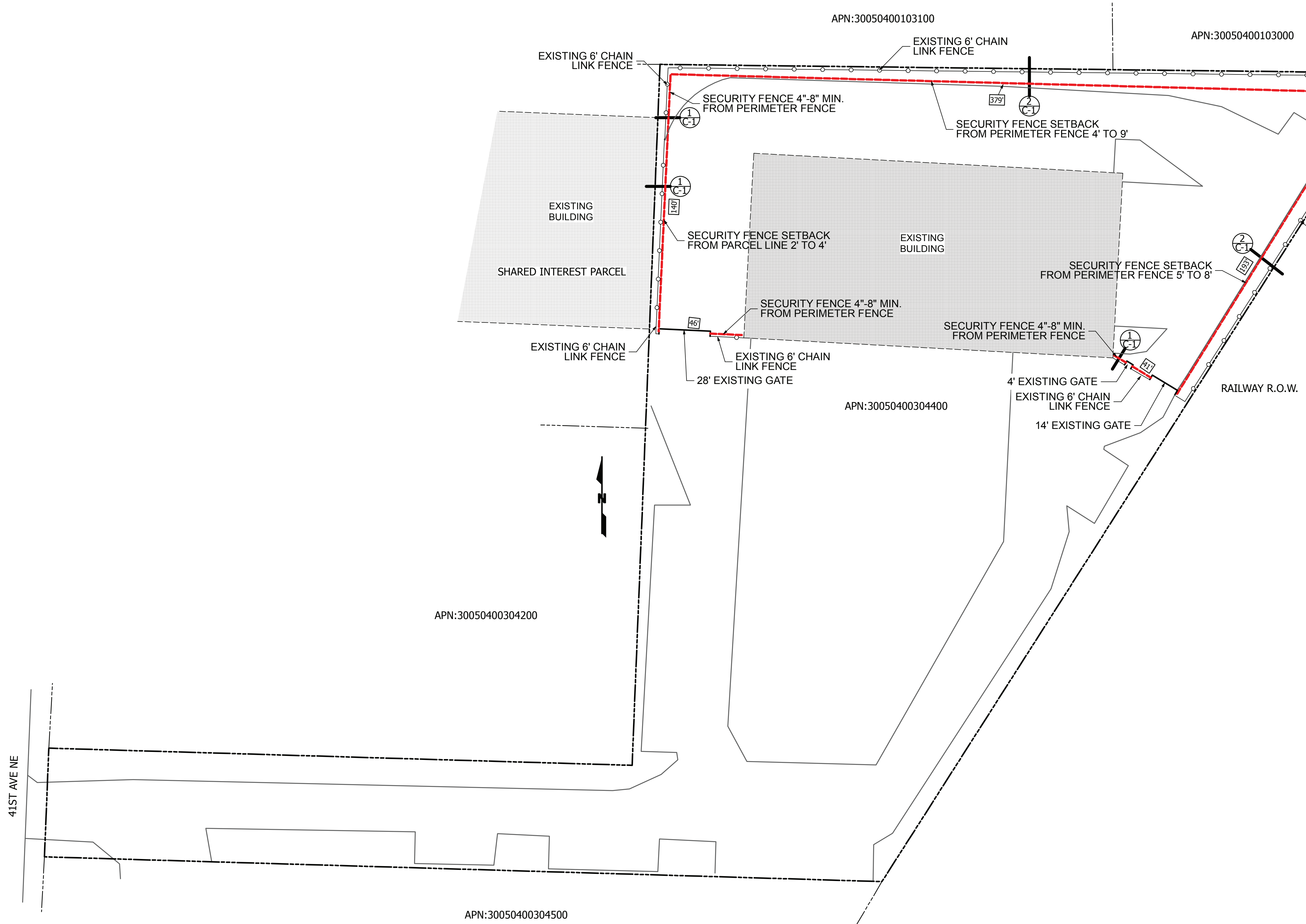

**1**  
C-1 PERIMETER FENCE SECTION  
NTS.

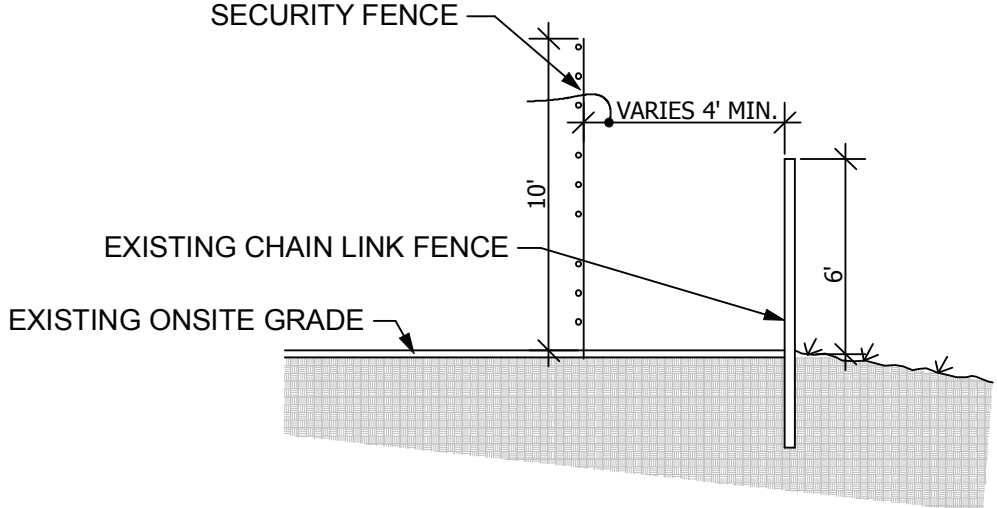

**2**  
C-1 PERIMETER FENCE SECTION  
NTS.

**SITE PLAN**  
SCALE: 1" = 30'

**NOTES**

POLE LOCATIONS:  
STEEL POLES: TO BE LOCATED APPROXIMATELY ON EACH SIDE OF GATE(S) & EVERY 90° (OR GREATER) TURN IN FENCE LINE.  
FIBERGLASS/INTERMEDIATE POLES: TO BE LOCATED APPROXIMATELY EVERY 30'

DISCLAIMER:  
POLE LOCATIONS MAY SLIGHTLY DEVIATE FROM STIPULATIONS ABOVE DUE TO ON-SITE CONDITIONS

**LEGEND**

	PROPERTY LINE/ROW
	PROPOSED CHAIN LINK FENCE
	PROPOSED PERIMETER SECURITY SYSTEM
	CURB
	EXISTING BUILDING
	PROPOSED SECURITY FENCE LENGTH

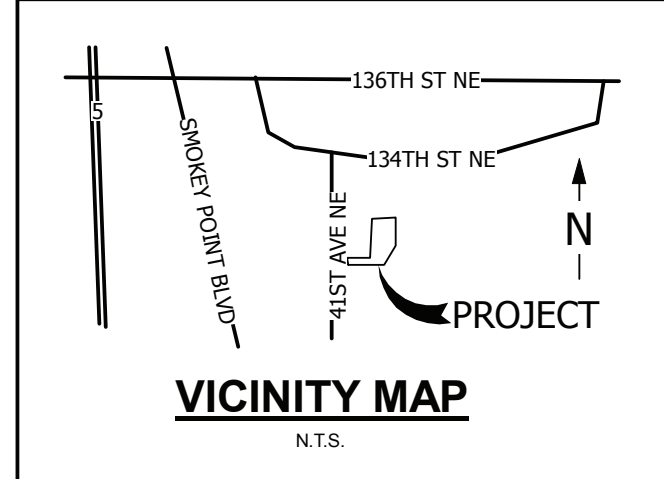



#	DATE / DESCRIPTION

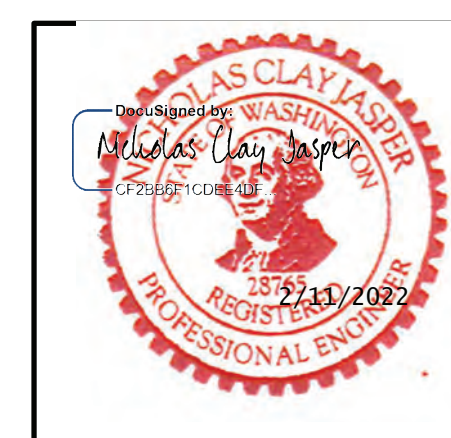

**AMAROK**  
 ULTIMATE PERIMETER SECURITY

550 Assembly Street, 5th Floor Columbia, SC 29201 PH: 803-796-6333

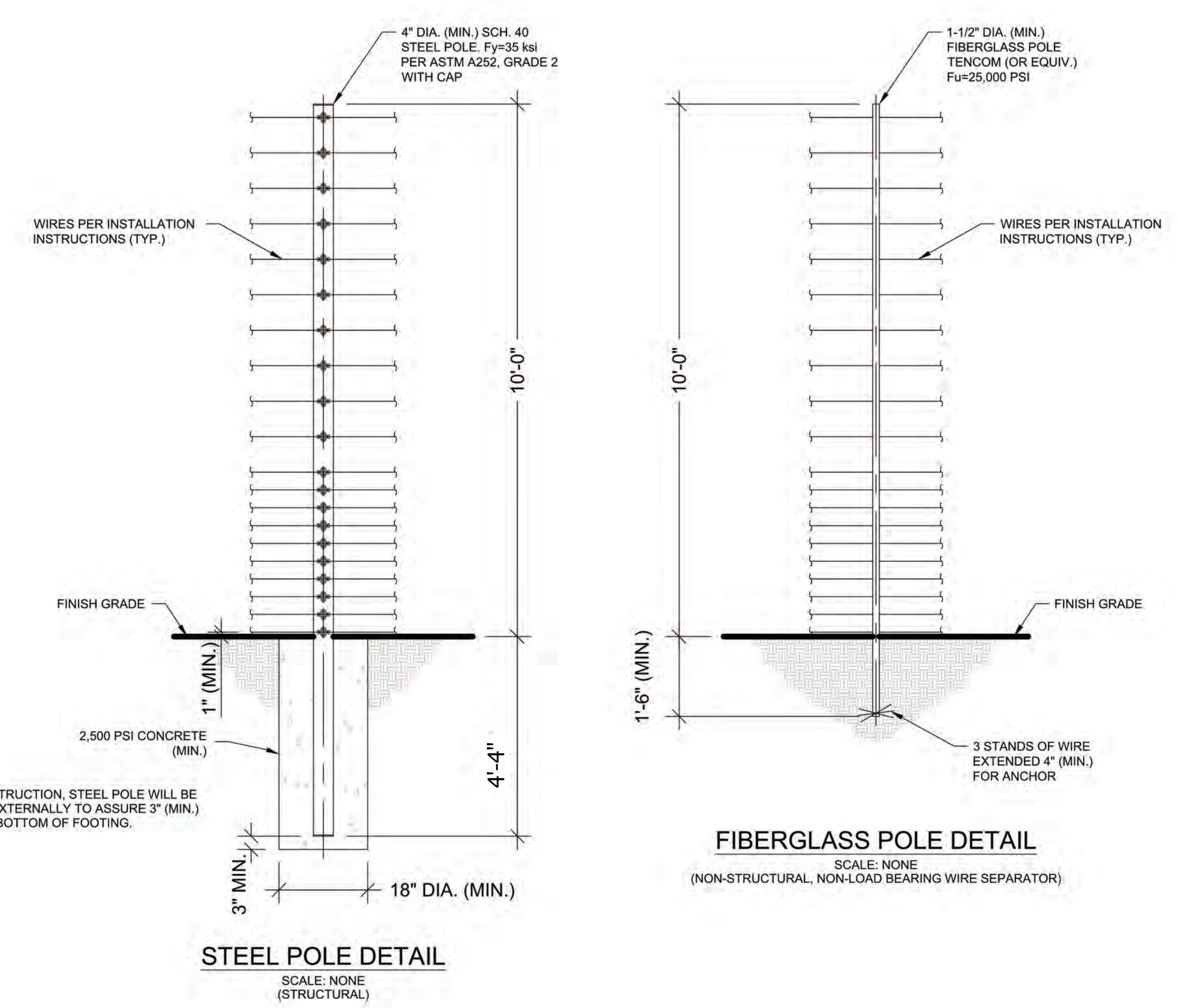

**NOTE:**  
 DURING CONSTRUCTION, STEEL POLE WILL BE SUPPORTED EXTERNALLY TO ASSURE 3" (MIN.) SPACE FROM BOTTOM OF FOOTING.

**RAPID TIGHTENERS**  
 RAPID TIGHTENERS ARE INSTALLED IN EVERY SECTION - BETWEEN 6" INCHES AND 3 FEET FROM A FIBERGLASS POLE - TOWARD THE CENTER OF THE RUN.  
 THE TIGHTENERS ARE ALTERNATED ON OPPOSITE SIDES OF THE POLE TO PREVENT GROUNDS FROM HITTING WIRES WITH CURRENT.  
 WIRE SHOULD BE WRAPPED TWO OR THREE TIMES AROUND EACH TIGHTENER.

**WARNING SIGNS**  
 WARNING SIGNS MUST BE INSTALLED EVERY 30 FEET, WHICH IS THE MAXIMUM DISTANCE BETWEEN SIGNS.  
 ALL WARNING SIGNS SHOULD BE MOUNTED EITHER BETWEEN WIRES 15 & 16 OR AT BEST VISIBLE HEIGHT.  
 IF INSTALLED BEHIND A SOLID FENCE, WARNING SIGNS SHOULD ALSO BE PLACED ON OR ABOVE THE PERIMETER FENCE.

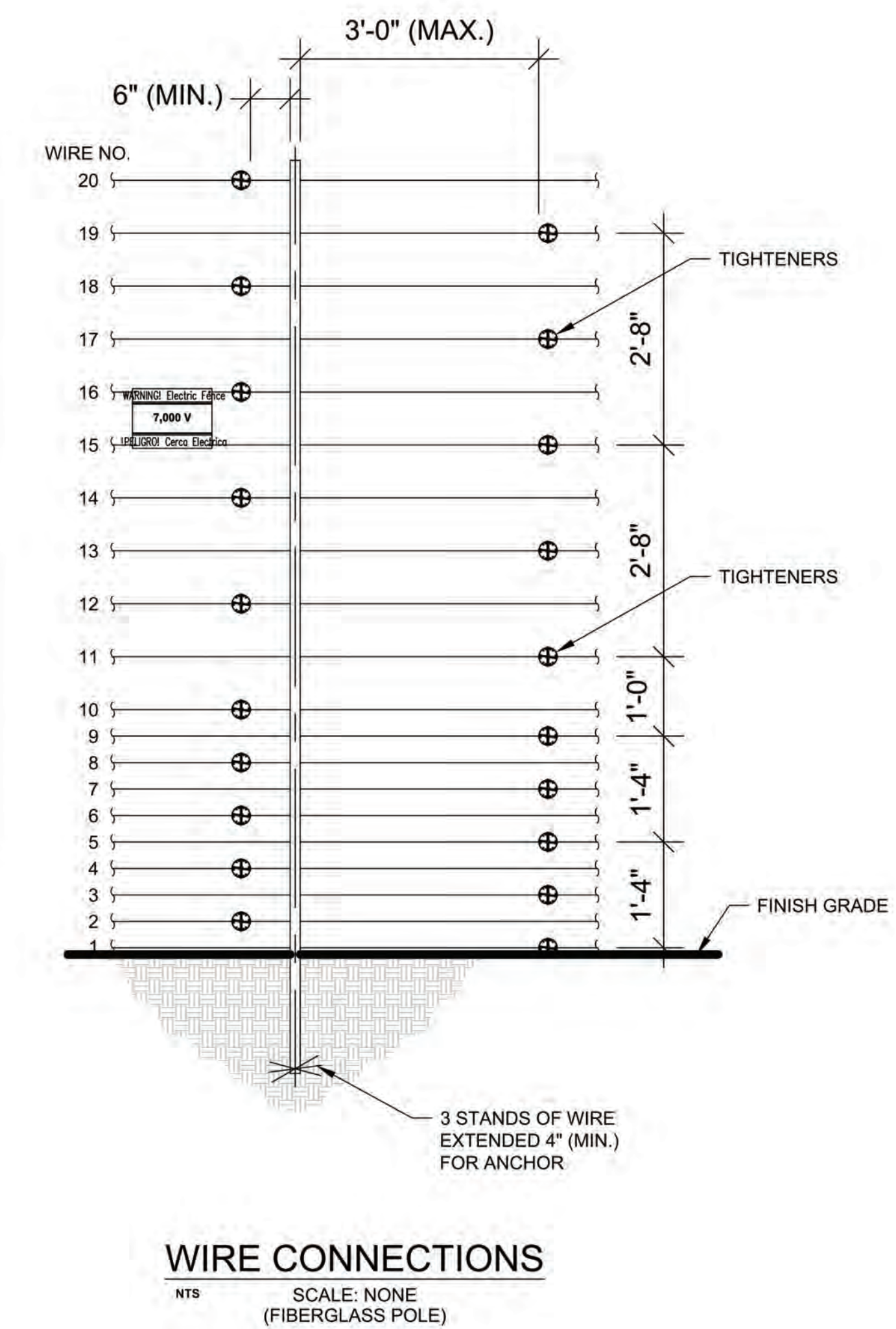

EXAMPLE WARNING SIGNS @ 9" X 12"  
 WARNING SIGNS SHALL BE PLACED AT EACH ENTRANCE OF THE PROPERTY AND 30 FEET ON CENTER THEREAFTER

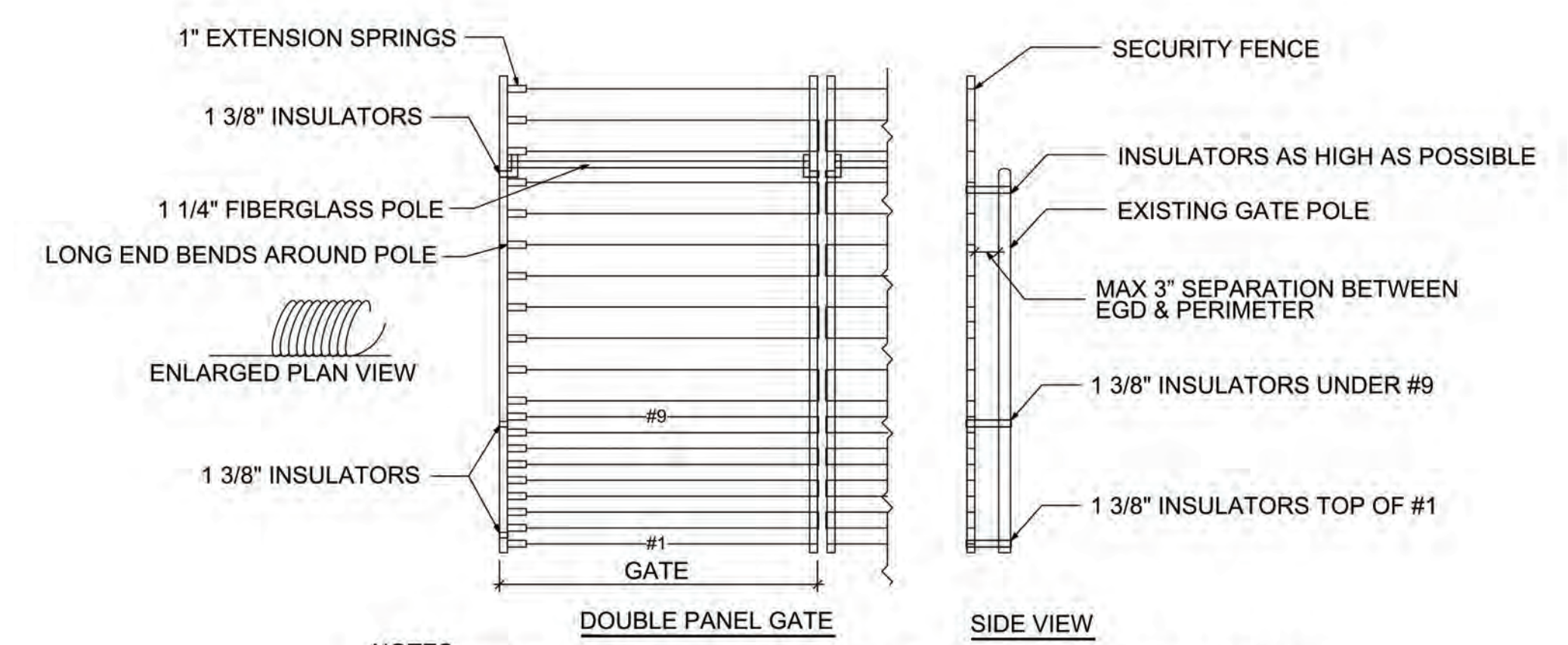

- NOTES:**
- INSULATORS ARE LOCATED ON TOP OF #1, UNDER #9, TO AS HIGH ON THE GATE AS POSSIBLE.
  - SPRINGS ARE LOCATED ON OPPOSITE SIDES OF LOCK.
  - ALL CONTACTS MUST INCLUDE SPRINGS.
  - ALL CONTACTS MUST HAVE BOLT THROUGH FIBERGLASS (NO SET SCREWS).
  - ALL BRACE BANDS HOOKED TO CHAIN LINK MUST HAVE SET SCREWS.
  - EVERY GATE PANEL MUST HAVE A SIGN.
  - GATE MOUNTS WILL NOT IMPACT THE FUNCTIONALITY OF THE GATE

**GATE DETAIL**  
 N.T.S.

PROJECT: UNIFIRST - MARYSVILLE  
 13059 41ST AVE NE  
 MARYSVILLE, WA 98271

SHEET TITLE: TYPICAL DETAILS

DATE: 2/11/2022  
 SCALE: SEE PLAN



#	DATE / DESCRIPTION



**AMAROK**  
 ULTIMATE PERIMETER SECURITY  
 550 Assembly Street, 5th Floor Columbia, SC 29201 PH: 803-786-6333

WIRE RUN DETAILS & OUTSIDE MOUNTED ELECTRONICS/CONTROLLER WITH STEEL POLE DETAIL

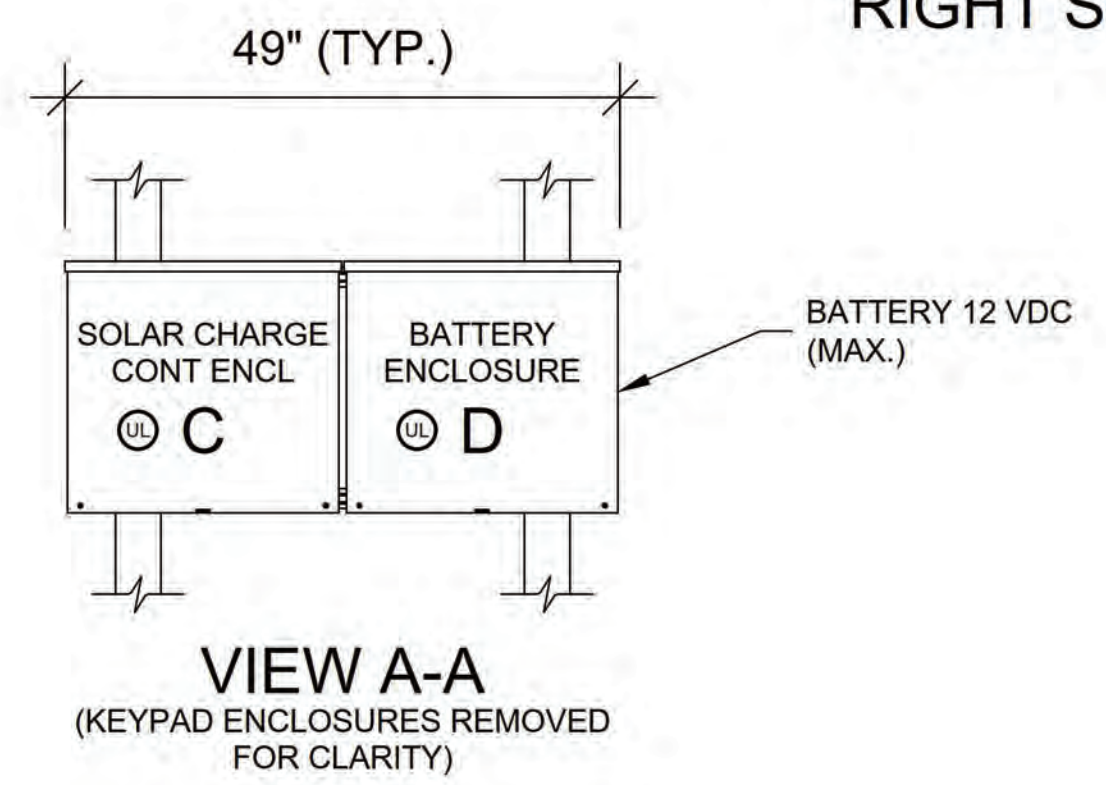
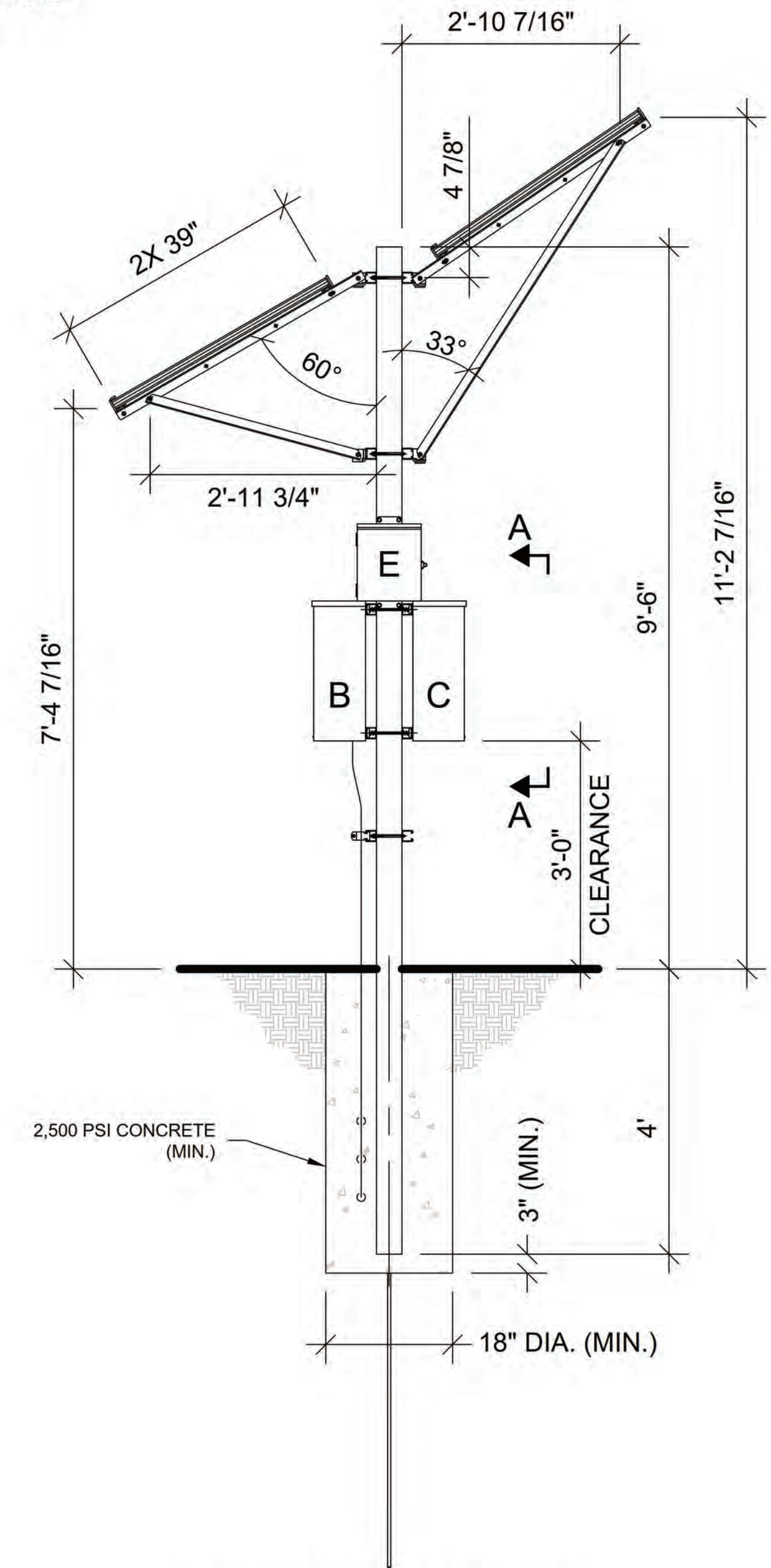
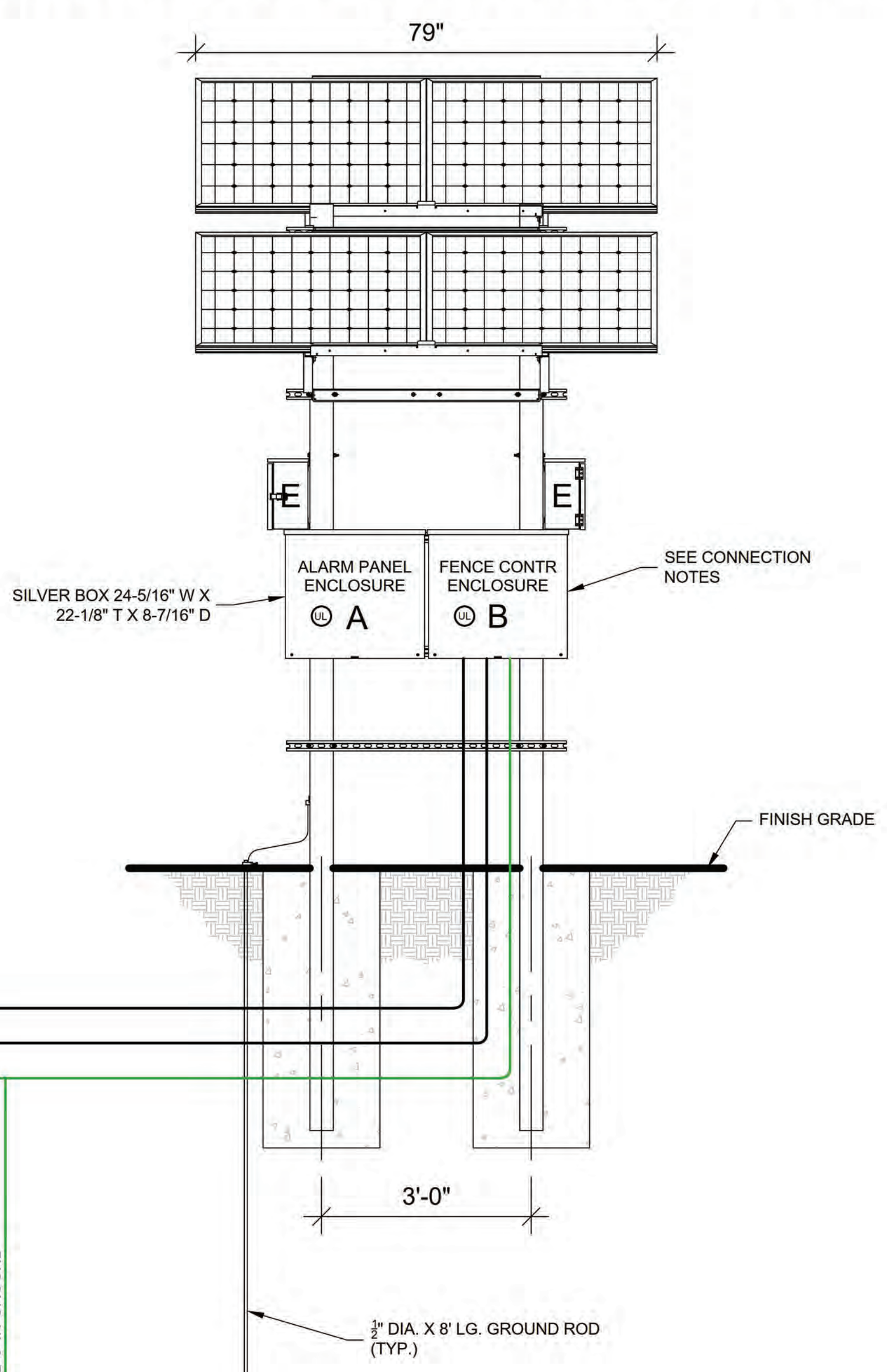
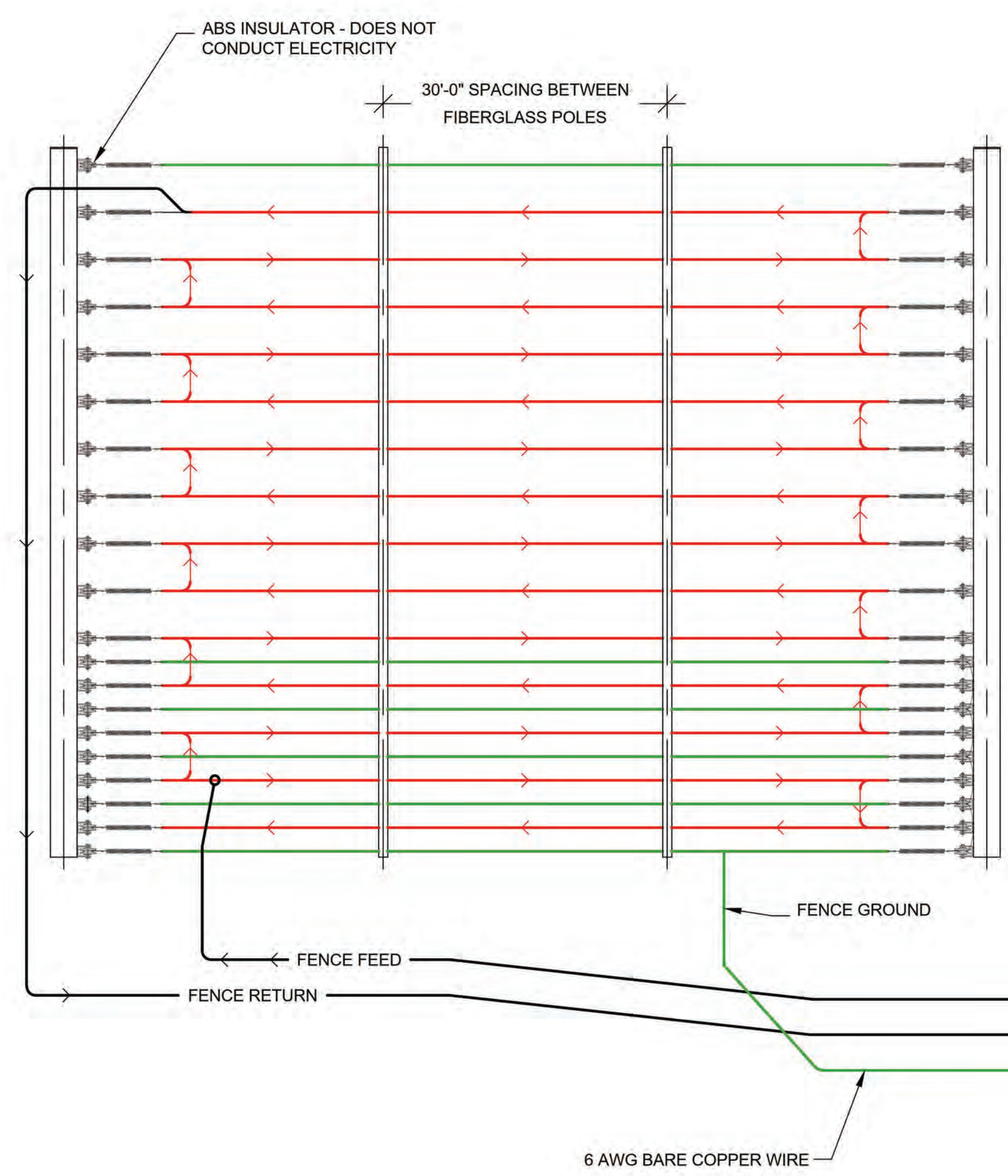

**CONNECTION NOTES:**

A: ALARM PANEL ENCLOSURE - HOUSES THE ALARM CONTROL PANEL. THIS BOX INTERCONNECTS TO "B" / FENCE CONTROLLER ENCLOSURE USING THE APS WHIP / 10 CONDUCTOR CABLE AND "C" / SOLAR CHARGE CONTROLLER USING TWO CONDUCTOR CABLE. ENCLOSURE WEIGHT 21 LBS. (MAX.).

B: FENCE CONTROLLER ENCLOSURE - HOUSES THE FENCE ENERGIZER OR EQUIVALENT. THIS BOX CONNECTS TO "A" / ALARM PANEL ENCLOSURE USING THE APS WHIP / 10 CONDUCTOR CABLE. ENCLOSURE WEIGHT 22 LBS. (MAX.).

C: SOLAR CHARGE CONTROLLER ENCLOSURE - HOUSES POWER ELEMENTS FOR SOLAR CHARGE CONTROLLER AND DISCONNECTS FOR SOLAR, BATTERY, AND LOAD CONNECTIONS. POWER UP PROCEDURE: TURN ON BATTERY BREAKER FIRST, THEN TURN ON SOLAR BREAKER. THE ELECTRONICS POWER IS CONTROLLED BY THE LOAD BREAKER. ENCLOSURE WEIGHT 25 LBS. (MAX.).

D: BATTERY ENCLOSURE - HOUSES THE BATTERIES AND INTERCONNECTS TO "C" / SOLAR CHARGE CONTROLLER ENCLOSURE USING TWO CONDUCTOR 14G AND 10G THWN WIRES. ENCLOSURE WEIGHT 130 LBS. (MAX.) - BATTERY WILL NOT EXCEED 70KWH.

E: KEYPAD ENCLOSURE - HOUSES THE KEYPAD. THIS BOX INTERCONNECTS TO "B" USING 10 CONDUCTOR / 18 AWG WIRE. ENCLOSURE WEIGHT 12 LBS. (MAX.).

**NOTES:**

MOUNT 4 SILVER BOXES TO A PAIR OF 4"x4"x180" LG. GALVANIZED ASTM A500 STEEL POLES. BOTTOM OF THE LOWEST BOX MUST BE A MINIMUM OF 2 FEET ABOVE GROUND LEVEL. THE SUPPORT POLES MUST BE EMBEDDED AT A MINIMUM OF 5'-6" BELOW GROUND LEVEL.

PROJECT: UNIFIRST - MARYSVILLE  
 13059 41ST AVE NE  
 MARYSVILLE, WA 98271

SHEET TITLE: TYPICAL DETAILS

DATE: 2/11/2022  
 SCALE: SEE PLAN

SHEET: C-3  
 of 3