

# GEDDES MARINA INTERIM REMEDIAL ACTION

PREPARED FOR:  
**CITY OF MARYSVILLE**  
 LOCATED IN SEC. 33, T. 30 N., R. 5 E., W.M., SNOHOMISH COUNTY, MARYSVILLE, WA

## PROJECT CONTACTS

<b>CLIENT</b> CITY OF MARYSVILLE 80 COLUMBIA AVENUE MARYSVILLE, WA 98270  P: 360-363-8275 DAVE RASAR DRASAR@MARYSVILLEWA.GOV	<b>CIVIL ENGINEER</b> MAUL FOSTER & ALONGI, INC. 2815 SECOND AVENUE, SUITE 540 SEATTLE, WA 98121  P: 206-724-0614 ANDREW KAPAROS, P.E. AKAPAROS@MAULFOSTER.COM
	<b>AGENCY</b> US EPA REGION 10 BROWNFIELD PROGRAM ALASKA FIELD OFFICE  P: 907-271-3414 MARY GOOLIE GOOLIE.MARY@EPA.GOV

## PROJECT SUMMARY

**SITE ADDRESS:**  
 1326 FIRST STREET  
 MARYSVILLE, WA 98270

**NEW IMPROVEMENTS:**  
 THIS PROJECT INCLUDES THE PLACEMENT OF A HIGH-VISIBILITY DEMARCATION LAYER FOLLOWED BY THE CAPPING UPLAND AREAS WITH A CLEAN SOIL COVER.



VICINITY MAP

NOT TO SCALE

## SHEET INDEX

C0.0	COVER SHEET
C1.0	CONSTRUCTION NOTES
C1.1	MASTER LEGEND
C2.0	EXISTING CONDITIONS PLAN
C3.0	EROSION AND SEDIMENT CONTROL PLAN & DEMOLITION PLAN
C3.1	EROSION AND SEDIMENT CONTROL DETAILS
C4.0	GRADING PLAN
C5.0	CAP CONSTRUCTION PLAN

## GENERAL NOTES

- A SITE SURVEY HAS BEEN PERFORMED, BUT CONTRACTOR SHALL VERIFY LOCATIONS OF ALL EXISTING BUILDINGS, STRUCTURES, UTILITIES, AND UNDERGROUND PIPING PRIOR TO START OF CONSTRUCTION.
- HORIZONTAL DATUM: WASHINGTON STATE PLANE COORDINATE SYSTEM SOUTH ZONE, NAD 83. ELEVATION DATUM: NAVD 88, FEET
- CONTRACTOR TO VERIFY ALL UTILITY LOCATIONS AND DEPTHS PRIOR TO CONSTRUCTION. A MINIMUM OF TWO FULL BUSINESS DAYS PRIOR TO BEGINNING CONSTRUCTION, THE CONTRACTOR SHALL CALL 811 (UTILITY NOTIFICATION CENTER) FOR LOCATION MARK-UP OF EXISTING UTILITIES.
- ALL CONSTRUCTION, MATERIALS, AND WORKMANSHIP SHALL CONFORM TO THE LATEST STANDARDS AND PRACTICES OF THE CITY OF MARYSVILLE AND THE LATEST EDITION OF THE "STANDARD SPECIFICATIONS FOR ROAD, BRIDGE, AND MUNICIPAL CONSTRUCTION" PREPARED BY WSDOT/APWA.
- IN CASE OF A CONFLICT BETWEEN THE REGULATORY STANDARDS OR SPECIFICATIONS, THE MORE STRINGENT REQUIREMENT WILL PREVAIL.
- ANY CHANGES TO THE DESIGN AND/OR CONSTRUCTION SHALL BE APPROVED BY THE OWNER OR ENGINEER.
- APPROVAL OF THESE PLANS DOES NOT CONSTITUTE AN APPROVAL OF ANY OTHER CONSTRUCTION NOT SPECIFICALLY SHOWN ON THE PLANS. PLANS FOR STRUCTURES SUCH AS BRIDGES, BUILDINGS, TANKS, VAULTS, ROCKERIES, AND RETAINING WALLS MAY REQUIRE A SEPARATE REVIEW AND APPROVAL BY THE BUILDING DEPARTMENT PRIOR TO CONSTRUCTION.
- A COPY OF THESE APPROVED PLANS SHALL BE ON THE JOB SITE WHENEVER CONSTRUCTION IS IN PROGRESS.
- IT SHALL BE THE CONTRACTOR'S RESPONSIBILITY TO OBTAIN ALL CONSTRUCTION EASEMENTS AND PERMITS NECESSARY TO PERFORM THE WORK.
- THE CONTRACTOR IS RESPONSIBLE FOR ALL CONSTRUCTION STAKING.
- PUBLIC AND PRIVATE DRAINAGE WAYS SHALL BE PROTECTED FROM POLLUTION. NO MATERIAL IS TO BE DISCHARGED TO OR DEPOSITED IN STORMWATER SYSTEMS THAT MAY RESULT IN VIOLATION OF STATE OR FEDERAL WATER QUALITY STANDARDS.
- ALL CONSTRUCTION WITHIN THE PUBLIC RIGHT-OF-WAY SHALL HAVE AN APPROVED PUBLIC RIGHT-OF-WAY WORK PERMIT PRIOR TO ANY CONSTRUCTION ACTIVITY WITHIN THE RIGHT-OF-WAY.
- THE CONTRACTOR SHALL BE RESPONSIBLE FOR PROVIDING ADEQUATE SAFEGUARDS, SAFETY DEVICES, PROTECTIVE EQUIPMENT, FLAGGERS, AND ANY OTHER NEEDED ACTIONS TO PROTECT THE LIFE, HEALTH, AND SAFETY OF THE PUBLIC, AND TO PROTECT PROPERTY IN CONNECTION WITH THE PERFORMANCE OF WORK COVERED BY THE CONTRACTOR. ALL TRAFFIC CONTROL DEVICES SHALL CONFORM TO THE LATEST ADOPTED EDITION OF THE "MANUAL ON UNIFORM TRAFFIC CONTROL DEVICES" (MUTCD) PUBLISHED BY THE U.S. DEPARTMENT OF TRANSPORTATION. TWO-WAY TRAFFIC MUST BE MAINTAINED AT ALL TIMES ON THE ADJACENT PUBLIC STREETS.
- ANY PUBLIC OR PRIVATE CURB, GUTTER, SIDEWALK, OR ASPHALT DAMAGED DURING CONSTRUCTION SHALL BE REPAIRED TO CITY OF MARYSVILLE STANDARDS AND PRACTICES.
- THE CONTRACTOR SHALL BE RESPONSIBLE FOR MAINTAINING THE INTEGRITY OF ADJACENT UTILITIES WHICH MAY INCLUDE, BUT ARE NOT LIMITED TO, WATER, SANITARY SEWER, STORMWATER, POWER, TELEPHONE, CABLE TV, GAS, IRRIGATION, AND STREET LIGHTING. THE CONTRACTOR SHALL NOTIFY RESIDENTS AND BUSINESSES 48 HOURS IN ADVANCE OF ANY WORK AFFECTING ACCESS OR SERVICE AND SHALL MINIMIZE INTERRUPTIONS TO DRIVEWAYS FOR RESIDENTS AND BUSINESSES ADJACENT TO THE PROJECT.
- ALL LAWN AND VEGETATED AREAS DISTURBED WILL BE RESTORED TO ORIGINAL CONDITION. ANY DISTURBANCE OR DAMAGE TO OTHER PROPERTY ON ADJACENT PARCELS OR IN THE PUBLIC RIGHT OF WAY SHALL ALSO BE REPAIRED OR RESTORED TO ORIGINAL CONDITION.

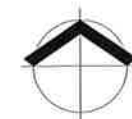

FOR BID

MAUL FOSTER & ALONGI  
 2815 SECOND AVE, SUITE 540  
 SEATTLE, WA 98121  
 206.658.7620  
 www.maulfooster.com



This digital seal contains the signature and document control. 5/13/16

GEDDES MARINA INTERIM  
 REMEDIAL ACTION  
 CITY OF MARYSVILLE  
 MARYSVILLE, WA

ISSUE	DATE	DESCRIPTION

PROJECT: 0689.01.03  
 DESIGNED: A. KAPAROS  
 DRAWN: Z. PYLE  
 CHECKED: J. CLARY  
 SCALE:

DRAWING NOT TO SCALE

SHEET TITLE

COVER

SHEET

C0.0

100-915  
 516-001

PLOTTED ON: 2016-06-11 11:55 AM  
 PLOTTER: Andrew Kaparos Plotter: 2016-06-11 11:55 AM  
 FILE: C:\Users\akaparos\Documents\Projects\0689.01.03\0689.01.03.dwg



# CONSTRUCTION NOTES

## GENERAL EROSION AND SEDIMENT CONTROL NOTES

1. ALL GRADING AND EROSION CONTROL MATERIALS, WORKMANSHIP AND METHODS OF CONSTRUCTION SHALL CONFORM TO THE CURRENT EDITION OF THE STORMWATER MANAGEMENT MANUAL FOR WESTERN WASHINGTON. EROSION CONTROL SHALL BE PER THE SPECIFICATIONS AND DETAILS CONTAINED THEREIN AND SHALL TAKE PRECEDENCE OVER OTHER STANDARDS AND SPECIFICATIONS.
2. THE CONTRACTOR WILL PROVIDE APPROPRIATE PROACTIVE EROSION CONTROL DURING CONSTRUCTION TO PREVENT THE EROSION CONTROL SYSTEMS FROM FAILING DUE TO THE COMBINATION OF PUBLIC FLOODS DURING CONSTRUCTION. ALL ADJACENT PROPERTIES THE LAGOON AREA OR THE SHROUDING PUBLIC FLOODS DURING CONSTRUCTION.
3. CARE SHOULD BE TAKEN TO NOT DISTURB MORE AREA THAN NEEDED FOR CONSTRUCTION REQUIREMENTS. ALL DISTURBED SOILS SURFACES ARE TO BE STABILIZED. STABILIZATION OF DISTURBED SOILS SHALL CONSIST OF: HYDROSEEDING OR HANDSEEDING, MULCHING, PLACING OF EROSION CONTROL, BARRIERS OR PLASTIC IN LANDSCAPING SOIL AREAS. ALL SEEDED AREAS ARE TO BE FERTILIZED, WATERED, AND MAINTAINED TO ENHANCE THE IMMEDIATE REGROWTH OF VEGETATION.
4. THE MAINTENANCE OF THESE EROSION AND SEDIMENT CONTROL (ESC) PLANS AND THE CONSTRUCTION, MAINTENANCE AND UPGRADING OF THESE ESC FACILITIES IS THE RESPONSIBILITY OF THE CONTRACTOR UNTIL ALL CONSTRUCTION IS COMPLETED AND APPROVED.
5. THE BOUNDARIES OF THE WORK AREA LIMITS SHOWN ON THIS PLAN SHALL BE CLEARLY FLAGGED IN THE FIELD PRIOR TO CONSTRUCTION. DURING THE CONSTRUCTION PERIOD, NO DISTURBANCE BEYOND THE FLAGGED WORK AREA LIMITS SHALL BE PERMITTED. THE FLAGGING SHALL BE MAINTAINED BY THE CONTRACTOR FOR THE DURATION OF CONSTRUCTION.
6. THE ESC FACILITIES SHOWN ON THIS PLAN MUST BE CONSTRUCTED IN CONJUNCTION WITH ALL SITE PREPARATION, STOCKPILING, ANY SURFACE WATER BODIES, ROADWAYS OR VIOLATE APPLICABLE STANDARDS.
7. THE ESC FACILITIES SHOWN ON THIS PLAN ARE THE MINIMUM REQUIREMENTS FOR ANTICIPATED SITE CONDITIONS. DURING THE CONSTRUCTION PERIOD, THESE ESC FACILITIES SHALL BE UPGRADED AS NEEDED FOR UNEXPECTED STORM EVENTS AND TO ENSURE THAT SEDIMENT AND SEDIMENT-LOADED WATER DO NOT LEAVE THE SITE.
8. THE ESC FACILITIES SHALL BE INSPECTED DAILY BY THE CONTRACTOR AND MAINTAINED AS NECESSARY TO ENSURE THEIR CONTINUED FUNCTIONING. THE CONTRACTOR SHALL MAINTAIN AN ON-SITE WRITTEN DAILY LOG OF EROSION CONTROL AND MAINTENANCE.
9. THE ESC FACILITIES ON AN INACTIVE SITE SHALL BE INSPECTED AND MAINTAINED A MINIMUM OF ONCE A MONTH AND WITHIN THE 24 HOURS FOLLOWING A RAINFALL EVENT TOTALING 0.5 IN OVER A 24 HOUR PERIOD OR GREATER.
10. ANY SEDIMENT DISCHARGED TO THE STORMWATER SYSTEM DUE TO CONSTRUCTION ACTIVITIES SHALL BE REMOVED TO PREVENT DISCHARGE TO SURFACE WATER BODIES.
11. A STABILIZED CONSTRUCTION ENTRANCE SHALL BE INSTALLED AT THE BEGINNING OF CONSTRUCTION AND MAINTAINED FOR THE DURATION OF THE PROJECT. ADDITIONAL MEASURES MAY BE REQUIRED TO ENSURE THAT ALL PAVED AREAS ARE KEPT CLEAN FOR THE DURATION OF THE PROJECT.
12. ALL EROSION AND SEDIMENT CONTROL MEASURES ARE TO BE PLACED PRIOR TO ANY DISTURBANCE CAUSED BY CLEARING OR GRADING AND SHALL CONFORM TO THE REQUIREMENTS OF THE STORMWATER MANAGEMENT MANUAL FOR WESTERN WASHINGTON, THE CITY OF MARYSVILLE ENGINEERING AND CONSTRUCTION STANDARDS, AND TO THE STANDARD DETAILS INCLUDED IN THESE PLANS. ALL EXPOSED AND UNWORKED SOILS SHALL BE STABILIZED BY THE APPROPRIATE BMP. DURING THE PERIOD FROM MAY 1 TO SEPTEMBER 30, NO SOIL SHALL BE EXPOSED FOR MORE THAN SEVEN (7) DAYS. FROM OCTOBER 1 TO APRIL 30, NO SOIL SHALL BE EXPOSED FOR MORE THAN TWO (2) DAYS.
13. PROTECTION:
  - a. PRIOR TO ANY SITE REMEDIATION ACTIVITIES, ALL STORM DRAINAGE INLETS SHALL BE PROTECTED PER THE REQUIREMENTS OF STORMWATER MANAGEMENT MANUAL FOR WESTERN WASHINGTON TO PREVENT SEDIMENT FROM ENTERING THE STORM DRAINAGE SYSTEM PRIOR TO PERMANENT STABILIZATION OF THE DISTURBED AREA. CLEAN FILTERS AS NECESSARY TO MAINTAIN DRAINAGE. PROVIDE APPROVED TRAFFIC CONTROL DEVICES AS NECESSARY, REMOVE FILTERS AND CLEAN CATCH BASINS FOLLOWING COMPLETION OF SITE WORK.
  - b. INSTALL Silt Fence PRIOR TO ANY SOIL DISTURBING ACTIVITIES AS SHOWN ON THIS PLAN TO PREVENT Silt INTRUSION UPON ADJACENT LAND AND ANY SURFACE WATER BODIES.
14. PROTECTION OF ADJACENT ROADS AND STREETS:
  - a. ALL CONSTRUCTION EQUIPMENT AND TRUCKS ENTERING THE SITE SHALL USE EXISTING CURB CUTS AND REMAIN ON EXISTING PAVED AREAS, UNLESS UTILIZED DIRECTLY FOR SOIL EXCAVATION AND HANDLING. ANY TRUCKS OR EQUIPMENT THAT ENTER THE CARPING AREAS SHALL HAVE ALL WHEELS WASHED AND DEBRIS REMOVED PRIOR TO EXITING THE SITE.
  - b. A WHEEL WASH SHALL BE CONSTRUCTED, IF DETERMINED NECESSARY BY THE ENGINEER, AT THE LOCATION DEFINED BY THE ENGINEER.
15. IN AREAS SUBJECT TO SURFACE AND AIR MOVEMENT OF DIRT WHERE ON-SITE OR OFF-SITE DAMAGE IS LIKELY TO OCCUR, ONE OR MORE OF THE FOLLOWING PREVENTATIVE MEASURES SHALL BE TAKEN FOR DUST CONTROL:
  - a. MINIMIZE THE PERIOD OF SOIL EXPOSURE THROUGH THE USE OF TEMPORARY GROUND COVER AND OTHER TEMPORARY STABILIZATION PRACTICES.
  - b. THE SITE IS SPRINKLED WITH WATER UNTIL THE SOIL IS WET. REPEAT AS NECESSARY TO PREVENT THE CARRY OUT OF MUD ONTO THE STREET. REFER TO PROTECTION OF ADJACENT STREETS NOTE.
16. STOCKPILED SOIL OR SHALL BE PLACED IN LOCATIONS AS APPROVED BY THE ENGINEER.
17. CONTRACTOR SHALL COVER STOCKPILES OVERNIGHT AND DURING HIGH WINDS OR PRECIPITATION EVENTS.
18. AREAS SUBJECT TO WIND EROSION SHALL USE APPROPRIATE DUST CONTROL MEASURES INCLUDING THE APPLICATION OF A FINE SPRAY OF WATER, PLASTIC SHEETING, STRAW MULCHING OR OTHER APPROVED MEASURES.
19. ACTIVE INLETS TO STORM WATER SYSTEMS SHALL BE PROTECTED THROUGH THE USE OF APPROVED INLET PROTECTION MEASURES. ALL INLET PROTECTION MEASURES ARE TO BE REGULARLY INSPECTED AND MAINTAINED AS NEEDED.
20. MATERIAL STOCKPILES ARE TO BE PROTECTED FROM PRECIPITATION BY THE FOLLOWING MEANS:
  - a. TEMPORARY - COVER PILES WITH TAPES OR PLASTIC SHEETING WEIGHTED WITH TREES, LUMBER, SAND BAGS, OR CONCRETE BLOCKS.
  - b. PERMANENT - COVER PILES WITH TAPES OR PLASTIC, OR RESEED, PERIMETER AREAS AROUND PILES ARE TO BE SURROUNDED WITH EROSION CONTROL, FILTER FABRIC FENCES UNTIL SOIL SURFACE IS STABILIZED WITH RESEEDING.
21. THE ESC FACILITIES SHALL BE INSPECTED DAILY BY THE CONTRACTOR AND MAINTAINED AS NECESSARY TO ENSURE CONTINUOUS FUNCTIONING, INSPECTION AND MAINTENANCE SHALL INCLUDE, BUT NOT BE LIMITED TO,
  - a. VERIFYING THAT ALL AREAS ARE GRADED SUCH THAT ALL RUNOFF IS DIRECTED TO A SEDIMENTATION TRAP FACILITY BEFORE BEING DISCHARGING TO SURFACE.

## REMOVAL OF TRAPPED SILT AT Silt BARRIERS, Silt TRAPS, OR POINTS OF ACCUMULATION.

- a. ADDITIONAL PROTECTIVE MEASURES, AS REQUIRED, DUE TO JOB SITE CONDITIONS.
- c. STABILIZED CONSTRUCTION ENTRANCES INSTALLED AT THE BEGINNING OF CONSTRUCTION AND MAINTAINED FOR THE DURATION OF THE PROJECT. MONITORING OF VEHICLES LEAVING THE SITE TO MINIMIZE TRANSMISSION OF LOOSE SOILS TO THE PUBLIC ROADWAYS.
- d. IF SEDIMENT IS TRANSPORTED ONTO A ROAD SURFACE, THE SURFACE IS TO BE CLEANED THOROUGHLY AT THE END OF EACH DAY.
22. AT NO TIME SHALL MORE THAN ONE FOOT OF SEDIMENT BE ALLOWED TO ACCUMULATE WITHIN A TRAPPED CATCH BASIN. ALL CATCH BASINS AND CONVEYANCE LINES SHALL BE CLEANED PRIOR TO PROJECT COMPLETION. THE CLEANING OPERATION SHALL NOT FLUSH SEDIMENT LOADED WATER INTO THE DOWNSPREAM SYSTEM.
23. THIS SEDIMENTATION AND EROSION CONTROL PLAN IS INTENDED TO BE UTILIZED AS A GUIDE TO CONTROL THE TRANSPORTATION OF LOOSE SOILS FROM THE PROPERTY THAT CAUSE WATER QUALITY AND NUISANCE PROBLEMS OUTSIDE OF THE CONSTRUCTION AREA.
24. DEPENDING ON THE CONTRACTOR'S CONSTRUCTION PRACTICES, SOME PORTIONS OF THE PROPOSED EROSION CONTROL PLAN MAY BE VARIED ACCORDING TO THE JOB SITE CONDITION. ALL CHANGES TO THE PLAN MUST BE REVIEWED AND APPROVED BY THE ENGINEER PRIOR TO ADJUSTMENT.

## GENERAL SEDIMENT FENCE NOTES:

1. FILTER FABRIC SHALL BE PURCHASED IN A CONTINUOUS ROLL CUT TO THE LENGTH OF THE BARRIER TO AVOID USE OF JOINTS. WHEN JOINTS ARE NECESSARY, FILTER CLOTH SHALL BE SPICED TOGETHER ONLY AT A SUPPORT POST WITH A MINIMUM 6 INCH OVERLAP, AND BOTH ENDS SECURELY FASTENED TO THE POST.
2. THE FILTER FABRIC FENCE SHALL BE INSTALLED TO FOLLOW THE CONTOURS WHERE FEASIBLE. THE FENCE POSTS SHALL BE SPACED A MAXIMUM OF 8 FEET APART AND DRIVEN SECURELY INTO THE GROUND A MINIMUM OF 24 INCHES.
3. WHEN STANDARD STRENGTH FILTER FABRIC IS USED, A WIRE SUPPORT FENCE SHALL BE FASTENED SECURELY TO THE UPSIDE SIDE OF THE FENCE USING 1/2" DIA. GALVANIZED WIRE STAPLES AT LEAST 1 INCH LONG. THE WIRE SHALL EXTEND INTO THE TRENCH A MINIMUM OF 4 INCHES AND SHALL NOT EXTEND MORE THAN 30 INCHES ABOVE THE ORIGINAL GROUND SURFACE.
4. THE STANDARD STRENGTH FILTER FABRIC SHALL BE STAPLED OR WHEDED TO THE FENCE AND 12 INCHES OF THE FABRIC SHALL BE EXTENDED THE TRENCH. THE FABRIC SHALL NOT EXTEND MORE THAN 30 INCHES ABOVE THE ORIGINAL GROUND SURFACE. FILTER FABRIC SHALL NOT BE STAPLED TO TREES.
5. SEDIMENT FENCES SHALL BE REMOVED WHEN THEY HAVE SERVED THEIR USEFUL PURPOSE AND AT THE ENGINEER'S DIRECTION.
6. SEDIMENT FENCES SHALL BE INSPECTED BY THE CONTRACTOR IMMEDIATELY AFTER EACH RAINFALL AND AT LEAST DAILY DURING PROLONGED RAINFALL. ANY REQUIRED REPAIRS SHALL BE MADE IMMEDIATELY.
7. CONSTRUCTION SPECIFICATIONS:
  - a. Silt FENCE: THIS SEDIMENT BARRIER UTILIZES STANDARD STRENGTH OR EXTRA STRENGTH SYNTHETIC FILTER FABRICS. IT IS DESIGNED FOR SITUATIONS IN WHICH ONLY SHEET OR OVERLAND FLOWS ARE EXPECTED.
  - b. THE HEIGHT OF A Silt FENCE SHALL NOT EXCEED 30 INCHES (HIGHER FENCES MAY IMPOUND VOLUMES OF WATER SUFFICIENT TO CAUSE FAILURE OF THE STRUCTURE).
  - c. A MINIMUM 4 INCH WIDE BY 4 INCH DEEP TRENCH SHALL BE EXCAVATED ALONG THE LINE OF POSTS AND UPSLOPE OF THE BARRIER.
  - d. THE TRENCH SHALL BE BACKFILLED WITH NATIVE SOIL.
8. MAINTENANCE:
  - a. SHOULD THE FABRIC ON A SEDIMENT FENCE DECOMPOSE OR BECOME INEFFECTIVE PRIOR TO THE END OF THE EXPECTED USABLE LIFE AND THE SEDIMENT FENCE STILL BE NECESSARY, THE FABRIC SHALL BE REPLACED PROMPTLY.
  - b. SEDIMENT DEPOSITS SHALL BE REMOVED AFTER EACH STORM EVENT AND WHEN DEPOSITS REACH APPROXIMATELY ONE HALF THE HEIGHT OF THE BARRIER.
  - c. ANY SEDIMENT DEPOSITS REMAINING IN PLACE AFTER THE SEDIMENT FENCE IS NO LONGER REQUIRED SHALL BE DRESSED TO CONFORM WITH THE EXISTING GRADE, PREPARED AND SEED.
9. ALL BASE ESC MEASURES INLET PROTECTION, PERIMETER SEDIMENT CONTROL, CONSTRUCTION ENTRANCES, ETC.] MUST BE IN PLACE, FUNCTIONAL AND APPROVED IN AN INITIAL INSPECTION PRIOR TO COMMENCEMENT OF CONSTRUCTION ACTIVITIES.

## SITE GRADING

1. THE OWNER WILL STRIP AND GRUB ALL PORTIONS OF THE SITE WITHIN THE LIMITS OF THE WORK PRIOR TO THE BEGINNING OF ANY GRADING OPERATIONS.
2. FOLLOWING STRIPPING AND GRUBBING, THE CONTRACTOR SHALL ROUGH GRADE THE EXPOSED SOILS TO BE SMOOTH AND FREE OF IRREGULARITIES THAT MIGHT ACCUMULATE SURFACE WATER PRIOR TO THE PLACEMENT OF HIGH-VARIABLE DEFORMATION LAYER AND SUBSEQUENT CLEAN SOIL CAP MATERIAL. THE CONTRACTOR SHALL COMPACT THE EXISTING SURFACE TO A MAXIMUM DRY DENSITY FOR THE GRANULAR NATIVE SOILS UNLESS OTHERWISE SPECIFIED ON THE PLAN OR BY THE OWNER. ALL OTHER SOILS SHALL BE COMPACTED TO NO LESS THAN 95%.
3. COMPACTION TESTING SHALL BE DONE IN ACCORDANCE WITH ASTM D 698 (STANDARD PROCTOR).
4. ALL GRADING OPERATIONS AND DISTURBED SURFACE STABILIZATION SHALL BE IN ACCORDANCE WITH THE PROJECT EROSION CONTROL PLAN AND SHALL MEET REQUIREMENTS OF THE STORMWATER MANUAL FOR WESTERN WASHINGTON.



GEDDES MARINA INTERIM  
REMEDIAL ACTION  
CITY OF MARYSVILLE  
MARYSVILLE, WA



**MAUL FOSTER ALONGI**  
2815 SECOND AVENUE, SUITE 540  
SEATTLE, WA 98121  
PHONE: 206.858.7620  
www.maulfooster.com

PROJECT: 0687103	DESIGNED: K. KAYAKOS
DRAWN: Z. PIATY	CHECKED: J. CARY
SCALE:	
SHEET TITLE:	CONSTRUCTION NOTES
SHEET:	C1.0

ISSUE	DATE	DESCRIPTION
***	***	***
***	***	***
***	***	***
***	***	***
***	***	***
***	***	***

FOR BID







- NOTES:
1. ALL UTILITIES SHOWN ARE APPROXIMATE. SEE GENERAL NOTE 1.
  2. SHEET C20
  3. EXISTING ASPHALT, CONCRETE, AND GRAVEL SHOWN IS APPROXIMATE. CONTRACTOR SHALL VERIFY EXTENT.



**GEDDES MARINA INTERIM  
REMEDIAL ACTION**  
CITY OF MARYSVILLE  
MARYSVILLE, WA



**MAUL FOSTER ALONGI**  
2815 SECOND AVENUE, SUITE 540  
SEATTLE, WA 98121  
PHONE: 206.858.7620  
www.maulfooster.com

ISSUE	DATE	DESCRIPTION

PROJECT: 04810103  
DESIGNED BY: KAPOROS  
DRAWN: LPTLE  
CHECKED: J. CLAY  
SCALE: 1"=40'

NOTE: THIS IS A PRELIMINARY SHEET. ALL DIMENSIONS AND LOCATIONS ARE APPROXIMATE. CONTRACTOR SHALL VERIFY EXTENT.

EXISTING  
CONDITIONS  
SHEET  
C20



NOTES:

GENERAL

1. THE EXISTING SITE IS GENTLY SLOPED TOWARDS THE LAGOON, CURRENTLY, ALL RUNOFF DRAINS TO THE LAGOON, FOLLOWING SITE CAPPING, ALL WORK AREAS WILL BE GENTLY SLOPED TOWARDS THE LAGOON. POST-CONSTRUCTION DIRECTION OF STORMWATER FLOW WILL MATCH THE PRE-CONSTRUCTION DIRECTION OF FLOW.
2. ALL WORK WILL OCCUR ABOVE THE ORDINARY HIGH WATER MARK (OHWM), AS SHOWN ON THE PLAN.
3. ALL CATCH BASINS ON THE PROPERTIES AFFECTED BY CONSTRUCTION AND WITHIN 500 FEET DOWN GRADIENT FROM LAND DISTURBING ACTIVITIES SHALL HAVE INLET PROTECTION TO PREVENT DISCHARGES TO SURFACE WATERS OR CONVEYANCE SYSTEMS LEADING TO SURFACE WATERS.
4. INSTALL SEDIMENT FENCING AND OTHER BMPs AS NECESSARY TO PREVENT SEDIMENT-LADEN RUNOFF FROM EXITING THE WORK AND STOCKPILE AREAS.
5. STOCKPILE COVER SHALL BE DEPLOYED DURING HEAVY RAIN/WIND AND WHEN STOCKPILE IS NOT USED FOR MORE THAN 48 HOURS. COVER MATERIALS SHALL BE DEPLOYED AS SHOWN ON DETAILS D AND E, SHEET C3.1.
6. STOCKPILE PERIMETER SILT FENCING REMOVED FOR ACCESS SHALL BE REPLACED AT THE END OF EACH WORKING DAY. THE PERIMETER SHALL REMAIN COMPLETELY ENCLOSED DURING NON-WORKING HOURS.
7. IF WIND EROSION (I.E. DUST GENERATION) IS OBSERVED, APPROPRIATE DUST CONTROL MEASURES SHALL BE IMPLEMENTED, INCLUDING THE APPLICATION OF A FINE SPRAY OF WATER, PLASTIC SHEETING, STRAW MULCHING, OR OTHER APPROVED MEASURES.
8. NO SOIL MAY BE TRACKED OFF SITE BY ANY TRAFFIC RELATED TO THE CONSTRUCTION ACTIVITIES. THIS MAY BE ACHIEVED BY ONE OF THE FOLLOWING METHODS:
  - a. USE EXISTING ASPHALT AS THE ONLY ALLOWABLE SURFACE FOR CONSTRUCTION THROUGH TRAFFIC.
  - b. INSTALL CONSTRUCTION ENTRANCE/EXIT AND ALLOW CONSTRUCTION TRAFFIC TO ENTIRE EXTENT OF SITE.
  - c. ADDITIONAL MEASURES MAY BE REQUIRED TO ENSURE THAT ADJACENT PAVED AREAS ARE KEPT CLEAN FOR THE DURATION OF THE PROJECT.
  - d. PRIOR TO THE START OF ON-SITE CONSTRUCTION ACTIVITY, THE CONTRACTOR SHALL INSTALL TEMPORARY PERIMETER FENCE TO ENCLOSE CONSTRUCTION AREA, AS NOTED ON PLAN, AS WELL AS ANY OTHER MEANS NECESSARY TO ENSURE PUBLIC SAFETY.

DEMOLITION

1. OWNER WILL DEMOLISH BUILDINGS, ASPHALT, AND CONCRETE PADS AS NEEDED. CONTRACTOR SHALL DEMOLISH SELECT FEATURES AS NEEDED FOR CAP CONSTRUCTION.
2. ALL DEMOLITION ACTIVITIES WILL BE CONDUCTED IN COMPLIANCE WITH APPLICABLE RULES AND REGULATIONS.

EROSION CONTROL

1. MAINTAIN SILT FENCE OR A COMPOST SOCK DURING EXCAVATION AS SHOWN ON THESE PLANS AND ON DETAIL A, SHEET 3.1 TO PREVENT SILT INTRUSION TO ADJACENT LAND AND SURFACE WATER BODIES. THE SILT FENCE SHALL BE MAINTAINED TO FOLLOW THE SITE TOPOGRAPHY WHERE FEASIBLE. THE FENCE POSTS SHALL BE SPACED A MAXIMUM OF 8 FEET APART AND DRIVEN SECURELY INTO THE GROUND A MINIMUM OF 24 INCHES.
2. CATCH BASINS: CLEAN BEFORE RETENTION CAPACITY HAS BEEN REDUCED BY FIFTY PERCENT. SEDIMENT BASINS AND SEDIMENT TRAPS: REMOVE TRAPPED SEDIMENTS BEFORE DESIGN CAPACITY HAS BEEN REDUCED BY FIFTY PERCENT AND AT COMPLETION OF PROJECT.
3. THE INTENTIONAL WASHING OF SEDIMENT INTO STORM SEWERS OR DRAINAGE WAYS MUST NOT OCCUR. VACUUMING OR DRY SWEEPING AND MATERIAL PICKUP MUST BE USED TO CLEANUP RELEASED SEDIMENTS.
4. PREVENT TRACKING OF SEDIMENT ONTO PUBLIC OR PRIVATE ROADS USING BMPs SUCH AS AN EXIT TIRE WASH.
5. AT THE END OF EACH WORKDAY SOIL STOCKPILES MUST BE STABILIZED OR COVERED. OR OTHER BMPs MUST BE IMPLEMENTED TO PREVENT DISCHARGES TO SURFACE WATERS OR CONVEYANCE SYSTEMS LEADING TO SURFACE WATERS.
6. FOLLOWING CONSTRUCTION OF THE CAP, THE CONTRACTOR SHALL TRACK THE SOIL SURFACE. ADDITIONAL STABILIZATION MEASURES WILL BE PERFORMED BY THE OWNER.

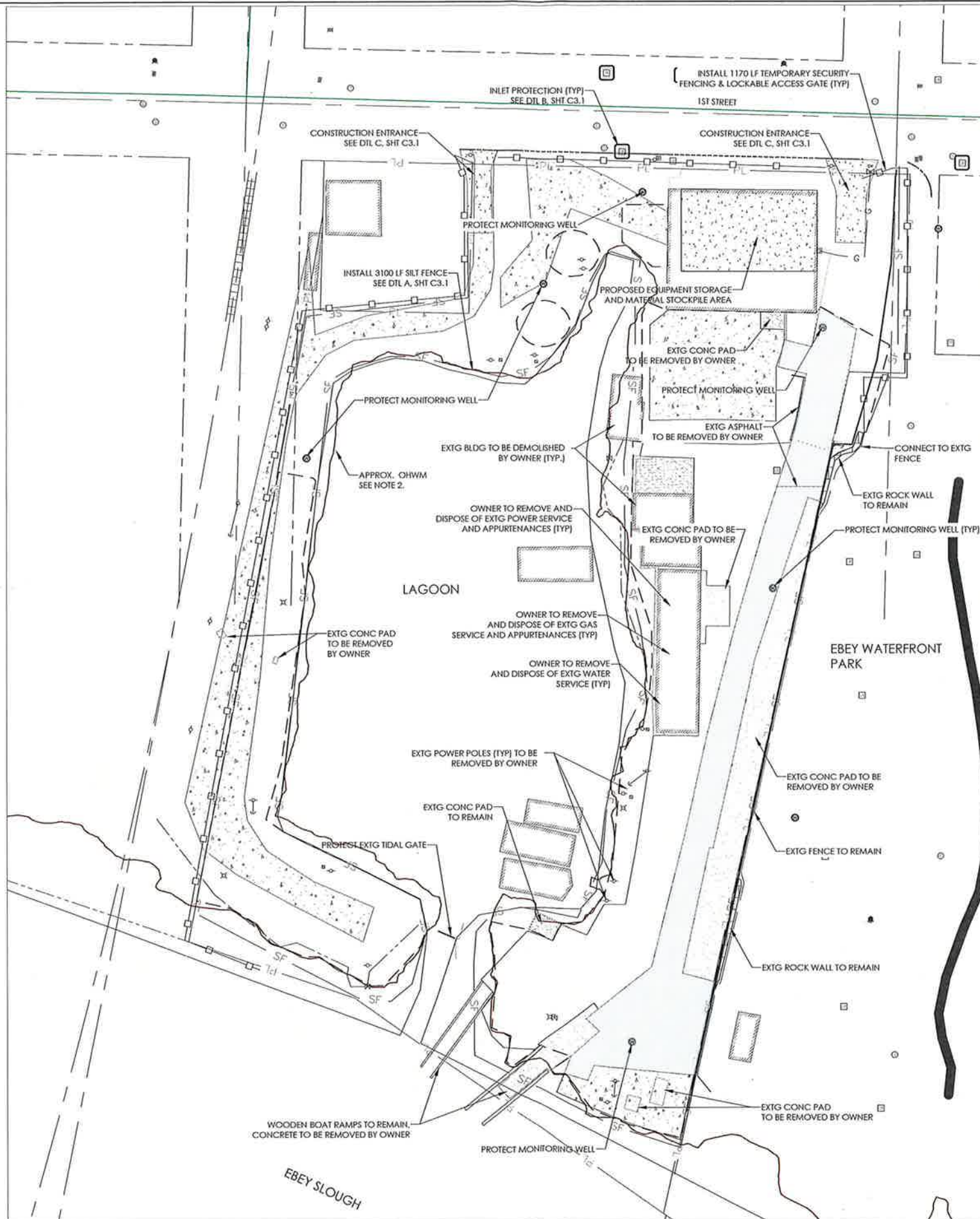

LEGEND

- SILT FENCE ——— SF ———
- CONSTRUCTION FENCE ——— [ ] ———
- GRADING EXTENT ——— [ ] ———
- EXISTING ASPHALT [ ]
- EXISTING CONCRETE [ ]

MAUL FOSTER ALONGI  
2815 2ND AVENUE, SUITE 540  
SEATTLE, WA 98121  
PHONE: 206.888.7620  
www.maulfooster.com



This digital seal certifies the signatory and document on file. 5/13/16

GEDDES MARINA INTERIM  
REMEDIAL ACTION  
CITY OF MARYSVILLE  
MARYSVILLE, WA

NO.	DATE	DESCRIPTION

PROJECT: 0689.01.03  
DESIGNED: A. KAPAROS  
DRAWN: Z. PYLE  
CHECKED: J. CLARY  
SCALE  
0 40' 80'

NOTE: BAR IS ONE INCH ON ORIGINAL DRAWING. IF NOT ONE INCH ON THIS SHEET, ADJUST SCALE ACCORDINGLY.  
SHEET TITLE  
EROSION AND  
SEDIMENT  
CONTROL &  
DEMOLITION PLAN  
SHEET  
C3.0



FOR BID

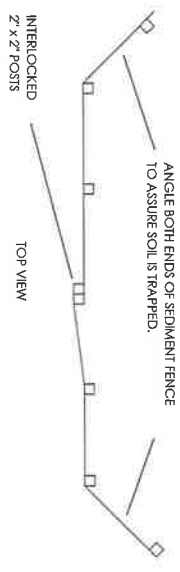
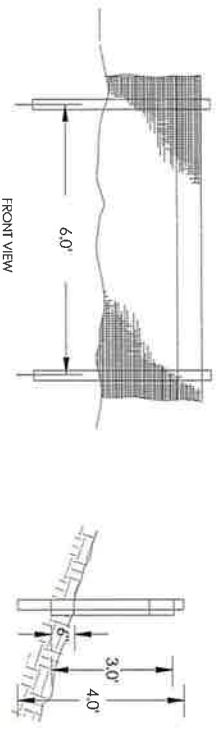

- NOTES:
1. BURY BOTTOM OF FILTER FABRIC 6" MIN. VERTICALLY BELOW GRADE.
  2. 2" X 2" FR. PINE OR STEEL FENCE POSTS.
  3. STITCHED LOOPS TO BE INSTALLED UPHILL SIDE OF SLOPE.
  4. COMPACT NATIVE FILL IN ALL AREAS OF FILTER FABRIC TRENCH.
  5. SILT FENCING SHALL BE INSTALLED ON CONTOUR.

**A** SILT FENCE  
C3.1 NIS

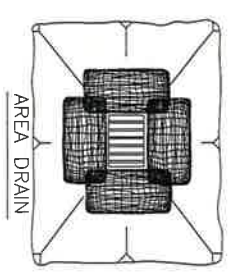
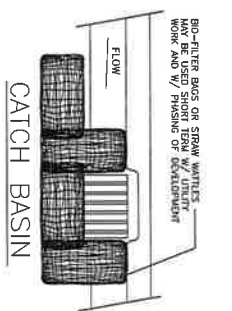

- NOTES:
1. ADDITIONAL MEASURES MUST BE CONSIDERED DEPENDING ON SOIL TYPE.
  2. BIO-FILTER BAGS SHOULD BE STAKED WHERE APPLICABLE USING (2) 1" X 2" WOODEN STAKES OR APPROVED EQUAL PER BAG.
  3. STRAW WATTLES MUST BE STABILIZED BY ATTACHING WIRE CLIPS TO THE CATCH BASIN PER MANUFACTURERS SPECIFICATIONS.
  4. INLET PROTECTION MUST BE REGULARLY INSPECTED BY THE EROSION CONTROL INDIVIDUAL TO ENSURE PROPER PLACEMENT/FUNCTION AND MAINTENANCE.

**B** INLET PROTECTION DETAIL  
C3.1 NIS

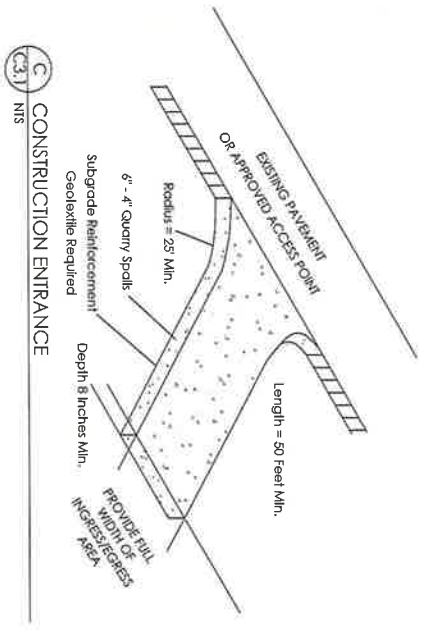

**C** CONSTRUCTION ENTRANCE  
C3.1 NIS

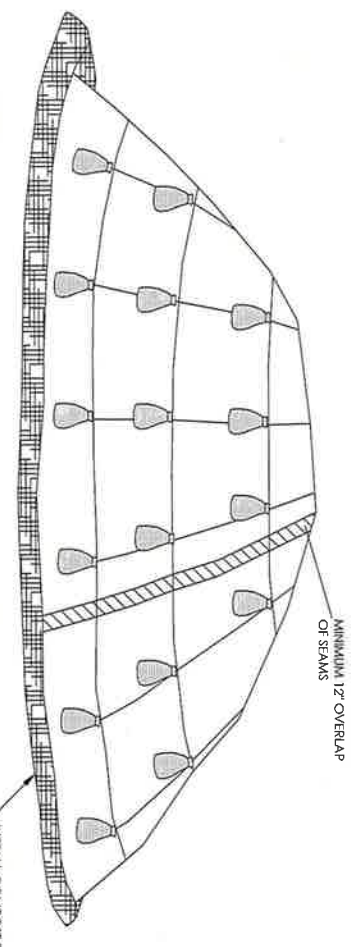

- NOTES:
1. MINIMUM 12" COVER OVERLAP AT ALL SEAMS.
  2. COMPOST SOCK OR SILT FENCE REQUIRED AT TOE OF STOCKPILE AREA AS SHOWN IN THE PERIMETER PLAN VIEW, DETAIL E, THIS SHEET.
  3. STOCKPILE COVER SHALL BE MAINTAINED TIGHTLY IN PLACE BY USING SAND BAGS OR TIRES ON ROPS WITH A MAXIMUM OF 1' GRID SPACING IN ALL DIRECTIONS.
  4. STOCKPILE COVERING SHALL BE BLACK PLASTIC WITH U.V. PROTECTION.
  5. IF STOCKPILING POTENTIALLY CONTAMINATED MATERIAL ON GRAVEL OR SOIL SURFACE, PLACE IMPERMEABLE FABRIC BETWEEN SURFACE AND EXCAVATED SOIL.

**D** STOCKPILE COVER DETAIL  
C3.1 NIS

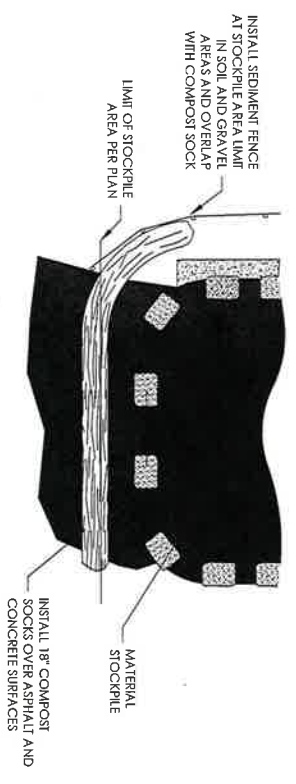

PERIMETER PLAN VIEW DETAIL  
NIS

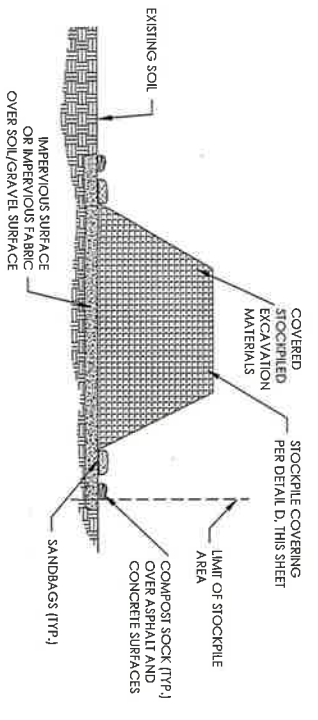

CROSS SECTION VIEW FOR IMPERVIOUS SURFACE WITH COMPOST SOCK  
NIS

**E** STOCKPILE EROSION CONTROL DETAIL  
C3.1 NIS

ISSUE	DATE	DESCRIPTION





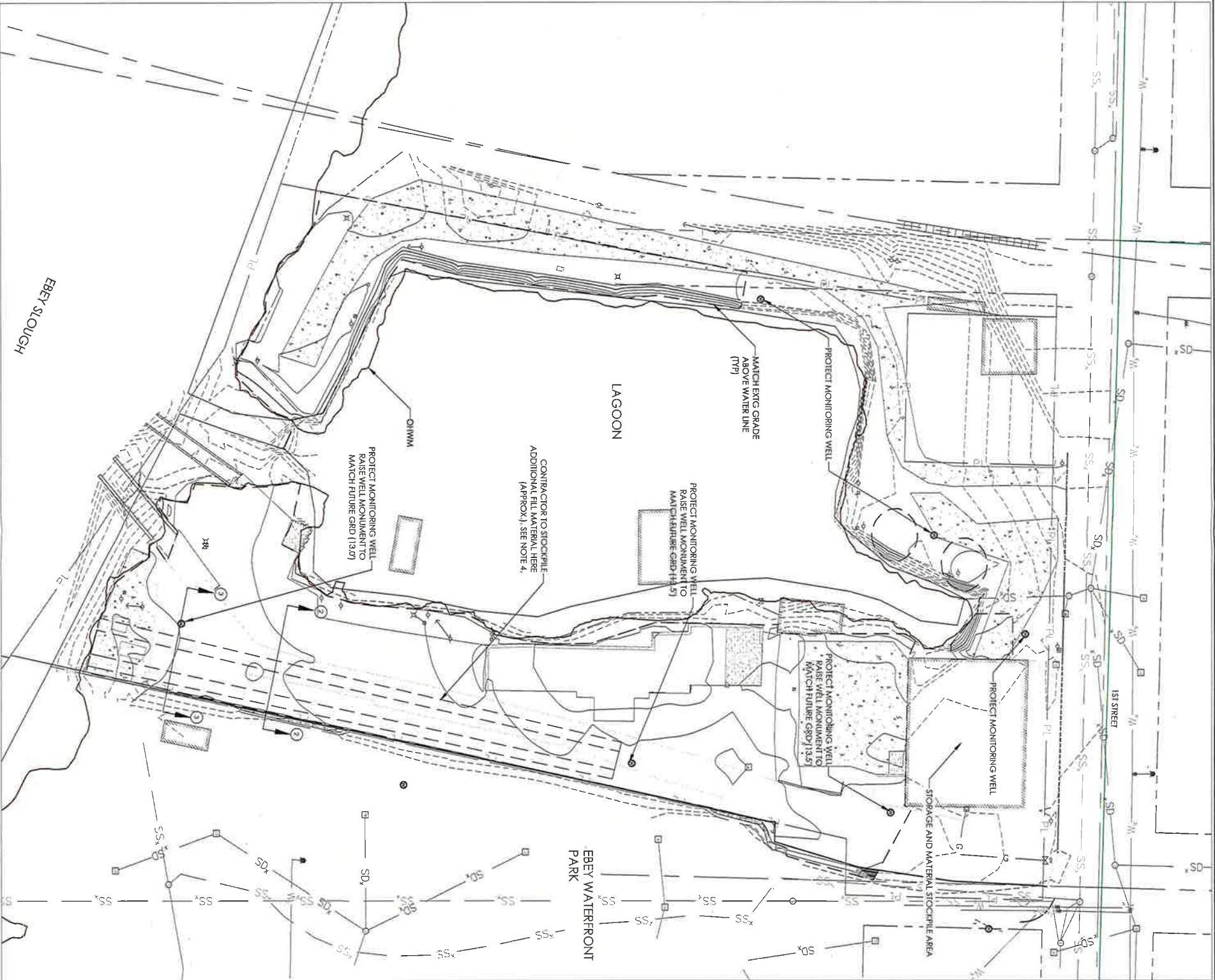
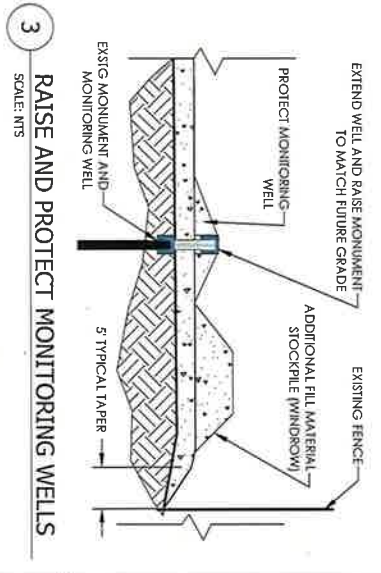
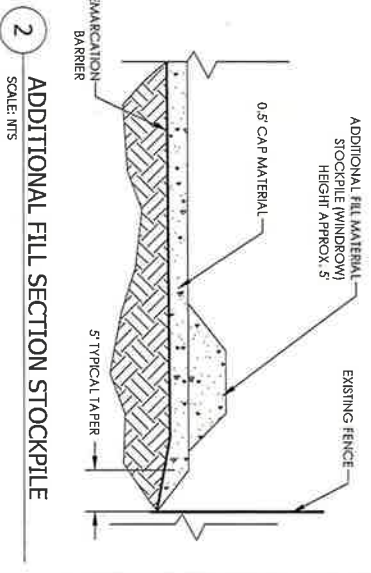
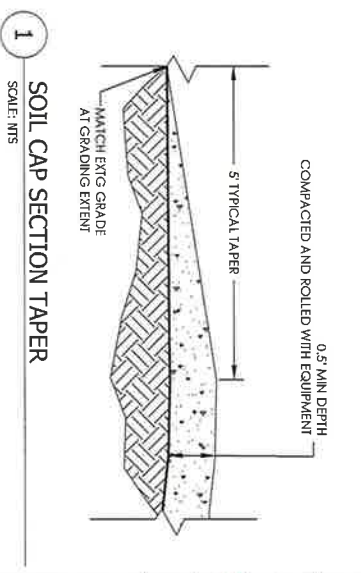

GRADING QUANTITIES			
NON-STRUCTURAL	STRUCTURAL	STRUCTURAL	STRUCTURAL
FILL	3000 CV	FILL	0 CV
CUT (DISPOSAL)	0 CV	CUT	0 CV
NET (IMPORT)	3000 CV	DISPOSAL	0 CV

- GRADING CONSTRUCTION NOTES**
1. PLACE GEOTEXTILE BARRIER BELOW ALL CAP MATERIAL (SEE DTL. 1, SH. CS.0)
  2. MATCH EXISTING GRADE AT EXTENT OF ALL GRADING AREAS
  3. FROM EXISTING GRADE, INCREASE DEPTH OF CAP TO 6" WITHIN 5 FT; SEE DTL. 1, THIS SH.
  4. PLACE 6" SOIL MATERIAL OVER ALL CAP AREAS. ADDITIONAL FILL MATERIAL TO BE PLACED IN STOCKPILE (MINIMUM) TO BE EXPOSED TO SOIL. FUTURE USE BY THE OWNER. SEE DTL. 2, THIS SH.



FOR BID

ISSUE	DATE	DESCRIPTION

PROJECT: 06990103  
 DESIGNED: A. KAPROS  
 DRAWN: Z. PYLE  
 CHECKED: J. CLARY  
 SCALE: 1" = 40'  
 SHEET TITLE: GRADING PLAN  
 SHEET: CA.0

**GEDDES MARINA INTERIM REMEDIAL ACTION**  
 CITY OF MARYSVILLE  
 MARYSVILLE, WA



**MAUL FOSTER ALONG I**  
 2815 2ND AVENUE, SUITE 540  
 SEATTLE, WA 98121  
 PHONE: 206.858.7620  
 www.maulfooster.com



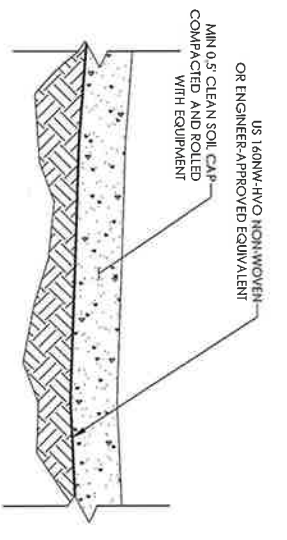

1 SOIL CAP SECTION  
SCALE: NTS

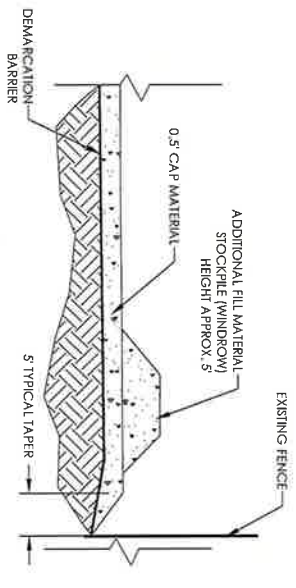

2 ADDITIONAL FILL SECTION STOCKPILE  
SCALE: NTS

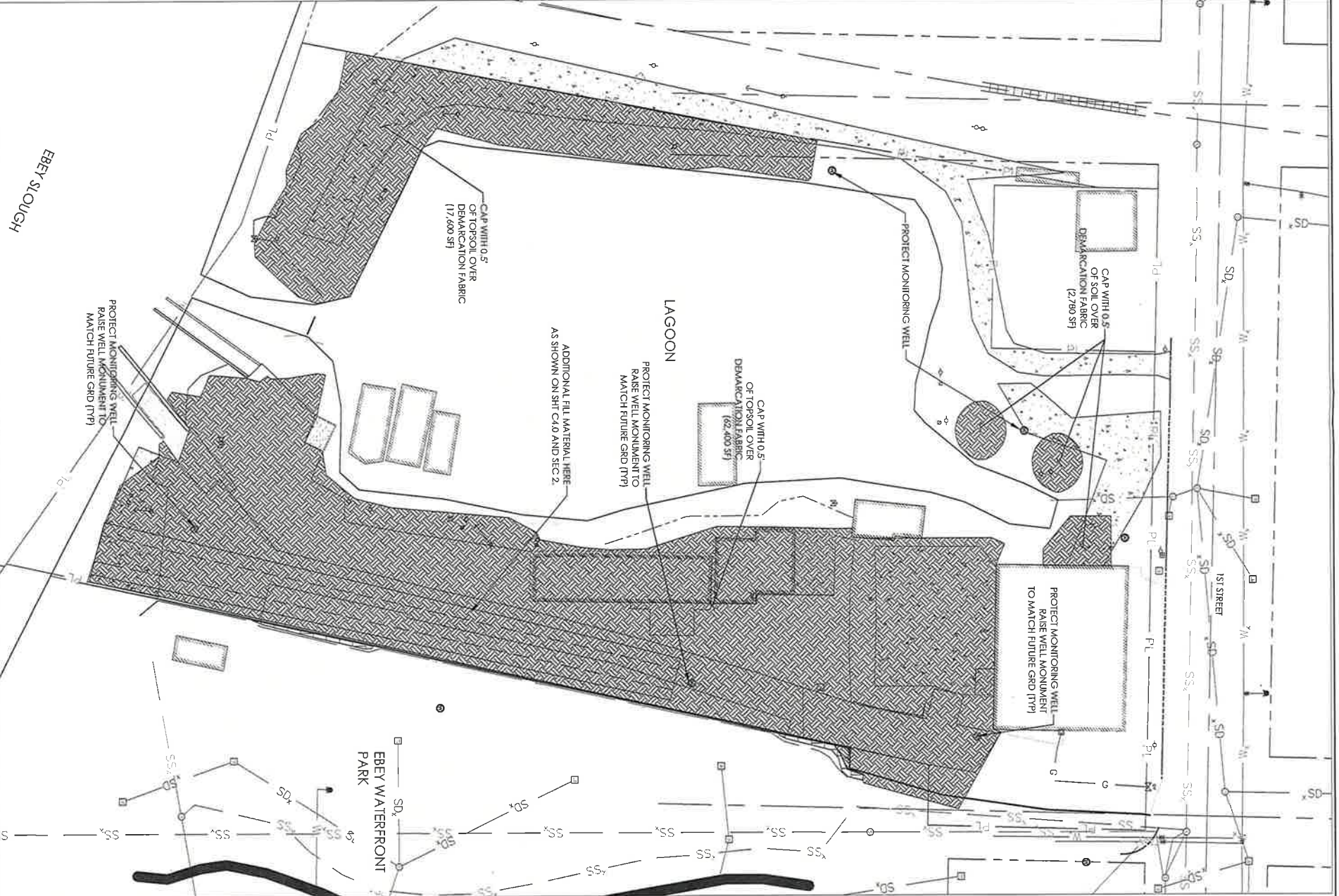

- NOTES:
- 1) ALL CAP MATERIAL MUST BE WEED FREE, CERTIFIED CLEAN SOIL/SAND AND APPROVED BY THE ENGINEER OR OWNER.
  - 2) DEMARCATION FABRIC SHALL BE US 160NW-HVO NON-WOVEN OR EQUIVALENT.
  - 3) SEE DETAILS 1 AND 2. THIS SHEET FOR CAP MATERIAL DETAILS.
  - 4) RAISE MONITORING WELL MONUMENTS TO MATCH FINISHED GRADES, AS INDICATED ON GRADING PLAN, SHEET CA0.



FOR BID

ISSUE	DATE	DESCRIPTION

PROJECT: 0689201.03  
 DESIGNER: A. ZAVANOS  
 DRAWN: J. FRIE  
 CHECKED: J. CLARY  
 SCALE: 1"=40'

NOTE: THIS IS A PRELIMINARY DRAWING. IT IS NOT TO BE USED FOR CONSTRUCTION WITHOUT THE APPROVAL OF THE ENGINEER.

SHEET TITLE: CAP CONSTRUCTION PLAN

SHEET: C5.0

**GEDDES MARINA INTERIM REMEDIAL ACTION**  
 CITY OF MARYSVILLE  
 MARYSVILLE, WA



**MAUL FOSTER ALONGI**  
 2815 SECOND AVE, SUITE 540  
 SEATTLE, WA 98121  
 PHONE: 206.858.7620  
 www.maulfooster.com