

**PLANT LIST**

SYMBOL	BOTANICAL / COMMON	*QUANTITY	SIZE	CONDITION
	<i>Acer truncatum</i> x <i>A. plat.</i> 'Warrenred' / Pacific Sunset Maple	18	2" cal.	B&B
	<i>Fraxinus oxycarpa</i> 'Raywood' / Raywood Ash	3	2" cal.	B&B
	<i>Prunus cerasifera</i> 'Kräuter Vesuvius' / Kräuter Vesuvius Plum	36	2" cal.	B&B
	<i>Acer rubrum</i> 'Bow Hall' / Bow Hall Red Maple	21	2" cal.	B&B
	<i>Prunus</i> x <i>hillieri</i> 'spire' / Spire Cherry	10	2" cal.	B&B
	<i>Pinus flexilis</i> 'Vanderwolf's pyramid' / Vanderwolts pyramid Pine	24	6' min.	B&B
	<i>Pinus nigra</i> / Black Pine	12	6' min.	B&B
	<i>Thuja O.</i> 'Emerald Green' / Emerald green arborvitae		6' min.	full & bushy
	<i>Evonymus alata</i> 'Compacta' / Compact Burning Bush	5	gallon	full & bushy
	<i>Prunus lauro</i> 'Zabellana' / Zabel Cherry Laurel	2	gallon	full & bushy
	<i>Viburnum tinus</i> 'Spring Bouquet' / Spring Bouquet Viburnum	2	gallon	full & bushy
	<i>Viburnum tinus</i> 'Spring Bouquet' / Spring Bouquet Viburnum	5	gallon	full & bushy
	<i>Raphiolepis umbellata minor</i> / Dwarf Yedda Hawthorn	2	gallon	full & bushy
	<i>Nandina domestica</i> 'Moon Bay' / Moon Bay Heavenly Bamboo	2	gallon	full & bushy
	<i>Lavendula</i> 'Hidcote' / Hidcote Lavender	1	gallon	full & bushy
	<i>Ilex crenata</i> 'Helleri' / Heller Japanese Holly	2	gallon	full & bushy
	<i>Calluna vulgaris</i> 'Res Star' / Red Star Heather	1	gallon	full & bushy
	<i>Spiraea</i> x <i>bumalda</i> 'Limemound' / Limemound Spiraea	1	gallon	full & bushy
	<i>Arctostaphylos uva-ursi</i> / kinnickinnik	4"	pots	
	Hydroseeded swale grass mix, PT 870: • Turf type tall fescue • Perennial ryegrass • Creeping red fescue • Colonial bentgrass 7 pounds per 1000 sf	24"	o.c.	

\* CONFIRM ALL PLANT QUANTITIES

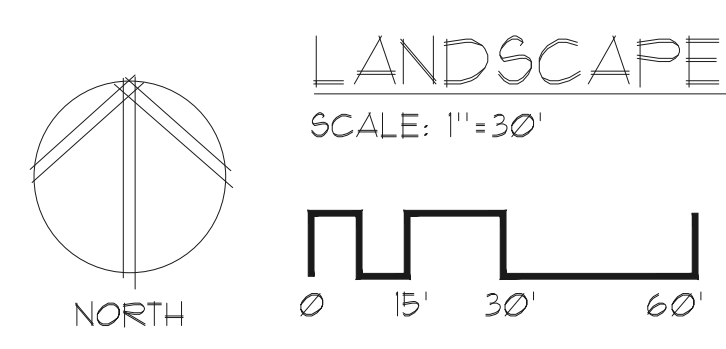

**LANDSCAPE PLAN**  
SCALE: 1"=30'



**MAIN STREET DESIGN**  
LANDSCAPE ARCHITECTURE  
9402 Tidal Court  
Bainbridge Is., WA 98110  
(206) 842-7886

CITY OF MARYVILLE  
FILE # PA 23010

**LANDSCAPE PLAN** sheet **L-1**

PROPOSED BUILDING FOR  
**IDEAL INDUSTRIAL PARK**  
SMOKEY POINT BLVD, MARYSVILLE, WA

LANDE MUELLER & ASSOCIATES  
ARCHITECTS  
130 LAKESIDE • SUITE 250 • SEATTLE, WA 98122 • (206) 325-2553

job no.	KL	checked	8/24/23	no.	date
drawn		date		revision	



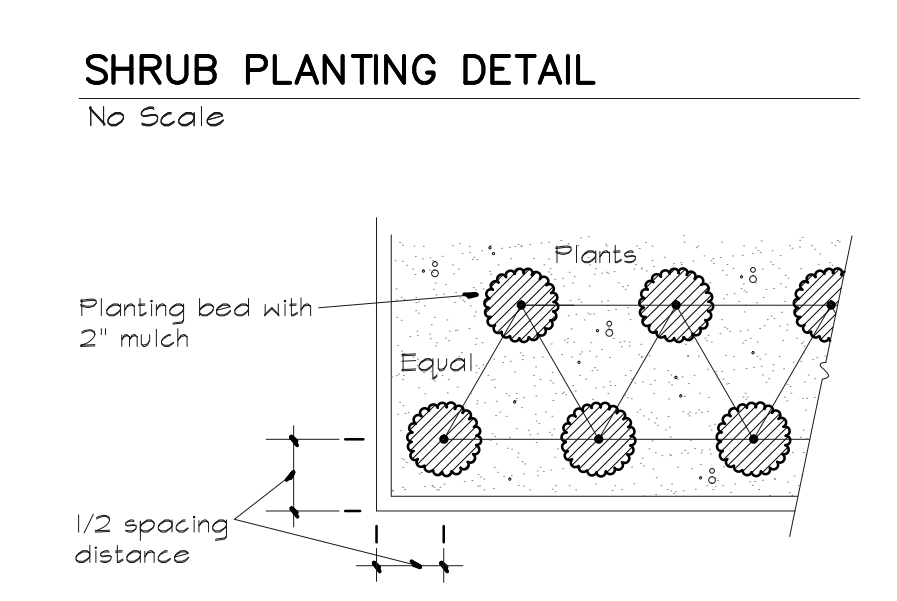
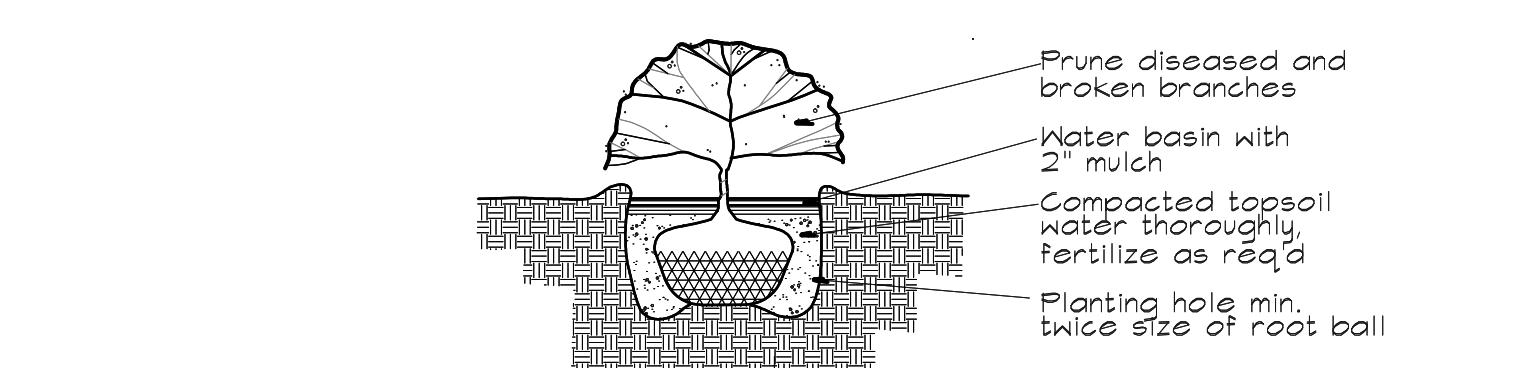
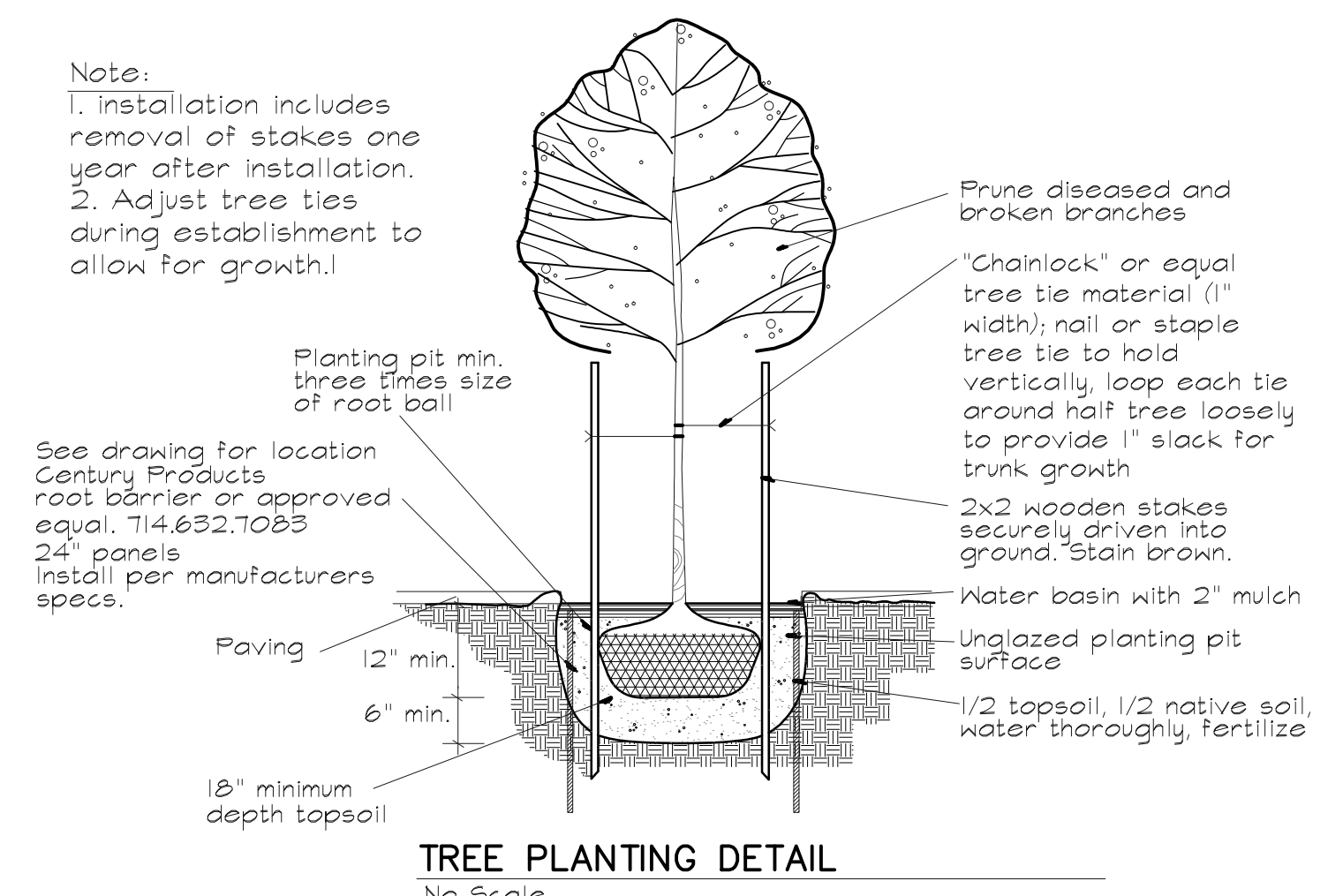
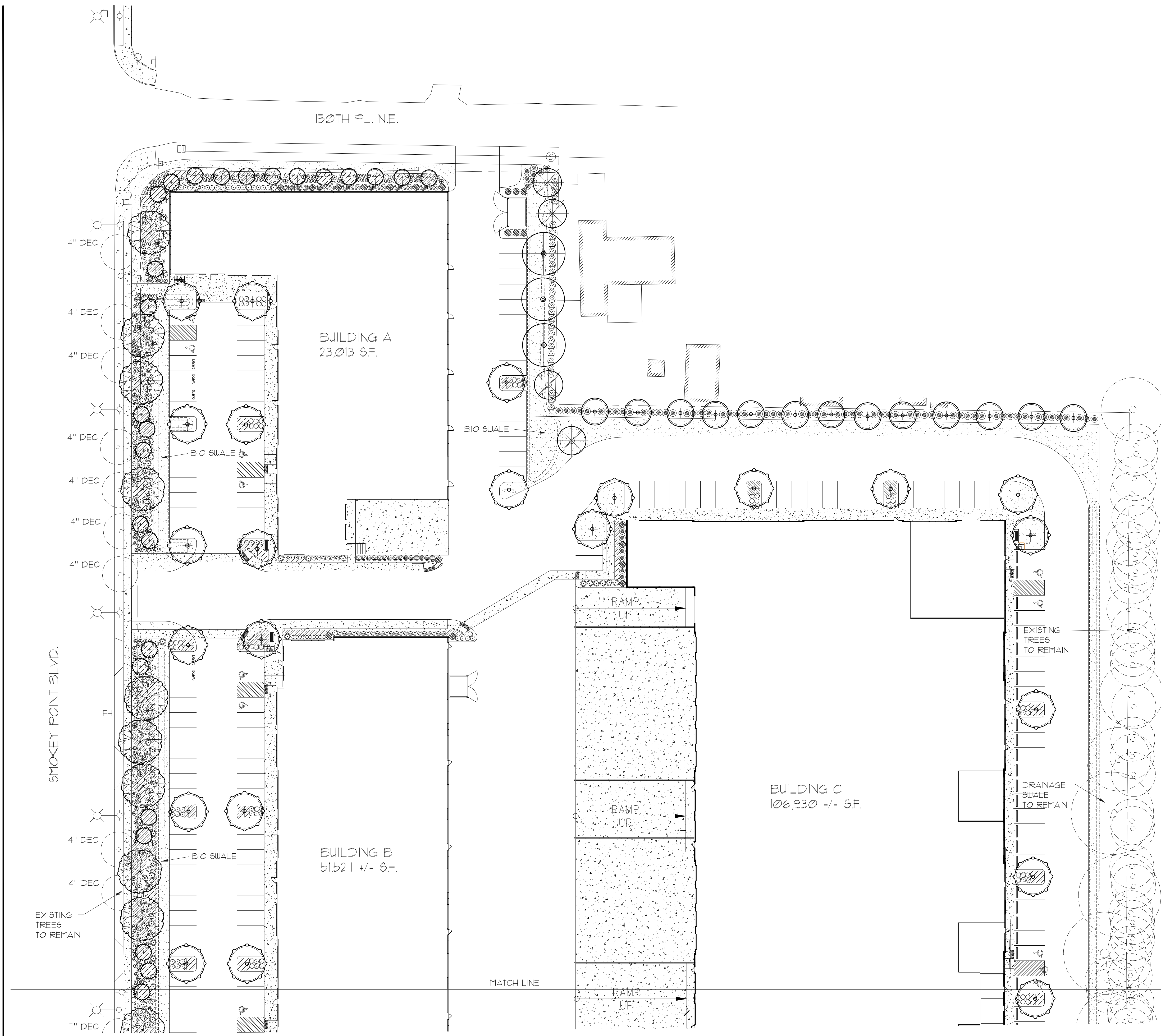

- MAINTENENCE**
1. All landscaped areas and plants required by this must be permanently maintained in a healthy growing condition in order to accomplish the purpose for which they were required.
  2. Dead or diseased plants must be replaced within 30 days of notification, or as soon as practical in regard to freezing weather, or complex situations involving the removal and replacement of large trees.
  3. All landscaped areas must be kept free of debris and weeds.
  4. Plant material must not interfere with public utilities, restrict pedestrian or vehicle access or constitute a traffic hazard.
  5. Planted areas next to pedestrian walkways and sidewalks shall be maintained or plant material chosen to maintain a clear zone between three and eight feet from ground level.
  6. The owners, their agents and assigns are responsible for providing, protecting, and maintaining all landscaping material in a healthy and growing condition, replacing it when necessary and keeping it free of refuse and debris.
  7. All fencing, walls and other features used for screening purposes shall be kept free of litter, debris, and weeds.

- NOTES**
1. Subgrades, including berms, to within 1/10th foot provided by General Contractor unless otherwise noted.
  2. Subgrade shall be scarified or rototilled if conditions require.
  3. 4\"/>

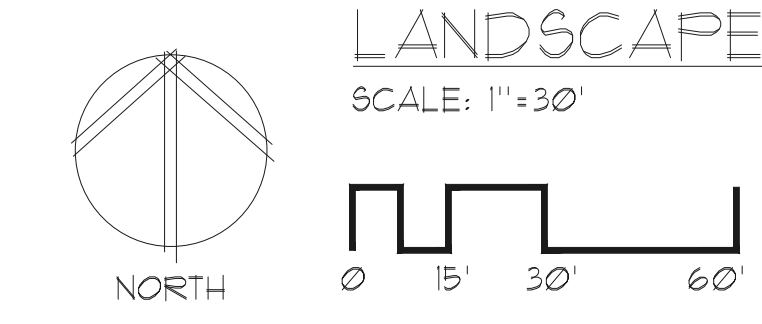

**LANDSCAPE PLAN**  
SCALE: 1"=30'



**MAIN STREET DESIGN**  
LANDSCAPE ARCHITECTURE  
9402 Total Court, (206) 842-7886  
Bainbridge Is., WA 98110

CITY OF MARYVILLE  
FILE # PA 23010

PROPOSED BUILDING FOR  
**IDEAL INDUSTRIAL PARK**  
SMOKEY POINT BLVD, MARYSVILLE, WA

**LANDSCAPE PLAN**  
LANGE MUELLER & ASSOCIATES  
ARCHITECTS  
130 LAKESIDE • SUITE 250 • SEATTLE, WA 98122 • (206) 325-2553

sheet  
**L-2**

job no.	KL	drawn	checked	8/24/23	date
no.					revision



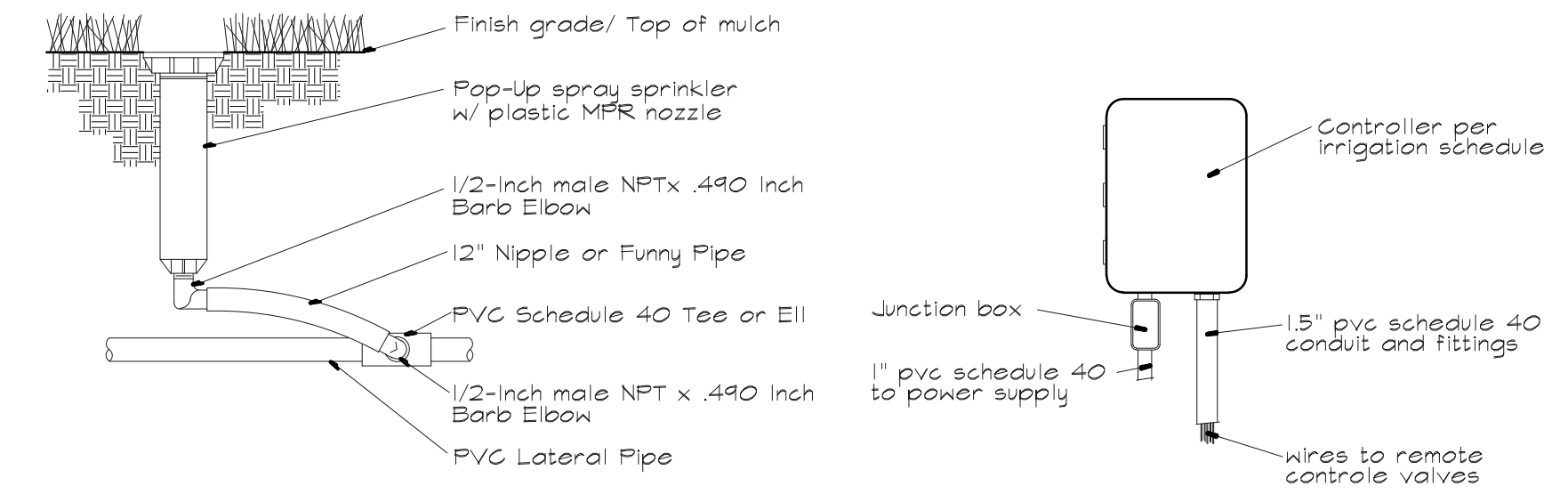
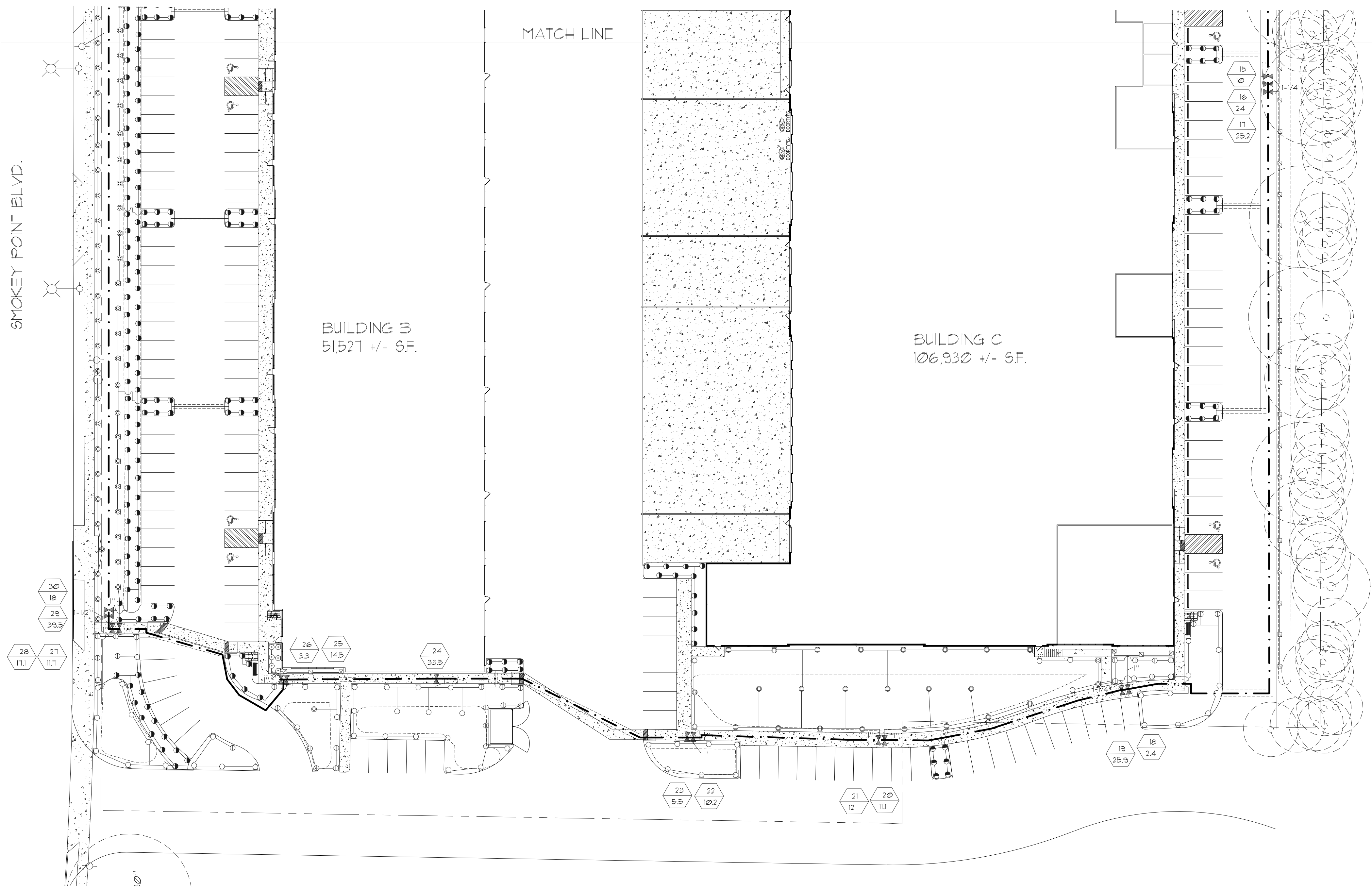

**POP-UP SPRINKLER**  
No Scale

**WALL MOUNT CONTROLLER**  
No Scale

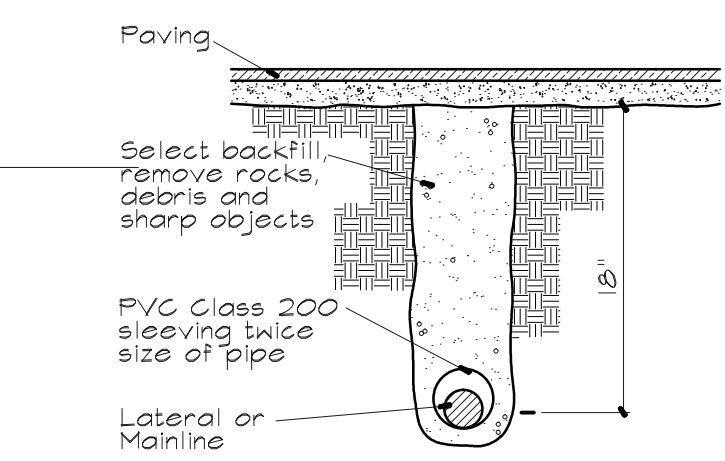

**SLEEVING DETAIL**  
No Scale

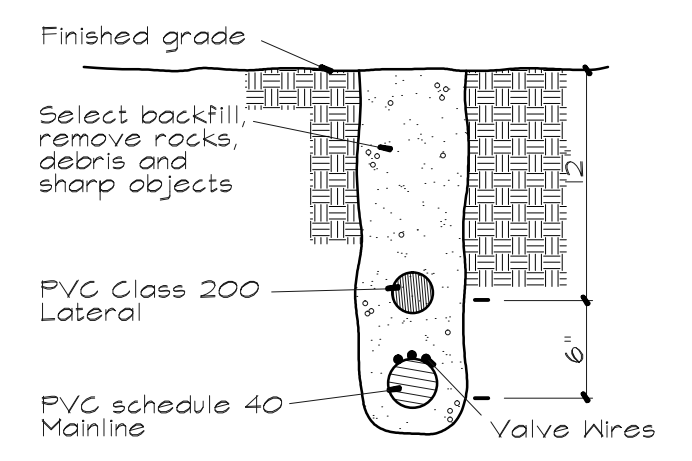

**TRENCHING DETAIL**  
No Scale

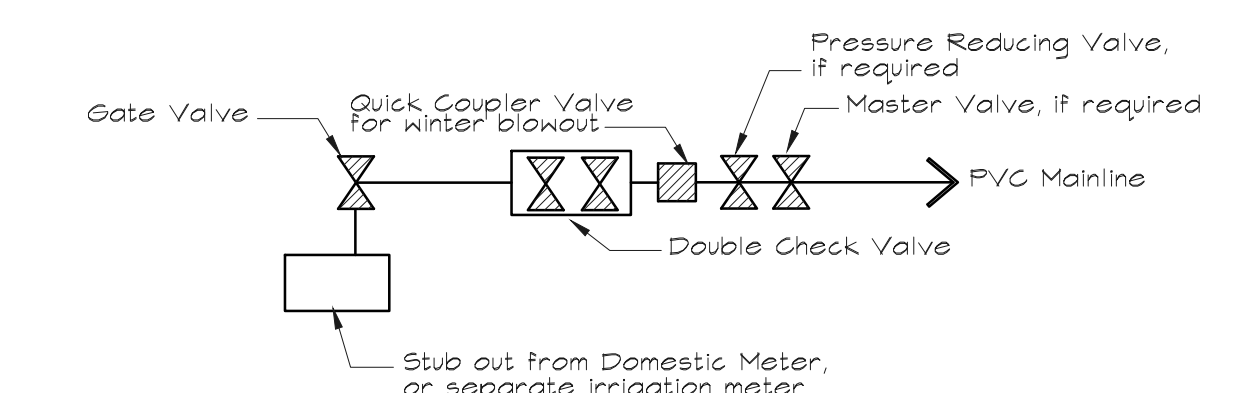

**POINT OF CONNECTION**  
No Scale

**IRRIGATION SCHEDULE**

SYMBOL	DESCRIPTION	RADIUS	GPM	PSI
☉	RAINBIRD 3500 SERIES POP-UP, 3.0 NOZZLE, 4" POP-UP	21'	.92	35
○	RAINBIRD 1800 MFR 15' SERIES POP-UP, 4" LAWN, 6" G.C.	15'	1.854	30
⊙	RAINBIRD 1800 MFR 12' SERIES POP-UP, 4" LAWN, 6" G.C.	12'	1.304	30
⊘	RAINBIRD 1800 MFR 10' SERIES POP-UP, 4" LAWN, 6" G.C.	10'	0.794	30
⊚	RAINBIRD 1800 MFR 8' SERIES POP-UP, 4" LAWN, 6" G.C.	8'	0.524	30
⊛	RAINBIRD 1800 MFR 5' SERIES POP-UP, 4" LAWN, 6" G.C.	5'	0.24	30
⊜	RAINBIRD 1800 MFR SIDE STRIP POP-UP, 4" LAWN, 6" G.C.	9'x18'	1.73	30
⊝	RAINBIRD 1800 MFR SIDE STRIP POP-UP, 4" LAWN, 6" G.C.	4'x30'	1.21	30
⊞	RAINBIRD 1800 MFR END STRIP POP-UP, 4" LAWN, 6" G.C.	4'x15'	0.61	30
⊘	RAINBIRD FEB SERIES PLASTIC VALVES			
⊚	RAINBIRD ESP ME3 SERIES CONTROLLER - CONFIRM LOCATION			
⊞	POINT OF CONNECTION: 1-1/2" IRRIGATION METER - CONFIRM LOCATION			
	1-1/2" FEBCO 850 DOUBLE CHECK VALVE			
	1" QUICK COUPLER VALVE			

- STATION 21 GPM
- 1-1/2" MAINLINE, PVC SCHEDULE 40
- LATERAL LINE, PVC CLASS 200 - 1" MINIMUM
- SLEEVING, PVC SCHEDULE 40, MINIMUM 2X LINE SIZE.

- CONFIRM EXACT LOCATION OF P.O.C., CONTROLLER, AND WATER PRESSURE AT P.O.C.
- ALL VALVES IN 'AMETEK' OR 'CARSON' BOXES SET AT FINISHED GRADE.
- ALL WORK PER PLANS, LOCAL CODES AND MANUFACTURER'S SPECS.
- PRESSURE TEST BEFORE BACKFILLING.
- PLAN IS DIAGNOSTIC. ADJUST LINE AND HEAD LOCATIONS AS NECESSARY TO ASSURE PROPER COVERAGE AND CONFORM WITH ACCEPTED CONSTRUCTION PRACTICES.

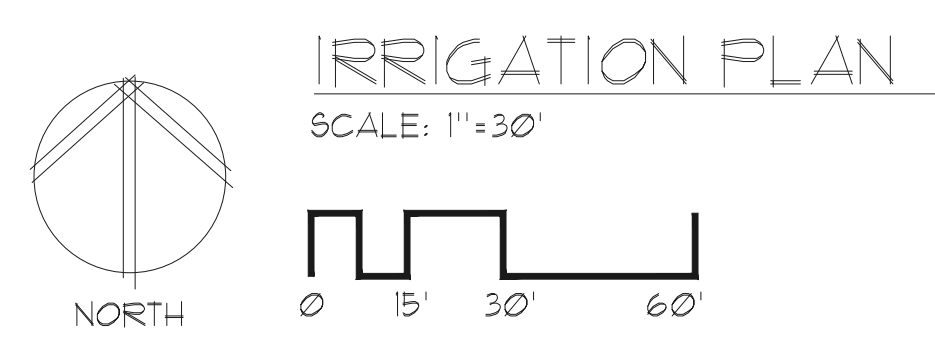

CITY OF MARYVILLE  
FILE # PA 23010



**MAIN STREET DESIGN**  
LANDSCAPE ARCHITECTURE  
9402 Tidal Court  
Bainbridge Is., WA 98110  
(206) 842-7886

PROPOSED BUILDING FOR  
**IDEAL INDUSTRIAL PARK**  
SMOKEY POINT BLVD, MARYSVILLE, WA

IRRIGATION PLAN  
**LANDE MUELLER & ASSOCIATES**  
ARCHITECTS  
130 LAKESIDE • SUITE 250 • SEATTLE, WA 98122 • (206) 325-2553  
sheet  
**L-3**

job no.	KL	checked	8/24/23	revision	no.	date
drawn						

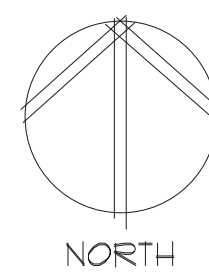
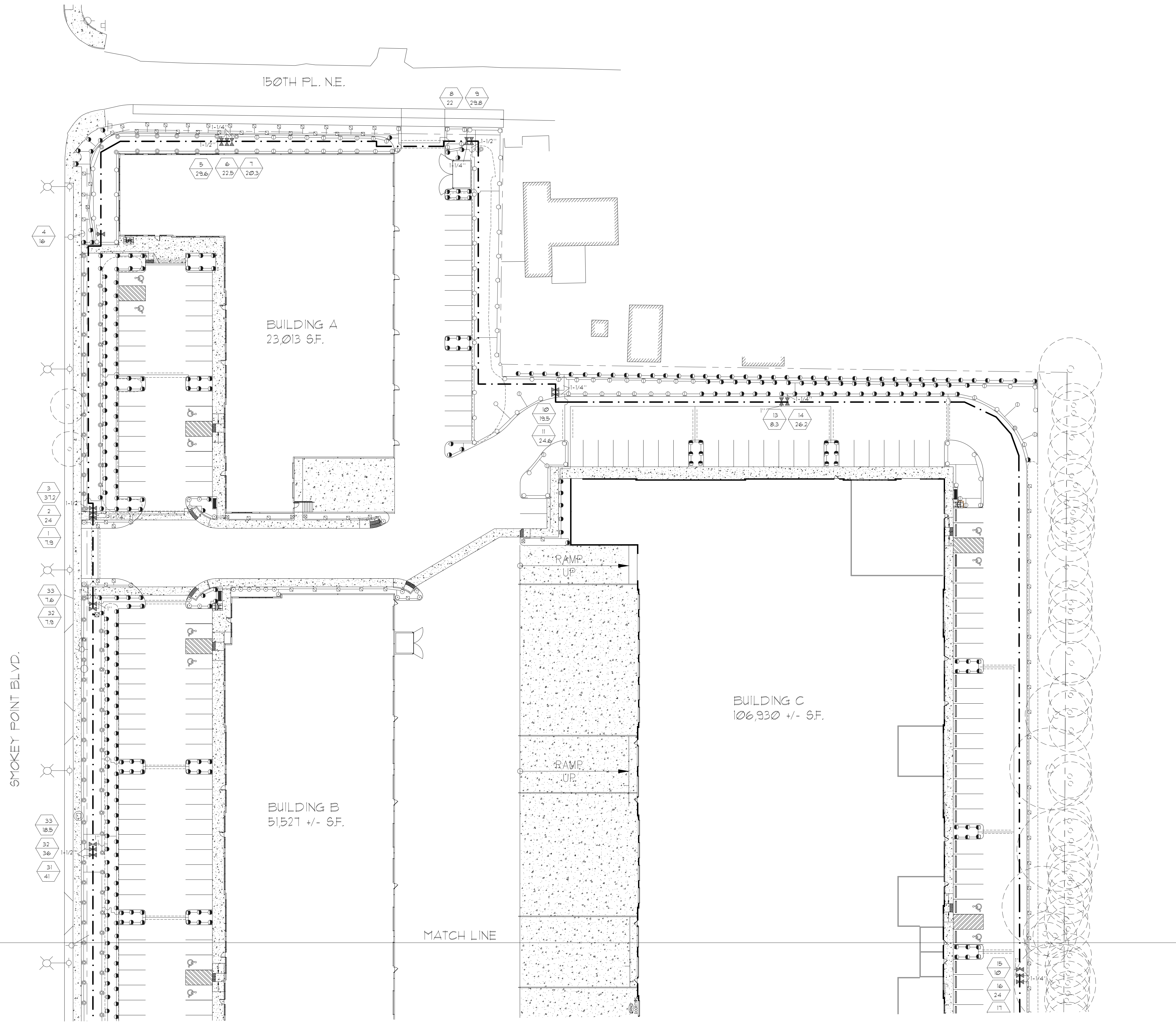

IRRIGATION PLAN  
SCALE: 1"=30'

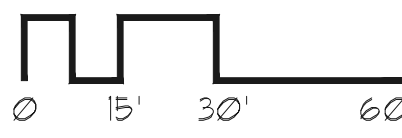

**MAIN STREET DESIGN**  
LANDSCAPE ARCHITECTURE  
9402 Tidal Court (206) 842-7886  
Bainbridge Is., WA 98110

CITY OF MARYVILLE  
FILE # PA 23010

IRRIGATION PLAN

LANCE MUELLER & ASSOCIATES  
ARCHITECTS  
180 LAKESIDE • SUITE 250 • SEATTLE, WA 98122 • (206) 325-2553

L-4

PROPOSED BUILDING FOR

**IDEAL INDUSTRIAL PARK**

SMOKEY POINT BLVD, MARYSVILLE, WA

job no.	KL	checked	8/24/23	no.	revision	date
	drawn					