

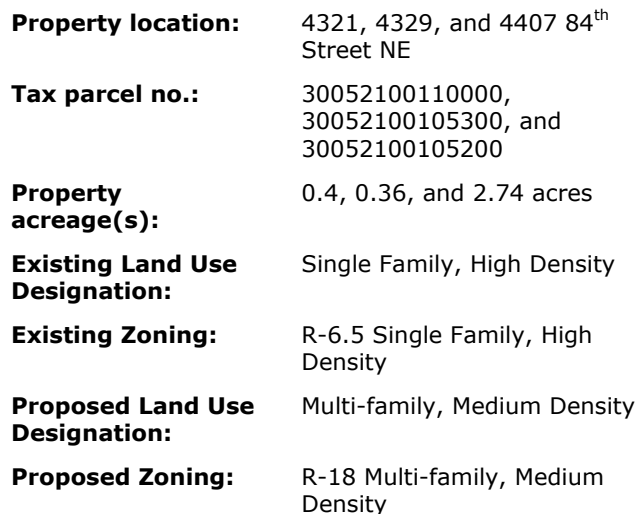

As part of its city-wide 2015 Comprehensive Plan update, which covers the planning period 2015 to 2035, the City of Marysville is assessing current Comprehensive Plan designations and existing zoning of properties, and is also updating the text of the Comprehensive Plan. The City of Marysville Comprehensive Plan text and maps include policies and recommendations intended to provide guidance for public and private decision makers who will be responsible for Marysville's future growth, and provides a legally recognized framework for making decisions about land use, transportation, public facilities, and parks and open space within the City. The following Comprehensive Plan Map amendment and rezone is proposed in your area:

Proposal: The proposal is to amend the Comprehensive Plan Map designation for approximately 3.5 acres located at 4321 84th Street (0.4 acres), 4329 84th Street (0.36 acres), and 4407 84th Street NE (2.74 acres) from Single Family, High Density to Multi-family, Medium Density.



If you have any questions regarding the Comprehensive Plan Amendment Process or upcoming meetings, please contact Angela Gemmer, Associate Planner, at 360.363.8240 or by e-mail at agemmer@marysvillewa.gov.