

- NOTES:
- TREE PIT SHALL NOT BE LESS THAN (3) TIMES ROOT BALL DIA.
 - CUT ALL TIES AND FOLD BACK BURLAP FROM UPPER 1/3 OF ROOT BALL
 - REMOVE ALL PLASTIC AND TWINE
 - TREE STAKES PERPENDICULAR TO THE PREVAILING WIND
 - PLANT TREES 2" HIGHER THAN DEPTH GROWN IN NURSERY

1 TYPICAL DECIDUOUS TREE PLANTING DETAIL

- NTS
- NOTES:
- 3-INCH WOOD CHIP MULCH MAY BE ADDED FOR ROOT PROTECTION WITHIN FENCED AREA.
 - OUTSIDE OF PROTECTION FENCING AREA, PROTECT ROOTS 2-INCHES OR LARGER IN DIAMETER BY USING HAND EXCAVATION TECHNIQUES.
 - MINIMIZE CONSTRUCTION ZONE; PROTECT VEGETATION OUTSIDE CONSTRUCTION ZONE BY SEGREGATING IT WITH HIGH VISIBILITY CONSTRUCTION FENCING.

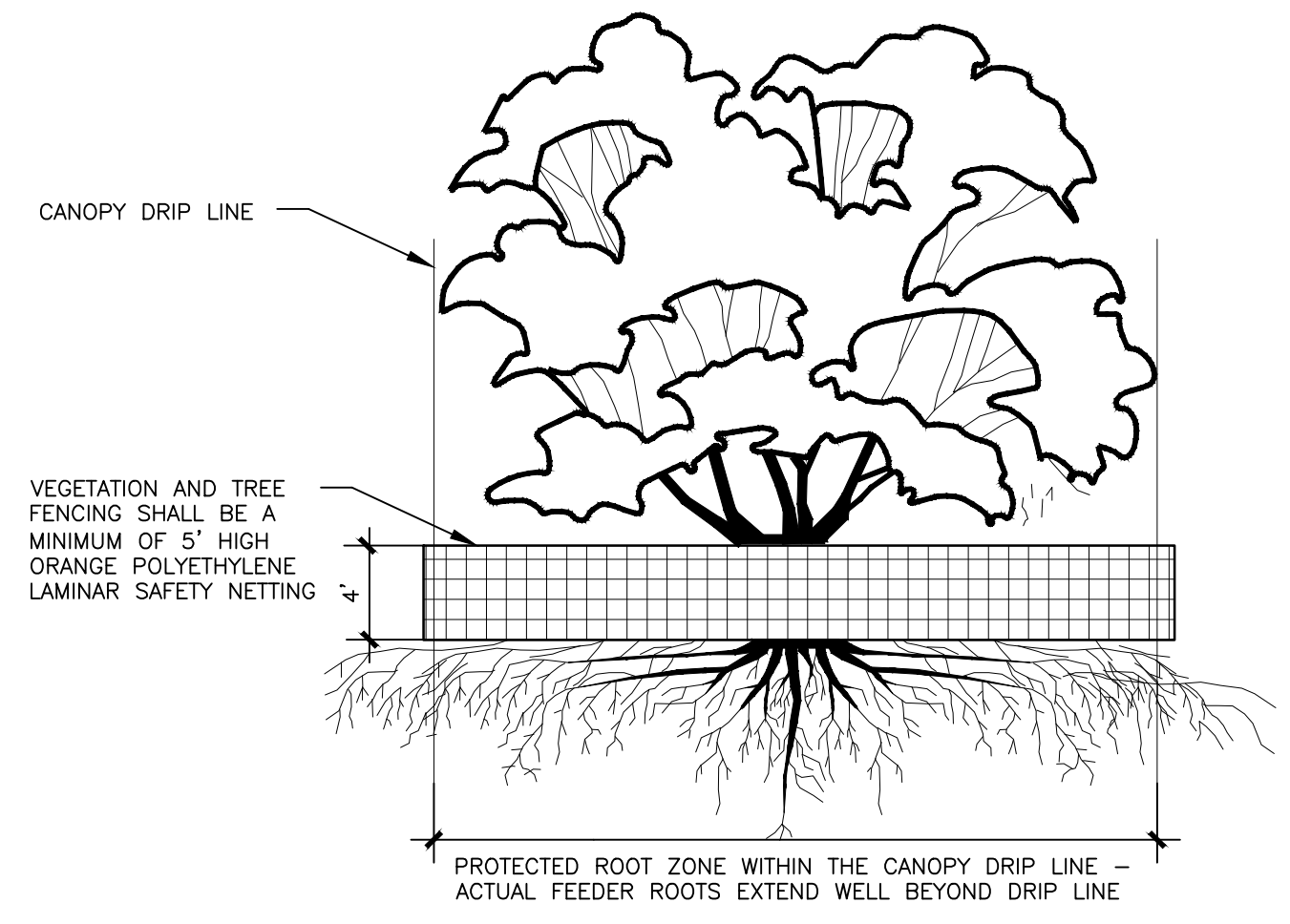

3 MARYSVILLE TREE PRESERVATION DETAIL

NTS

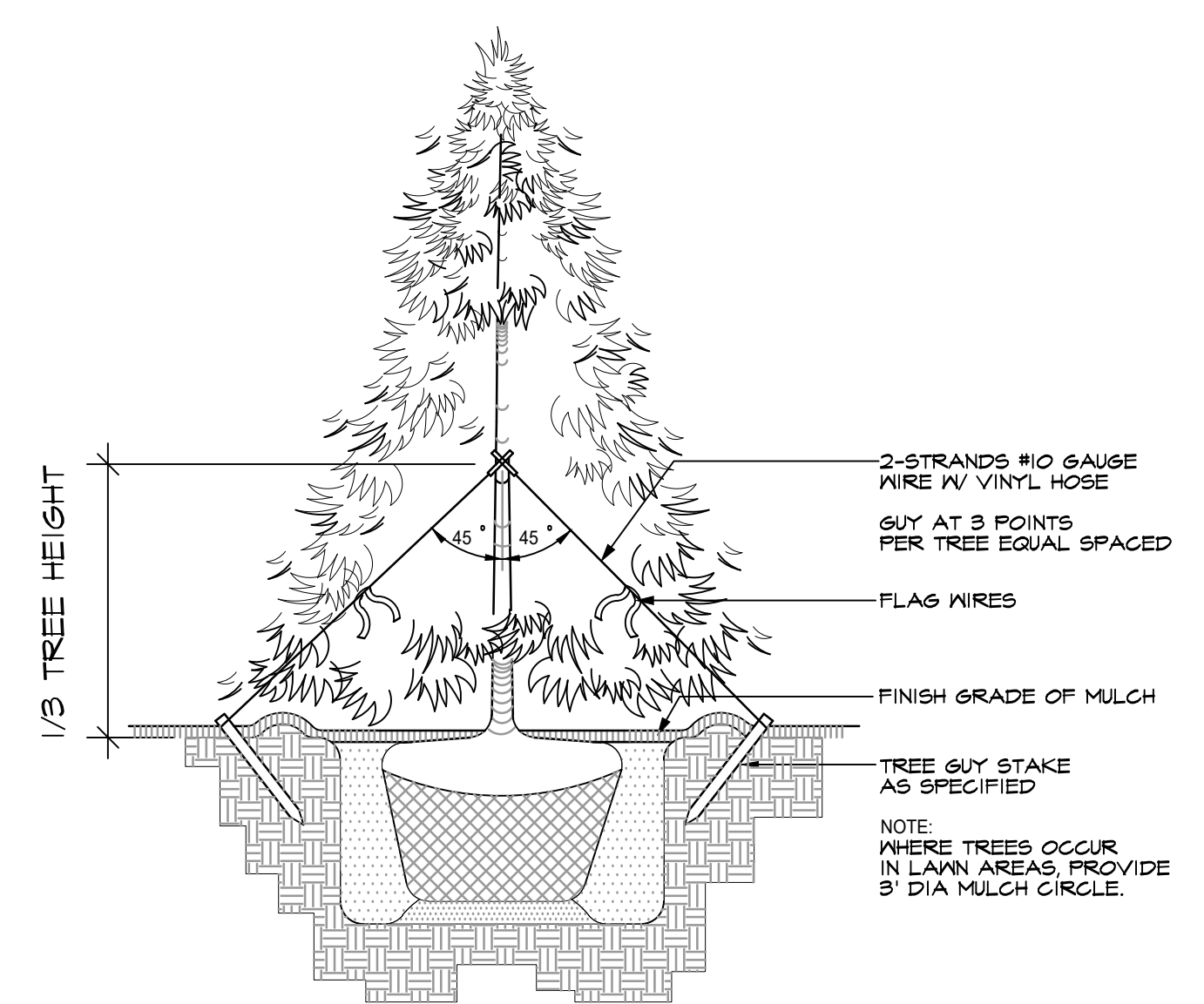

2 TYPICAL EVERGREEN TREE PLANTING DETAIL

NTS

PLANT SCHEDULE

TREES	BOTANICAL / COMMON NAME	SIZE	QTY
	<i>Acer circinatum</i> Vine Maple	3 stem min, 6' Ht	10
	<i>Acer rubrum</i> 'Bowhall' Bowhall Maple	2" Cal.	5
	<i>Acer rubrum</i> 'Karpick' Karpick Maple	2" Cal.	6
	<i>Calocedrus decurrens</i> Incense Cedar	6'-7' Ht.	20
	<i>Carpinus japonica</i> Japanese Hornbeam	2" Cal.	20
	<i>Cercidiphyllum japonicum</i> Katsura Tree	2" Cal.	4
	<i>Parrotia persica</i> 'Ruby Vase' Ruby Vase Persian Parrotia	2" Cal.	2

LANDSCAPE NOTES

- CONTRACTOR SHALL BE RESPONSIBLE FOR FAMILIARIZING THEMSELVES WITH ALL OTHER SITE IMPROVEMENTS AND CONDITIONS PRIOR TO STARTING LANDSCAPE WORK.
- CONTRACTOR SHALL USE CAUTION WHILE EXCAVATING TO AVOID DISTURBING ANY UTILITIES ENCOUNTERED. CONTRACTOR IS TO PROMPTLY ADVISE OWNER OF ANY DISTURBED UTILITIES. LOCATION SERVICE PHONE 1-800-424-5555.
- CONTRACTOR SHALL BE RESPONSIBLE FOR COMPUTING SPECIFIC QUANTITIES OF GROUND COVERS AND PLANT MATERIALS UTILIZING ON-CENTER SPACING FOR PLANTS AS STATED ON THE LANDSCAPE PLAN AND MINIMUM PLANTING DISTANCES AS SPECIFIED BELOW IN THESE NOTES.
- CONTRACTOR SHALL BE RESPONSIBLE FOR PROVIDING THE QUANTITIES OF PLANTS THAT ARE REPRESENTED BY SYMBOLS ON THE DRAWINGS.
- SUBGRADE IS TO BE WITHIN 1/4" OF ONE FOOT AS PROVIDED BY OTHERS. ALL PLANTING AREAS TO BE CLEARED OF ALL CONSTRUCTION MATERIAL AND ROCKS AND STICKS LARGER THAN 2" DIAMETER.
- 6" DEPTH TOPSOIL IN BED AREAS AND 4" IN ALL LAWN AREAS.
- 2" DEPTH BARK IN ALL BED AREAS.
- ALL PLANT MATERIAL SHALL BE FERTILIZED WITH AGRO TRANSPLANT FERTILIZER 4-2-2 PER MANUFACTURER'S SPECIFICATIONS.
- ALL PLANT MATERIAL SHALL CONFORM TO AAN STANDARDS FOR NURSERY STOCK, LATEST EDITION. ANY REPLACEMENTS MADE AT ONCE.
- 9.A. GENERAL: ALL PLANT MATERIAL FURNISHED SHALL BE HEALTHY REPRESENTATIVES, TYPICAL OF THEIR SPECIES OR VARIETY AND SHALL HAVE A NORMAL GROWTH HABIT. THEY SHALL BE FULL, WELL BRANCHED, WELL PROPORTIONED, AND HAVE A VIGOROUS, WELL DEVELOPED ROOT SYSTEM. ALL PLANTS SHALL BE HARDY UNDER CLIMATIC CONDITIONS SIMILAR TO THOSE IN THE LOCALITY OF THE PROJECT.
- 9.B. TREES, SHRUBS, AND GROUND COVER: QUANTITIES, SPECIES, AND VARIETIES, SIZES AND CONDITIONS AS SHOWN ON THE PLANTING PLAN. PLANTS TO BE HEALTHY, VIGOROUS, WELL FOLIATED WHEN IN LEAF. FREE OF DISEASE, INJURY, INSECTS, DECAY, HARMFUL DEFECTS, AND ALL WEEDS. NO SUBSTITUTIONS SHALL BE MADE WITHOUT WRITTEN APPROVAL FROM LANDSCAPE ARCHITECT OR OWNER.
- IRRIGATION PROVIDED BY ONE OUTLET LOCATED WITHIN 50 LF OF PLANT MATERIAL.



LANDSCAPE PLAN

Root of Design
206.441.4545
2020 Maitby Rd
Ste 7, FMB 370
Bethell, WA 98021
www.rootofdesign.com



Devin Agee

PROJECT TITLE

LANDSCAPE PLAN
4407 84TH ST NE MARYSVILLE, WA

DRAWN ELK	DATE 06.26.23
REVISED ELK	DATE 10.10.23
ELK	11.27.23

1" = 40'-0"

L1

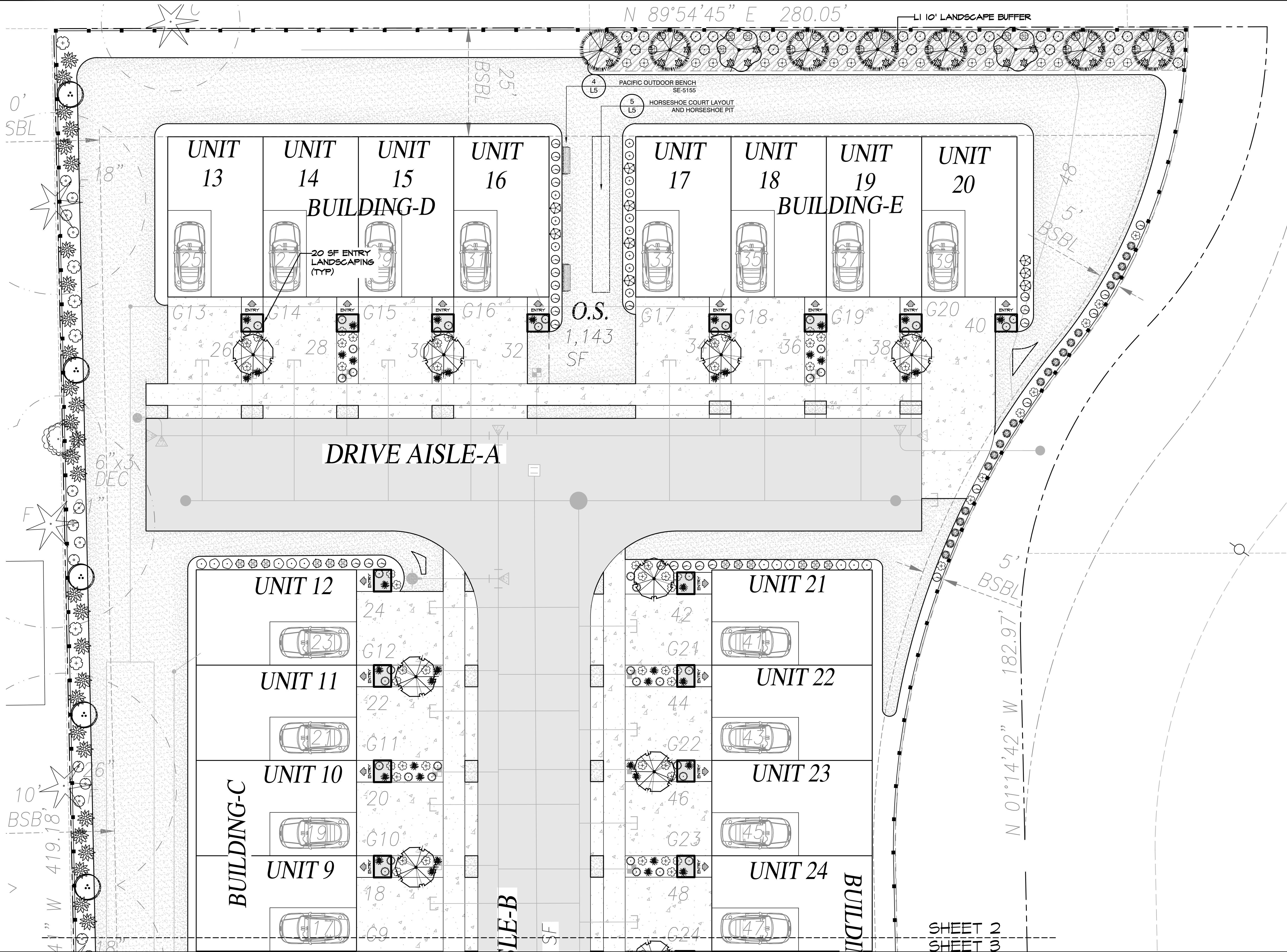

Root of Design
 206.441.4545
 2020 Maitby Rd
 Ste 7, FMB 370
 Bothell, WA 98021
 www.rootofdesign.com



Devin Agee

PROJECT TITLE

LANDSCAPE PLAN

4407 84TH ST NE MARYSVILLE, WA

DRAWN ELK	DATE 06.26.23
REVISED ELK	DATE 10.10.23
ELK	DATE 11.27.23

1"=10'-0"

L2

SHEET 2
 SHEET 3

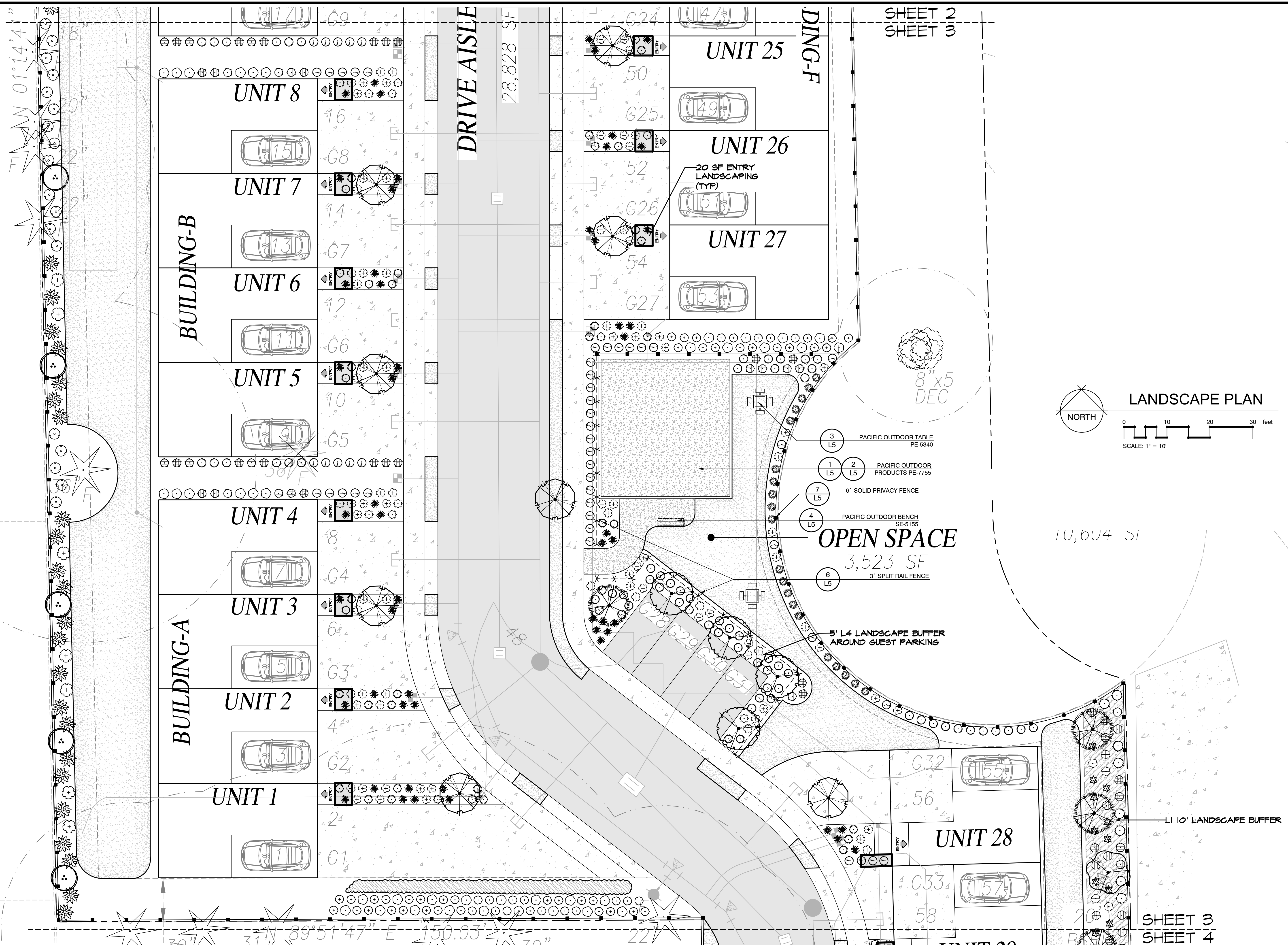

SHEET 2
SHEET 3

SHEET 3
SHEET 4

Root of Design
206.441.4545
2020 Maitby Rd
Ste 7, FMB 370
Bothell, WA 98021
www.rootofdesign.com

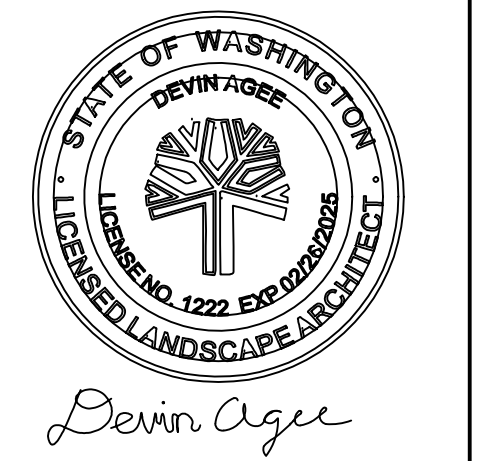

PROJECT TITLE

LANDSCAPE PLAN

4407 84TH ST NE MARYSVILLE, WA

DRAWN ELK	DATE 06.26.23
REVISED ELK	DATE 10.10.23
ELK	DATE 11.27.23

1" = 10'-0"

L3

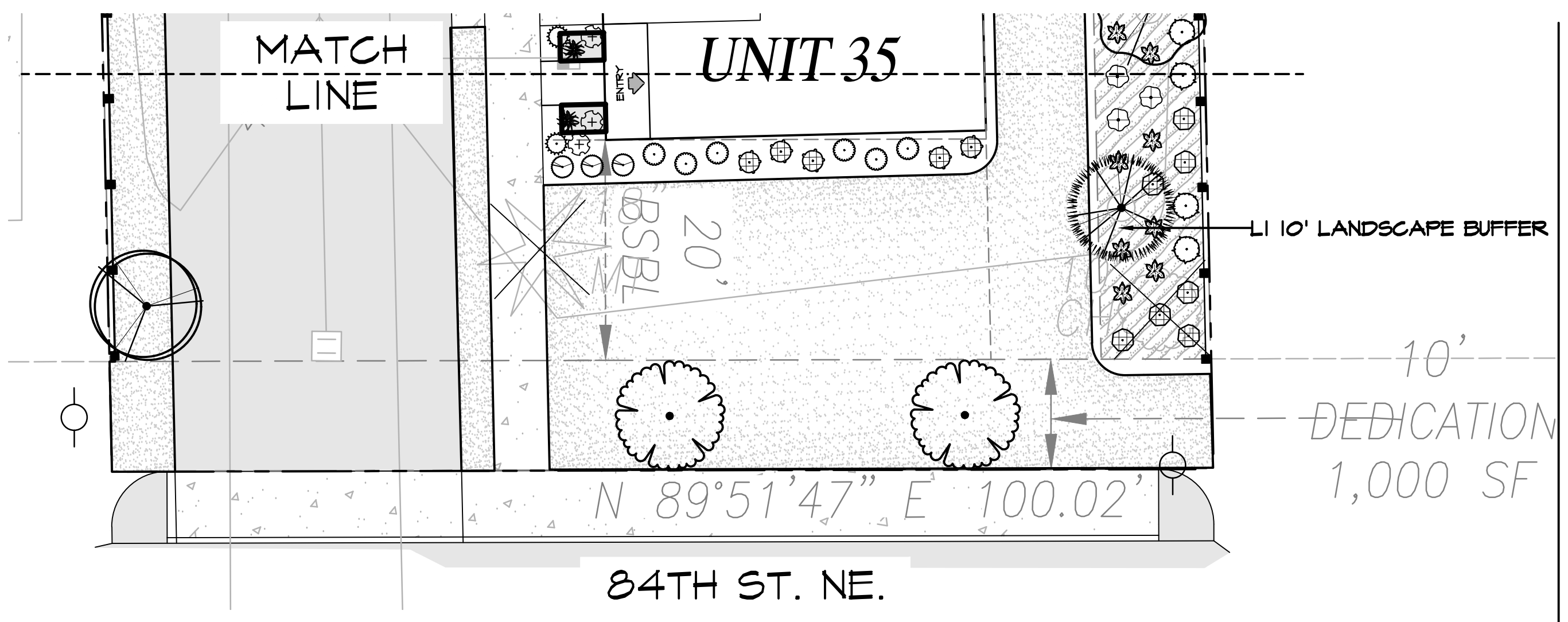
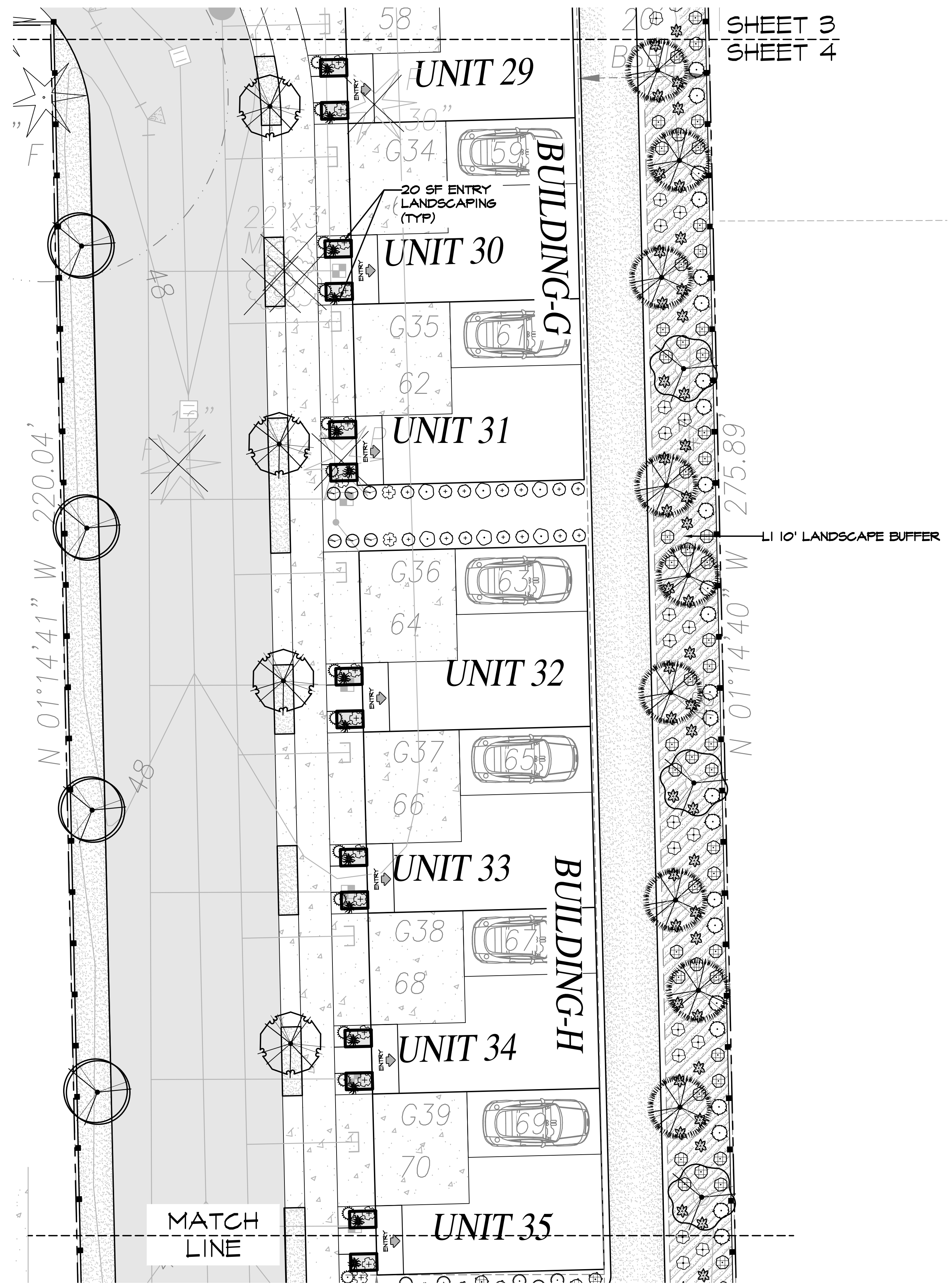

PLANT SCHEDULE

TREES	BOTANICAL / COMMON NAME	SIZE	QTY	
	<i>Acer circinatum</i> / Vine Maple	3 stem min, 6' Ht	10	
	<i>Acer rubrum</i> 'Bowhall' / Bowhall Maple	2" Cal.	5	
	<i>Acer rubrum</i> 'Karpick' / Karpick Maple	2" Cal.	6	
	<i>Calocedrus decurrens</i> / Inense Cedar	6"-7' Ht.	20	
	<i>Carpinus japonica</i> / Japanese Hornbeam	2" Cal.	20	
	<i>Cercidiphyllum japonicum</i> / Katsura Tree	2" Cal.	4	
	<i>Parrotia persica</i> 'Ruby Vase' / Ruby Vase Persian Parrotia	2" Cal.	2	
SHRUBS	BOTANICAL / COMMON NAME	SIZE	QTY	
	<i>Berberis thunbergii</i> 'Crimson Pygmy' / Crimson Pygmy Barberry	2 gal	110	
	<i>Calamagrostis x acutiflora</i> 'Karl Foerster' / Feather Reed Grass	1 gal	41	
	<i>Evonymus fortunei</i> 'Emerald Gaiety' TM / Wintercreeper	2 gal	56	
	<i>Evonymus japonicus</i> 'Greenspire' / Greenspire Upright Evonymus	2 gal	43	
	<i>Hydrangea macrophylla</i> 'Nikko Blue' / Nikko Blue Hydrangea	2 gal	65	
	<i>Lonicera pileata</i> 'Moss Green' / Moss Green Honeysuckle	2 gal	71	
	<i>Mahonia aquifolium</i> 'Compacta' / Compact Oregon Grape	24" Ht. min.	60	
	<i>Nandina domestica</i> 'Gulf Stream' TM / Heavenly Bamboo	2 gal	165	
	<i>Nandina domestica</i> 'Sienna Sunrise' / Heavenly Bamboo	2 gal	9	
	<i>Pennisetum alopecuroides</i> 'Hameln' / Hameln Dwarf Fountain Grass	2 gal	112	
	<i>Pieris japonica</i> 'Brouwer's Beauty' / Lily of the Valley Bush	3 gal	52	
	<i>Polystichum munitum</i> / Western Sword Fern	24" Ht. min.	83	
	<i>Prunus laurocerasus</i> 'Mount Vernon' / Mount Vernon Laurel	2 gal	106	
	<i>Ribes sanguineum</i> / Red Flowering Currant	3 gal.	13	
	<i>Sarcococca ruscifolia</i> / Fragrant Sarcococca	3 gal.	30	
	<i>Spiraea x bumalda</i> 'Limeound' TM / Limeound Spiraea	24" Ht. min.	40	
	<i>Vaccinium ovatum</i> / Evergreen Huckleberry	24" Ht. min.	43	
GROUND COVERS	BOTANICAL / COMMON NAME	SIZE	SPACING	QTY
	<i>Fragaria chiloensis</i> / Beach Strawberry	4"pot	18" o.c.	1,340
	Turf Sod / Draught Tolerant Fescue Blend	sod		21,218 sf
	<i>Vinca minor</i> 'Bowles Blue' / Dwarf Periwinkle	4"pot	24" o.c.	52
SITE	BOTANICAL / COMMON NAME	SIZE	SPACING	QTY
	12" Engineered Play Chips	N/A		960 sf



Root of Design
 206.441.4545
 2020 Maitby Rd
 Ste 7, FMB 370
 Bothell, WA 98021
 www.rootofdesign.com



Devin Agee

PROJECT TITLE

LANDSCAPE PLAN

4407 84TH ST NE MARYSVILLE, WA

DRAWN ELK	DATE 06.26.23
REVISED ELK	DATE 10.10.23
ELK	11.27.23

1"=10'-0"

L4



ACTIVITIES: 11
AGE RANGE: 5 - 12
AREA: 40'x42'

1 PACIFIC OUTDOOR PRODUCTS PE-7755

NTS

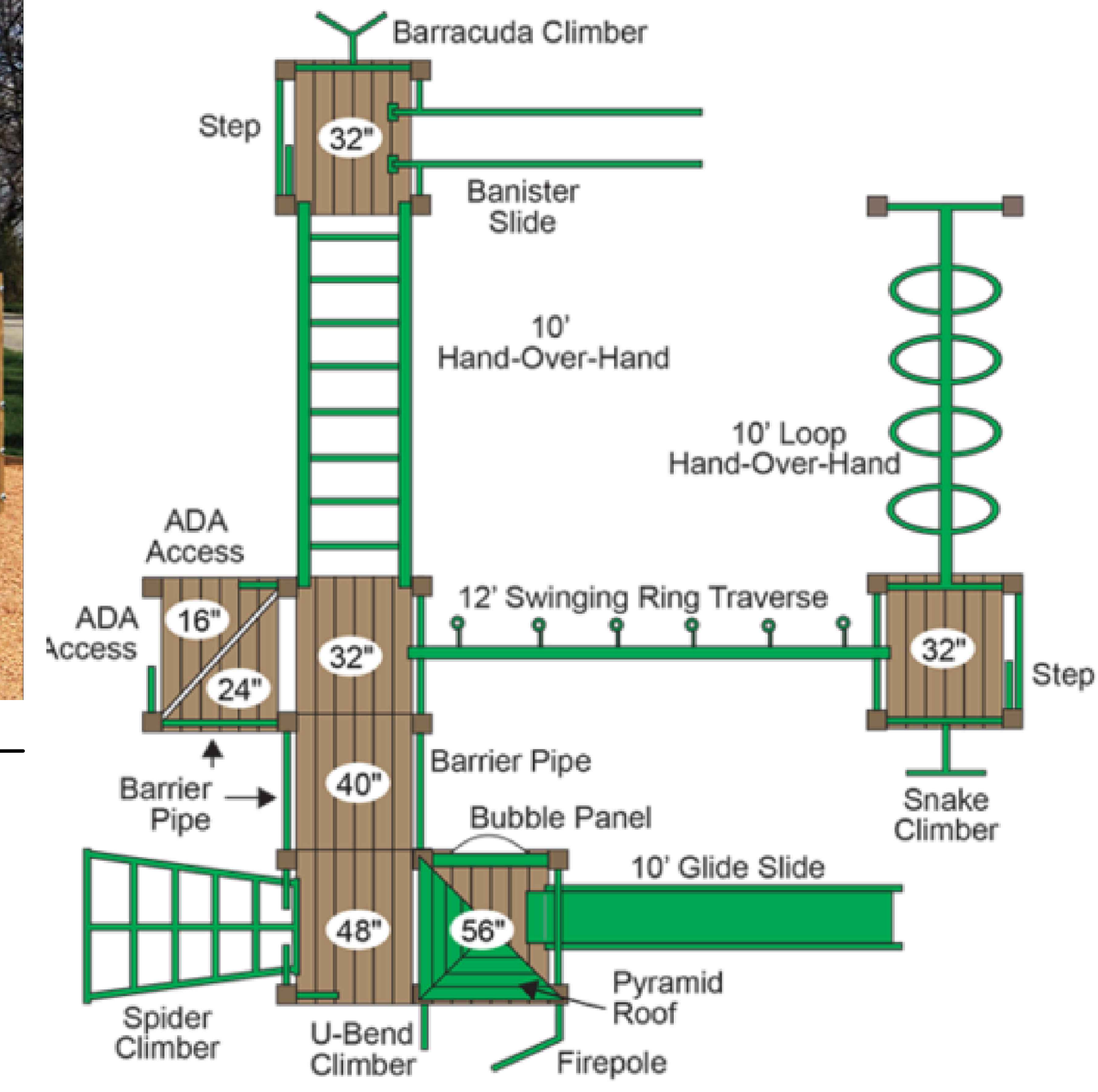

2 PACIFIC OUTDOOR PRODUCTS PE-7755

NTS



3 PACIFIC OUTDOOR TABLE PE-5340

NTS



4 PACIFIC OUTDOOR BENCH SE-5155

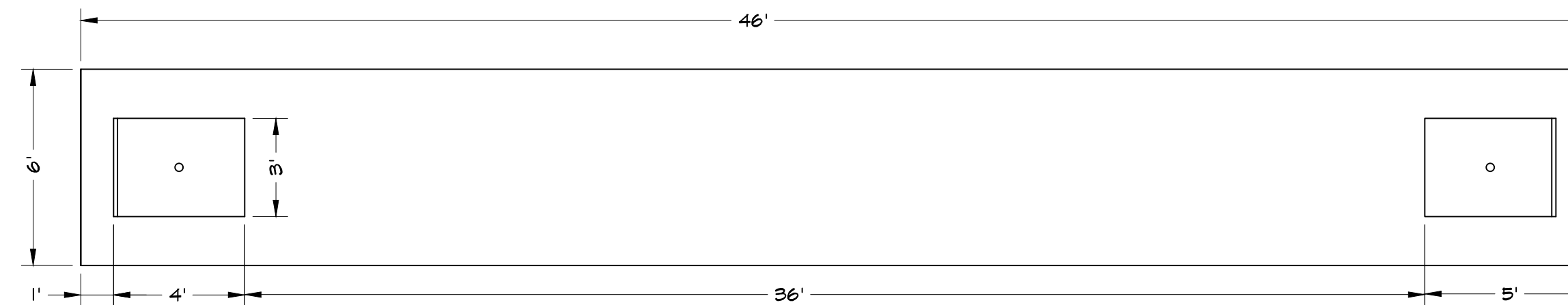
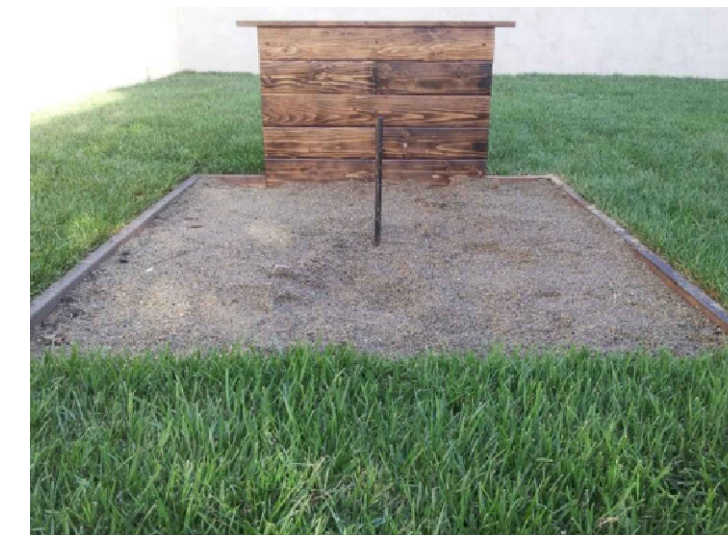

5 HORSESHOE COURT LAYOUT AND HORSESHOE PIT

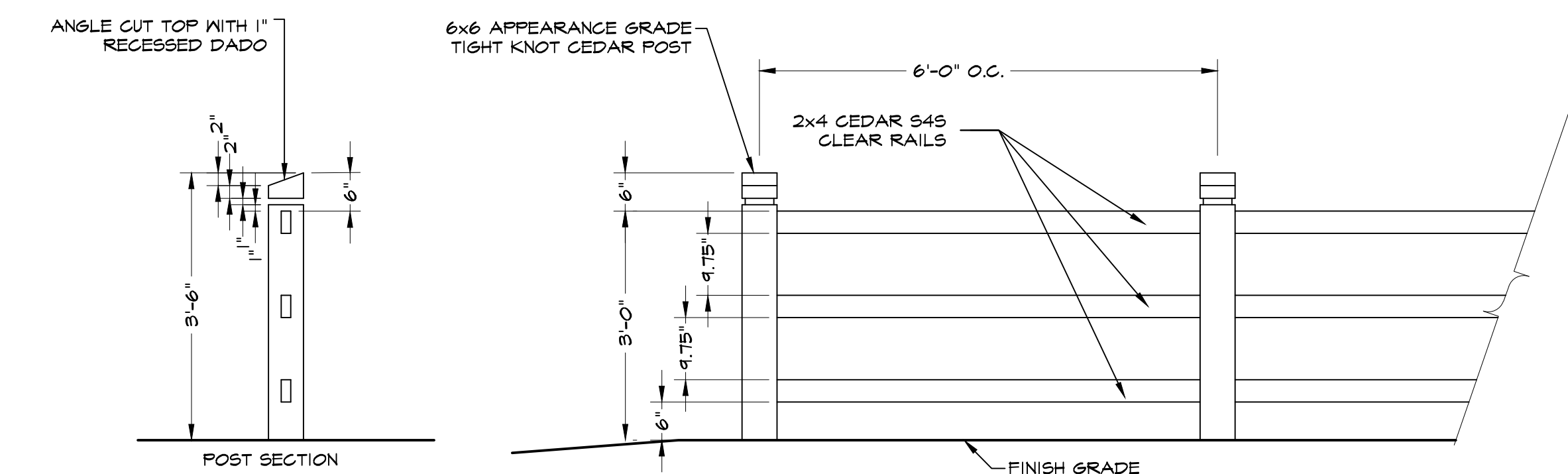

6 3' SPLIT RAIL FENCE

NTS

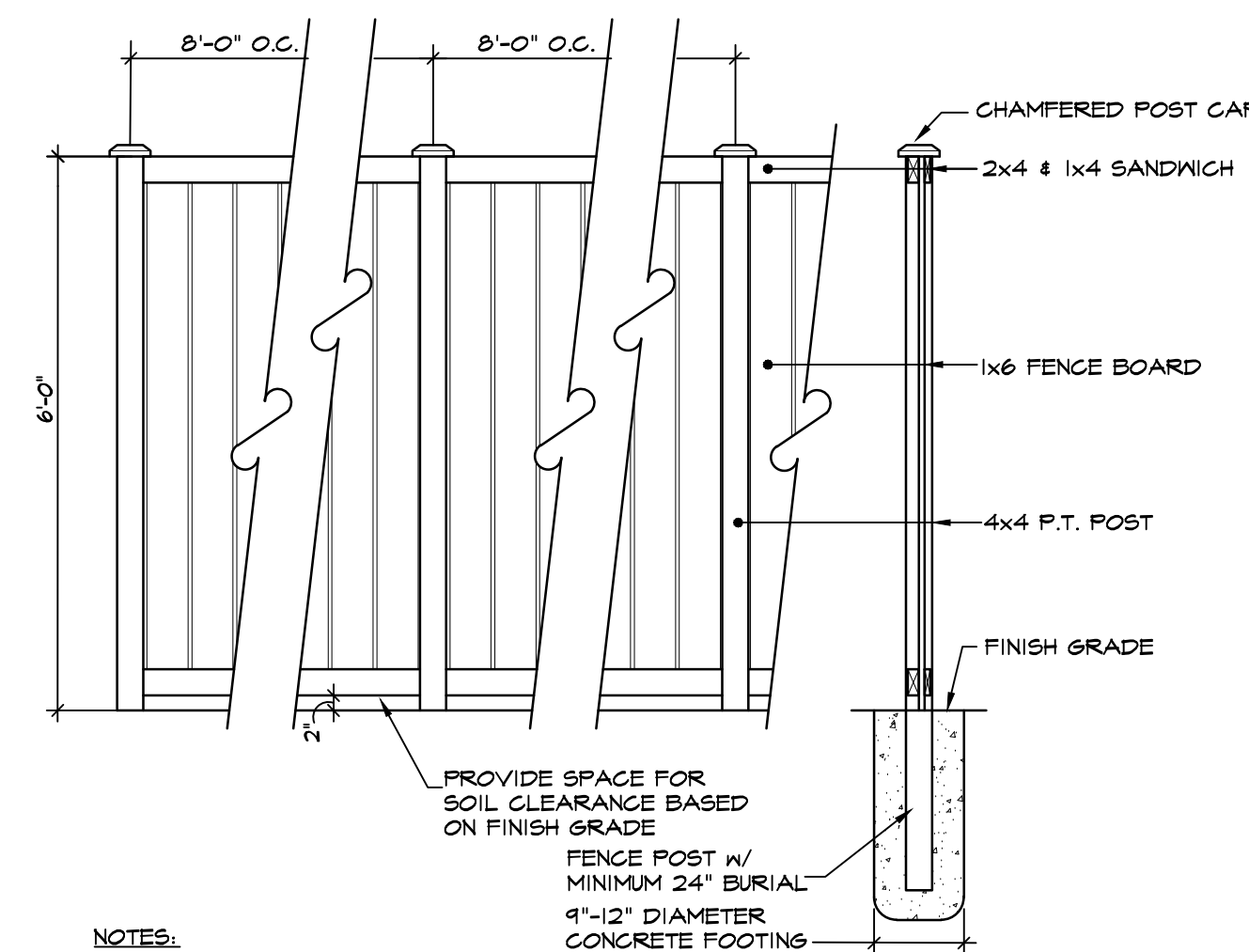

NOTES:
1. TIGHT KNOT CEDAR
2. ALL HARDWARE/FASTENERS TO BE NON-FERROUS
3. THE FINISHED SIDE OF THE FENCE SHALL FACE THE EXTERIOR OF THE LOT
4. ALL FENCES STAINED SHALL BE STAINED WITH BRAND AND COLOR TO BE DETERMINED

7 6' SOLID PRIVACY FENCE

NTS

Root of Design
206.441.9545
2020 Maitby Rd
Ste 7, PMB 370
Bothell, WA 98021
www.rootofdesign.com



Devin Agee

PROJECT TITLE

LANDSCAPE PLAN

4407 84TH ST NE MARYSVILLE, WA

DRAWN ELK DATE 06.26.23

REVISED ELK DATE 10.10.23
ELK DATE 11.27.23

NTS

L5